

BILL OF MATERIAL

MARKS	SHIP	TEMP	QTY	MATERIAL	FT	IN	GR	REMARK'S
36B1			ONE	W12x35	25	6 1/8		
	pa36		3	R3 x 3	0	11 1/8		SHAPED
36B2			ONE	W12x35	25	6 1/8		
	pa36		3	R3 x 3	0	11 1/8		SHAPED
36B3			ONE	W12x35	25	6 1/8		
	pa36		4	R3 x 3	0	11 1/8		SHAPED
36B4			ONE	W12x35	25	6 1/8		
	pa36		4	R3 x 3	0	11 1/8		SHAPED

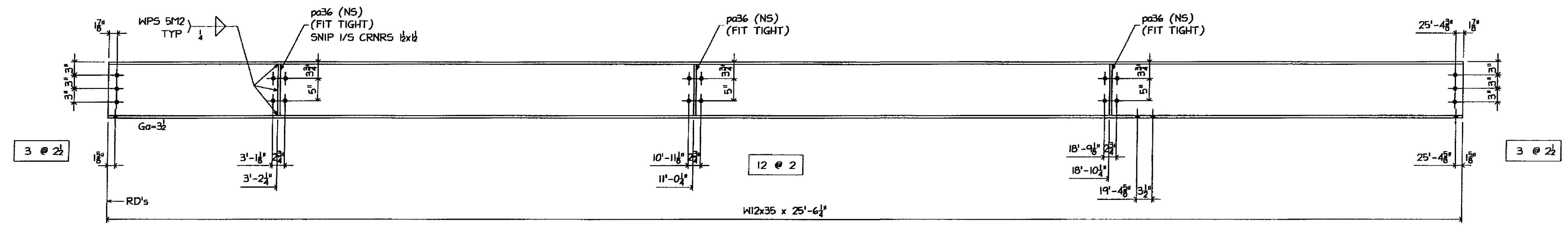

ONE - BEAM - 36B1 (AS SHOWN)
ONE - BEAM - 36B2 (OPP HAND)

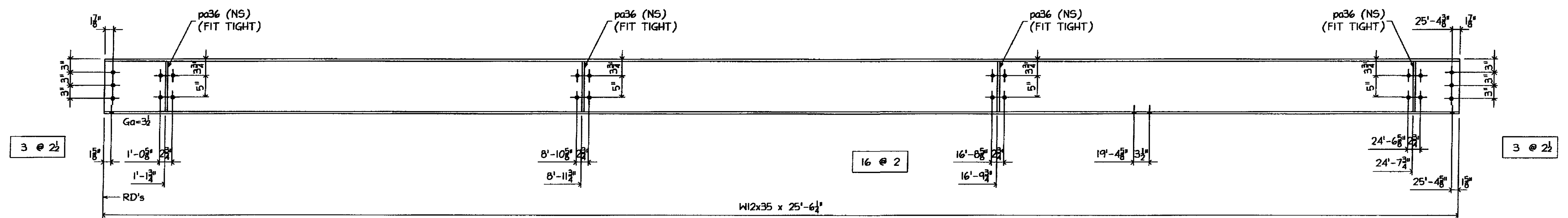

ONE - BEAM - 36B3 (AS SHOWN)
ONE - BEAM - 36B4 (OPP HAND)

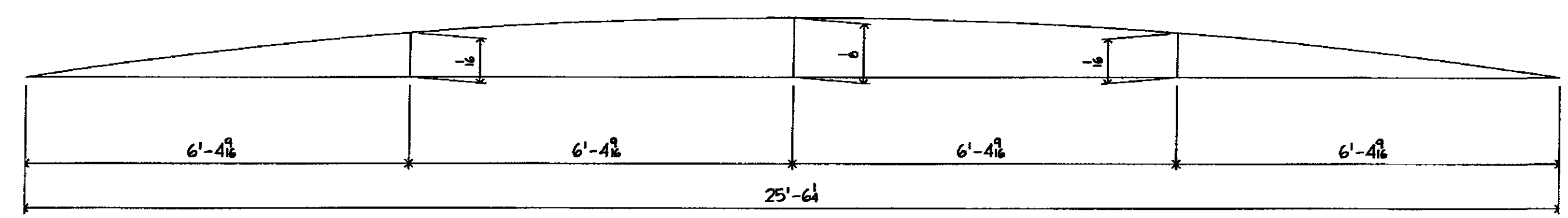

CAMBER DIAGRAM

SHOP DRAWINGS ARE REVIEWED UNLESS NOTED OTHERWISE

NO EXCEPTION TAKEN	<input checked="" type="checkbox"/>
REVISION AS NOTED	<input type="checkbox"/>
REVISION AS NOTED	<input type="checkbox"/>
REVISION AS NOTED	<input type="checkbox"/>
REJECTED	<input type="checkbox"/>

DATE: 3/27/19

SIGNATURE: [Signature]

REVIEW BY STANTEC IS FOR THE SOLE PURPOSE OF ASCERTAINING GENERAL CONFORMITY WITH DESIGN. CONTRACTOR IS RESPONSIBLE FOR DIMENSIONS, FABRICATION AND CONSTRUCTION METHODS, COORDINATION OF SUB-TRADES, DETAIL DESIGN OF COMPONENTS, AND ERRORS OR OMISSIONS ON SHOP DRAWINGS.

GALVANIZING NOTES:

- ALL WELDS SHALL BE SEALED
- VENT AS REQUIRED
- COMPLETE FINAL ASSEMBLY OF BOLTED ITEMS AFTER GALVANIZING WIRE-BRUSH ALL CONTACTING SURFACES TO A DULL-GRAY APPEARANCE PRIOR TO ASSEMBLY

FB THIS DWG

56- 3/8" x 2 (A325 GALV.) BOLT w/N#W
24- 3/8" x 2 1/2 (A325 GALV.) BOLT w/N#W

MATL:

- ALL MAT'L SHALL CONFORM TO AASHTO M 270/M 270 GRADE 50 (UNLESS NOTED)
- 'CVN' INDICATES CHARPY 'V' NOTCH TESTED.
- 'FCM' INDICATES 'FRACTURE CRITICAL MEMBER'

WELD: E70xx
HOLES: 1/8" UNO
PREP: SSPC-SP8
PAINT: GALVANIZED AND AIR COOLED (NOT QUENCHED) (SEE GALVANIZING NOTES)

3/11/09 PER APPL COMMENTS DATED 3/06/09

ARC ENTERPRISES, INC.
KINGFIELD, MAINE

PROJECT: STATE OF VERMONT - AGENCY OF TRANSPORTATION
BRIDGE No 31 - RICHMOND, VERMONT

SCALE: NTS APPROVED BY: DRAWN BY: KAJ

DATE: 2/18/09 CHKD. BY: CM05-DB2

BRIDGE # HIGHWAY #1 OVER WINOOSKI RIVER
SIDEWALK STRINGER DETAILS

T BUCK CONSTRUCTION DWG NO 09-113 - 36/A