

**STAGE II**

1. OPEN NEWLY CONSTRUCTED ROADWAY TO A MINIMUM OF ONE LANE OF THROUGH TRAFFIC. DURING WORK HOURS, MAINTAIN ALTERNATING TWO-WAY TRAFFIC ON LEGION ROAD AND EAST ARLINGTON ROAD. DURING NON-WORKING HOURS, RESTORE TWO-WAY TRAFFIC ON EAST ARLINGTON ROAD. REMOVE BARRIERS AND DRUMS; COVER OR REMOVE W20-4 AND W20-7 SIGNS.
2. CONSTRUCT GMP SUBSTATION DRIVEWAY EXTENSION.
3. CONSTRUCT PROPOSED CONCRETE TANK PAD.
4. THE CONTRACTOR SHALL SUBMIT FOR THE ENGINEER'S REVIEW AND APPROVAL A DETAILED WORK PLAN OUTLINING THE PROCEDURE, EQUIPMENT AND SCHEDULE TO BE USED IN PERFORMING THE RELOCATION OF THE MILITARY TANK. THE DETAILED WORK PLAN SHALL INCLUDE CONSTRUCTION STAGING PLAN, CRANE LIFTING PLAN, CUT SHEETS, ETC. TO VERIFY THE CAPACITY OF THE EQUIPMENT AND MATERIALS TO BE USED IN PERFORMING THE MILITARY TANK RELOCATION.
5. REMOVE EXISTING TANK PAD, REGRADE SIDESLOPE AND COMPLETE ROADWAY CONSTRUCTION.
6. RELOCATE TRAFFIC ONTO COMPLETED LEGION ROAD.
7. REGRADE TEMPORARY WIDENED GRAVEL SURFACE ROADWAY (6" SAND AND 15" DENSE GRADED CRUSHED STONE), PLACE 4" TOPSOIL AND SEED WHERE SPECIFIED ON PLANS.
8. INSTALL DETECTABLE WARNING PANEL (E. ARLINGTON ROAD STA 15+33.30 RT).
9. RAILROAD FLAGGER IS REQUIRED FOR WORK WITHIN RAILROAD RIGHT OF WAY.
10. RAILROAD TRAFFIC SHALL BE MAINTAINED AT ALL TIMES.
11. AUTOMATIC WARNING SYSTEM (AWS) SHALL BE OPERATIONAL DURING ALL NON-WORKING HOURS.
12. CONSTRUCT NEW RAILROAD SIGNAL FOUNDATIONS AND INSTALL NEW AWS.
13. REMOVE REMAINING TRAFFIC CONTROL AND EROSION CONTROL MEASURES.

**GENERAL NOTES - ALL PHASES:**

1. FOR GENERAL NOTES SEE VAOT STANDARD T-1.
2. PAYMENT FOR TRAFFIC CONTROL WORK WILL BE MADE UNDER ITEM 900.645 SPECIAL PROVISION (TRAFFIC CONTROL, RAIL-HIGHWAY CROSSING).
3. THE CONTRACTOR MAY PROPOSE TO USE THEIR OWN SITE SPECIFIC TRAFFIC CONTROL PLAN WHILE MAINTAINING THE PHASES OF CONSTRUCTION, CONSTRUCTION REQUIREMENTS, AND ALLOWABLE WORK TIMES AS STATED ABOVE AND IN THE SPECIAL PROVISIONS.

- LEGEND:**
- LIMITS OF STAGE II ROADWAY CONSTRUCTION
  - INLET PROTECTION DEVICE, TYPE I
  - TEMPORARY EROSION MATTING
  - PROJECT DEMARCATION FENCE
  - GEOTEXTILE FOR SILT FENCE, WOVEN WIRE REINFORCED
  - CLEAR ZONE
  - TEMPORARY STONE CHECK DAM, TYPE I
  - REFLECTORIZED DRUM
  - FLAGGER
  - POLICE OFFICER
  - DIRECTION OF TRAFFIC

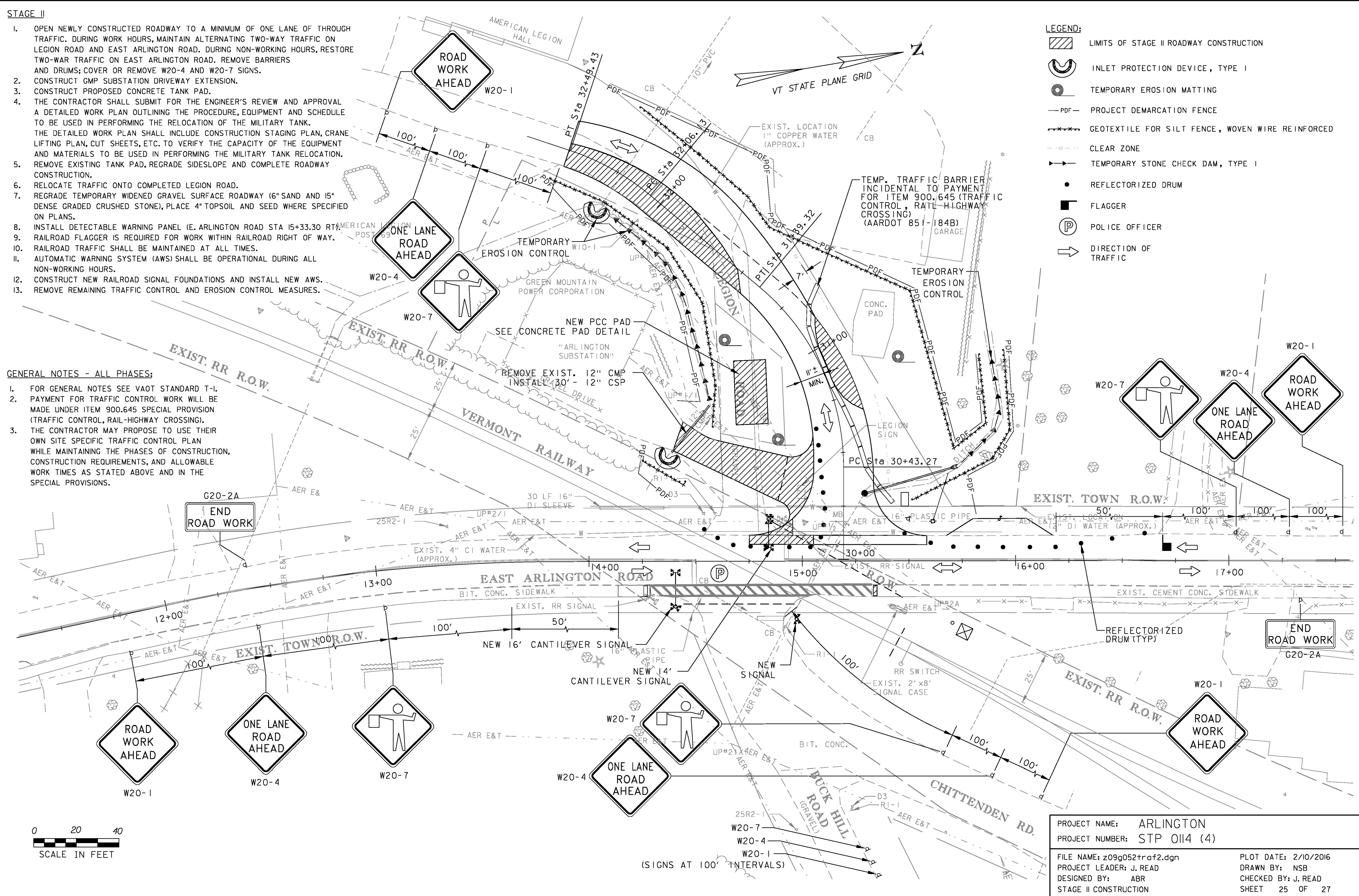

P701120069

PROJECT NAME: ARLINGTON  
 PROJECT NUMBER: STP 0114 (4)  
 FILE NAME: z09g052traf2.dgn  
 PROJECT LEADER: J. READ  
 DESIGNED BY: ABR  
 STAGE II CONSTRUCTION

PLOT DATE: 2/10/2016  
 DRAWN BY: NSB  
 CHECKED BY: J. READ  
 SHEET 25 OF 27