

STATE OF VERMONT AGENCY OF TRANSPORTATION

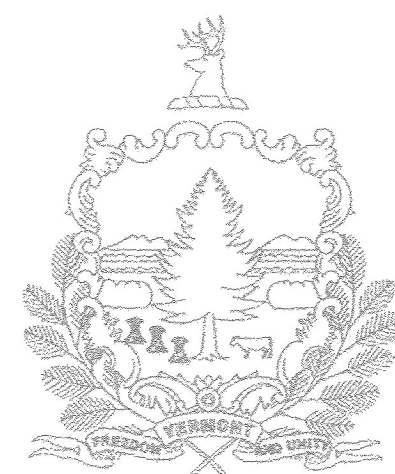

PROPOSED IMPROVEMENT COUNTY OF BENNINGTON TOWN OF ARLINGTON

TH#1, CL.2 AND TH#46, CL.3 (7-RURAL MAJOR COLLECTOR)

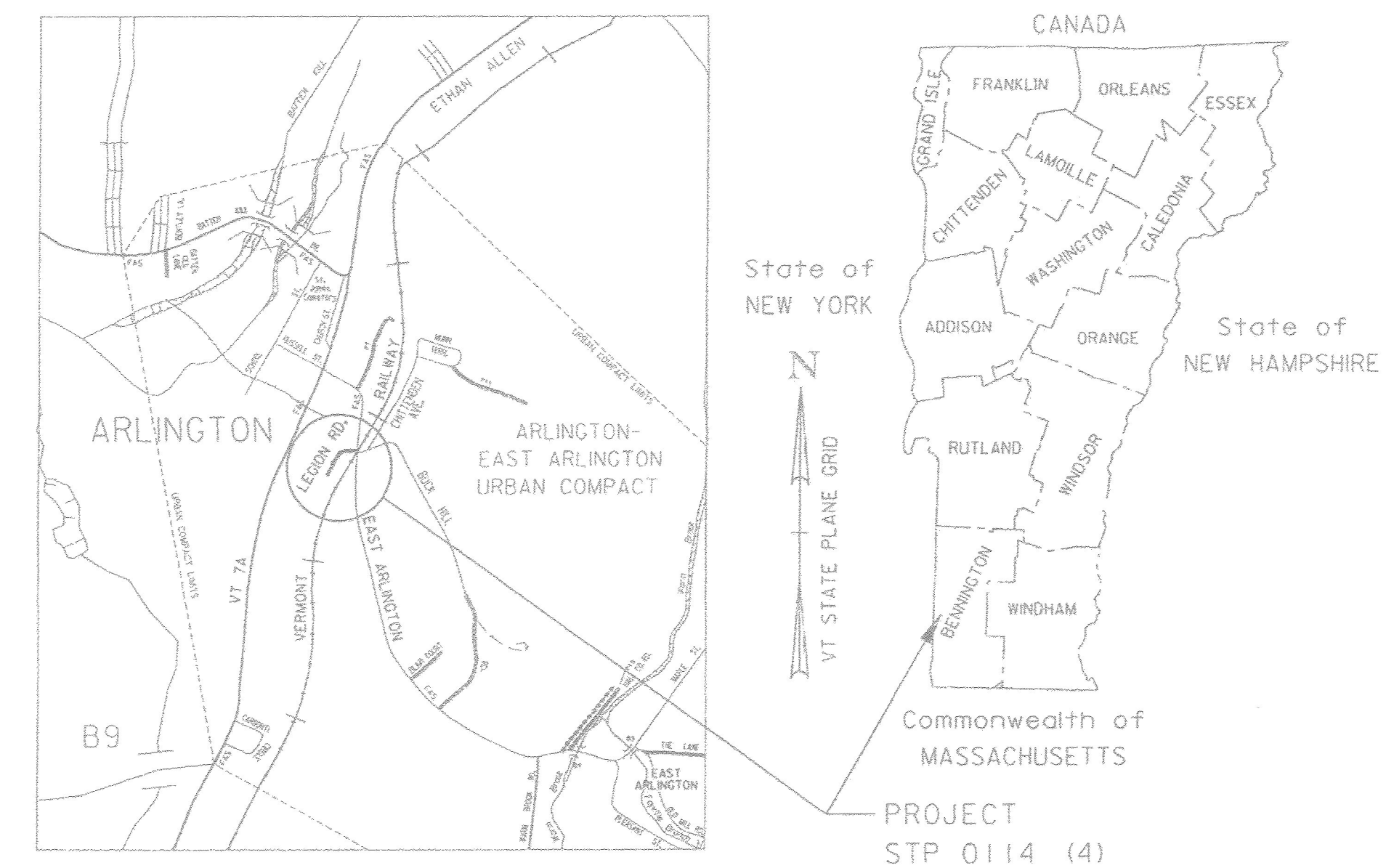

RECORD PLANS	
CONTRACTOR:	DELSIGNORE BLACKTOP PAVING, INC. - TROY, NY
RESIDENT ENGINEER:	RON LEMAIRE
CONSTRUCTION BEGAN:	JULY 25, 2016
CONSTRUCTION COMPLETE:	SEPTEMBER 12, 2016
RECORD PLANS BY:	RON LEMAIRE & AARON WEAVER
I HEREBY CERTIFY THAT ALL THE CONSTRUCTION REQUIRED BY THIS SET OF DRAWINGS HAS BEEN ACCOMPLISHED AS INDICATED HEREIN.	
<i>Ron Lemaire</i> FOR: RESIDENT ENGINEER	DATE May 29, 2018
NOTE: Any further information concerning final quantities, amounts or other details relative to this project may be found at Central Files in the electronic archives.	

E. ARLINGTON RD.: BEGINNING AT A POINT ON E. ARLINGTON RD. SAID POINT BEING APPROXIMATELY 1000 ft SOUTHEASTERLY FROM ITS INTERSECTION WITH STATE ROUTE 7A AND EXTENDING SOUTHEASTERLY TO INCLUDE GRADE CROSSING 851-184B.
 LEGION RD. RELOCATED: BEGINNING AT A POINT ON LEGION ROAD RELOCATED 7.00 ft WESTERLY OF ITS INTERSECTION WITH EAST ARLINGTON ROAD AND EXTENDING SOUTHWESTERLY 243.00 ft.
 WORK TO BE PERFORMED UNDER THIS PROJECT WILL INCLUDE THE RELOCATION OF EXISTING LEGION ROAD AND THE RECONSTRUCTION OF EAST ARLINGTON ROAD RR CROSSING SIGNAL SYSTEM INCLUDING NEW SIGNALS, PAVEMENT MARKINGS, AND SIGNAGE.

TRAFFIC DATA

RAILROAD:
 PASSENGER DESIGN SPEED = 30 MPH
 FREIGHT DESIGN SPEED = 25 MPH

LEGION ROAD:
 DESIGN SPEED = 15 MPH (ASSUMED)
 AADT= NO DATA AVAILABLE
 ASSUMED < 100

E. ARLINGTON ROAD:
 DESIGN SPEED = 25 MPH (POSTED)
 AADT (2011) = 2200 E

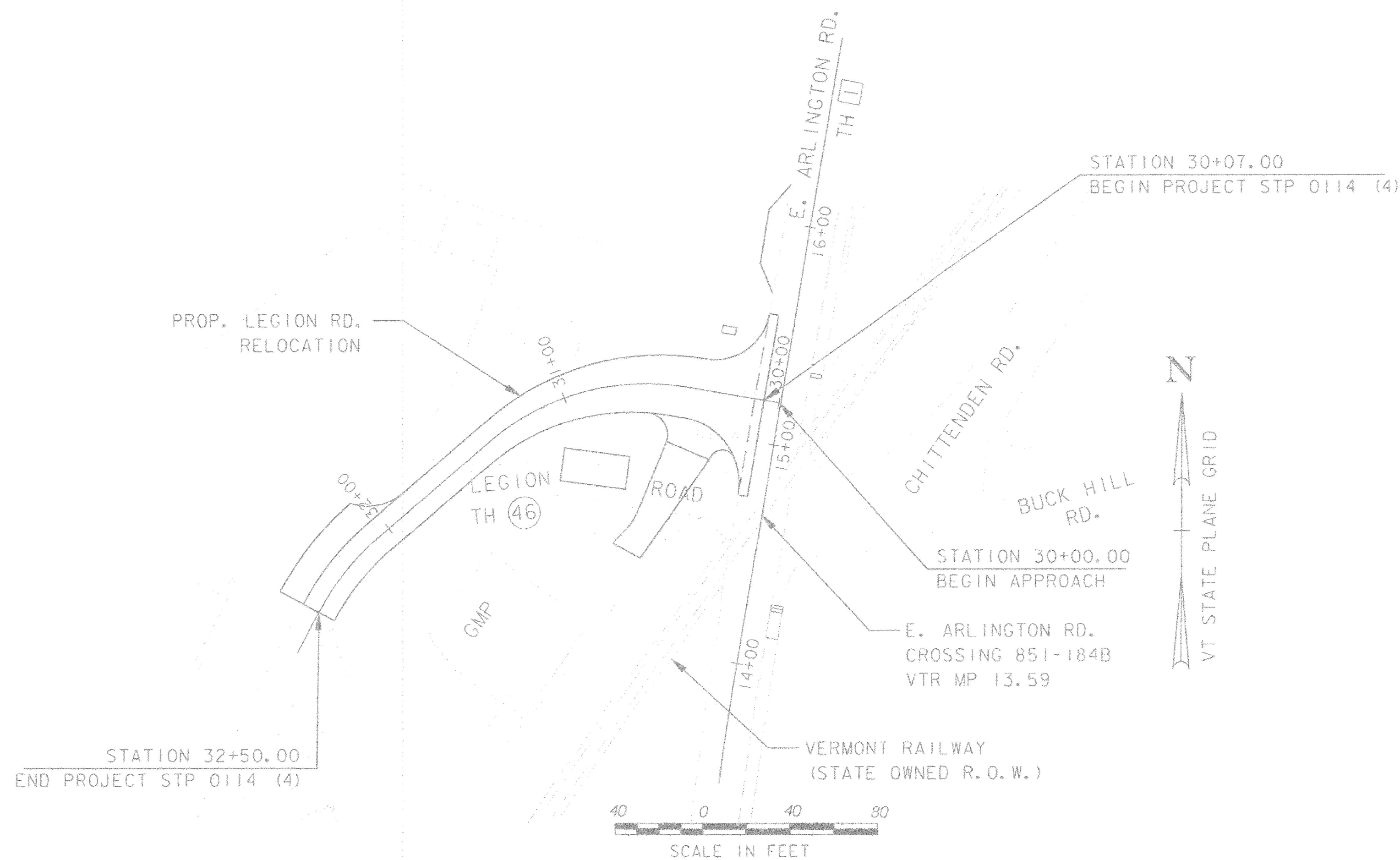

THESE PLANS ARE SUBJECT TO SUCH ENGINEERING CHANGES AS MAY BE REQUIRED BY THE FEDERAL HIGHWAY ADMINISTRATION OR THE DIRECTOR OF PROGRAM DEVELOPMENT.

CONSTRUCTION IS TO BE CARRIED ON IN ACCORDANCE WITH THESE PLANS AND THE STANDARD SPECIFICATIONS FOR CONSTRUCTION DATED 2011, AS APPROVED BY THE FEDERAL HIGHWAY ADMINISTRATION ON JULY 20, 2011 FOR USE ON THIS PROJECT, INCLUDING ALL SUBSEQUENT REVISIONS AND SUCH REVISED SPECIFICATIONS AND SPECIAL PROVISIONS AS ARE INCORPORATED IN THESE PLANS.

QUALITY ASSURANCE PROGRAM : LEVEL 3

SURVEYED BY : VTRANS
 SURVEYED DATE : JAN. 2004

DATUM
 VERTICAL NAVD 88
 HORIZONTAL NAD 83 (96)

Note:
 ROW sheets 26 and 27 of this plan set have been prepared by Stantec, South Burlington, Vermont.

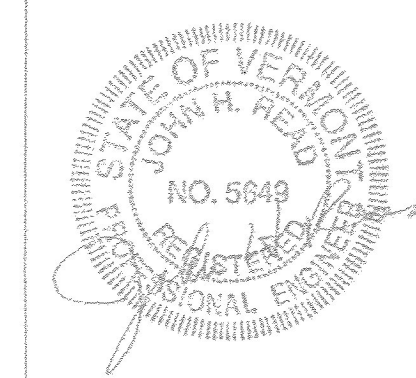

RAIL PROGRAM DIRECTOR	
APPROVED <i>[Signature]</i>	DATE 2/9/16
PROJECT MANAGER : KYLE WELLS	
PROJECT NAME : ARLINGTON	
PROJECT NUMBER : STP 0114 (4)	
SHEET 1 OF 27 SHEETS	