

UPPER CHORD PANEL POINTS U12 & U16
 (DETAILS FOR U12 ARE SHOWN)
 (DETAILS FOR U16 ARE OPP. HAND)
 INSIDE & OUTER ELEVATION FOR TRUSS T1 & T2 ARE IDENTICAL
 (LOOKING NORTH)

- NO EXCEPTION TAKEN
- REJECTED
- MAKE CORRECTIONS NOTED
- REVISE AND RESUBMIT
- SUBMIT SPECIFIED ITEM

CHECKING IS ONLY FOR THE GENERAL CONFORMANCE WITH THE DESIGN CONCEPT OF THE PROJECT AND GENERAL COMPLIANCE WITH THE INFORMATION GIVEN IN THE CONTRACT DOCUMENTS. ANY ACTION SHOWN IS SUBJECT TO THE REQUIREMENTS OF THE PLANS AND SPECIFICATIONS. CONTRACTOR IS RESPONSIBLE FOR DIMENSIONS WHICH SHALL BE CONFIRMED AND CORRELATED AT THE JOB SITE; FABRICATION PROCESSES AND TECHNIQUES OF CONSTRUCTION; COORDINATION OF HIS WORK WITH THAT OF ALL OTHER TRADES AND THE SATISFACTORY PERFORMANCE OF THE WORK.

** NOTE **
 THE PURPOSE OF THIS DRAWING IS TO COORDINATE GEOMETRIC CONTROL INFORMATION AND CONNECTION SPACING. THIS DWG IS SUBMITTED FOR INFORMATION ONLY & IS NOT INTENDED FOR SHOP FABRICATION. DETAIL DWGS WILL SHOW ALL WELDING AND DIMENSIONS REQ'D FOR FABRICATION.

DATE 1/29/2016 BY J. Najdowski

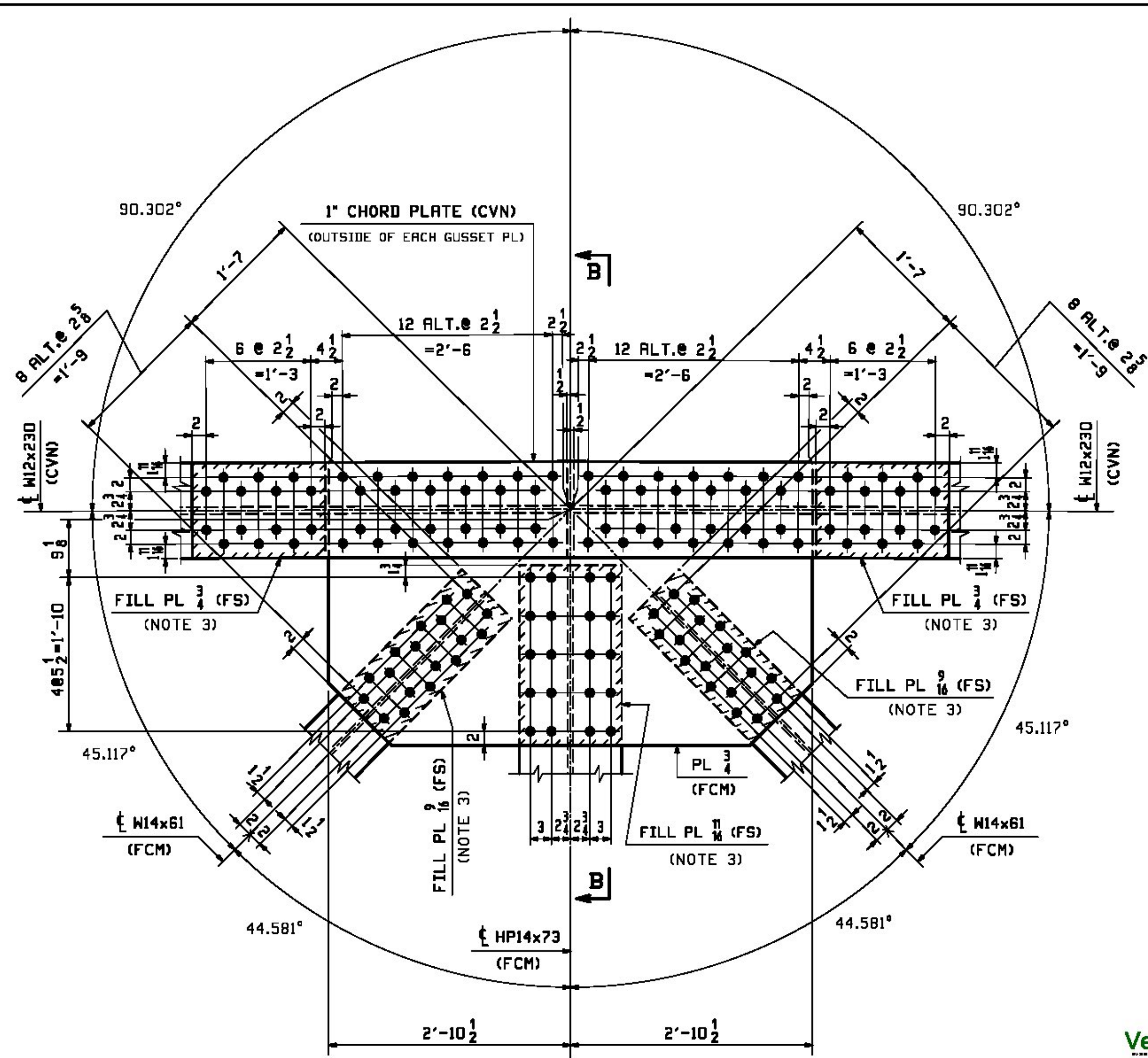

UPPER CHORD PANEL POINT U14
 INSIDE & OUTER ELEVATION FOR TRUSS T1 & T2 ARE IDENTICAL
 (LOOKING NORTH)

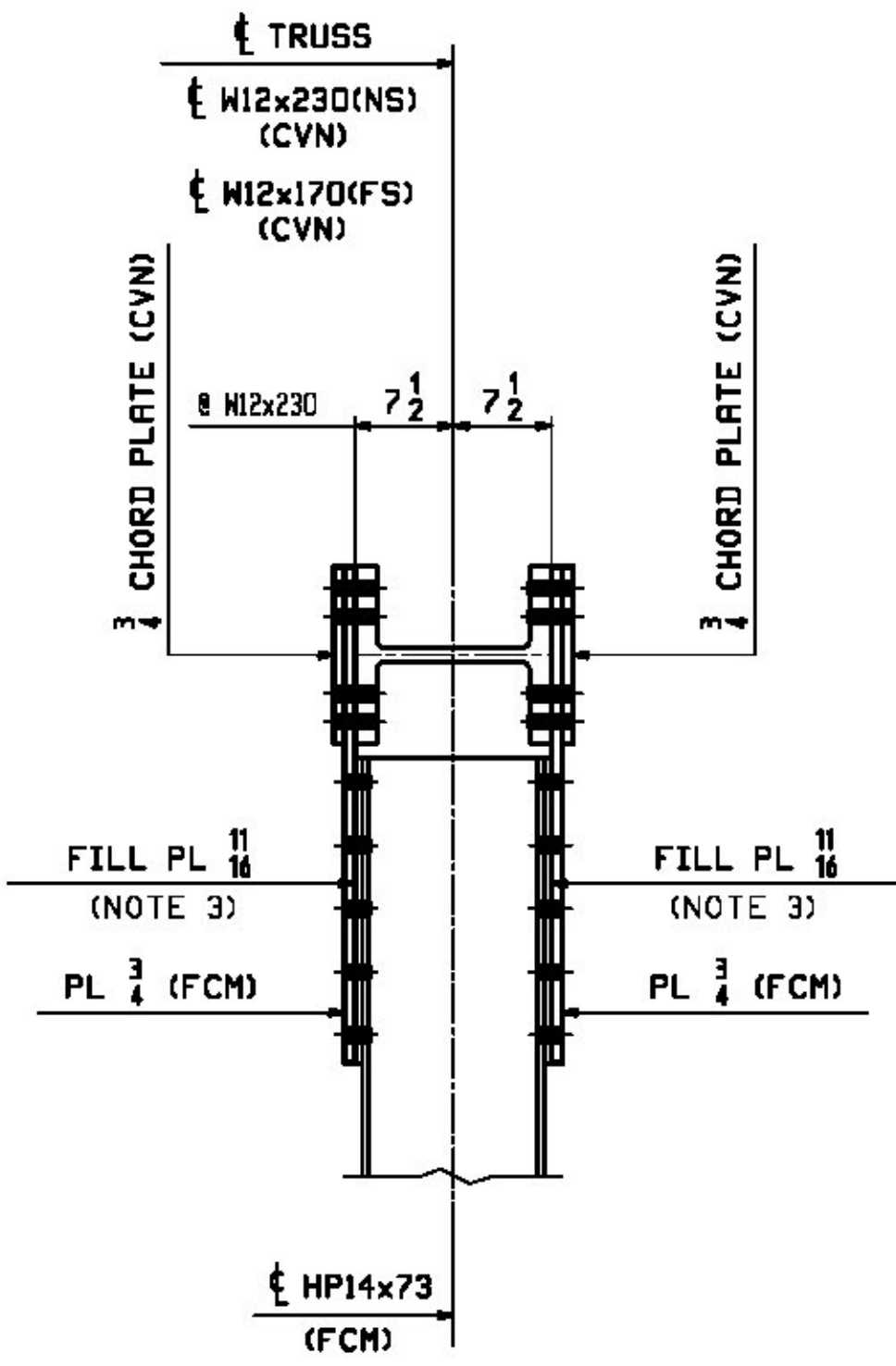

SECTION A-A

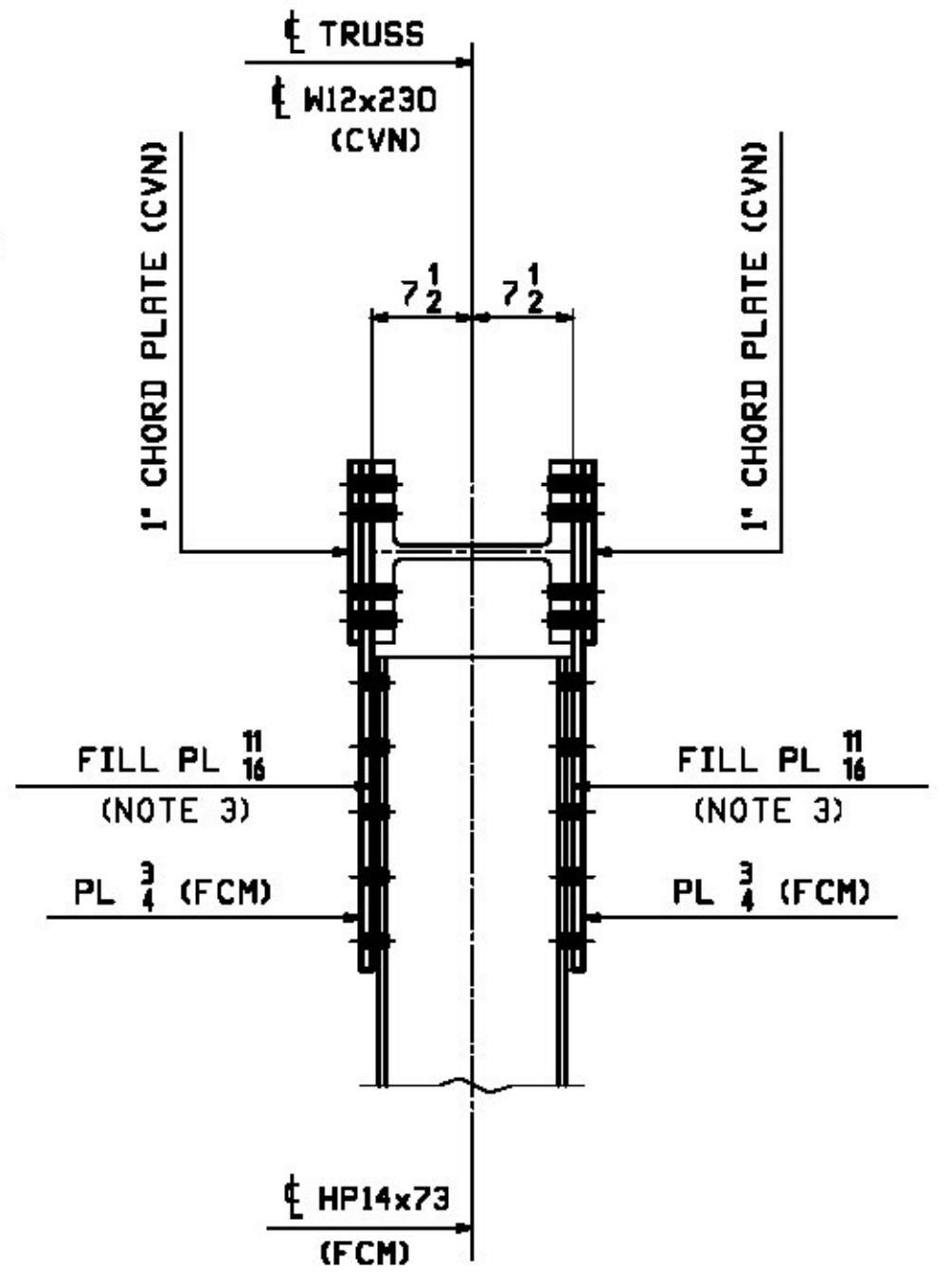

SECTION B-B

Vermont Agency of Transportation
RECEIVED
 ON: **March 21, 2016**
 and Checked for
CONFORMANCE
 BY: **ABC** DATE:

- NOTES:
- FCM INDICATES FRACTURE CRITICAL MATERIAL, CVN INDICATES CHARPY V-NOTCH TESTED MATERIAL. ALL STEEL (EXCEPT FOR BOLTS) SHALL BE HOT-DIP GALVANIZED AFTER FABRICATION.
 - BOLTS SHALL BE 7/8" A325-1 GALV. (UN). ALL BOLTS SHALL BE INSTALLED WITH HEADS EXPOSED TO PUBLIC VIEW WITH ONE HARDENED WASHER AND ONE DTI WASHER. BOLTS AND WASHERS SHALL BE MECHANICALLY GALVANIZED.
 - DUE TO ROLLING MILL TOLERANCE, THE ACTUAL THICKNESS OF FILL PLATES MAY VARY FROM WHAT IS SHOWN ON THIS DWG. THE SHOP WILL BE RESPONSIBLE FOR ADJUSTING FILL THICKNESS AS REQUIRED TO SUIT THE ACTUAL MATERIAL SIZE. FILL PLATES SHALL BE A SINGLE THICKNESS PLATE.

REV.	DATE	REMARKS	DWN	CHK	APVL	SHOP
0						
MATERIAL:		SURFACE PREP. & PAINT:		HOLES:		SHOP BOLTS:
M270-50 (UN)		HOT-DIP GALV.		7/8" (UN)		7/8" (UN)
DESCRIPTION: TRUSS LAYOUT @ U12, U14 & U16						
STRUCTURE: TH-10 OVER OTTER CREEK PONY TRUSS BRIDGE			DRAWN: RB		DATE: 10/5/15	
LOCATION: RUTLAND CITY, VERMONT			CHKD: WJL		DATE: 10/15/15	
PROJ NO. BR 3000 (19)			JOB NO. 598		DWG NO. TD7	
CUSTOMER: KUBRICKY CONSTRUCTION CORP.					REV.	

CASCO BAY STEEL STRUCTURES, INC.
 1 WALLACE AVE. PHONE (207) 780-6722
 SOUTH PORTLAND, ME 04106 FAX. (207) 780-6726