

PROJECT DESCRIPTION : CONSTRUCT NEW TWO SPAN GIRDER BRIDGE ON THE NORTH SIDE OF THE EXISTING TWO SPAN TRUSS BRIDGE. TH-8 REQUIRES REALIGNMENT AND ROADWORK RELATIVE TO THE BRIDGE, TH-10 REQUIRES REALIGNMENT AND ROADWORK. EXISTING BRIDGE WILL BE REMOVED AFTER PROPOSED BRIDGE IS CONSTRUCTED.

UTILITY REPLACEMENT WORK INCLUDES NEW WATER AND SEWER INSTALLATION ALONG WITH PUMP STATION MODIFICATIONS.

INDEX OF SHEETS

| | |
|-------|---------------------------------------|
| 0 | TITLE SHEET |
| 1-2 | WATER / SEWER NOTES |
| 3 | DORR DRIVE PUMP STATION NOTES |
| 4 | DORR DRIVE PUMP STATION ORIGINAL PLAN |
| 5-9 | WATER / SEWER DETAILS |
| 10-13 | WATER / SEWER LAYOUTS |
| 14 | DORR DRIVE PUMP STATION PLAN |
| 15-18 | WATER PROFILES |
| 19-22 | SEWER PROFILES |

STATE OF VERMONT AGENCY OF TRANSPORTATION



PROPOSED IMPROVEMENT

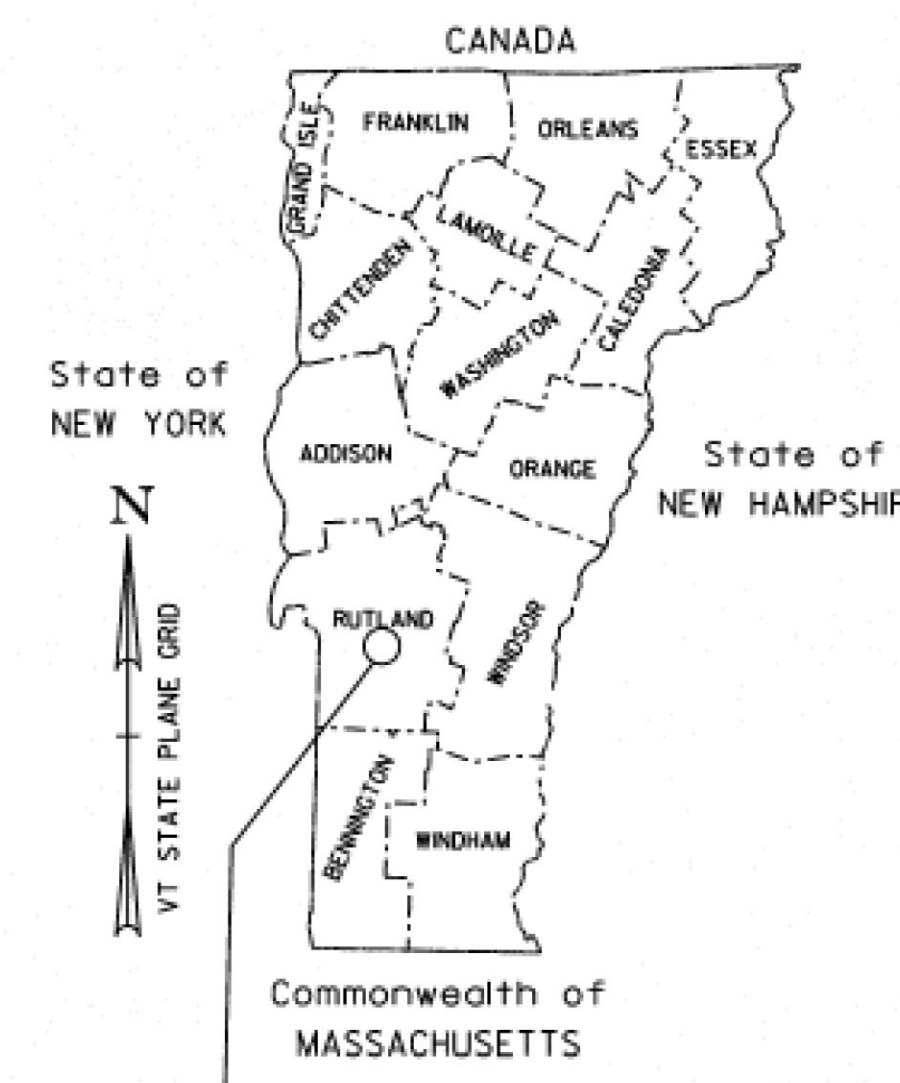
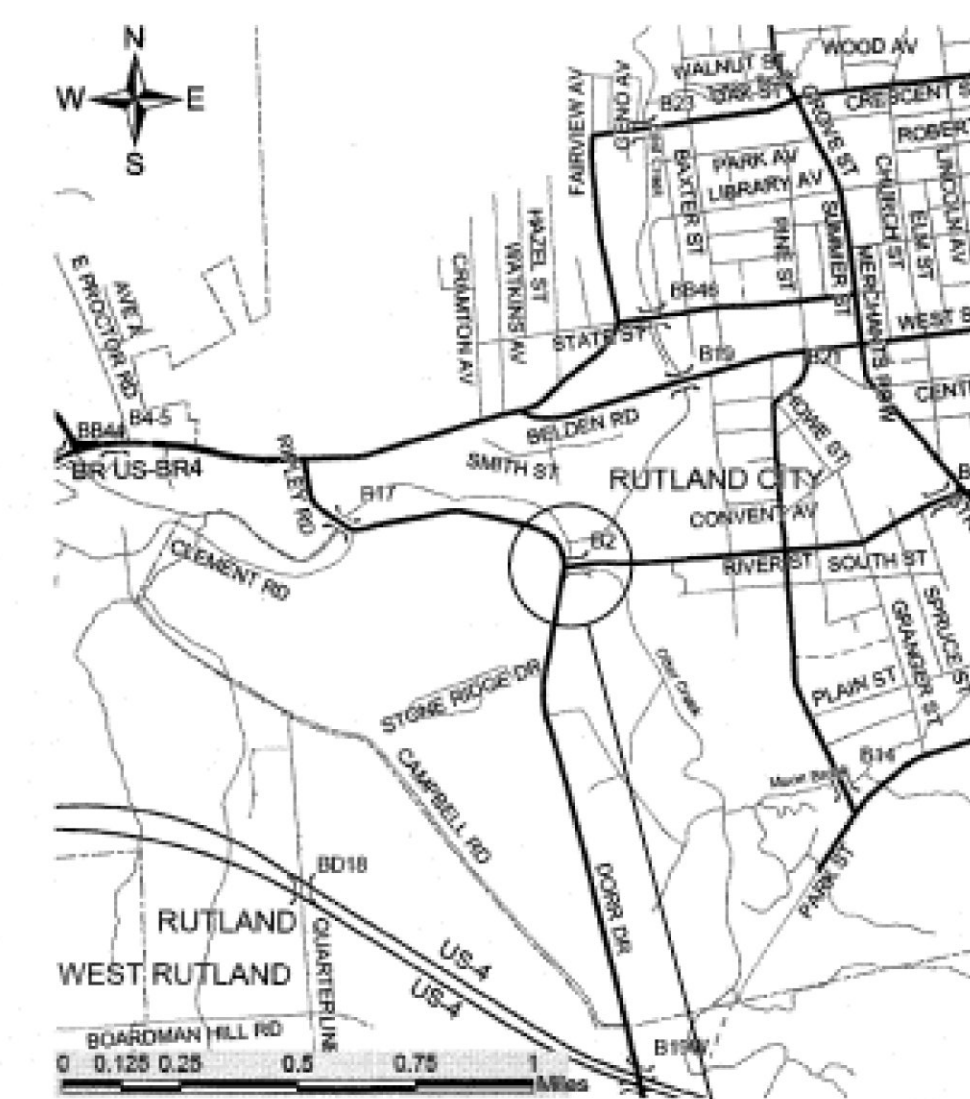

CITY OF RUTLAND
COUNTY OF RUTLAND

ROUTE NO : TH-8 (RIVER STREET) Urban Collector - FAU 3052
TH-10 (DORR DRIVE) Urban Collector- FAU 3008
BRIDGE NO : 2 (TH-8)

BEGINNING AT THE INTERSECTION OF DORR DR (TH-10) AND RIVER ST (TH-8) AND EXTENDING EASTERLY ALONG RIVER ST (TH-8), 0.15 MILES.

BEGINNING ON DORR DR (TH-10) AT A POINT 0.06 MILES NORTH OF THE INTERSECTION OF RIVER ST (TH-8) AND DORR DR (TH-10) AND EXTENDING SOUTHERLY ALONG DORR DR 0.11 MILES

LENGTH OF STRUCTURE : TH-8 = 278.65 FT
LENGTH OF ROADWAY : TH-8 = 521.35 FT + TH-10 = 566 FT
LENGTH OF PROJECT : = 1,366 FT

**WATER & SEWER
REPLACEMENT
PLAN SUBSET**

~~6/17/2014~~

NOTE:
THIS COVER SHEET USED TO SHOW PROJECT LOCUS.

RECORD PLANS

**WATER & SEWER
REPLACEMENT
PLAN SUBSET**

FEBRUARY 2016

GENERAL CONTRACTOR - KUBRICKY CONSTRUCTION CORP.
UTILITY CONTRACTOR - CHAMPLAIN CONSTRUCTION
RESIDENT ENGINEER - STANTEC

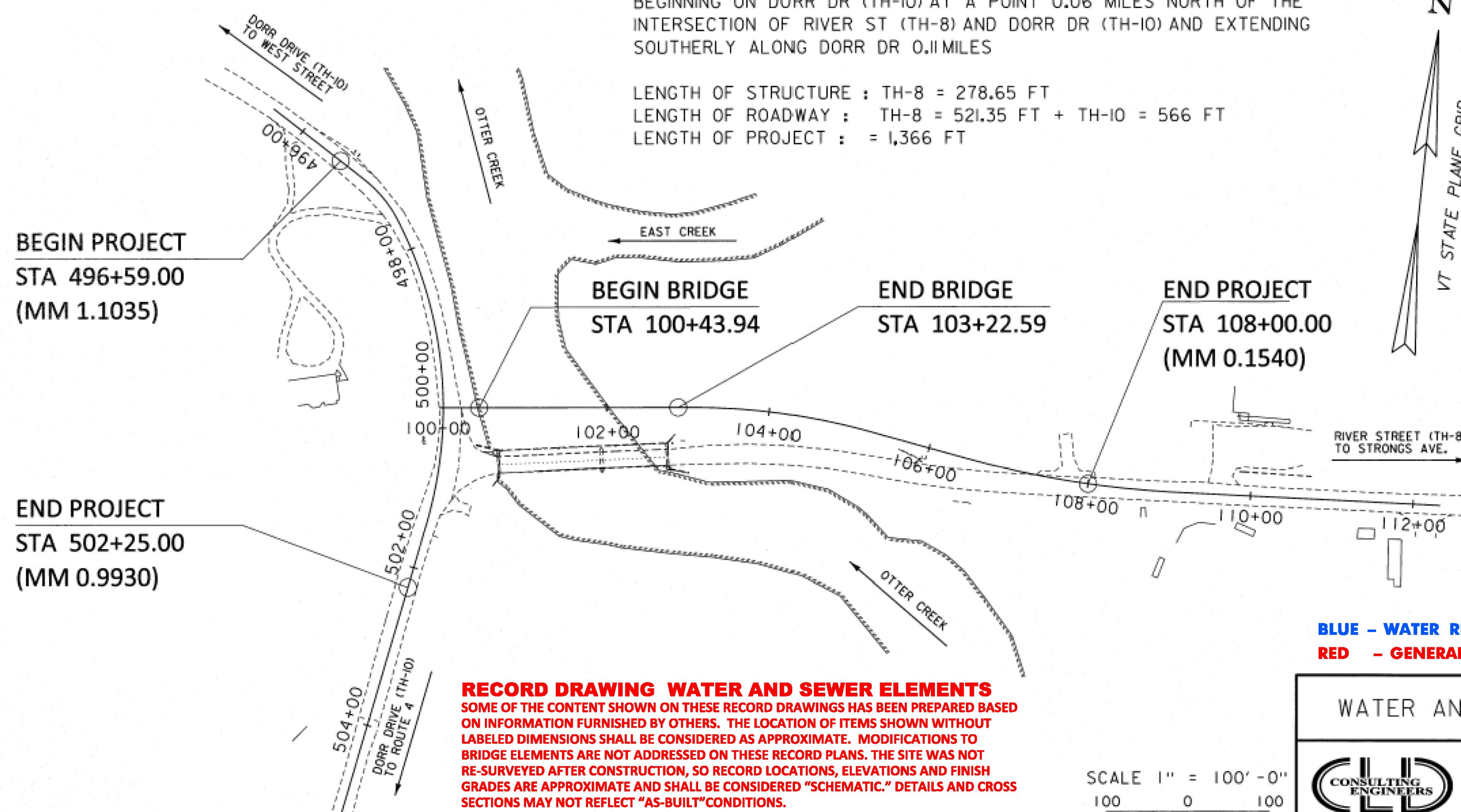

THESE PLANS ARE SUBJECT TO SUCH ENGINEERING CHANGES AS MAY BE REQUIRED BY THE FEDERAL HIGHWAY ADMINISTRATION OR THE DIRECTOR OF PROGRAM DEVELOPMENT.
CONSTRUCTION IS TO BE CARRIED ON IN ACCORDANCE WITH THESE PLANS AND THE STANDARD SPECIFICATIONS FOR CONSTRUCTION DATED 2011, AS APPROVED BY THE FEDERAL HIGHWAY ADMINISTRATION ON JULY 20, 2011 FOR USE ON THIS PROJECT, INCLUDING ALL SUBSEQUENT REVISIONS AND SUCH REVISED SPECIFICATIONS AND SPECIAL PROVISIONS AS ARE INCORPORATED IN THESE PLANS.

| | |
|-----------------------------------|-------------|
| QUALITY ASSURANCE PROGRAM : LEVEL | |
| SURVEYED BY : L. ORVIS | |
| SURVEYED DATE : MARCH 2000 | |
| DATUM | |
| VERTICAL | NAVD 88 |
| HORIZONTAL | NAD 83 (92) |

RECORD DRAWING WATER AND SEWER ELEMENTS
SOME OF THE CONTENT SHOWN ON THESE RECORD DRAWINGS HAS BEEN PREPARED BASED ON INFORMATION FURNISHED BY OTHERS. THE LOCATION OF ITEMS SHOWN WITHOUT LABELED DIMENSIONS SHALL BE CONSIDERED AS APPROXIMATE. MODIFICATIONS TO BRIDGE ELEMENTS ARE NOT ADDRESSED ON THESE RECORD PLANS. THE SITE WAS NOT RE-SURVEYED AFTER CONSTRUCTION, SO RECORD LOCATIONS, ELEVATIONS AND FINISH GRADES ARE APPROXIMATE AND SHALL BE CONSIDERED "SCHEMATIC." DETAILS AND CROSS SECTIONS MAY NOT REFLECT "AS-BUILT" CONDITIONS.

BLUE - WATER RECORD REVISIONS
RED - GENERAL AND SEWER REVISIONS

WATER AND SEWER PLANS

540 Commercial Street, Manchester, NH 03101
(603) 668-8223 • Fax: (603) 668-8802
cld@cdengineers.com • www.cdengineers.com
Maine • New Hampshire • Vermont

- ④ RECORD CHANGES CLOUD
- ① PLAN REVISIONS
5/23/14: REVISIONS TO ADDRESS
DEC 5/9/14 COMMENTS.

| | |
|-----------------------------------|------------|
| DIRECTOR OF PROGRAM DEVELOPMENT | |
| APPROVED _____ | DATE _____ |
| PROJECT MANAGER : CAROLYN CARLSON | |
| PROJECT NAME : RUTLAND CITY | |
| PROJECT NUMBER : BRF 3000 (16) | |
| SHEET 0 OF 22 SHEETS | |

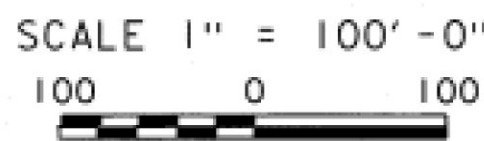

MODEL: TITLE
CLD 13-0126