

PROJECT DESCRIPTION : CONSTRUCT NEW TWO SPAN GIRDER BRIDGE ON THE NORTH SIDE OF THE EXISTING TWO SPAN TRUSS BRIDGE. TH-8 REQUIRES REALIGNMENT AND ROADWORK RELATIVE TO THE BRIDGE, TH-10 REQUIRES REALIGNMENT AND ROADWORK. EXISTING BRIDGE WILL BE REMOVED AFTER PROPOSED BRIDGE IS CONSTRUCTED.

STATE OF VERMONT AGENCY OF TRANSPORTATION

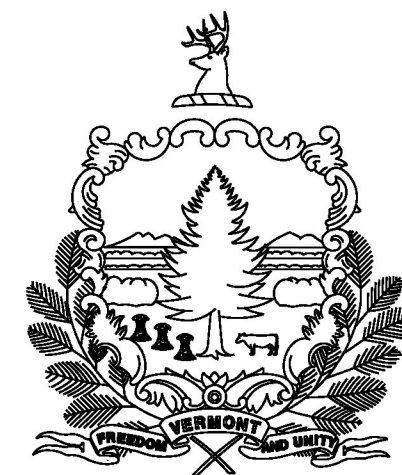

PROPOSED IMPROVEMENT BRIDGE PROJECT

CITY OF RUTLAND
COUNTY OF RUTLAND

ROUTE NO : TH 8 (RIVER STREET) Urban Collector - FAU 3052
TH 10 (DORR DRIVE) Urban Collector- FAU 3008
BRIDGE NO : 2 (TH 8)

BEGINNING AT THE INTERSECTION OF DORR DR (TH 10) AND RIVER ST (TH 8) AND EXTENDING EASTERLY ALONG RIVER ST (TH 8), 0.15 MILES.

BEGINNING ON DORR DR (TH 10) AT A POINT 0.06 MILES NORTH OF THE INTERSECTION OF RIVER ST (TH 8) AND DORR DR (TH 10) AND EXTENDING SOUTHERLY ALONG DORR DR 0.11 MILES

LENGTH OF STRUCTURE : TH-8 = 279.45 FT
LENGTH OF ROADWAY : TH-8 = 520.55 FT + TH-10 = 566 FT
LENGTH OF PROJECT : = 1,366 FT

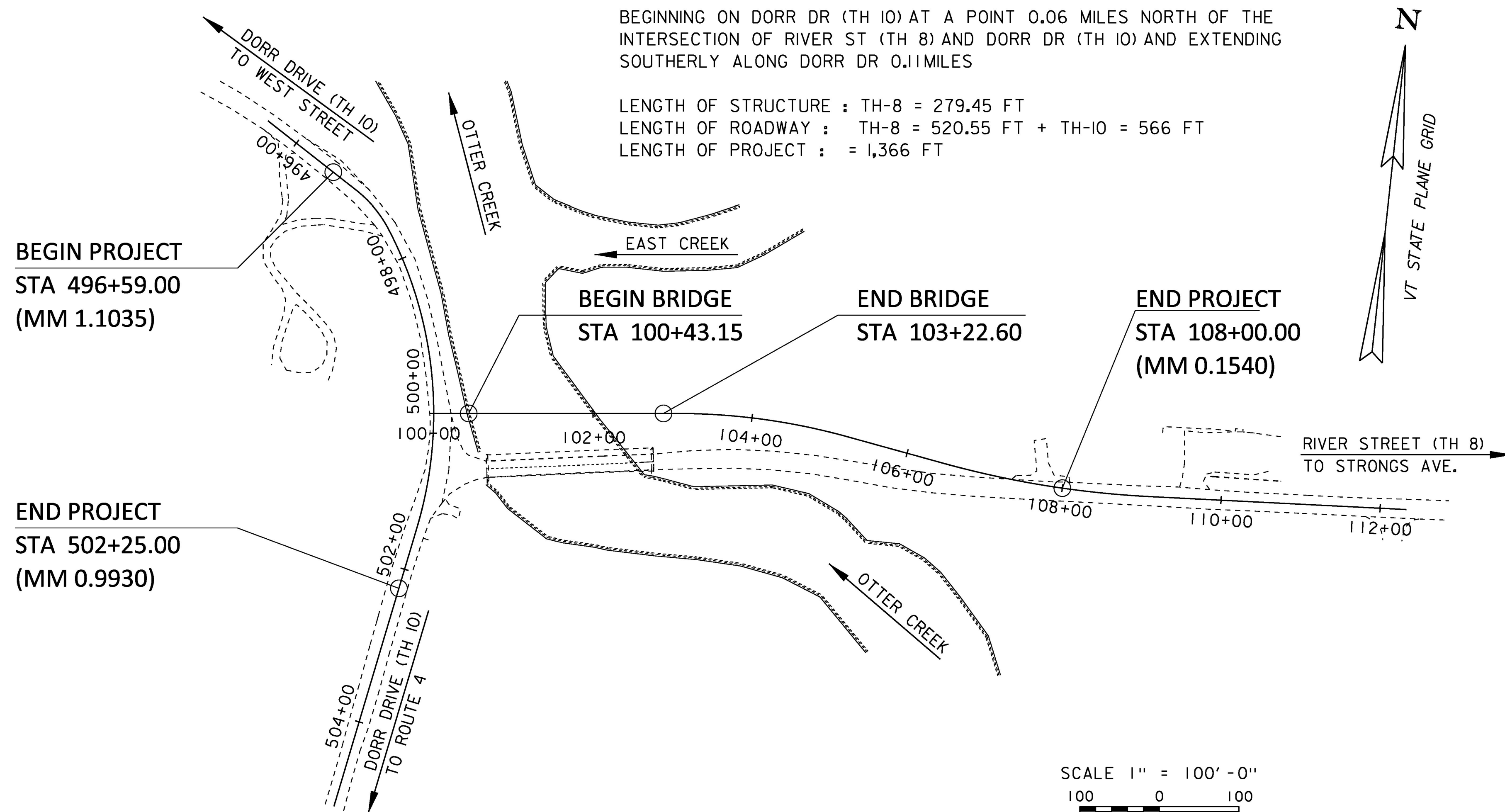
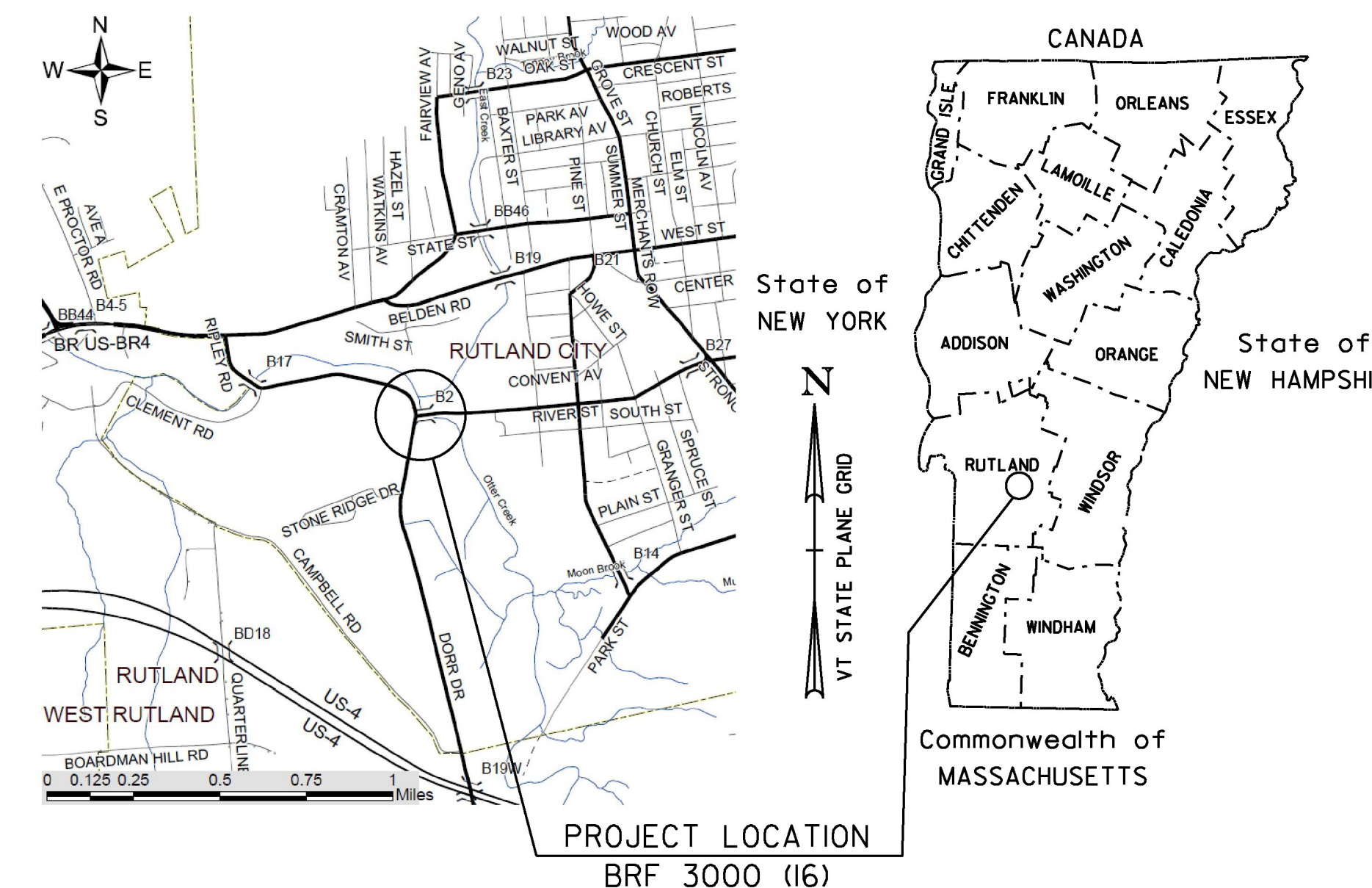

CONSTRUCTION IS TO BE CARRIED ON IN ACCORDANCE WITH THESE PLANS AND THE STANDARD SPECIFICATIONS FOR CONSTRUCTION DATED 2011, AS APPROVED BY THE FEDERAL HIGHWAY ADMINISTRATION ON JULY 20, 2011 FOR USE ON THIS PROJECT, INCLUDING ALL SUBSEQUENT REVISIONS AND SUCH REVISED SPECIFICATIONS AND SPECIAL PROVISIONS AS ARE INCORPORATED IN THESE PLANS.

QUALITY ASSURANCE PROGRAM : LEVEL 2

SURVEYED BY : L. ORVIS
SURVEYED DATE : MARCH 2000

DATUM
VERTICAL NAVD 88
HORIZONTAL NAD 83 (92)

PROJECT MANAGER : CAROLYN CARLSON

PROJECT NAME : RUTLAND CITY
PROJECT NUMBER : BRF 3000 (16)

SHEET 122 OF 245 SHEETS