

13+50

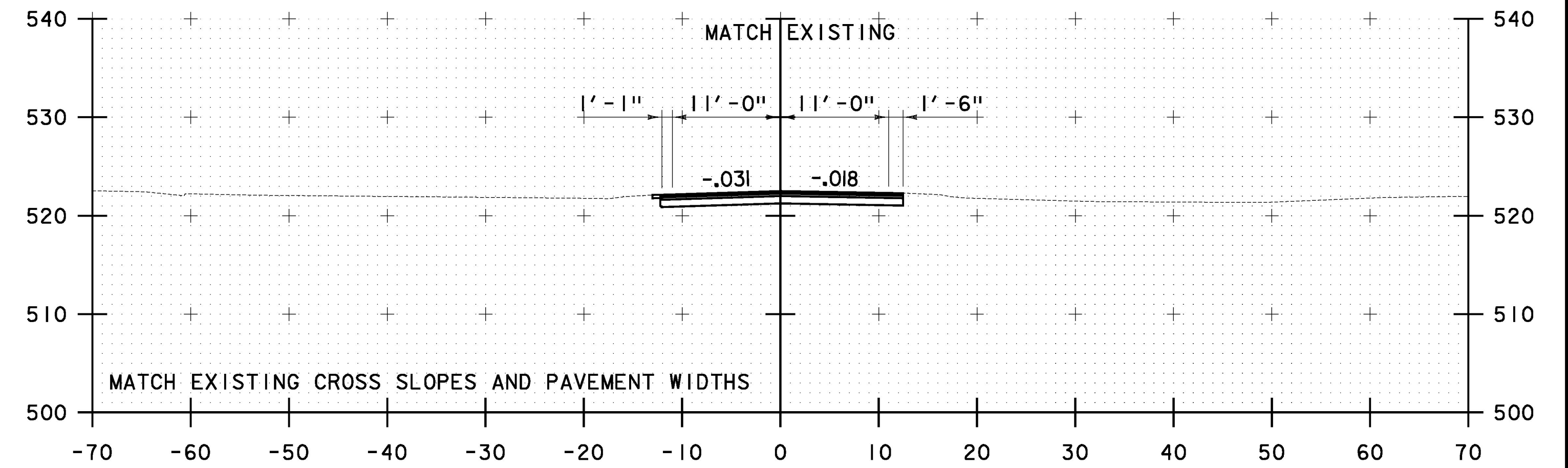

14+50

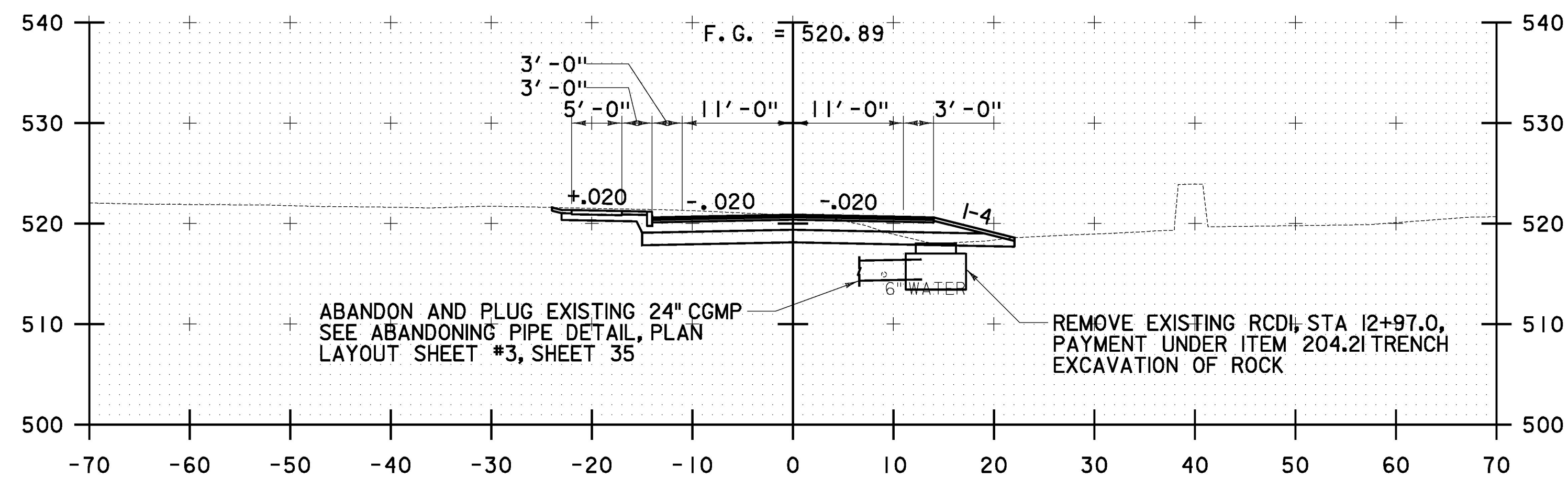

13+00

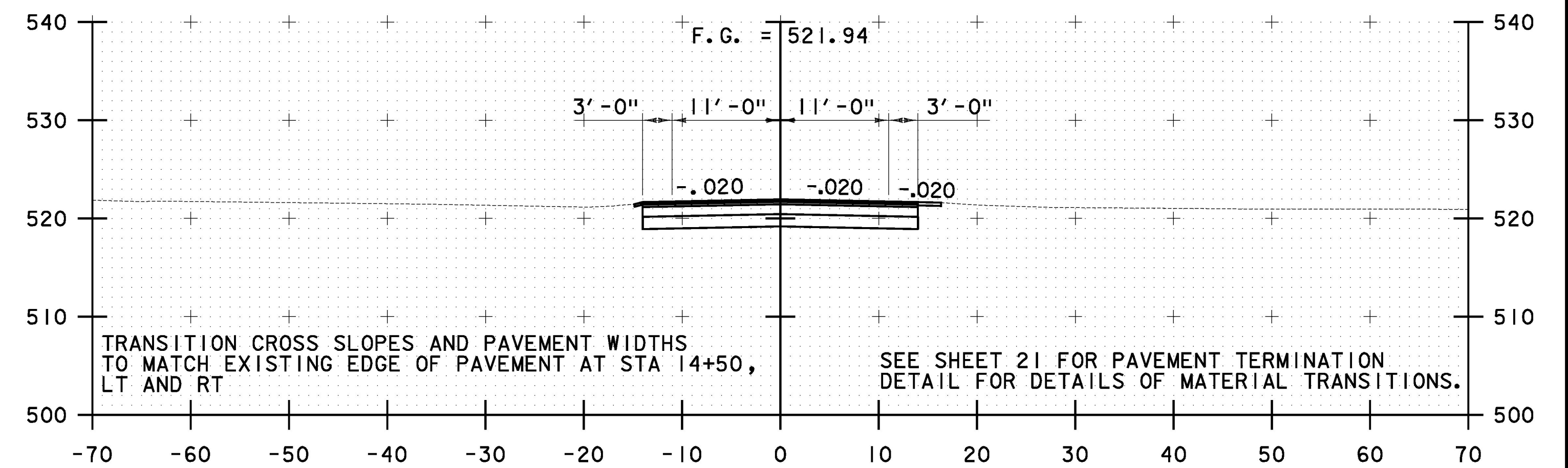

14+00

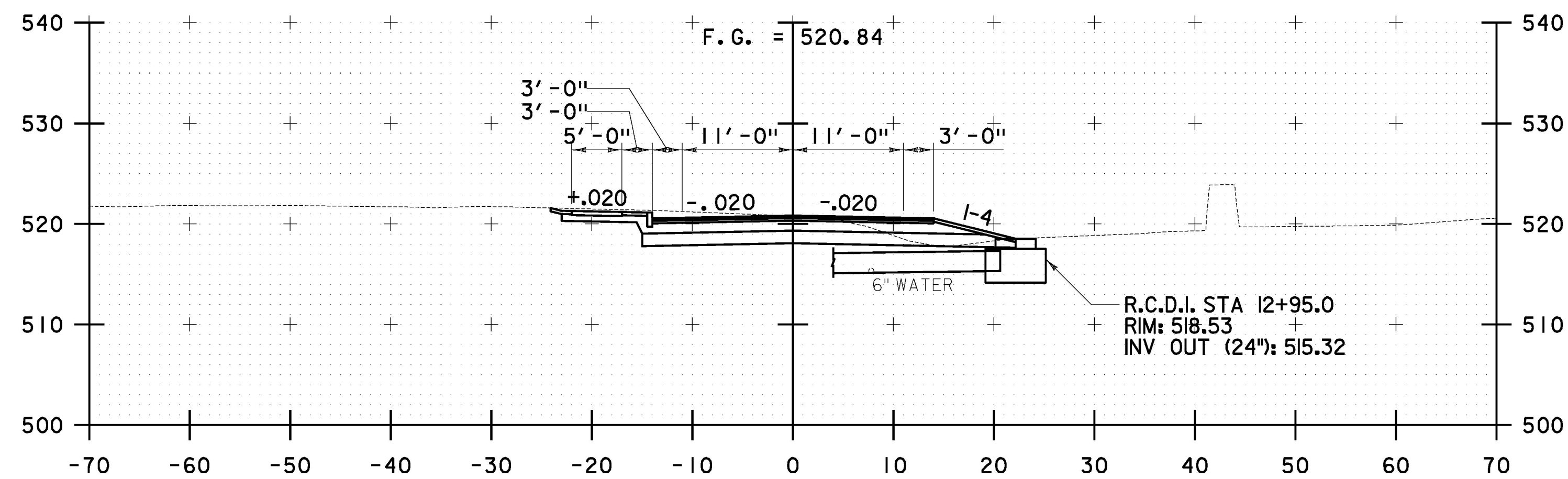

12+95

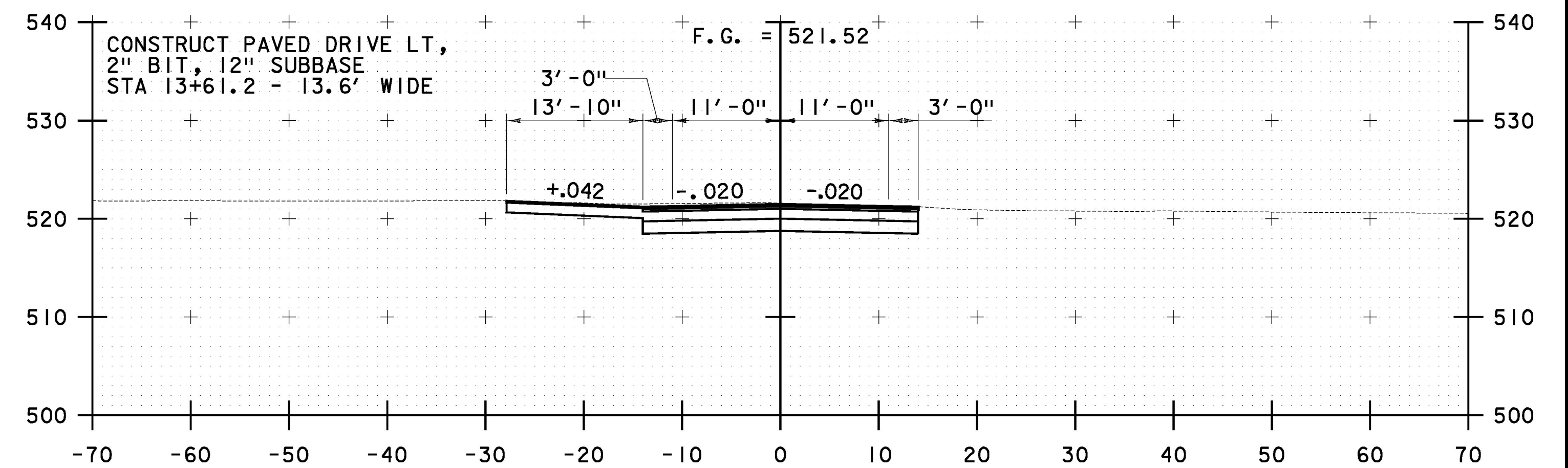

13+60

**NOTE:**

- I. EXISTING UTILITIES INCLUDING WATER, SANITARY SEWER AND STORM SEWER PIPES ARE SHOWN IN THEIR APPROXIMATE LOCATIONS. THE CONTRACTOR IS RESPONSIBLE FOR CONFIRMING THE LOCATIONS OF ALL UTILITIES AT LEAST 48 HOURS PRIOR TO COMMENCING EXCAVATION OPERATIONS BY CONTACTING "DIG SAFE" AT (888) 344-7233.



SCALE IN FEET



STA. 12+95 TO STA. 14+50

|  |                               |                      |
|--|-------------------------------|----------------------|
| <b>TH 10<br/>CROSS<br/>SECTIONS #8</b> | PROJECT NAME: RUTLAND CITY    | PLOT DATE: 6/30/2014 |
|  | PROJECT NUMBER: BRF 3000 (I9) |                      |
|  | PROJECT LEADER: M.D.S.        | CHECKED BY: D.E.G.   |
|  | DESIGNED BY: C.R.H.           | SHEET 88 OF 245      |
|  | DWG. NO.: THIOXS-8            |                      |

FILE NAME = W:\P\c\seas\ANY\K2\2015\CADD\WSTN\08\096\ecmsul\anta\208\096\8x8.dgn  
 DATE/TIME = 6/30/2014 4:49:16  
 USER =