

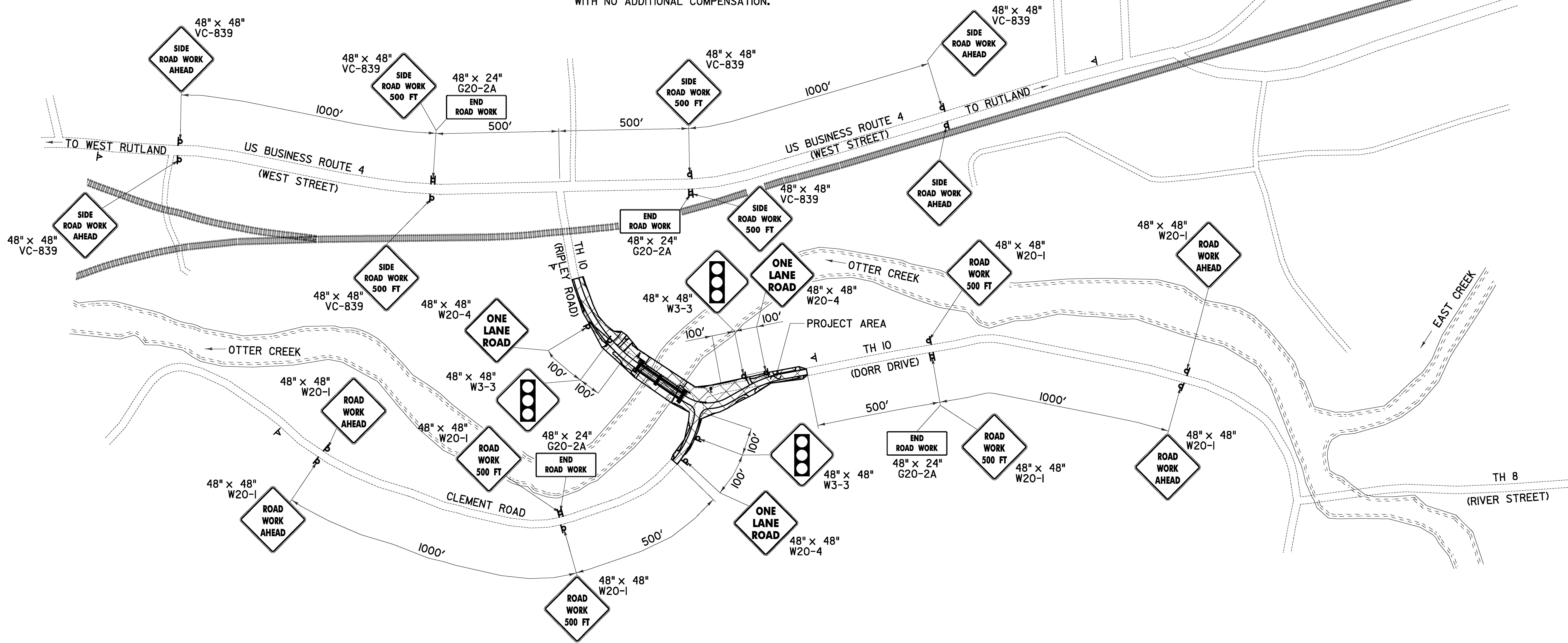

NOTES:

1. ALL DISTANCES SHOWN ARE DESIRABLE MINIMUMS. FIELD CONDITIONS SHALL CONTROL THE ACTUAL PLACEMENT OF CONSTRUCTION SIGNS. SEE VTRANS' STD. T-10 FOR ADDITIONAL SIGN PLACEMENT DETAILS. PROPOSED CONSTRUCTION SIGNS SHALL NOT INTERFERE WITH THE SIGHT LINES TO EXISTING SIGNS. PROPOSED SIGNS SHALL BE LOCATED A MINIMUM OF 100 FEET FROM THE NEAREST EXISTING OR PROPOSED SIGN. EXACT SIGN LOCATIONS SHALL BE APPROVED BY THE ENGINEER.
2. SEE TEMPORARY TRAFFIC SIGNAL PLAN, SHEET 42, FOR FURTHER DETAILS WITHIN THE PROJECT AREA.
3. CONSTRUCTION SIGNING AND ALL TEMPORARY TRAFFIC CONTROL MEASURES SHALL BE IN ACCORDANCE WITH SECTION 6 OF THE LATEST EDITION OF THE MANUAL ON UNIFORM TRAFFIC CONTROL DEVICES (MUTCD).
4. CONSTRUCTION SIGNS SHALL BE IN NEW OR LIKE NEW CONDITION PER VTRANS' STANDARDS.
5. CONSTRUCTION SIGNS SHALL BE OF THE SIZES SHOWN ON THE PLAN WITH BLACK LEGENDS ON FLUORESCENT ORANGE BACKGROUNDS. LEAD SIGN (W20-1) SHALL BE ASTM D4956 TYPE VIII FLUORESCENT ORANGE SHEET.
6. PAYMENT FOR THE INSTALLATION, MAINTENANCE, AND REMOVAL OF ALL CONSTRUCTION SIGNING WILL BE MADE UNDER ITEM 900.645 SPECIAL PROVISION (TRAFFIC CONTROL, ALL INCLUSIVE) (BR 17).
7. ALL SIGN STANDS AND POST INSTALLATIONS SHALL BE NATIONAL COOPERATIVE HIGHWAY RESEARCH PROGRAM REPORT (NCHRP) 350 COMPLIANT.
8. THE CONTRACTOR SHALL COVER OR REMOVE ANY SIGNS THAT CONTRADICT TEMPORARY TRAFFIC CONTROL SIGNS. ALL SIGNS REMOVED OR COVERED BY THE CONTRACTOR SHALL BE REPLACED OR UNCOVERED BY THE CONTRACTOR WHEN THE TRAFFIC CONTROL PLAN IS DISASSEMBLED. PAYMENT FOR THIS WORK SHALL BE CONSIDERED INCIDENTAL TO ITEM 900.645 SPECIAL PROVISION (TRAFFIC CONTROL, ALL INCLUSIVE) (BR 17). ANY DAMAGE TO EXISTING SIGNS BY THE CONTRACTOR SHALL BE REPLACED BY THE CONTRACTOR WITH NO ADDITIONAL COMPENSATION.
9. W3-3 AND W20-4 SIGNS ARE ASSOCIATED WITH THE TEMPORARY TRAFFIC SIGNAL. THEY SHALL BE INSTALLED UPON PROJECT MOBILIZATION AND MAY BE REMOVED ONCE THE TEMPORARY TRAFFIC SIGNAL HAS BEEN REMOVED FROM SERVICE OR AT THE DIRECTION OF THE ENGINEER. SIGN LOCATIONS ARE REFERENCED FROM THE STOP BAR FOR THE TEMPORARY TRAFFIC SIGNAL. SHOULD ANY OF THE STOP BARS BE RELOCATED, THE W3-3 AND W20-4 SIGNS FOR THAT APPROACH SHALL BE RELOCATED TO THE RELATIVE LOCATION SHOWN ON THIS SHEET. SEE TEMPORARY TRAFFIC SIGNAL PLAN, SHEET 42, FOR FURTHER DETAILS.
10. THE CONTRACTOR SHALL SUBMIT SITE SPECIFIC TRAFFIC CONTROL PLANS FOR ALL PHASES OF WORK TO BE APPROVED BY THE ENGINEER. THIS WORK SHALL BE INCLUDED UNDER ITEM 900.645 SPECIAL PROVISION (TRAFFIC CONTROL, ALL INCLUSIVE) (BR 17). THESE TRAFFIC CONTROL PLANS SHALL BE USED BY THE CONTRACTOR THROUGHOUT THE DURATION OF THE PROJECT EXCEPT DURING PHASES OF CONSTRUCTION THAT REQUIRE FULL CLOSURE OF BRIDGE 17.



LEGEND	
	PROPOSED CONSTRUCTION SIGN AND POSTS
	PORTABLE CHANGEABLE MESSAGE SIGN
	PROJECT AREA

NOT TO SCALE



TRAFFIC CONTROL PLAN	
PROJECT NAME:	RUTLAND CITY
PROJECT NUMBER:	BRF 3000 (19)
PROJECT LEADER:	M.D.S.
DESIGNED BY:	C.R.H.
DWG. NO.:	TCP
PLOT DATE:	6/30/2014
DRAWN BY:	C.R.H.
CHECKED BY:	D.E.G.
SHEET	41 OF 245

FILE NAME = V:\P\c\esets\ANY\K2\2015\CADD\MSTN\08\096\ecmsul\anta\z08\096\ecp.dgn
 DATE/TIME = 6/30/2014 4:49:16
 USER =