

TEMPORARY DETOUR SECTION A-A

N. T. S.

NOTE: ALL WORK AND MATERIALS ASSOCIATED WITH TEMPORARY DETOUR WILL BE INCIDENTAL TO ITEM 900.645 SPECIAL PROVISION (TRAFFIC CONTROL, RAIL-HIGHWAY CROSSING)

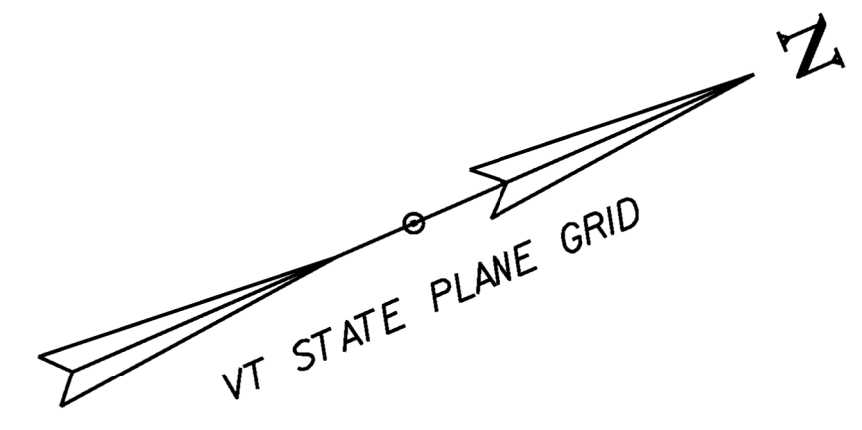
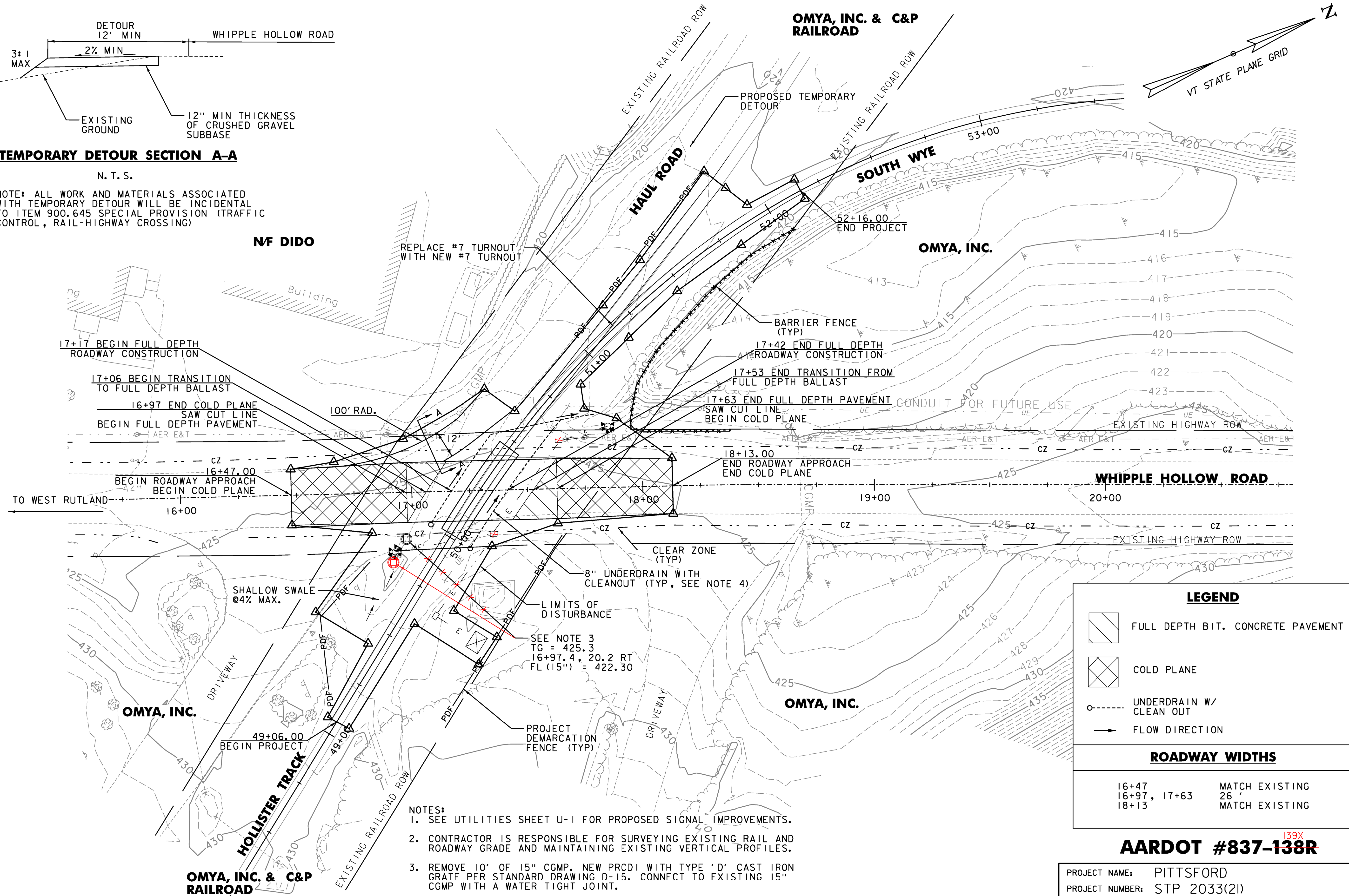

LEGEND

- FULL DEPTH BIT. CONCRETE PAVEMENT
- COLD PLANE
- UNDERDRAIN W/ CLEAN OUT
- FLOW DIRECTION

ROADWAY WIDTHS

16+47	MATCH EXISTING
16+97, 17+63	26'
18+13	MATCH EXISTING

- NOTES:**
- SEE UTILITIES SHEET U-1 FOR PROPOSED SIGNAL IMPROVEMENTS.
 - CONTRACTOR IS RESPONSIBLE FOR SURVEYING EXISTING RAIL AND ROADWAY GRADE AND MAINTAINING EXISTING VERTICAL PROFILES.
 - REMOVE 10' OF 15" CGMP. NEW PRCDI WITH TYPE 'D' CAST IRON GRATE PER STANDARD DRAWING D-15. CONNECT TO EXISTING 15" CGMP WITH A WATER TIGHT JOINT.
 - ALL WORK AND MATERIALS ASSOCIATED WITH UNDERDRAIN SHALL BE PAID INCIDENTAL TO PAY ITEM 900.645 SPECIAL PROVISION (RECONSTRUCT RAIL-HIGHWAY CROSSING) (AARDOT 837-138R) **139X**

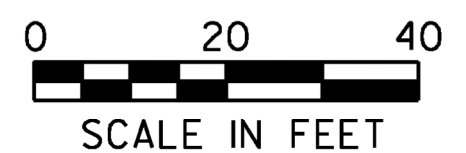

AARDOT #837-138R ^{139X}

PROJECT NAME: PITTSFORD
PROJECT NUMBER: STP 2033(21)

FILE NAME: ...05 construction plans.dgn PLOT DATE: 5/21/2013
PROJECT LEADER: G. EDWARDS DRAWN BY: DKG
DESIGNED BY: STANTEC CHECKED BY: KJR
CONSTRUCTION PLAN CP-1 SHEET 8 OF 21