

| LEGEND | |
|---------------------------------|--|
| (XXX) | SOIL MAP UNIT TYPE (SEE SHEET 2 FOR DETAILS) |
| ----- | SOIL MAP UNIT BOUNDARY |
| — FLOOD PLAIN — | Q ₁₀₀ FLOODPLAIN BOUNDARY |
| - - - - RIPARIAN BUFFER - - - - | RIPARIAN BUFFER |
| ----- | SILT FENCE |
| ----- | SILT FENCE (WOVEN WIRE REINFORCED) |
| - BF - - - - BF - - - - BF - | BARRIER FENCE |
| - PDF - - - - PDF - - - - PDF - | PROJECT DEMARCATION FENCE |
| | STONE AND BLOCK DROP INLET PROTECTION |
| | FILTER FABRIC DROP INLET PROTECTION |
| --- XXX --- | EXISTING MAJOR CONTOUR (10' INTERVAL) |
| --- XXX --- | EXISTING MINOR CONTOUR (2' INTERVAL) |

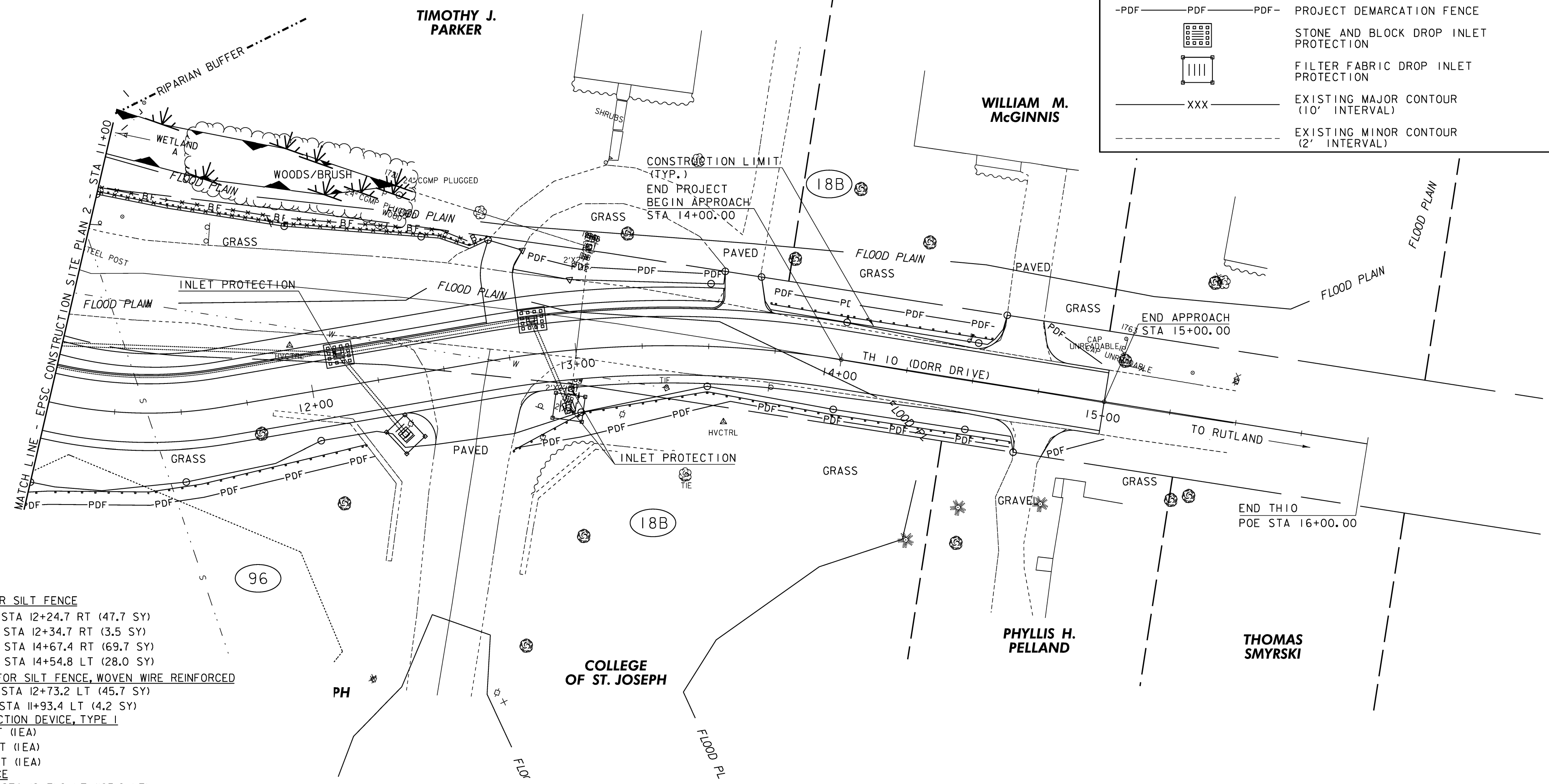

- 649.51 GEOTEXTILE FOR SILT FENCE
 TH 10 STA 11+00.0 - STA 12+24.7 RT (47.7 SY)
 TH 10 STA 12+26.5 - STA 12+34.7 RT (3.5 SY)
 TH 10 STA 12+63.6 - STA 14+67.4 RT (69.7 SY)
 TH 10 STA 13+72.0 - STA 14+54.8 LT (28.0 SY)
- 649.515 GEOTEXTILE FOR SILT FENCE, WOVEN WIRE REINFORCED
 TH 10 STA 11+00.0 - STA 12+73.2 LT (45.7 SY)
 TH 10 STA 11+87.2 - STA 11+93.4 LT (4.2 SY)
- 653.40 INLET PROTECTION DEVICE, TYPE I
 TH 10 STA 12+12.0 LT (1EA)
 TH 10 STA 12+95.3 RT (1EA)
 TH 10 STA 12+97.0 RT (1EA)
- 653.50 BARRIER FENCE
 TH 10 STA 11+00.0 - STA 12+71.6 LT (183.6 LF)
- 653.55 PROJECT DEMARCATION FENCE
 TH 10 STA 11+00.0 - STA 12+23.7 RT (143.3 LF)
 TH 10 STA 12+26.5 - STA 12+34.6 RT (10.0 LF)
 TH 10 STA 12+67.0 - STA 14+68.8 RT (204.0 LF)
 TH 10 STA 12+86.1 - STA 13+54.7 LT (57.5 LF)
 TH 10 STA 13+72.3 - STA 14+54.8 LT (84.0 LF)
 TH 10 STA 14+74.6 - STA 15+00.0 LT (27.5 LF)
 TH 10 STA 14+81.5 - STA 15+00.0 RT (27.5 LF)

SCALE 1" = 20'-0"
 20 0 20



| | | |
|---------------------------------------|-------------------------------|----------------------------|
| EPSC CONSTRUCTION SITE PLAN #3 | PROJECT NAME: RUTLAND CITY | PLOT DATE: \$DATE\$ |
| | PROJECT NUMBER: BRF 3000 (19) | DRAWN BY: C. HARDIN |
| | PROJECT LEADER: M. SARGENT | CHECKED BY: D. GOZALKOWSKI |
| | DESIGNED BY: C. HARDIN | ROW SHEET 17 OF 20 |

FILE NAME = \$FILES\$
 DATE / TIME = \$DATE\$ \$TIME\$
 USER = \$USER\$