

STATE OF VERMONT AGENCY OF TRANSPORTATION

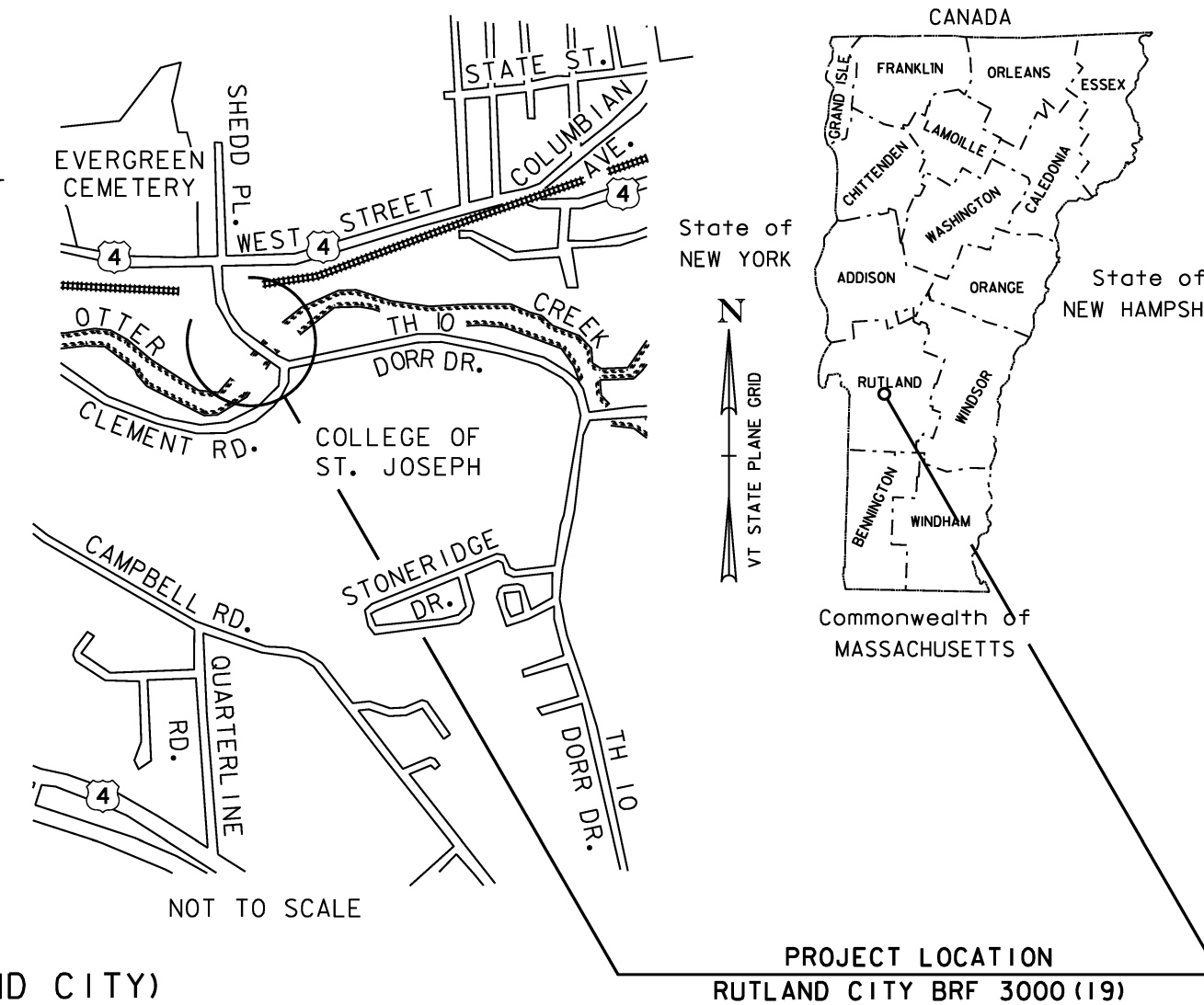

PROPOSED IMPROVEMENT BRIDGE PROJECT CITY OF RUTLAND COUNTY OF RUTLAND



ROW PLANS

ROUTE NO : TH 10 (RIPLEY ROAD) (MAJOR COLLECTOR) BRIDGE NO : 17 (RUTLAND CITY)
 BEGIN ROW PROJECT
 BRF 3000 (19)
 36.00' LT.

PROJECT LOCATION: LOCATED IN THE COUNTY OF RUTLAND, CITY OF RUTLAND, TH 10 (RIPLEY ROAD) OVER THE OTTER CREEK, APPROXIMATELY 500 FEET SOUTH OF THE JUNCTION OF US BUSINESS ROUTE 4 (WEST STREET) AND TH 10 (RIPLEY ROAD) AND EXTENDING ALONG TH 10 APPROXIMATELY 975 FEET TO THE END.
 PROJECT DESCRIPTION: CONSTRUCTION OF NEW STRUCTURE, EMBANKMENTS, AND SIDEWALK ON A NEW ALIGNMENT, RECONSTRUCTION OF APPROACHES AND DEMOLITION OF EXISTING STRUCTURE AND OTHER HIGHWAY RELATED ITEMS.
 LENGTH OF STRUCTURE : 208.50 FEET
 LENGTH OF ROADWAY : 916.50 FEET
 LENGTH OF PROJECT : 1,125.00 FEET
 LENGTH OF ROW PROJECT : 1,155.00 FEET

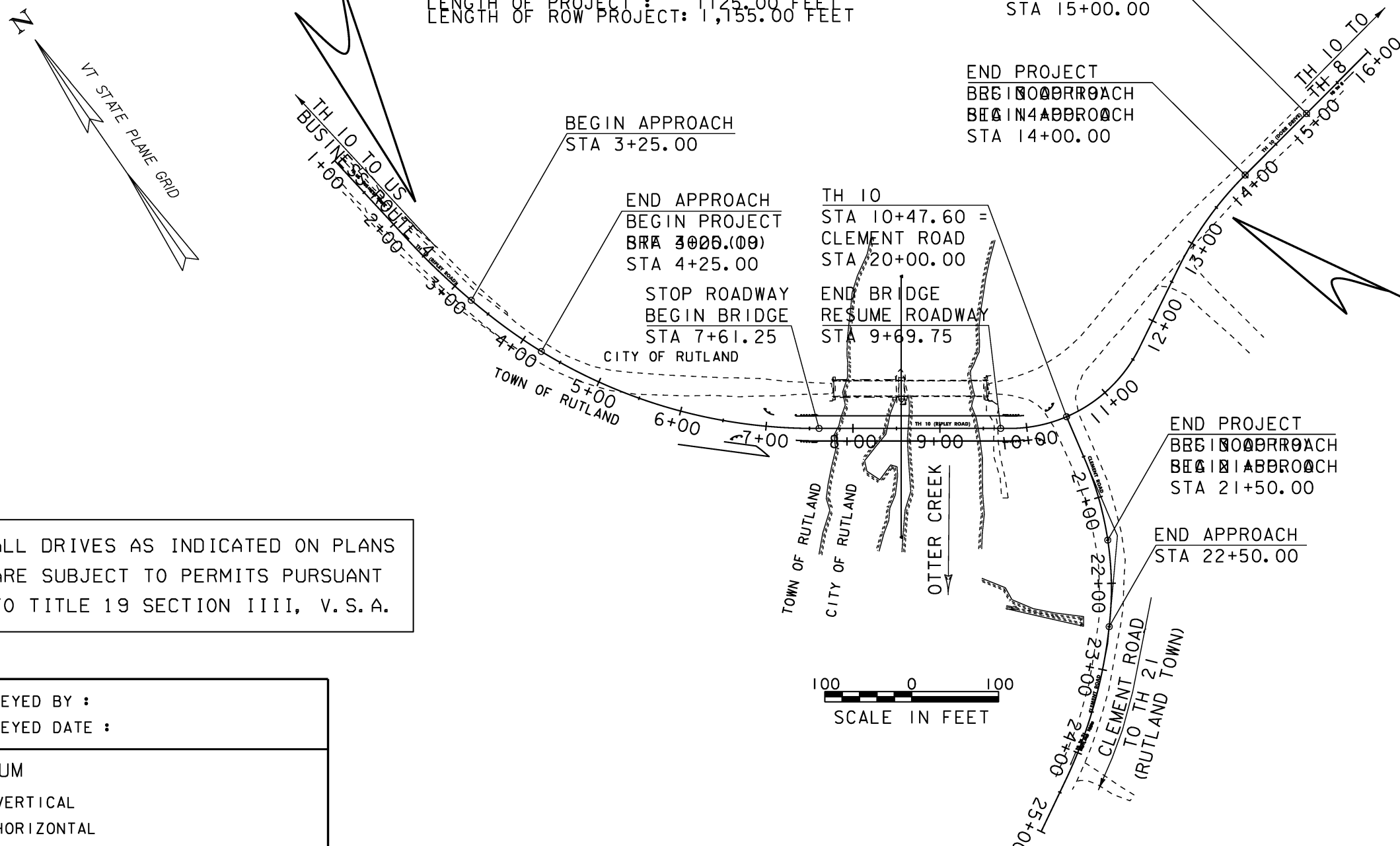

END ROW PROJECT
 BRF 3000 (19)
 STA. 13+53.00
 22.10' RT.

PLANS PREPARED BY

CONVENTIONAL SYMBOLS	
COUNTY LINE	
TOWN LINE	
LIMITS OF ACCESS	
POINT OF ACCESS	
FENCE LINE	
STONE WALL	
TRAVELED WAY	
GUARD RAIL	
RAILROAD	
SURVEY LINE	
CULVERT	
POWER POLE	
TELEPHONE POLE	
TREES	
CONTROL OF ACCESS	
PROPERTY LINE	
R.O.W. TAKING LINE	
SLOPE RIGHTS	
TOP OF CUT	
TOE OF SLOPE	

ALL DRIVES AS INDICATED ON PLANS ARE SUBJECT TO PERMITS PURSUANT TO TITLE 19 SECTION IIII, V. S. A.

SURVEYED BY :
 SURVEYED DATE :
 DATUM
 VERTICAL
 HORIZONTAL

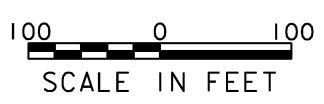

THESE PLANS ARE SUBJECT TO SUCH ENGINEERING CHANGES AS MAY BE REQUIRED BY THE FEDERAL HIGHWAY ADMINISTRATION OR THE DIRECTOR OF PROGRAM DEVELOPMENT.
 CONSTRUCTION IS TO BE CARRIED ON IN ACCORDANCE WITH THESE PLANS AND THE STANDARD SPECIFICATIONS FOR CONSTRUCTION DATED 2011, AS APPROVED BY THE FEDERAL HIGHWAY ADMINISTRATION ON JULY 20, 2011 FOR USE ON THIS PROJECT, INCLUDING ALL SUBSEQUENT REVISIONS AND SUCH REVISED SPECIFICATIONS AND SPECIAL PROVISIONS AS ARE INCORPORATED IN THESE PLANS.

081096

APPROVED DATE 11-29-12
Director of Program Development

APPROVED ROBERT M. WHITE DATE 11-29-12
Chief of Right of Way

RUTLAND CITY
BRF 3000 (19)
 ROW SHEET 1 OF 20 SHEETS