

**SUGGESTED SEQUENCE OF CONSTRUCTION**

- 1.) MAKE REPAIRS TO THE DOWNSTREAM COVERED BRIDGE TRUSS.
- 2.) INSTALL TEMPORARY RAILINGS ON THE REMAINING SUPERSTRUCTURE AND APPROACHES.
- 3.) REMOVE AND TRANSPORT THE COVERED BRIDGE TRUSSES AND ROOF TO THE DESIGNATED TOWN STORAGE SITE. SEE SHEET 13 FOR ADDITIONAL DETAILS.
- 4.) INSTALL THE STEEL SHEETING, TEMPORARY BRIDGE, APPROACHES, AND RAILINGS.
- 5.) REMOVE AND DISPOSE OF THE REMAINING EXISTING BRIDGE SUPERSTRUCTURE AND TEMPORARY RAILINGS.

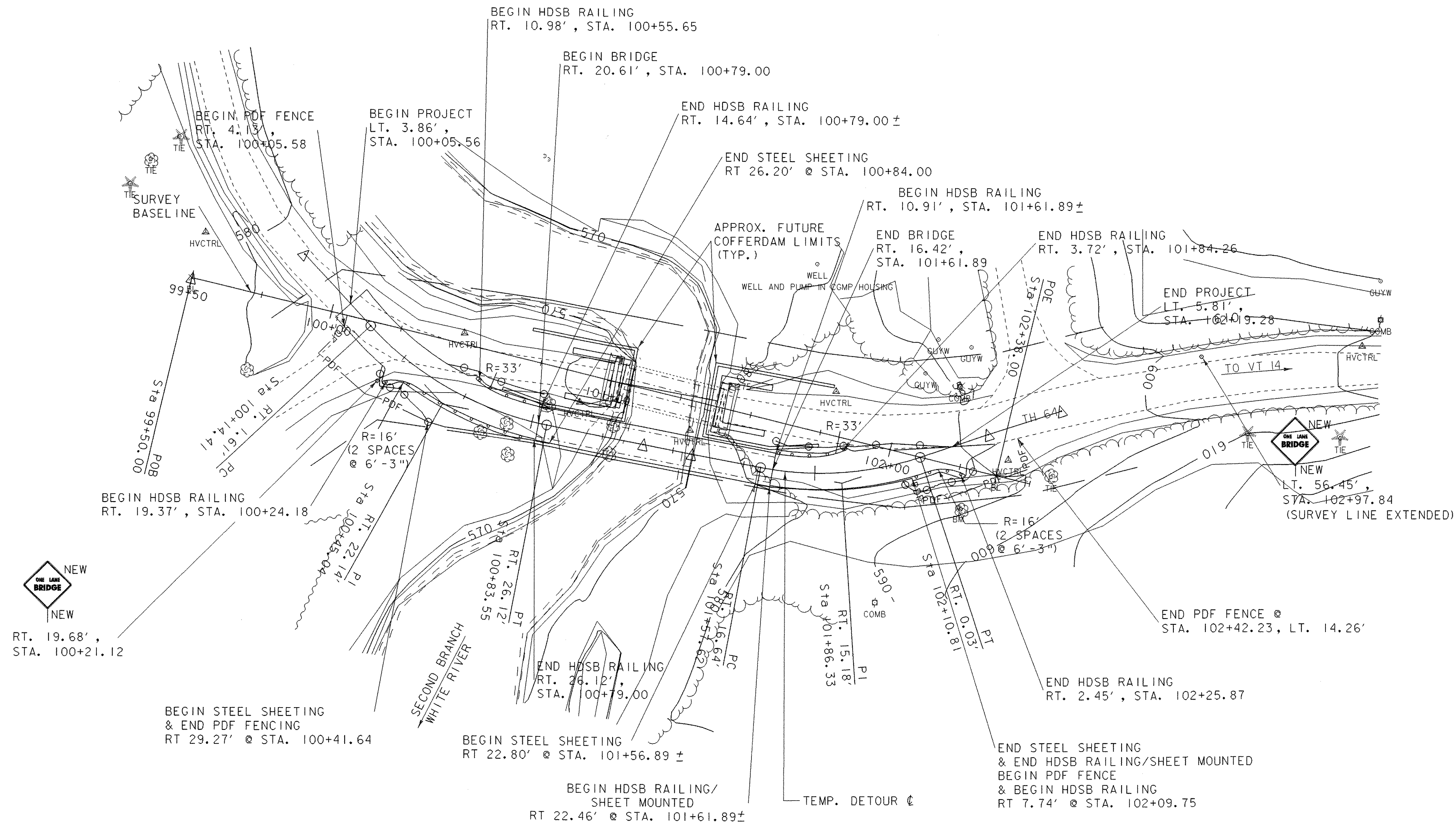

**LEGEND & ABBREVIATIONS**

PDF	PDF	SNOW FENCE (MOD.-PDF)
—	—	RIGHT OF WAY
HDSB RAILING:	HEAVY DUTY STEEL BEAM GUARD RAIL (GALVANIZED) (MOD.-8' POSTS)	
HDSB RAILING/ SHEET MOUNTED:	HEAVY DUTY STEEL BEAM GUARD RAIL (GALVANIZED) (MOD.-STEEL SHEET PILING)	
STEEL SHEETING:	PERMANENT STEEL SHEET PILING (S=45.3 in <sup>2</sup> MIN.)	

**PLAN**

SCALE: 1"=20'

SCALE 1"=20'-0"  
20 0 20

PROJECT NAME:	RANDOLPH		
PROJECT NUMBER:	BHO_1444(50)		
FILE NAME:	s06j09d1000cf	DATE:	4/11/06
PROJECT LEADER:	J. WEAVER	DRAWN BY:	J. IBEI
DESIGNED BY:	J. IBEI	CHECKED BY:	J. WEAVER
PLAN SHEET		SHEET	4 OF 18