

**BRIDGE CLOSED**  
**MONKTON RD**  
 SOUTH of SPEAR ST

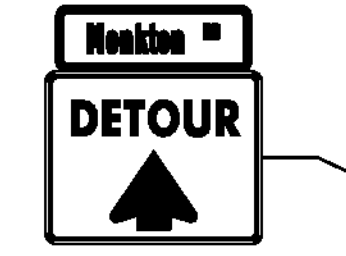

MOUNT ON TYPE 111 BARRICADE (MOD.)  
 MOUNT BELOW R11-2 SIGN ON TYPE 111 BARRICADE (MOD.)

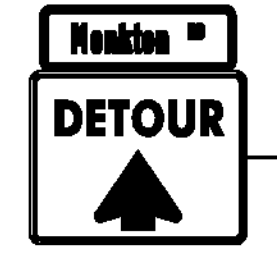

**END ROAD WORK**

**BRIDGE CLOSED**  
 MONTH XX THRU MONTH XX



**BRIDGE CLOSED**  
 MONTH XX THRU MONTH XX

**ROAD CLOSED TO THRU TRAFFIC**

**MESSAGES FOR PORTABLE CHANGEABLE MESSAGE SIGNS (PCMS)**

| MESSAGE 1 | MESSAGE 2 |
|-----------|-----------|
| COVERED   | MM / DD   |
| BRIDGE    | THRU      |
| CLOSED    | MM / DD   |

**LEGEND**

- - TYPE 111 BARRICADE
- ▣ - TYPE 111 BARRICADE (MOD.)
- ▤ - TEMPORARY TRAFFIC BARRIER

**NOTES:**

1. THE NUMBER OF TYPE 111 BARRICADES AND OTHER TRAFFIC CONTROL DEVICES SHOWN ARE FOR ILLUSTRATIVE PURPOSES ONLY. THE ACTUAL NUMBER REQUIRED ARE TO BE DETERMINED BASED ON INDIVIDUAL ROADWAY CLOSURE REQUIREMENTS.
2. ACCESS TO AND FROM THE MORSE RESIDENCE SHALL BE MAINTAINED AT ALL TIMES.
3. PORTABLE CHANGEABLE MESSAGE SIGNS (PCMS) SHALL BE PLACED OFF THE EDGE OF THE ROADWAY, OUTSIDE THE CLEAR ZONE, BUT SHALL BE VISIBLE FROM THE ROADWAY. ANY VEGETATION THAT INTERFERES WITH VISIBILITY OF THE PCMS SHALL BE REMOVED. REMOVAL OF THE VEGETATION SHALL BE INCIDENTAL TO ITEM 641.17, "PORTABLE CHANGEABLE MESSAGE SIGN RENTAL".
4. THE PORTABLE CHANGEABLE MESSAGE SIGNS (PCMS) SHALL DISPLAY THE MESSAGE SHOWN ONE WEEK (7 DAYS) PRIOR TO THE CLOSURE OF THE BRIDGE. THE PCMS SHALL NOT BE A PART OF THE DETOUR AND SHALL BE REMOVED ONCE THE DETOUR IS IMPLEMENTED AND THE BRIDGE IS CLOSED.

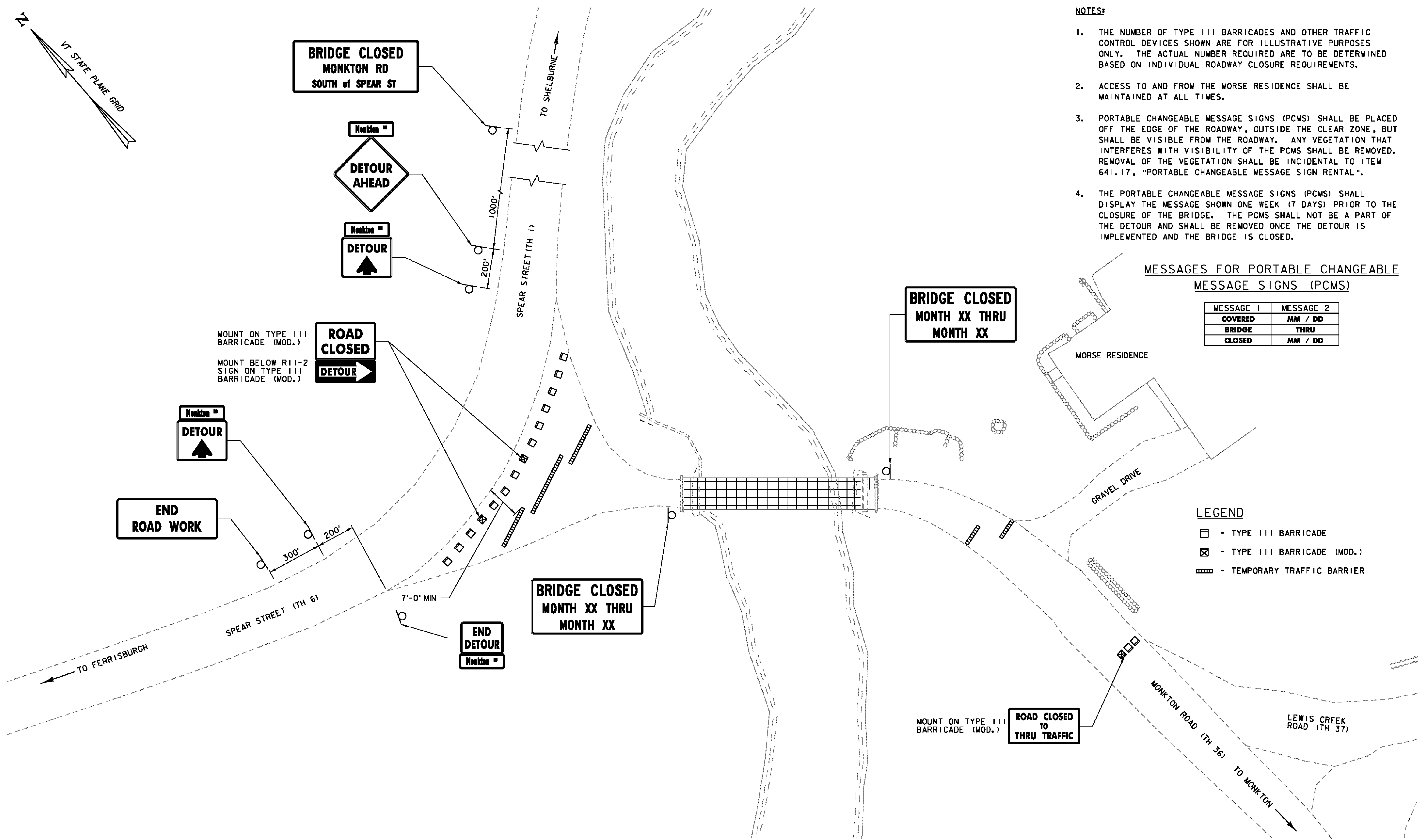

**PROJECT LOCATION TRAFFIC CONTROL PLAN**  
 NOT TO SCALE

TRAFFIC CONTROL MEASURES: SIGNS, BARRICADES, AND TEMPORARY TRAFFIC BARRIERS SHOWN ON THIS SHEET (EXCEPT PCMS'S) SHALL BE PAID UNDER ITEM 641.10, "TRAFFIC CONTROL".



|                                      |                         |
|--------------------------------------|-------------------------|
| PROJECT NAME: CHARLOTTE              | PLOT DATE: 10/4/2012    |
| PROJECT NUMBER: BHO 1445(34)         | DRAWN BY: J.W. GOLEK    |
| FILE NAME: z06j088details detour.dgn | CHECKED BY: B.O. CRONIN |
| PROJECT LEADER: M.A. COLGAN          | SHEET 18 OF 55          |
| DESIGNED BY: J.W. GOLEK              |                         |
| TRAFFIC CONTROL SHEET (4 OF 5)       |                         |