

REMOVAL AND DISPOSAL OF GUARDRAIL
 STA. 10+55.49 - 11+04.97, RT
 STA. 10+70.20 - 11+04.66, LT
 STA. 11+92.00 - 12+38.76, LT
 STA. 11+93.92 - 12+44.16, RT

ITEM 900.640, SPECIAL PROVISION
(HD STEEL BEAM GUARDRAIL, WEATHERING) (WOOD POSTS)
 STA. 10+54 - STA. 11+03, RT
 STA. 10+70 - STA. 11+03, LT
 STA. 11+92 - STA. 12+40, LT
 STA. 11+94 - STA. 12+48, RT

ANCHOR FOR STEEL BEAM RAIL
 STA. 10+64, RT
 STA. 12+29, LT
 STA. 12+35, RT

COLD PLANING, BITUMINOUS PAVEMENT
 STA. 10+75 - STA. 10+88

NOTES:

1. ONLY TREES IN STONE FILL AREA ON NORTHEAST CORNER ABOVE WINGWALL SHALL BE REMOVED. ALL OTHER TREES TO REMAIN. NEW TREES TO BE PLANTED ON NORTHEAST CORNER SHALL BE 3" SORBUS DECORA (MOUNTAIN ASH).
2. SOME UNDERMINING EXISTS UNDER EXISTING CONCRETE IN STREAM BED IN FRONT OF NORTH ABUTMENT AND WINGWALL ON UPSTREAM SIDE. THESE VOIDS TO BE FILLED USING GROUT BAG REPAIRS. SEE SHEET 46 FOR DETAILS.

BENCHMARK#4
 RRSIT
 MATURE ELM
 ELEVATION: 226.96

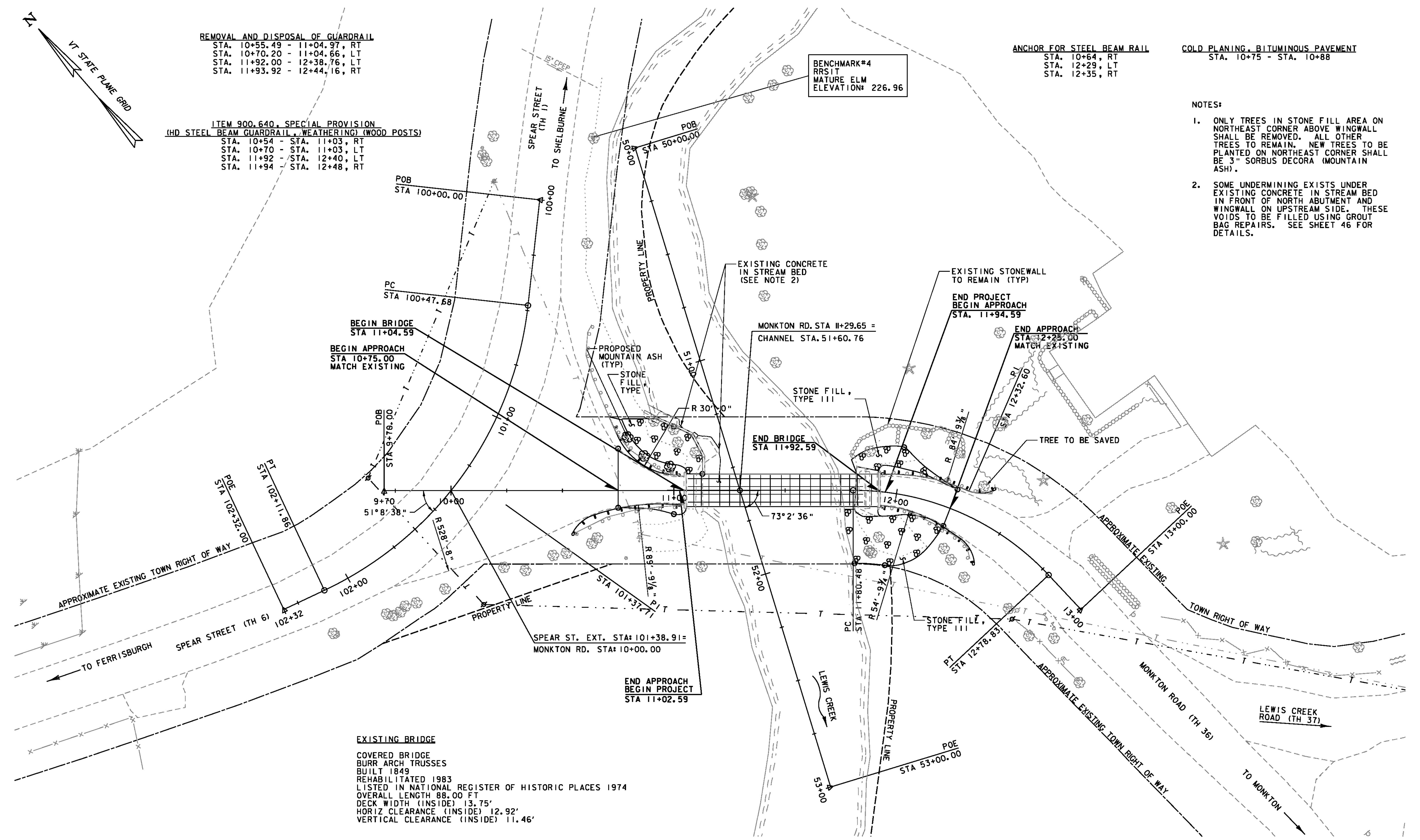

EXISTING BRIDGE
 COVERED BRIDGE
 BURR ARCH TRUSSES
 BUILT 1849
 REHABILITATED 1983
 LISTED IN NATIONAL REGISTER OF HISTORIC PLACES 1974
 OVERALL LENGTH 88.00 FT
 DECK WIDTH (INSIDE) 13.75'
 HORIZ CLEARANCE (INSIDE) 12.92'
 VERTICAL CLEARANCE (INSIDE) 11.46'

PLAN
 SCALE 1" = 20'-0"
 20 0 20

DATUM
 VERTICAL: NAVD 88
 HORIZONTAL: NAD 83 (07)



PROJECT NAME: CHARLOTTE	FILE NAME: z06j088.dgn	PLOT DATE: 10/4/2012
PROJECT NUMBER: BHO 1445(34)	PROJECT LEADER: M.A. COLGAN	DRAWN BY: J.W. GOLEK
	DESIGNED BY: J.W. GOLEK	CHECKED BY: K.E. HILL
	LAYOUT SHEET	SHEET 8 OF 55