

EXISTING TYPICAL BRIDGE SECTION
SCALE: 1/2" = 1'-0"

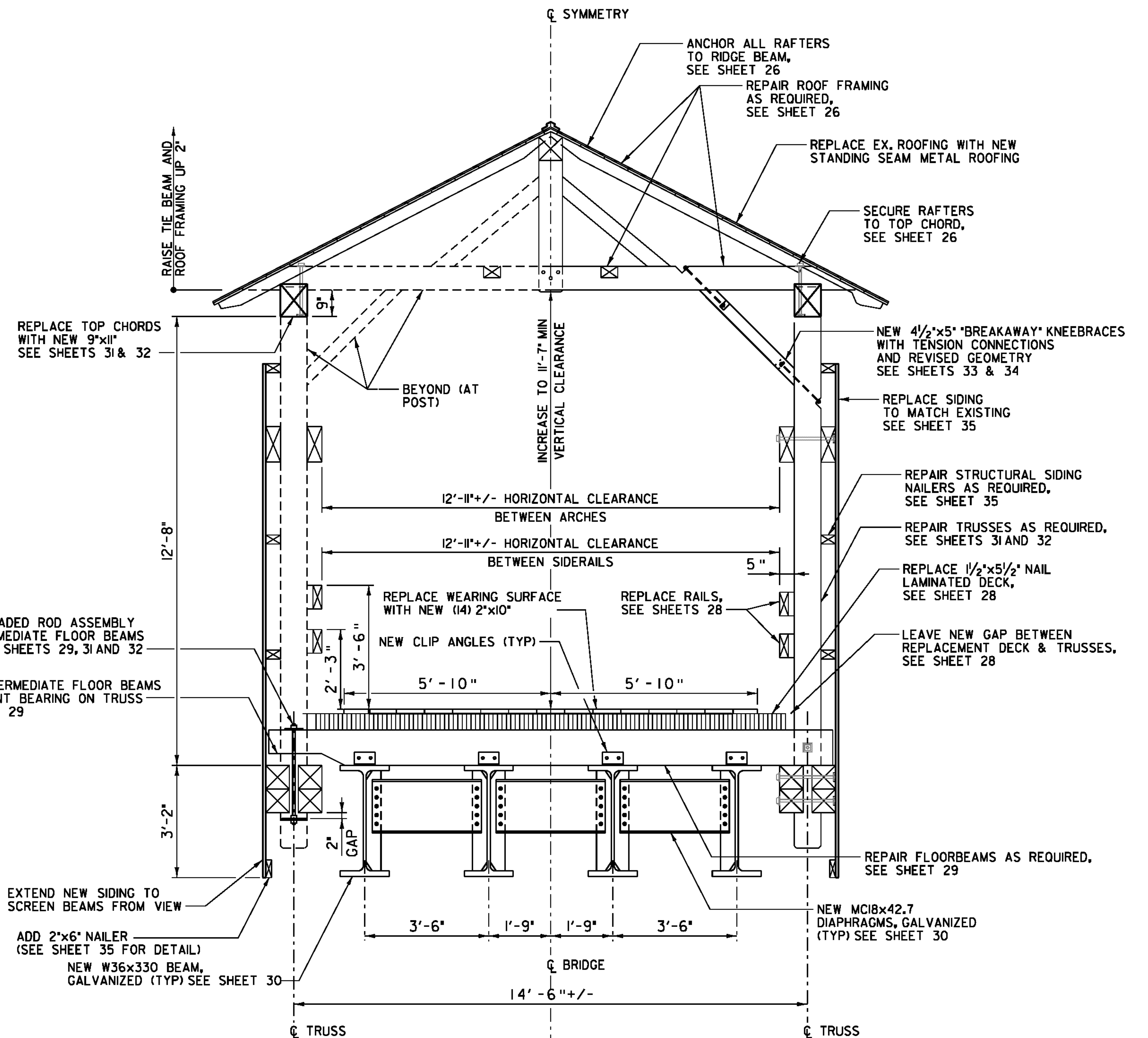

SECTION BETWEEN TRUSS POSTS
SECTION AT TRUSS POSTS

PROPOSED TYPICAL BRIDGE SECTION
SCALE: 1/2" = 1'-0"

NOTE:

1. SEE ROADWAY TYPICAL SECTIONS AND CROSS SECTIONS FOR INFORMATION NOT SHOWN.
2. SUPERSTRUCTURE IS TO BE RAISED 4" TO MAINTAIN EXISTING HYDRAULIC OPENING WITH THE INCREASED BEAM DEPTH. ROOF FRAMING IS TO BE RAISED AN ADDITIONAL 2" WITH RESPECT TO TOP OF DECK.

PROJECT NAME: CHARLOTTE
PROJECT NUMBER: BHO 1445(34)

FILE NAME: z06j088+yp.dgn
PROJECT LEADER: M.A. COLGAN
DESIGNED BY: K.E. HILL
TYPICAL SECTIONS

PLOT DATE: 10/4/2012
DRAWN BY: E.A. FIALA
CHECKED BY: M.A. COLGAN
SHEET 3 OF 55