

66D- VERSHIRE-DUMMERSTON  
COMPLEX, 15% TO 25%  
SLOPES, ROCKY.  
K FACTOR = 0.37

64D- SALMON-ADAMANT  
COMPLEX, 15% TO 25%  
SLOPES, VERY ROCKY.

66E- VERSHIRE-DUMMERSTON  
COMPLEX, 25% TO 60%  
SLOPES, ROCKY.  
K FACTOR = 0.37

26B- ADAMS LOAMY FINE SAND,  
3% TO 8% SLOPES.  
K FACTOR = 0.17

4A- SUNNY SILT LOAM,  
0% TO 2% SLOPES.  
K FACTOR = 0.32

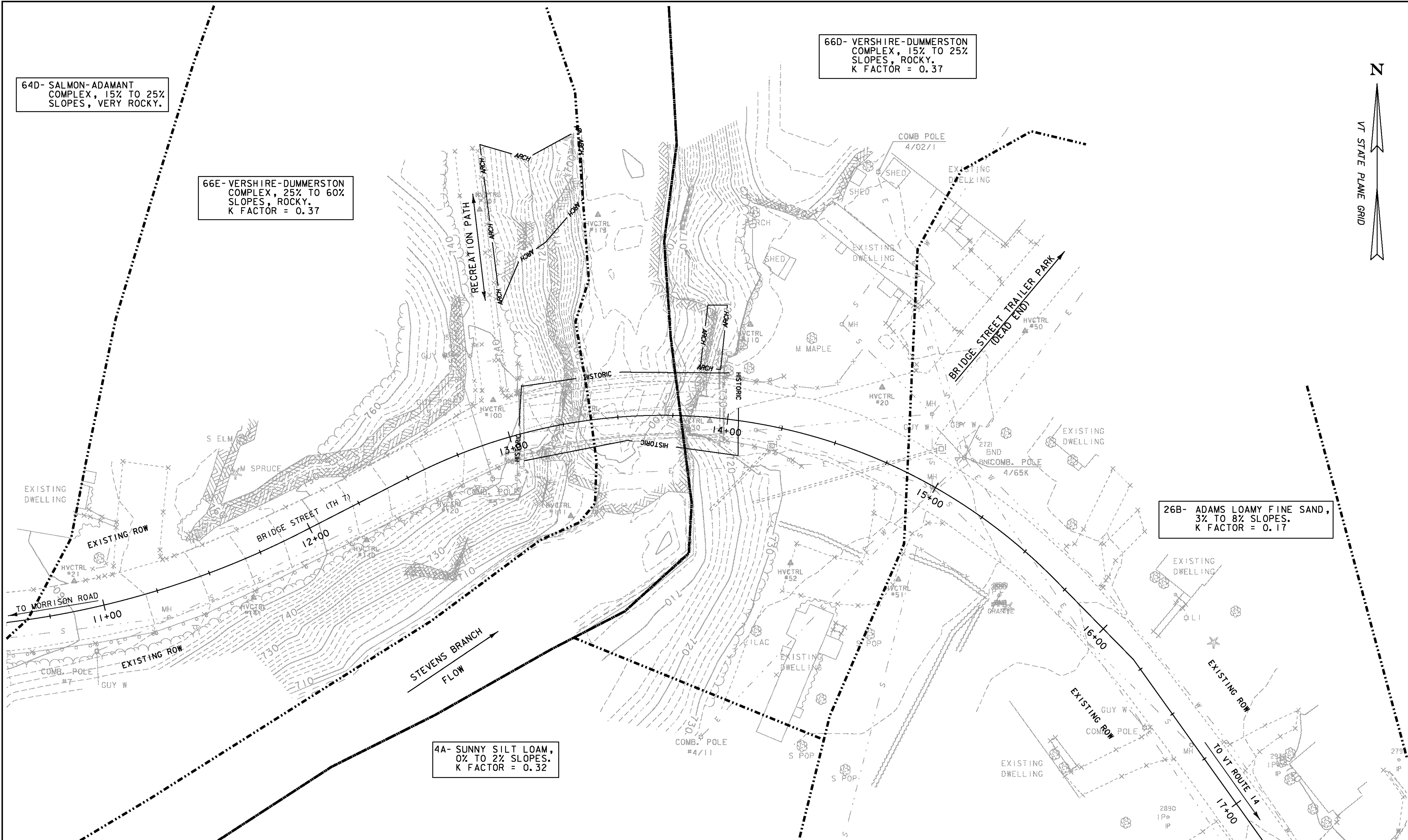

EPSC EXISTING CONDITIONS

SCALE 1" = 20'-0"  
20 0 20

PROJECT NAME: BARRE TOWN  
PROJECT NUMBER: BRF 6100(7)

FILE NAME: s06j002epsc\_existing.dgn  
PROJECT LEADER: J. LACROIX  
DESIGNED BY: J. SALVATORI  
EPSC EXISTING CONDITIONS

PLOT DATE: 27-SEP-2012  
DRAWN BY: R. PELLETT  
CHECKED BY: J. SALVATORI  
SHEET 63 OF 70

SEE "EPSC DETAILS 1" SHEET FOR LEGEND