

SECTION LOOKING WEST
SCALE 0 5 10 FEET

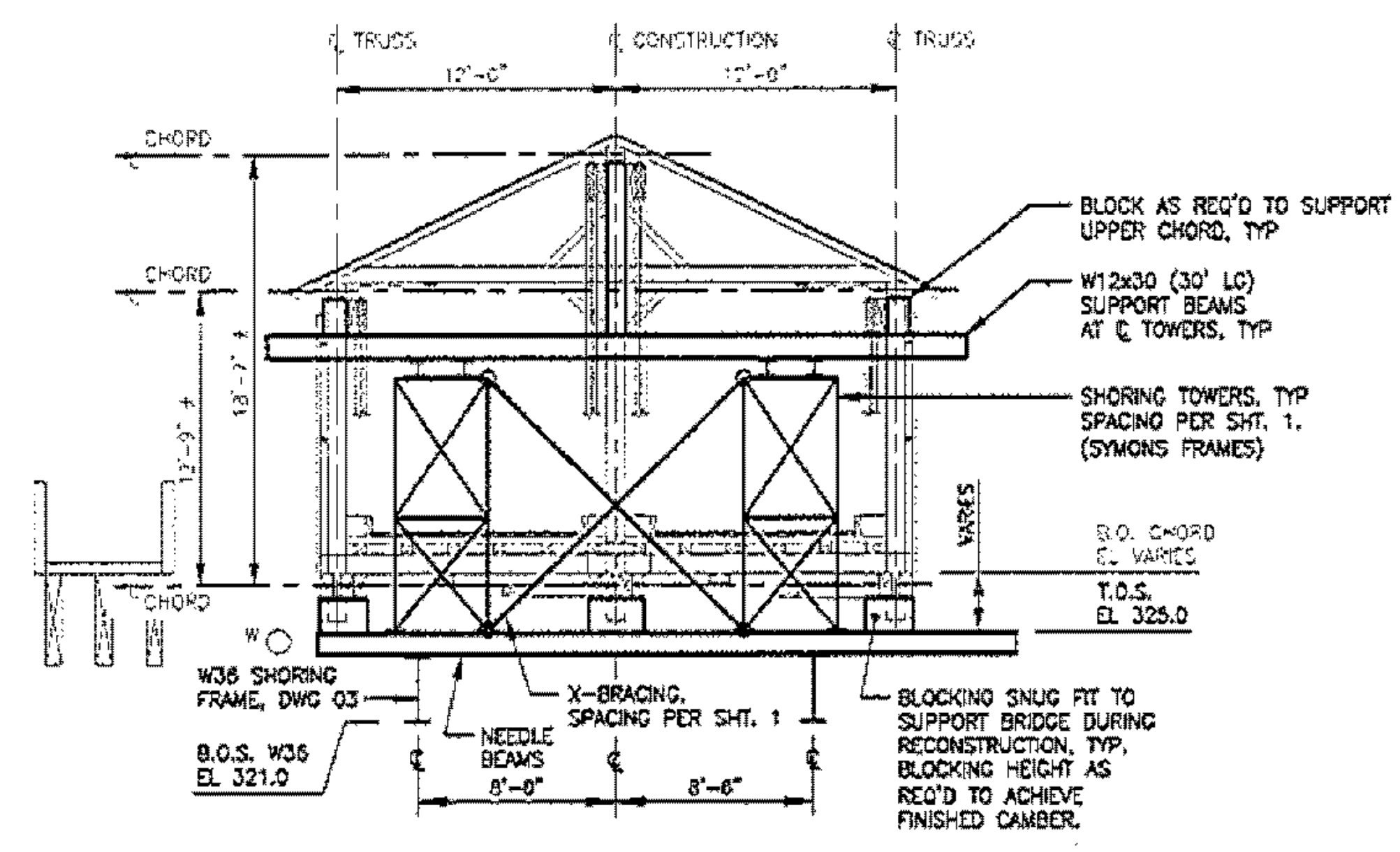

SECTION LOOKING WEST
SCALE 0 5 10 FEET

STEP 1 - PREPARE EXISTING BRIDGE FOR RECONSTRUCTION

- WORK SCOPE / SEQUENCE:
- PERFORM THE FOLLOWING TASKS (MAY BE PERFORMED CONCURRENTLY):
 - INSTALL TEMPORARY SHORING SYSTEM BELOW EXISTING BRIDGE, INCLUDING W36 SHORING FRAME, NEEDLE BEAMS & BLOCKING "SNUG FIT" TO UNDERSIDE OF BRIDGE FOR SUPPORT DURING RECONSTRUCTION. (FOR ADDITIONAL DETAILS REFER TO SHEET 1 & DWG 03).
 - IN ORDER TO REDUCE BRIDGE TOTAL WEIGHT PRIOR TO BRIDGE RECONSTRUCTION, CONTRACTOR MAY (AT CONTRACTOR'S OPTION) REMOVE THE FOLLOWING EXISTING BRIDGE MATERIALS IN A SEQUENCE THAT WILL "UNIFORMLY & SYMMETRICALLY" UNLOAD THE EXISTING BRIDGE WEIGHT.
 - FLOOR CURBS, RUNNER BOARDS, PLANK DECKING & FLOOR STRINGERS (FLOOR BEAMS & LOWER LATERAL BRACING TO REMAIN)
 - SIDING [PRIOR TO SIDING REMOVAL AT PORTALS, MEASURE SIDING PORTAL GEOMETRY FOR FUTURE REFERENCE]
 - INSTALL PROTECTIVE COVER ON EXISTING BRIDGE TO REMAIN, AS THE WORK PROGRESSES.

STEP 2 - REHAB BRIDGE: PHASE 1 WORK AREA

- WORK SCOPE / SEQUENCE:
- LOCALLY REMOVE EXISTING BRIDGE FLOORING / STRINGERS AS REQ'D AND INSTALL TEMPORARY SHORING ABOVE NEEDLE BEAMS IN ACCORDANCE WITH SHTS. 1 & 2.
 - REHABILITATE EXISTING BRIDGE AND ABUTMENTS IN ACCORDANCE WITH CONTRACT DOCUMENTS BY OTHERS. TYPICAL BRIDGE REHAB SEQUENCE:
 - SUPPORT ARCHES ON SHORING TOWER BEAMS & DISCONNECT ARCHES FROM KINGPOSTS.
 - REMOVE FLOORING / FLOOR STRINGERS / FLOOR BEAMS AND REBUILD LOWER CHORD & KINGPOSTS. INSTALL LOWER CHORD TO THE "CAMBER" ELEVATION INDICATED ON SHT. 2.
 - REBUILD REMAINDER OF TRUSS (DIAGONALS, UPPER CHORDS), LOWER LATERAL BRACING, FLOOR BEAMS, CROSS BEAMS & UPPER LATERAL BRACING.
 - RE-CONNECT ARCHES TO KINGPOSTS.

STEP 3 - REHAB BRIDGE: PHASE 2 WORK AREAS

WORK SCOPE / SEQUENCE: REPEAT STEP 2 IN PHASE 2 WORK AREAS

NOTE
1. USE THIS DRAWING IN CONJUNCTION WITH THE DRAWINGS LISTED AND INFORMATION PROVIDED ON THE FOLLOWING DRAWING:
MIDDLEBURY-WEYBRIDGE BRIDGE BHO 1445(33)
TEMPORARY SHORING FOR REHAB
DRAWING LIST & SITE LOCATION PLAN
RFS DWG. NO. ALP-MW-01, SHEET 1

LEGEND
T.O. TOP OF
T.O.S. TOP OF STEEL
B.O. BOTTOM OF

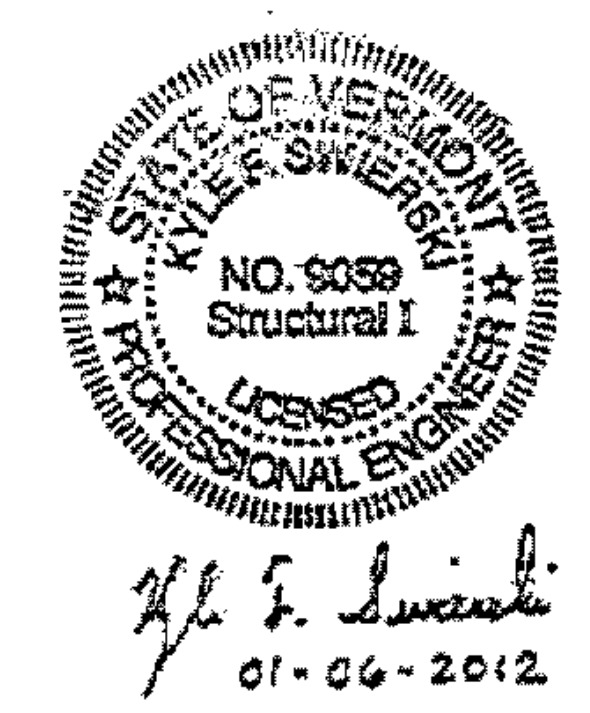

THIS DOCUMENT HAS BEEN PREPARED BY A PROFESSIONAL ENGINEER LICENSED IN THE STATE OF VERMONT. ANY ALTERATION TO THIS DOCUMENT SHALL BE IDENTIFIED AND SEALED/SIGNED BY THE ALTERING LICENSED PROFESSIONAL ENGINEER IN ACCORDANCE WITH THE STATE OF VERMONT LAWS AND RULES.

ALPINE CONSTRUCTION, LLC
VERMONT AGENCY OF TRANSPORTATION
MIDDLEBURY-WEYBRIDGE BRIDGE BHO 1445(33)
TEMPORARY SHORING FOR REHAB
GENERAL ARRANGEMENT
WORK SEQUENCE

DATE	REV.	DESCRIPTION OF REVISIONS	DRAWN BY	CHECKED BY
01-06-2012	0	ISSUED FOR CONSTRUCTION	LSS	RFS

KYLE F. SWIERSKI, P.E., LLC 41 Boll Drive Elma, New York 14059 (716) 655-6722 kswierski@roadrunner.com	PROJECT ID ALP-MW DRAWING NUMBER ALP-MW-02 SHEET 3 OF 4	REV. 0
--	---	-----------