

**TOP CHORD PLAN**  
SCALE: 1/4" = 1'-0"

LIMITS OF SIDING END RETURN, SEE DETAIL ON SHEET 48  
APPLY ONE EVEN COAT OF AN APPROVED CLEAR WATER SEALER FOR LOWER 4' OF VERTICAL (INCIDENTAL TO ITEM 660.30)

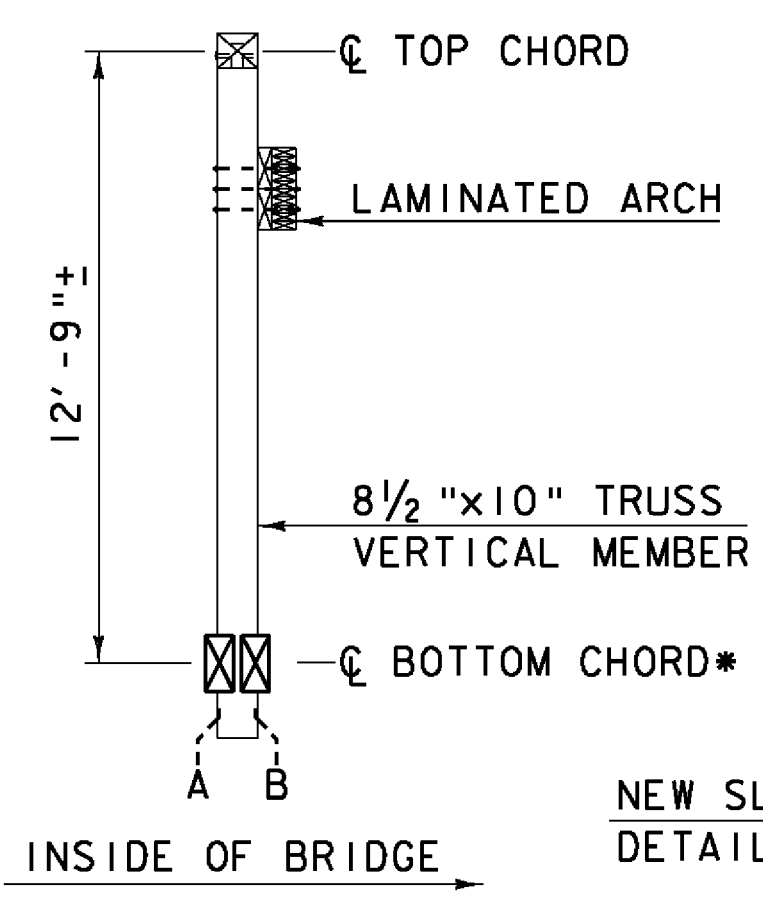

**TYPICAL TRUSS SECTION**  
SCALE: 1/4" = 1'-0"

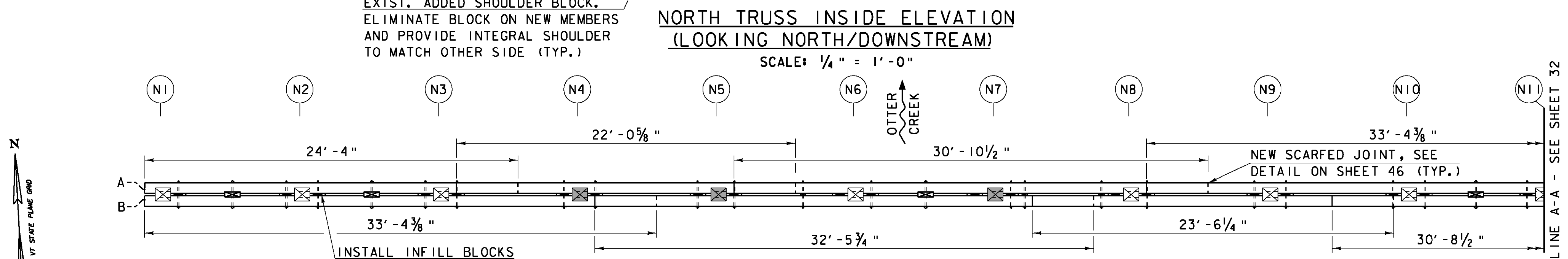

**BOTTOM CHORD PLAN**  
SCALE: 1/4" = 1'-0"

\*NOTE: BOTTOM CHORD IS TO BE REPLACED IN ITS ENTIRETY AND IT IS NOT SHOWN SHADED FOR CLARITY.

**LEGEND:**

- (XXX) TRUSS NODE LOCATION
- PREDETERMINED MEMBER TO BE REPLACED
- ▨ NEW MEMBER
- REPLACE THROUGH BOLT & PLATE (SEE DETAIL ON SHEET 48)
- ② INSTALL SHEAR BLOCK (SEE DETAIL ON SHEET 46)
- ③ INSTALL THROUGH BOLT (SEE SCARFED JOINT DETAIL ON SHEET 46)
- ④ INSTALL THROUGH BOLT (SEE DETAILS ON SHEET 51 OR 54)

SCALE: 1/4" = 1'-0"  
1 0 2 4 6



HTA PROJECT NO. 904217 MODEL truss.north.1

PROJECT NAME:	MIDDLEBURY-WEYBRIDGE	PLOT DATE:	9/20/2011
PROJECT NUMBER:	BHO 1445(33)	DRAWN BY:	J.B.McQUAID
FILE NAME:	z06j086sup.dgn	CHECKED BY:	S.T.JAMES
PROJECT LEADER:	M.D.SARGENT	DESIGNED BY:	J.BICJA
<b>NORTH TRUSS ELEV. &amp; PLAN (1 OF 2)</b>		SHEET 31 OF 66	

MATCH LINE A-A - SEE SHEET 32

MATCH LINE A-A - SEE SHEET 32

MATCH LINE A-A - SEE SHEET 32