

- INDEX OF SHEETS**
- 1. TITLE SHEET
  - 2. TYPICAL SECTIONS, NOTES & QUANTITIES
  - 3. TIE SHEET
  - 4. LAYOUT SHEET
  - 5. RESOURCE SHEET
  - 6-8. DETAIL SHEETS

**VAOT STANDARD SHEETS**

- E - 100A SIDE ROAD CONSTRUCTION APPROACH SIGNS - 1/02/04
- E - 102 CONSTRUCTION SIGN DETAILS - 6/30/03
- E - 102A CONSTRUCTION SIGN DETAILS - 5/01/04
- E - 107 DELINEATION, BARRICADES AND DETOURS... - 6/30/03
- E - 107A BREAKAWAY BARRICADE DETAILS - 8/08/95
- E - 121 STANDARD SIGN PLACEMENT-CONVENTIONAL ROAD - 8/08/95
- E - 146 REGULATORY SIGN DETAILS - 9/20/95
- E - 155 WARNING SIGN DETAILS - 5/01/04

# STATE OF VERMONT AGENCY OF TRANSPORTATION

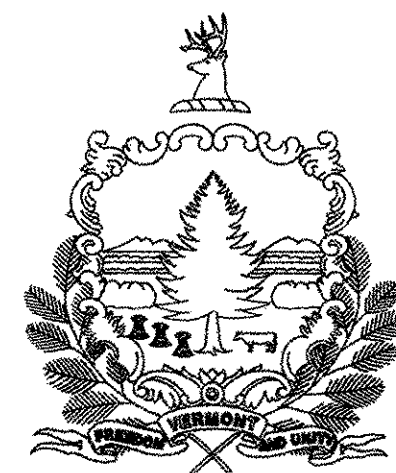

## PROPOSED IMPROVEMENT BRIDGE PROJECT

TOWN OF: BRATTLEBORO  
COUNTY OF: WINDHAM

ROUTE NO: TH 374, CL III BRIDGE NO: 30

PROJECT LOCATION: ON TH 374 BEGINNING APPROXIMATELY 0.015 MILES  
SOUTH FROM ITS INTERSECTION WITH TH2 (VT 9) AND EXTENDING  
SOUTHERLY APPROXIMATELY 0.016 MILES.

PROJECT DESCRIPTION: REHABILITATION OF THE CREAMERY COVERED BRIDGE.

LENGTH OF STRUCTURE: 83.4 FEET  
LENGTH OF PROJECT: 83.4 FEET

RECORD PLANS	
CONTRACTOR:	RENAUD BROTHERS, INC. - VERNON, VT
RESIDENT ENGINEER:	DAN TYLER
CONSTRUCTION BEGAN:	DECEMBER 11, 2006
CONSTRUCTION COMPLETE:	MAY 25, 2007
RECORD PLANS BY:	D. TYLER & M. BOOTH
I HEREBY CERTIFY THAT ALL THE CONSTRUCTION REQUIRED BY THIS SET OF DRAWINGS HAS BEEN ACCOMPLISHED AS INDICATED HEREIN.	
BY:	<i>Dan H. Gannell</i> RESIDENT ENGINEER
DATE:	2/24/09
NOTE: Any further information concerning final quantities, amounts or other details relative to this project may be found at Central Files in the electronic archives.	

CONVENTIONAL SYMBOLS	
COUNTY LINE	
TOWN LINE	
LIMITS OF ACCESS	
POINT OF ACCESS	
FENCE LINE	
STONE WALL	
TRAVELED WAY	
GUARD RAIL	
RAILROAD	
SURVEY LINE	
CULVERT	
POWER POLE	
TELEPHONE POLE	
TREES	
CONTROL OF ACCESS	
PROPERTY LINE	
R.O.W. TAKING LINE	
SLOPE RIGHTS	
TOP OF CUT	
TOE OF SLOPE	

SURVEYED BY : R. D. GILMAN  
SURVEYED DATE : 9-17-97

DATUM  
VERTICAL NAVD 88  
HORIZONTAL NAD-83 (92)

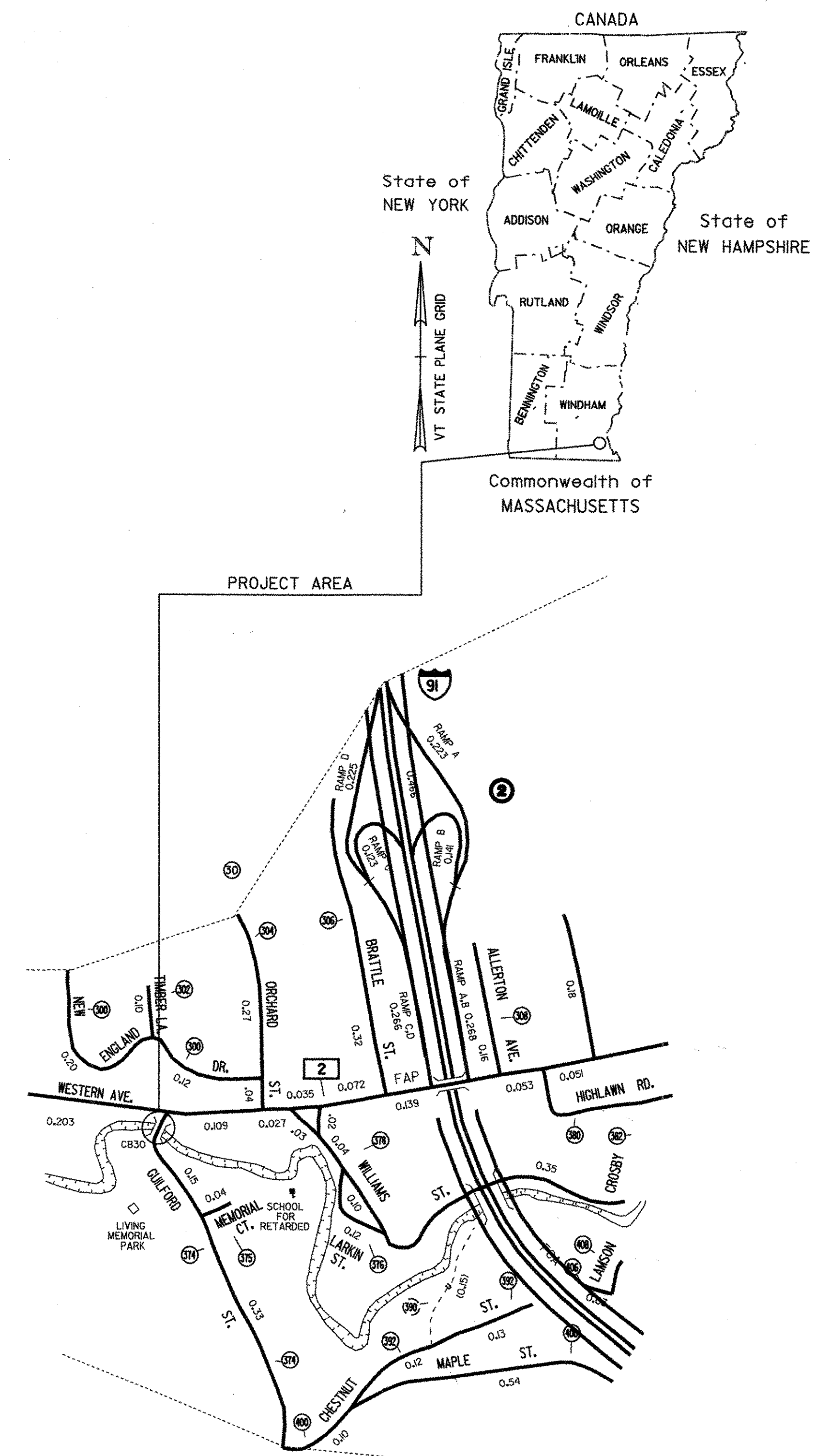
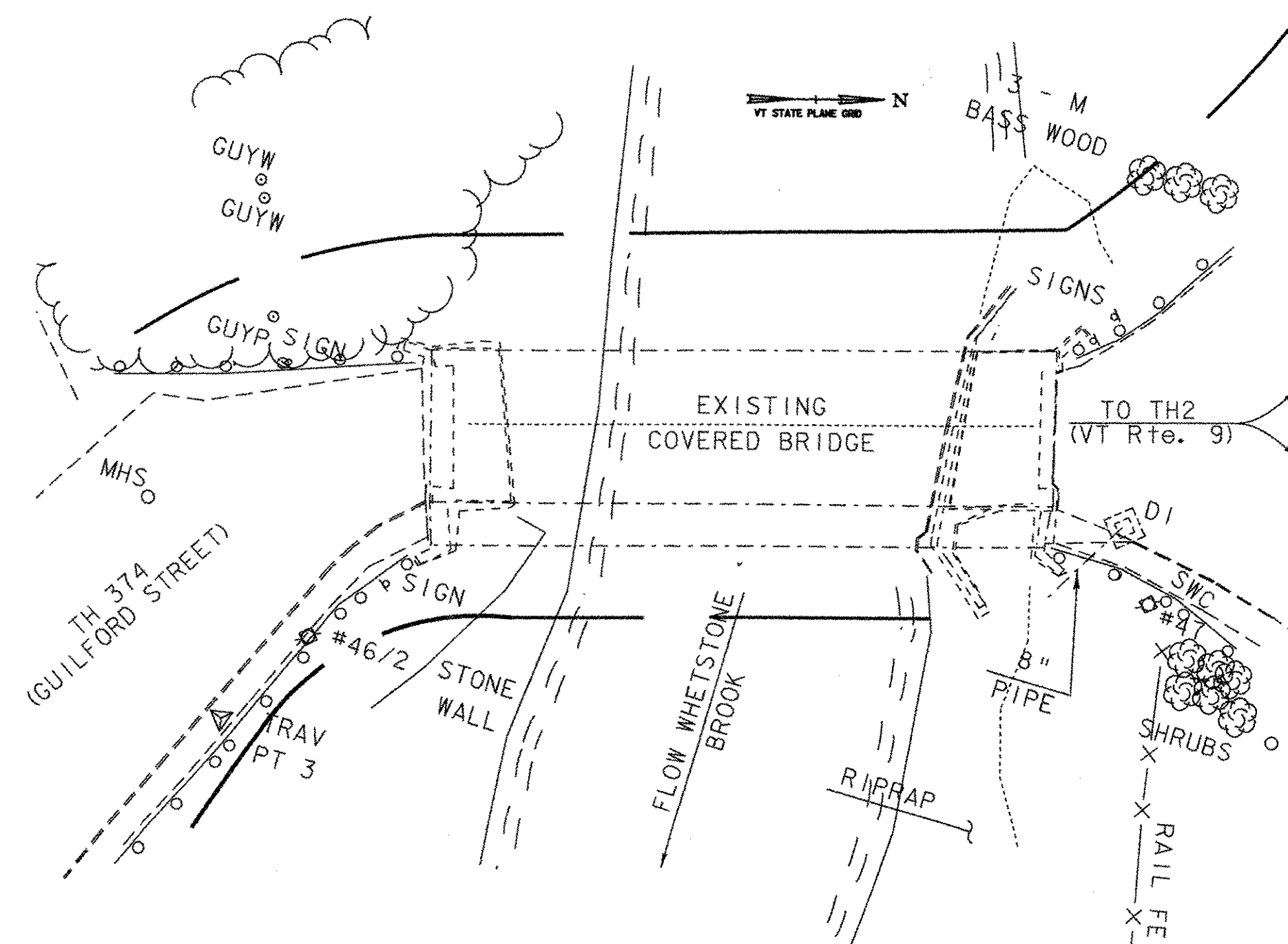

THESE PLANS ARE SUBJECT TO SUCH ENGINEERING CHANGES AS MAY BE REQUIRED BY THE FEDERAL HIGHWAY ADMINISTRATION OR THE DIRECTOR OF PROGRAM DEVELOPMENT.

CONSTRUCTION IS TO BE CARRIED ON IN ACCORDANCE WITH THESE PLANS AND THE STANDARD SPECIFICATIONS FOR CONSTRUCTION DATED 2001, AS APPROVED BY THE FEDERAL HIGHWAY ADMINISTRATION ON JANUARY 4, 2001 FOR USE ON THIS PROJECT, INCLUDING ALL SUBSEQUENT REVISIONS AND SUCH REVISED SPECIFICATIONS AND SPECIAL PROVISIONS AS ARE INCORPORATED IN THESE PLANS.

DEPARTMENT OF TRANSPORTATION FEDERAL HIGHWAY ADMINISTRATOR	
APPROVED <i>Mark D. Riebler</i>	DATE 9-6-06
DIRECTOR OF PROGRAM DEVELOPMENT	
APPROVED <i>Richard J. Weaver</i>	DATE 8-1-06
PROJECT MANAGER : J. WEAVER	
PROJECT : BRATTLEBORO BHO 1442 (33) (Re-advertised)	
SHEET 1 OF 8 SHEETS	