

STATE OF VERMONT AGENCY OF TRANSPORTATION



PROPOSED IMPROVEMENTS TOWNS OF WATERVILLE, CAMBRIDGE and JOHNSON COUNTY OF LAMOILLE MAJ-0274 (HOGBACK ROAD) TH-4

BEGINNING IN THE TOWN OF WATERVILLE AT STA 0+00 (MM 0.000)
AT THE INTERSECTION OF VT ROUTE 109 AND HOGBACK ROAD AND EXTENDING
EASTERLY ALONG HOGBACK ROAD FOR A DISTANCE OF APPROXIMATELY
24,021.6 FEET (4,550 MILES) THROUGH THE TOWN OF CAMBRIDGE AND INTO
THE TOWN OF JOHNSON TO STATION 123+00 (M.M.2.330).

STATION TO STATION DATA	LENGTH (FEET)	(MILES)
TOWN OF WATERVILLE STA 0+00 TO STA 2+11.2 (MM 0.000 TO MM 0.040)	211.2	0.040
TOWN OF CAMBRIDGE STA 0+00 TO STA 115+10.4 (MM 0.000 TO MM 2.180)	11,510.4	2.180
TOWN OF JOHNSON STA 0+00 TO STA 123+00 (MM 0.000 TO MM 2.330)	12,300	2.330
PROJECT TOTALS	24,021.6	4.550

WORK TO BE PERFORMED UNDER THIS PROJECT INCLUDES RESURFACING OF THE EXISTING
HIGHWAY WITH A COMBINATION OF RECLAIMING, BASE, AND WEARING COURSES, NEW PAVEMENT
MARKINGS, GUARD RAIL INSTALLATION, DRAINAGE IMPROVEMENTS AND INCIDENTAL ITEMS.

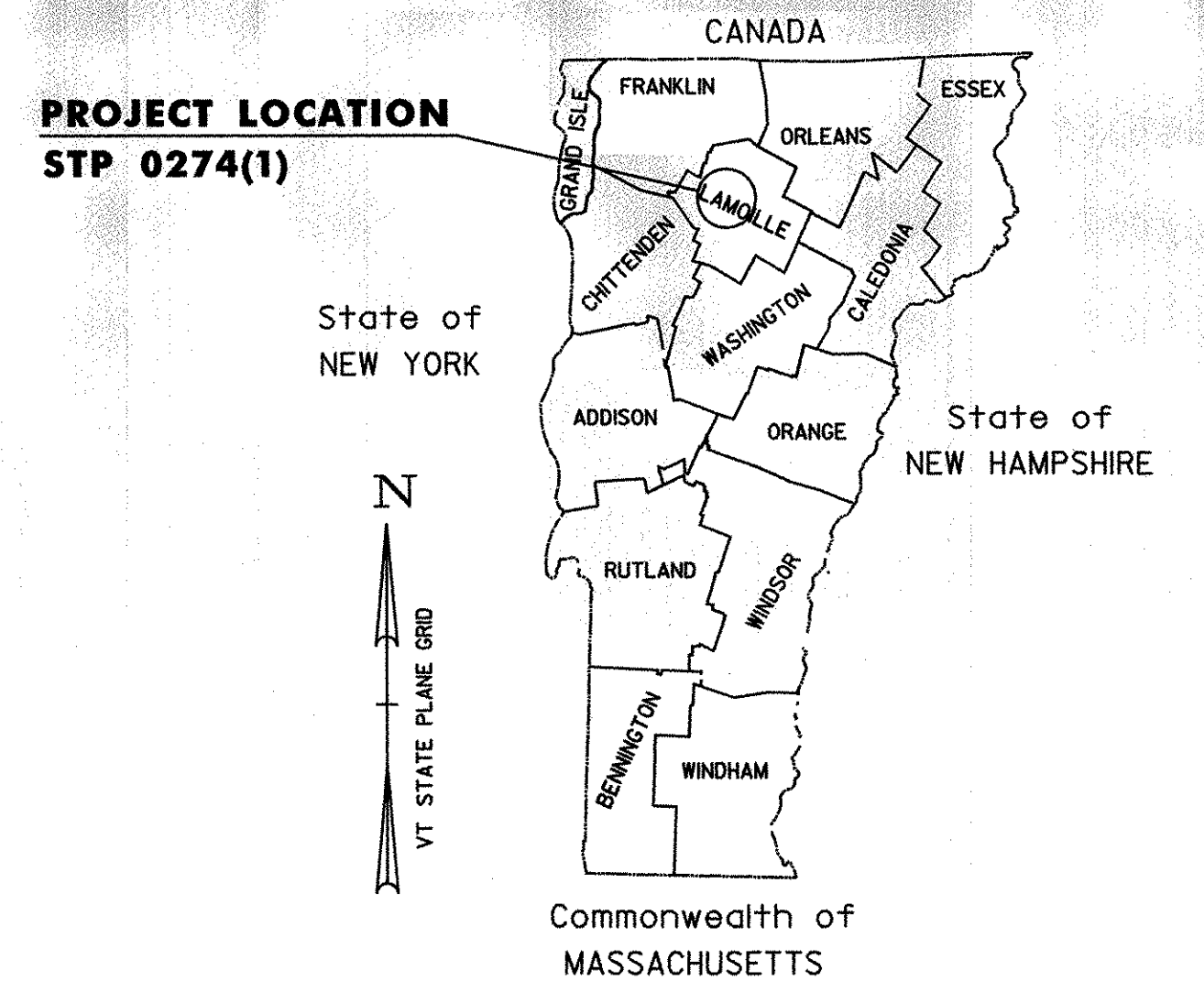
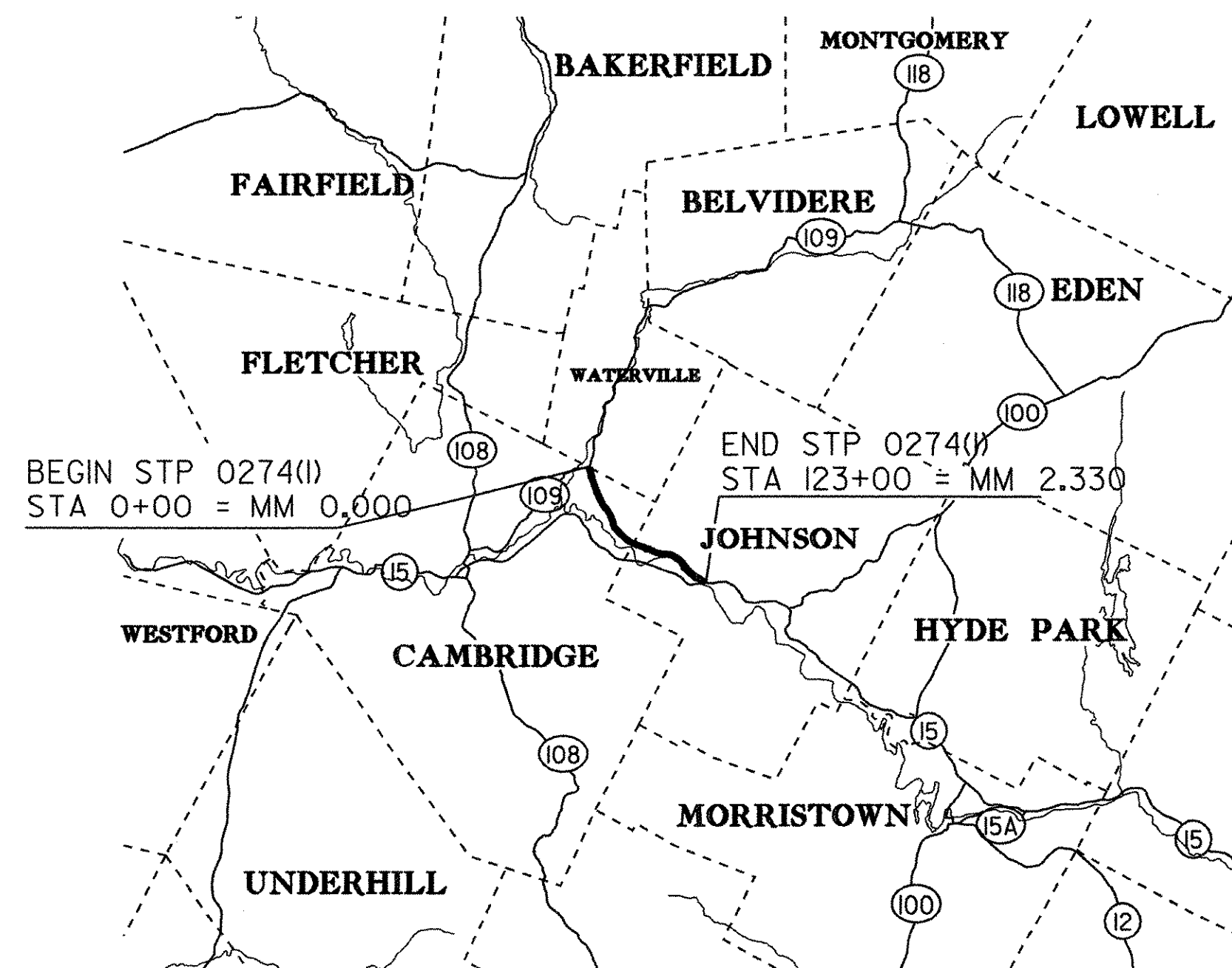

TRAFFIC DATA

	ADT			DHV			ESAL'S (2006-2016)	ESAL'S (2006-2026)
	2006	2016	2026	2006	2016	2026		
INTERSECTION OF VT ROUTE 109 AND HOGBACK ROAD, WATERVILLE MM 0.000 (BEGIN PROJECT) TO JOHNSON MM 2.330 (END PROJECT)	1,100	1,300	1,500	150	175	195	96,000	236,000

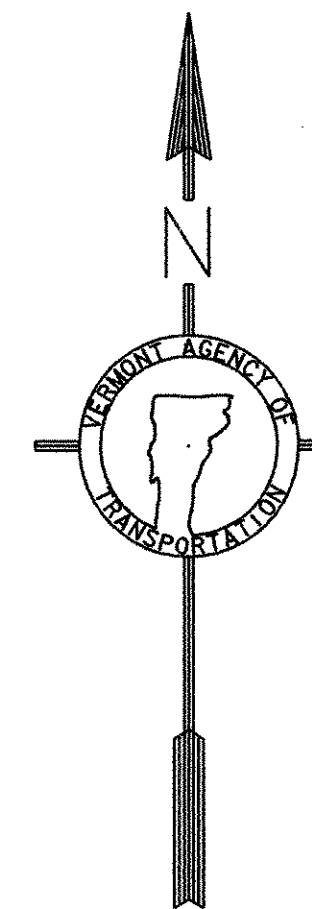

RIGHT-OF-WAY LIMITS, IF APPLICABLE, ARE PROVIDED SOLELY FOR THE CONVENIENCE OF THE STATE AND ITS CONTRACTOR DURING THE COURSE OF THIS PAVING PROJECT. ANY REFERENCES TO OFFSETS ON THESE PLANS ARE APPROXIMATE AND SHOULD NOT BE RELIED UPON FOR ANY OTHER PURPOSES.

UNLESS OTHERWISE NOTED, ALL DRAWINGS AND DETAILS ON THESE PLANS ARE DRAWN "NOT TO SCALE".

THESE PLANS ARE SUBJECT TO SUCH ENGINEERING CHANGES AS MAY BE REQUIRED BY THE FEDERAL HIGHWAY ADMINISTRATION OR THE DIRECTOR OF PROGRAM DEVELOPMENT.

CONSTRUCTION IS TO BE CARRIED ON IN ACCORDANCE WITH THESE PLANS AND THE STANDARD SPECIFICATIONS FOR CONSTRUCTION DATED 2001, AS APPROVED BY THE FEDERAL HIGHWAY ADMINISTRATION ON JANUARY 4, 2001 FOR USE ON THIS PROJECT, INCLUDING ALL SUBSEQUENT REVISIONS AND SUCH REVISED SPECIFICATIONS AND SPECIAL PROVISIONS AS ARE INCORPORATED IN THESE PLANS.

DIRECTOR OF PROGRAM DEVELOPMENT	
APPROVED <i>[Signature]</i>	DATE Dec 4 2006
PROJECT MANAGER : WOOLLAVER	
PROJECT NAME : CAMBRIDGE - JOHNSON	
PROJECT NUMBER : STP 0274(1) (RE-ADVERTISED)	
SHEET 1 OF 18 SHEETS	

INDEX OF SHEETS

1	TITLE SHEET
2-3	PROJECT TYPICAL SHEETS - ALTERNATE A
4-5	PROJECT TYPICAL SHEETS - ALTERNATE B
6-7	QUANTITY SHEETS
8	ITEM DETAIL SUMMARY SHEET
9-16	PAVING PROJECT LAYOUT SHEETS
17	TRAFFIC SIGN SUMMARY SHEET
18	CONSTRUCTION APPROACH SIGNING

VAOT STANDARDS

E-100	CONSTRUCTION APPROACH SIGNS	01-02-04
E-100A	SIDE ROAD CONSTRUCTION - APPROACH SIGNS	01-02-04
E-101	CONSTRUCTION SIGN DETAILS	05-30-03
E-102	CONSTRUCTION SIGN DETAILS	06-30-03
E-102A	CONSTRUCTION SIGN DETAILS	05-01-04
E-103	MAINLINE TRAFFIC CONTROL DETAILS	03-01-04
E-106	TRAFFIC CONTROL - MISCELLANEOUS DETAILS	03-01-04
E-107	DELINEATION, BARRICADES AND DETOURS FOR CONSTRUCTION AREAS	06-30-03
E-107A	BREAKAWAY BARRICADE DETAILS	08-08-95
E-110	MAJOR MAINTAINANCE OPERATION LANE CLOSURE	08-08-95
E-111	MAINTENANCE OPERATION APPROACH SIGNS	03-11-97
E-119	UTILITY WORK ZONE	03-01-04
E-120	STANDARD SIGN PLACEMENT - FREEWAY/EXPRESSWAY	08-08-95
E-121	STANDARD SIGN PLACEMENT - RURAL ROADS	08-08-95
E-141	REGULATORY SIGN DETAILS	09-20-95
E-143	REGULATORY SIGN DETAILS	06-15-04
E-146	REGULATORY SIGN DETAILS	09-20-05
E-150	WARNING SIGN DETAILS	05-01-04
E-160	FLANGED CHANNEL STEEL SIGN POST	05-20-99
E-164	SQUARE STEEL SIGN POSTS	05-20-99
E-191	PAVEMENT MARKING DETAILS	02-01-99
E-193	PAVEMENT MARKING DETAILS	08-18-95
G-1	STEEL BEAM GUARD RAIL	01-03-00
G-1D	STEEL BEAM GUARD RAIL	01-03-00
G-4	YIELDING MARKER POSTS	06-01-94
G-19	GENERIC GRADING PLANS FOR GUARDRAIL END TERMINALS	11-15-02

RECORD PLANS

CONTRACTOR:	THE GORMAN GROUP, LLC- ALBANY, NY
RESIDENT ENGINEER:	JEFF COTA
CONSTRUCTION BEGAN:	MAY 14, 2007
CONSTRUCTION COMPLETE:	OCTOBER 2, 2007
RECORD PLANS BY:	J. COTA & M. BOOTH

I HEREBY CERTIFY THAT ALL THE CONSTRUCTION REQUIRED BY THIS SET OF DRAWINGS HAS BEEN ACCOMPLISHED AS INDICATED HEREIN.

BY *[Signature]* RESIDENT ENGINEER
DATE 1/21/09

NOTE: Any further information concerning final quantities, amounts or other details relative to this project may be found at Central Files in the electronic archives.

CONVENTIONAL SIGNS

COUNTY LINE	---
TOWN LINE	----
LIMITS OF ACCESS	○-○-○-○
POINT OF ACCESS	X
FENCE LINE	-x-x-
STONE WALL	=====
TRAVELED WAY	=====
GUARD RAIL	○-○-○-○
RAILROAD	
SURVEY LINE	+
CULVERT	—+—+—+—+—
POWER POLE	⊙
TELEPHONE POLE	⊙
TREES	⊙ * ⊙
CONTROL OF ACCESS	—//—
PROPERTY LINE	---
R.O.W. TAKING LINE	---
SLOPE RIGHTS	—SR—
TOP OF CUT	—△—
TOE OF SLOPE	—○—

DATUM	
VERTICAL	N/A
HORIZONTAL	N/A

BY:



CIVIL ENGINEERING ASSOCIATES, INC.
P.O. BOX 488 SHELBURNE, VT 05482
802-985-2323 FAX: 802-985-2271 web: www.cea-vt.com

NOTES

1. THE PAVEMENT WEARING COURSE SHALL BE TYPE IV.
- ALL ASPHALT CEMENT USED IN THE BITUMINOUS CONCRETE PAVEMENT SHALL BE PG 58-28.
2. EMULSIFIED ASPHALT SHALL BE APPLIED BETWEEN ALL COURSES OF PAVEMENT AND ON COLD PLANED SURFACES AT THE RATE OF 0.025 GAL/SY OR AS DIRECTED BY THE RESIDENT ENGINEER.
3. BITUMINOUS CONCRETE PAVEMENT TOLERANCE = $\pm 1/4$ in (TOTAL THICKNESS EXCLUDING LEVELING).
4. THREE FEET OF BACKING IS REQUIRED BEHIND THE FACE OF GUARD RAIL WITH 6 ft POSTS. IF THIS CANNOT BE OBTAINED THEN 8ft POSTS SHALL BE USED.
5. ALL DRIVES AND TOWN HIGHWAYS SHALL RECEIVE A PAVED APRON AS DIRECTED BY THE RESIDENT ENGINEER. IF REQUIRED, A NEW SUBBASE SHALL BE CONSTRUCTED AND WILL BE PAID FOR UNDER ITEM 301.27, SUBBASE OF CRUSHED GRAVEL (FINE GRADED) TRUCK MEASUREMENT (MOD). A NEW BITUMINOUS SURFACE SHALL BE CONSTRUCTED AS DIRECTED AND WILL BE PAID FOR UNDER ITEM 406.27. ESTIMATED QUANTITIES OF THE ABOVE ITEMS HAVE BEEN INCLUDED TO PAY FOR THIS WORK.
6. AN ESTIMATED QUANTITY OF EARTH BORROW HAS BEEN INCLUDED FOR THE PROVISION OF CONSTRUCTING GUARD RAIL END SECTIONS THE QUANTITIES INCLUDED REFLECT 25 CUBIC YARDS OF EARTH BORROW FOR EACH GUARD RAIL TERMINAL.
7. BITUMINOUS CONCRETE PAVEMENT WORK, WHICH COULD INVOLVE SOME HAND-WORK (SUCH AS DRIVE AND SIDEROAD APPROACHES AND AROUND DRAINAGE/UTILITY STRUCTURES), SHALL BE PAID FOR AT THE CONTRACT UNIT PRICE FOR ITEM 406.27, MEDIUM DUTY BITUMINOUS CONCRETE PAVEMENT (PG 58-28).
8. YIELDING MARKER POSTS ARE TO BE USED TO REPLACE NON-YIELDING MARKER POSTS AT PIPE INLETS AND OUTLETS ONLY, AS DIRECTED BY THE RESIDENT ENGINEER.
9. COMPACTION, GRADING, AND CLEAN UP OF ITEM 301.27, SUBBASE OF CRUSHED GRAVEL (FINE GRADED) TRUCK MEASUREMENT (MOD) IS TO BE INCLUDED IN THE CONTRACT PRICE OF THE ITEM.
10. STABILIZING AGENT FOR THE RECLAIMED STABILIZED BASE WILL BE WATER. PAYMENT SHALL BE CONSIDERED INCIDENTAL TO ITEM 310.20.
11. AN ESTIMATED THICKNESS OF 6" OF CRUSHED GRAVEL FOR SUBBASE (FINE GRADED) TRUCK MEASUREMENT (MOD) HAS BEEN INCLUDED FOR THE PROVISION OF IMPROVING GRADATION DEFICIENCIES AND/OR CORRECTING SUPERELEVATION, AS NECESSARY, OR AS DIRECTED BY THE RESIDENT ENGINEER.

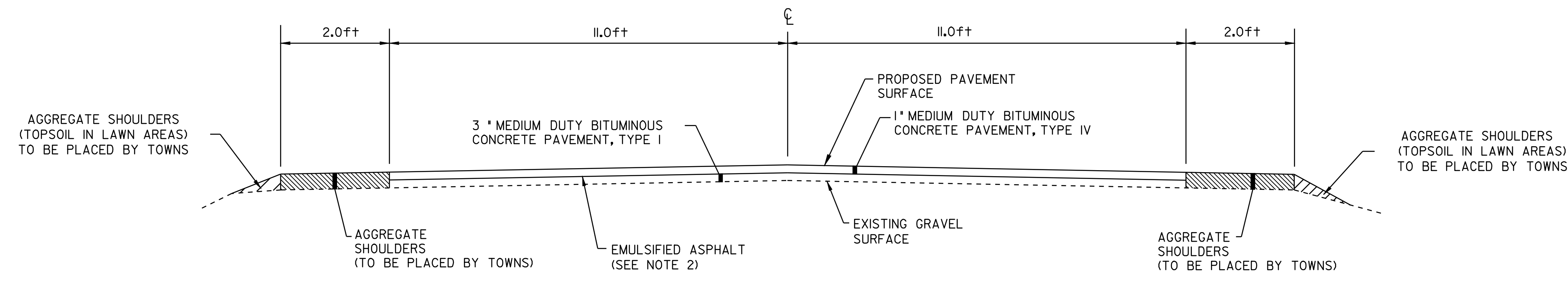

NEW PAVEMENT TYPICAL SECTION
WATERVILLE
STA 1+25 TO 2+11.2
CAMBRIDGE
STA 0+00 TO 115+10.4

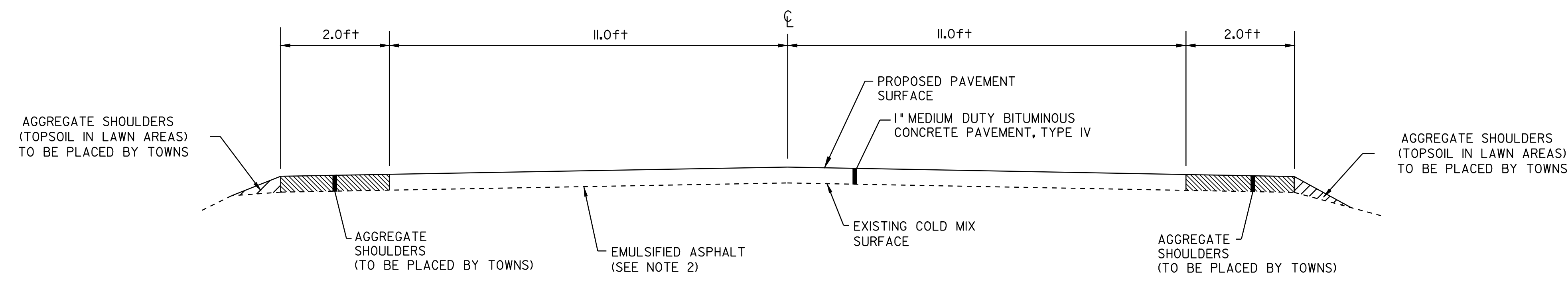

NEW PAVEMENT TYPICAL SECTION
JOHNSON
STA 0+00 TO 63+70

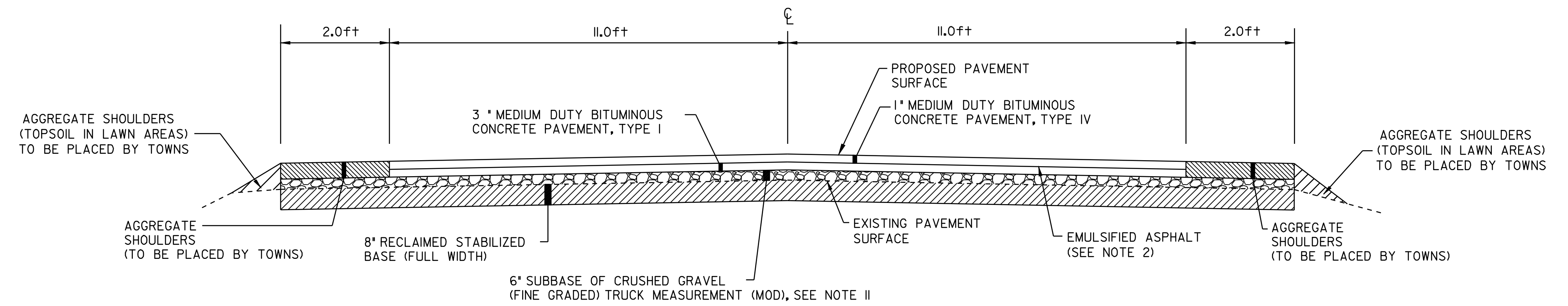

RECLAIM TYPICAL SECTION
JOHNSON
STA 63+70 TO 123+00

PROJECT TYPICAL SHEET #1 ALTERNATE A	DESIGNED BY	BCE/PJM	DATE	12-05
	DRAWN BY	C.E.A., INC.	DATE	12-05
	DESIGN FILE NO.	p05e402.dgn		
	PRF FILE	p05e402+yp1.1	DATE PLOTTED	03-FEB-2009
	PROJ. NAME	CAMBRIDGE - JOHNSON		
PROJ. NO.	STP 0274(1) (RE-ADVERTISED)			
SHEET	2	OF	18	SHEETS

PROJECT PAVING LIMITS

TOWN & ROUTE	BEGIN STATION	END STATION	LANE TYPICAL	WEARING DEPTH	LEVELING TONS	NOTES
WATERVILLE - HOGBACK ROAD	1+25	2+11.2	11.0FT-11.0FT	1"	--	PAVE WITH 3" TYPE I BASE COURSE AND TOP WITH 1" TYPE IV TOP COURSE, SHOULDERS NOT PAVED.
CAMBRIDGE - HOGBACK ROAD	0+00	115+10.4	11.0FT-11.0FT	1"	--	PAVE WITH 3" TYPE I BASE COURSE AND TOP WITH 1" TYPE IV TOP COURSE, SHOULDERS NOT PAVED.
JOHNSON - HOGBACK ROAD	0+00	63+70	11.0FT-11.0FT	1"	--	PAVE WITH 1" TYPE IV TOP COURSE, SHOULDERS NOT PAVED.
	63+70	123+00	11.0FT-11.0FT	1"	--	RECLAIM 8" w/6" SUBBASE, PAVE WITH 3" TYPE I BASE COURSE AND TOP WITH 1" TYPE IV TOP COURSE, SHOULDERS NOT PAVED.

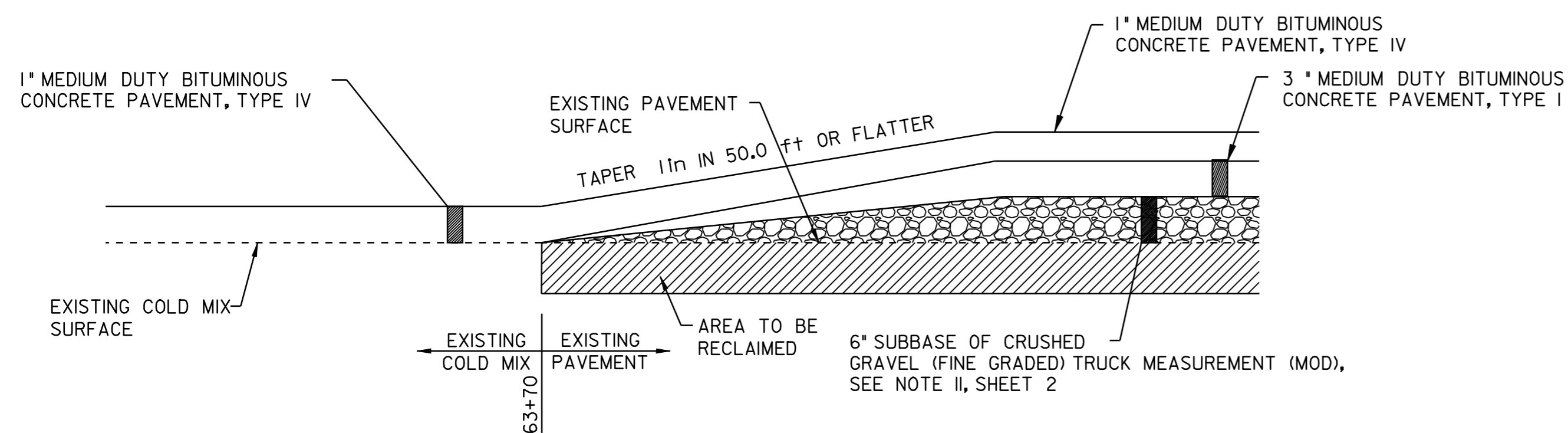

-TRANSITION AREA DETAIL-

JOHNSON
STA 63+70 (END NEW PAVEMENT/BEGIN RECLAIM)

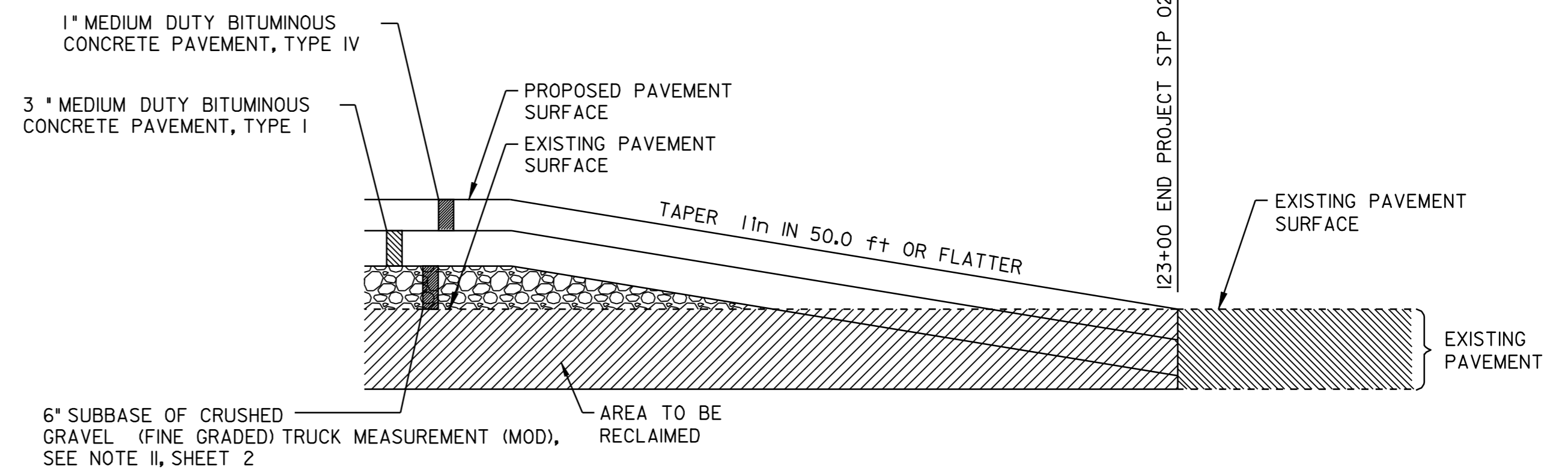

-APPROACH AREA DETAIL-

JOHNSON
STA 120+00 TO 123+00

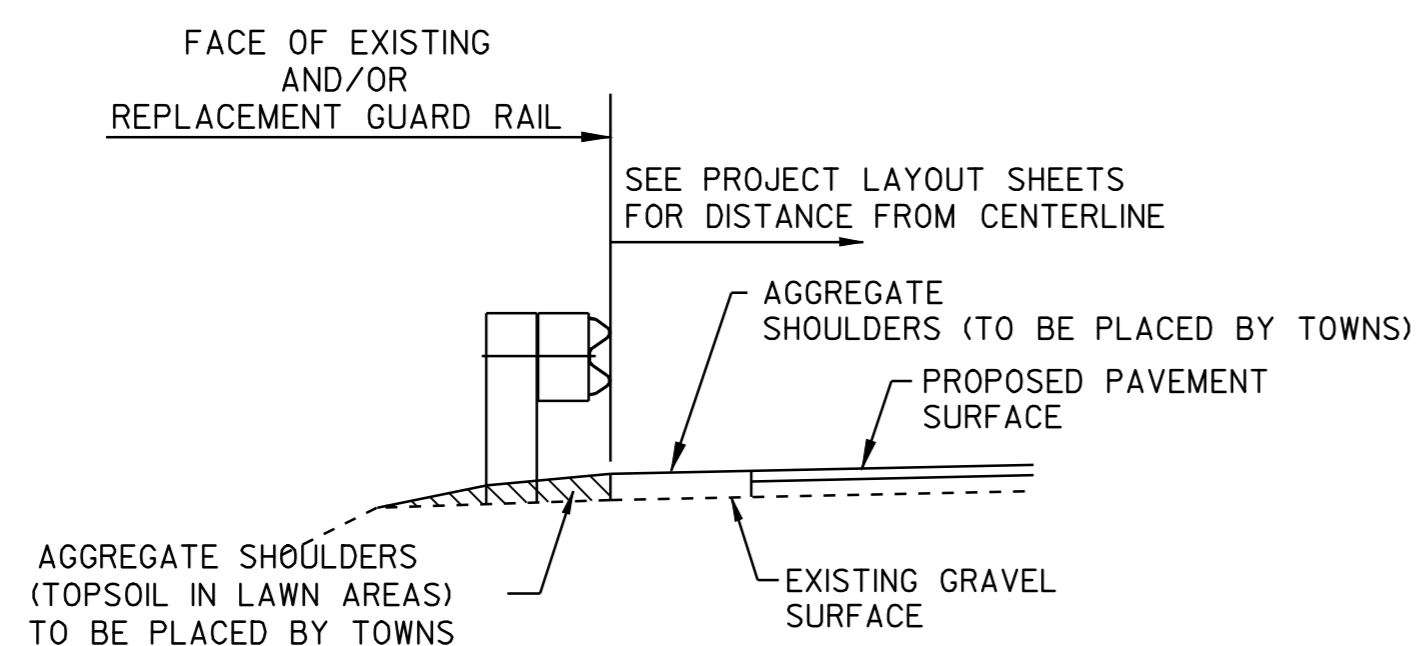

- TYPICAL SECTION AT GUARD RAIL - (@ EXISTING GRAVEL SECTION)

PROJECT TYPICAL SHEET #2 ALTERNATE A	DESIGNED BY	BCE/PJM	DATE	12-05
	DRAWN BY	C.E.A., INC.	DATE	12-05
	DESIGN FILE NO.	p05e402.dgn	PRF FILE	p05e402+yp2.i
	DATE PLOTTED	03-FEB-2009		
	PROJ. NAME	CAMBRIDGE - JOHNSON		
PROJ. NO.	STP 0274(1) (RE-ADVERTISED)			
SHEET	3	OF	18	SHEETS

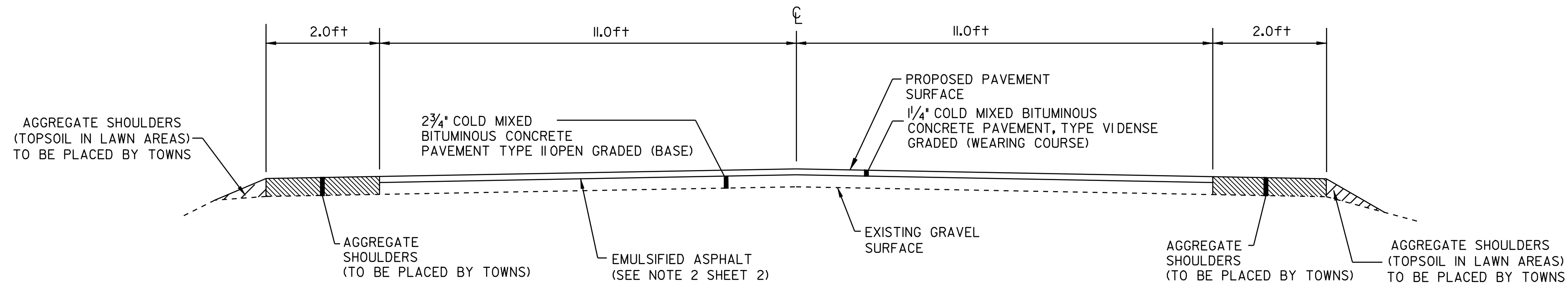

**COLD MIXED
BITUMINOUS PAVEMENT
NEW PAVEMENT TYPICAL SECTION
WATERVILLE
STA 1+25 TO 2+11.2
CAMBRIDGE
STA 0+00 TO 115+10.4**

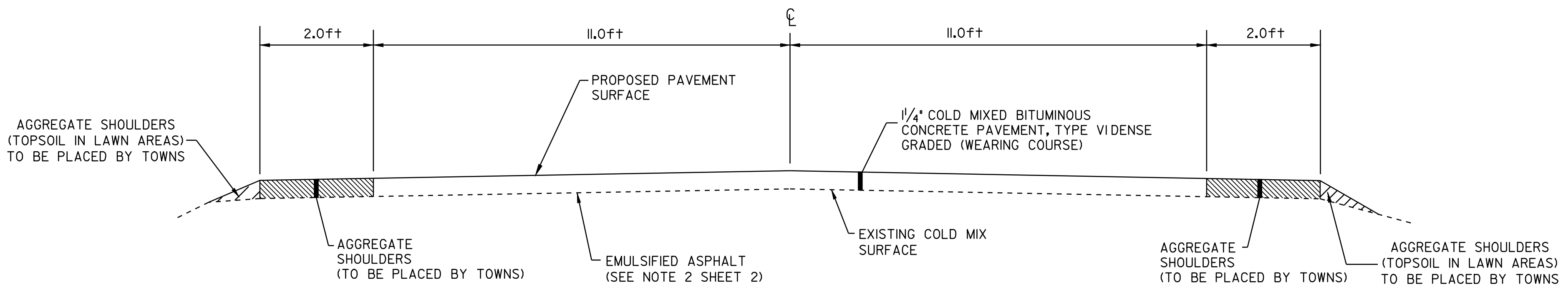

**COLD MIXED
BITUMINOUS PAVEMENT
NEW PAVEMENT TYPICAL SECTION
JOHNSON
STA 0+00 TO 63+70**

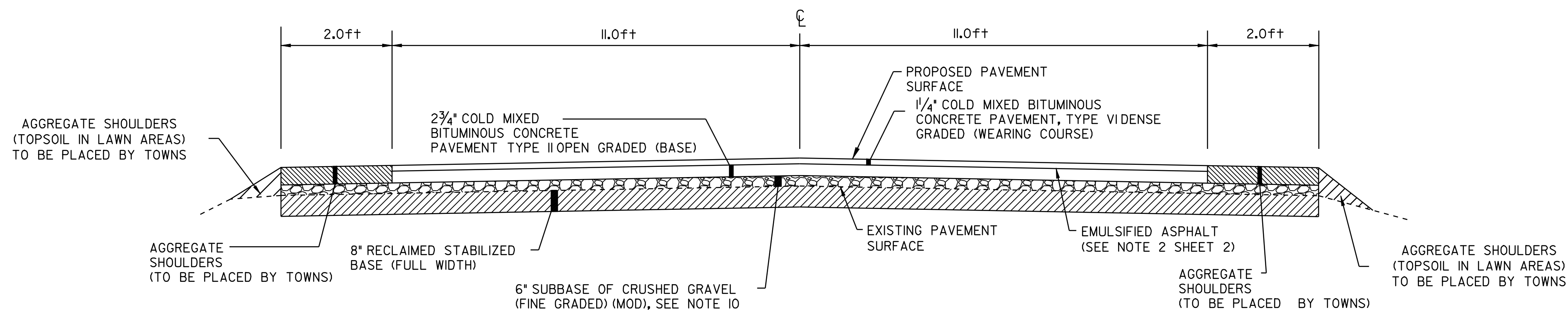

**COLD MIXED
BITUMINOUS PAVEMENT
RECLAIM TYPICAL SECTION
JOHNSON
STA 63+70 TO 123+00**

NOTES

1. THE PAVEMENT WEARING COURSE SHALL BE TYPE VIDENSE GRADED COLD MIX.
2. COLD MIXED BITUMINOUS CONCRETE PAVEMENT TOLERANCE = $\pm 1/4$ in (TOTAL THICKNESS EXCLUDING LEVELING).
3. THREE FEET OF BACKING IS REQUIRED BEHIND THE FACE OF GUARD RAIL WITH 6 ft POSTS. IF THIS CANNOT BE OBTAINED THEN 8ft POSTS SHALL BE USED.
4. ALL DRIVES AND TOWN HIGHWAYS SHALL RECEIVE A PAVED APRON AS DIRECTED BY THE RESIDENT ENGINEER. IF REQUIRED, A NEW SUBBASE SHALL BE CONSTRUCTED AND WILL BE PAID FOR UNDER ITEM 301.28, SUBBASE OF CRUSHED GRAVEL (FINE GRADED) (MOD). A NEW BITUMINOUS SURFACE SHALL BE CONSTRUCTED AS DIRECTED AND WILL BE PAID FOR UNDER ITEM 415.20. ESTIMATED QUANTITIES OF THE ABOVE ITEMS HAVE BEEN INCLUDED TO PAY FOR THIS WORK.
5. AN ESTIMATED QUANTITY OF EARTH BORROW HAS BEEN INCLUDED FOR THE PROVISION OF CONSTRUCTING GUARD RAIL END SECTIONS. THE QUANTITIES INCLUDED REFLECT 25 CUBIC YARDS OF EARTH BORROW FOR EACH GUARD RAIL TERMINAL.
6. COLD MIXED BITUMINOUS CONCRETE PAVEMENT WORK, WHICH COULD INVOLVE SOME HAND-WORK (SUCH AS DRIVE AND SIDEROAD APPROACHES AND AROUND DRAINAGE/UTILITY STRUCTURES), SHALL BE PAID FOR AT THE CONTRACT UNIT PRICE FOR ITEM 415.20, COLD MIXED BITUMINOUS PAVEMENT.
7. YIELDING MARKER POSTS ARE TO BE USED TO REPLACE NON-YIELDING MARKER POSTS AT PIPE INLETS AND OUTLETS ONLY, AS DIRECTED BY THE RESIDENT ENGINEER.
8. COMPACTION, GRADING, AND CLEAN UP OF ITEM 301.28, SUBBASE OF CRUSHED GRAVEL (FINE GRADED) (MOD) IS TO BE INCLUDED IN THE CONTRACT PRICE OF THE ITEM.
9. STABILIZING AGENT FOR THE RECLAIMED STABILIZED BASE WILL BE WATER. PAYMENT SHALL BE CONSIDERED INCIDENTAL TO ITEM 310.20.
10. AN ESTIMATED THICKNESS OF 6" OF CRUSHED GRAVEL FOR SUBBASE (FINE GRADED) (MOD) HAS BEEN INCLUDED FOR THE PROVISION OF IMPROVING GRADATION DEFICIENCIES AND/OR CORRECTING SUPERELEVATION, AS NECESSARY, OR AS DIRECTED BY THE RESIDENT ENGINEER.
11. ALL LIQUID BINDER USED IN COLD MIXED BITUMINOUS PAVEMENT, SHALL BE INCLUDED IN THE CONTRACT PRICE OF ITEM 415.20.

PROJECT TYPICAL SHEET #1 ALTERNATE B	DESIGNED BY	BCE/PJM	DATE	12-05
	DRAWN BY	C.E.A., INC.	DATE	12-05
	DESIGN FILE NO.	p05e402.dgn		
	PRF FILE	p05e402+yp3.1	DATE PLOTTED	03-FEB-2009
	PROJ. NAME	CAMBRIDGE - JOHNSON		
PROJ. NO.	STP 0274(1) (RE-ADVERTISED)			
SHEET	4	OF	18	SHEETS

PROJECT PAVING LIMITS

TOWN & ROUTE	BEGIN STATION	END STATION	LANE TYPICAL	WEARING DEPTH	LEVELING Tons	NOTES
WATERVILLE - HOGBACK ROAD	1+25	2+11.2	11.0FT-11.0FT	1 1/4"	--	PAVE WITH 2 3/4" TYPE II OPEN GRADED BASE COURSE AND TOP WITH 1 1/4" TYPE VIDENSE GRADED, SHOULDERS ARE NOT PAVED.
CAMBRIDGE - HOGBACK ROAD	0+00	115+10.4	11.0FT-11.0FT	1 1/4"	--	PAVE WITH 2 3/4" TYPE II OPEN GRADED BASE COURSE AND TOP WITH 1 1/4" TYPE VIDENSE GRADED, SHOULDERS ARE NOT PAVED.
JOHNSON - HOGBACK ROAD	0+00	63+70	11.0FT-11.0FT	1 1/4"	--	PAVE WITH 1 1/4" TYPE VIDENSE GRADED COLD MIXED RECYCLED TOP COURSE, SHOULDERS ARE NOT PAVED
	63+70	123+00	11.0FT-11.0FT	1 1/4"	--	RECLAIM 8" w/6" SUBBASE ,PAVE WITH 2 3/4" TYPE II OPEN GRADED BASE COURSE AND TOP WITH 1 1/4" TYPE VIDENSE GRADED, SHOULDERS ARE NOT PAVED.

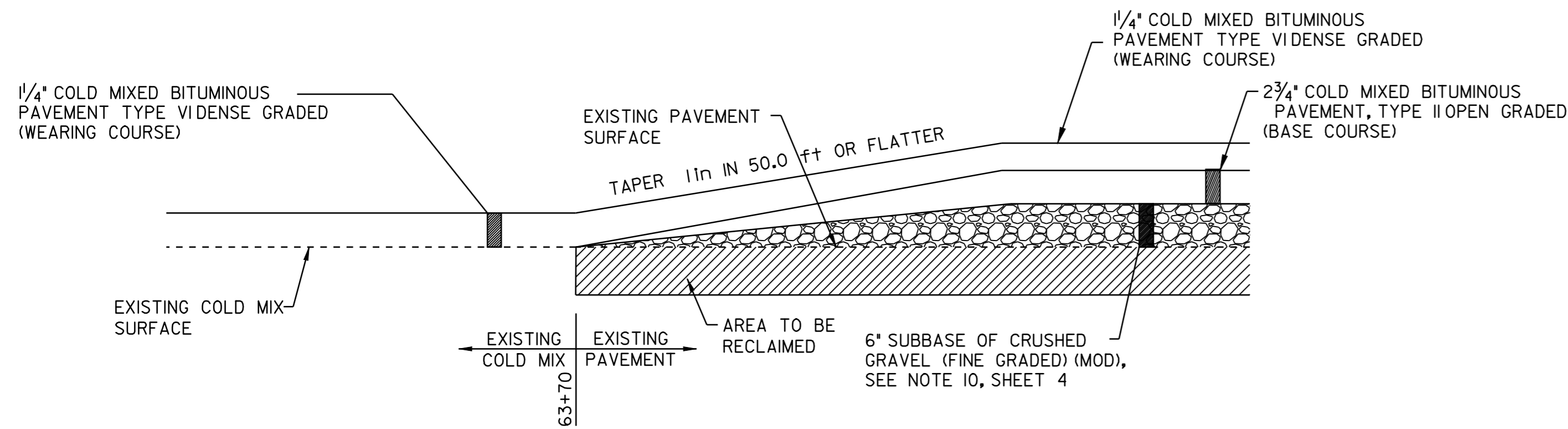

-TRANSITION AREA DETAIL-

JOHNSON
STA 63+70 (END NEW PAVEMENT/BEGIN RECLAIM)

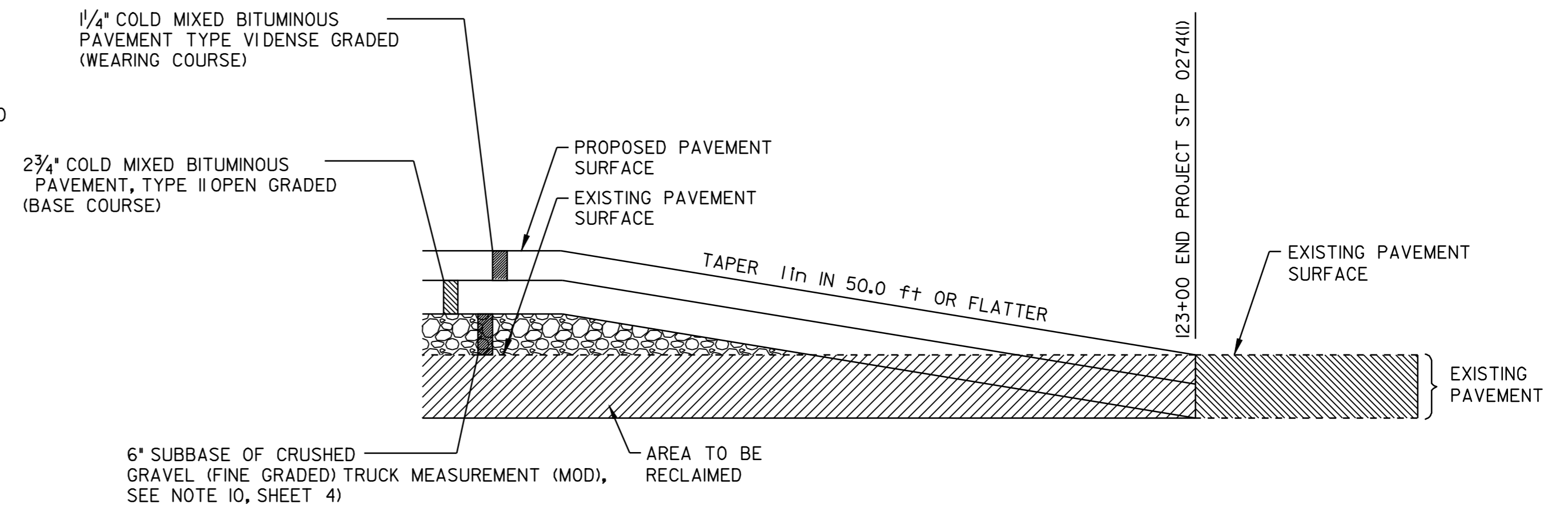

-APPROACH AREA DETAIL-

JOHNSON
STA 119+75 TO 123+00

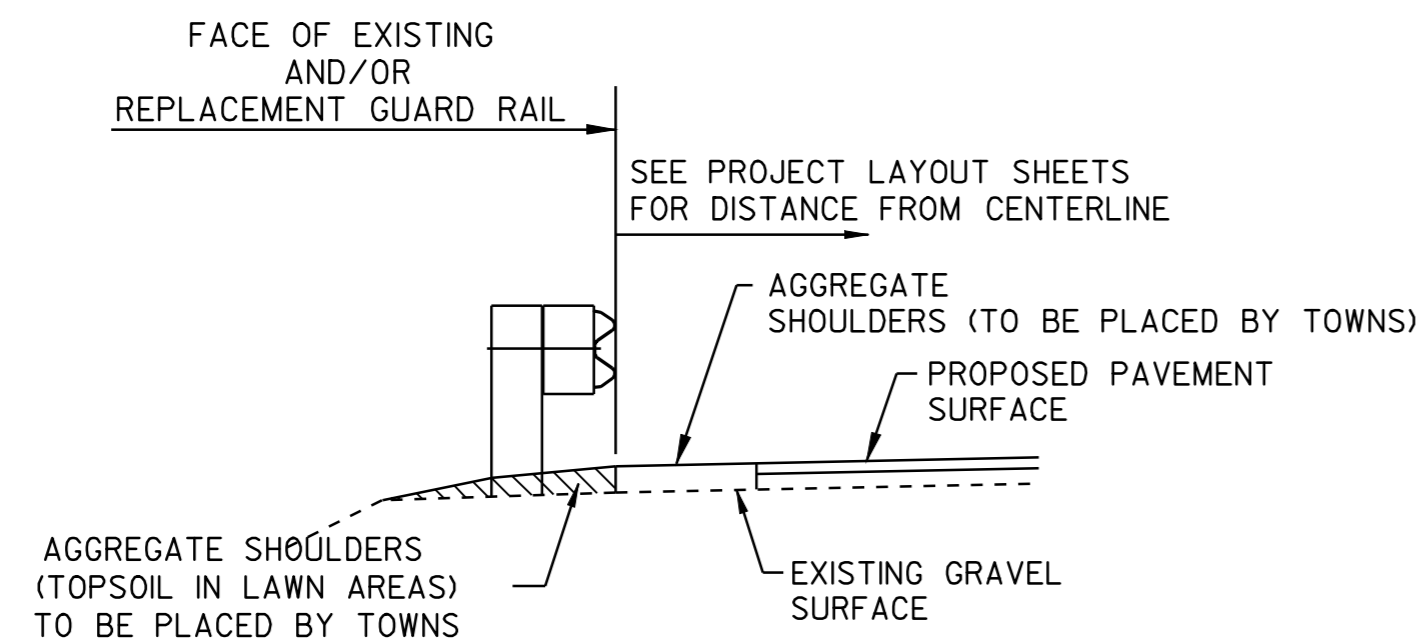

- TYPICAL SECTION AT GUARD RAIL -

(© EXISTING GRAVEL SECTION)

PROJECT TYPICAL SHEET #2 ALTERNATE B	DESIGNED BY	BCE/PJM	DATE	12-05
	DRAWN BY	C.E.A., INC.	DATE	12-05
	DESIGN FILE NO.	p05e402.dgn		
	PRF FILE	p05e402+yp4.i	DATE PLOTTED	03-FEB-2009 15
	PROJ. NAME	CAMBRIDGE - JOHNSON		
PROJ. NO.	STP 0274(1) (RE-ADVERTISED)			
SHEET	5	OF	18	SHEETS

ITEM DETAIL SUMMARY SHEET

LOCATION			MISCELLANEOUS ITEMS											DRAINAGE ITEMS								GUARD RAIL ITEMS											REMARKS	
STA	STA	POS.	203.15	203.28	203.30		204.20	301.27	402.12	402.12	616.41	649.51	654.10	604.412	NEW PIPE					613.10	605.10	619.17	621.20		621.21	621.505	621.60	621.76	621.77	621.80	621.81	676.10		
			COM. EXCAV.	EXCAV. OF PAVE. & SURFACES	EARTH BORROW	WASTE DITCHING MATERIAL	TRENCH EXCAV. OF EARTH	SUBBASE OF CRUSHED GRAVEL (MOD.)	AGG. SHOULD. ALT. A	AGG. SHOULD. ALT. B	REMOVAL OF EXISTING CURB	GEOTEXT. FOR SILT FENCE	EROSION MATTING	REHAB. D.I. CLASS I	DIA.	CSP (0.064)	RCP	CPEP	CSPE (0.064)	STONE FILL TYPE I	6" UNDER-DRAIN	YIELD. MARKER POSTS	STEEL BEAM G.R. (MOD.)	STEEL BEAM G.R. (8ft-MOD.) (MOD.)	HEAVY DUTY S.B. G.R.	MANUF. TERMINAL SECTION (FLARED)	ANCHOR FOR G.R.	REPLACE POST ASSEMBLY	REPLACE BEAM UNIT	REMOVE & DISP. OF G.R.	REMOVE & DISP. OF GUIDE POSTS	DELIN. w/STEEL POSTS		
CAMBRIDGE			CY	CY	CY	CY	CY	CY	TON	TON	LF	SY	SY	EA	in	FT	FT	FT	EA	CY	FT	EA	FT	FT	FT	EA	EA	EA	EA	FT	EA	EA		
0+00	115+10	LT&RT						40					400 0	200 0								2 5											ESTIMATED QUANTITIES TO BE USED AS DIRECTED BY THE RESIDENT ENGINEER.	
91+50	100+00	RT			50 0																		125	725			2					2	STEEL BEAM GUARD RAIL. NEW GUARD RAIL SECTION.	
JOHNSON																																		
0+00	125+66	LT&RT						1,015															2 6											ESTIMATED QUANTITIES TO BE USED AS DIRECTED BY THE RESIDENT ENGINEER.
44+30	55+55	RT			50 0																		670	455 0			2				11 50		2	REPLACE CABLE RAIL WITH STEEL BEAM GUARD RAIL.
50+00	52+62.5	RT																					216.5	262.5										
58+00	61+88	RT			50 0																		387.5	162.5			2						2	STEEL BEAM GUARD RAIL. NEW GUARD RAIL SECTION.
78+35	83+47	RT			50 12																		100	412.5			2				51 0		2	REPLACE CABLE RAIL WITH STEEL BEAM GUARD RAIL.
89+10	94+10	RT			50 24																		516.5	500			2				49 0		2	REPLACE GUIDE POSTS WITH STEEL BEAM GUARD RAIL.
SHEET SUB-TOTALS					250			1,055					400 0	200 0									4	1,782.5	1,592.5			10				1,580	49 0	10
ROUNDING					--			--					--	--									--	17.5	7.5			--				20.0	1 0	--
SHEET TOTALS					250			1,055					400 0	200 0									4	1,800.0	1,600			10				1,600	50 0	10
					36			3327															11	1714	1544						1150			

ITEM DETAIL SUMMARY SHEET

DESIGNED BY BCE/PJM DATE 12-05

DRAWN BY C.E.A., INC. DATE 12-05

DESIGN FILE NO. p05e402.dgn

PRF FILE p05e402ids.1 DATE PLOTTED 03-FEB-2009 15

PROJ. NAME: **CAMBRIDGE - JOHNSON**

PROJ. NO.: **STP 0274(1) (RE-ADVERTISED)**

SHEET **8** OF **18** SHEETS

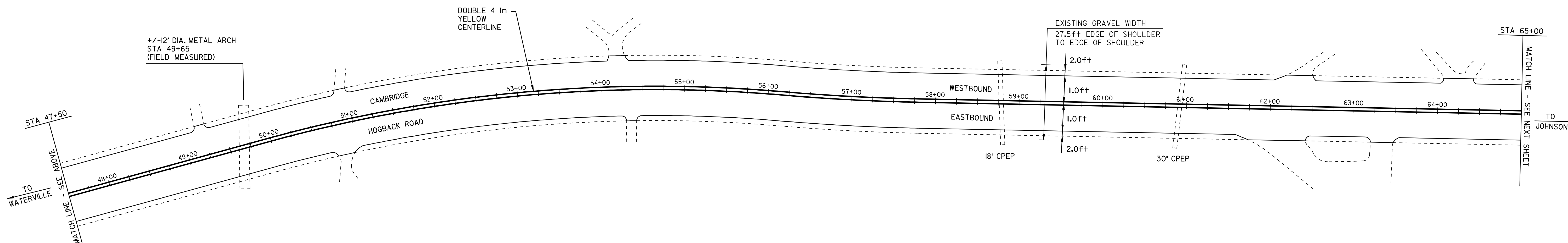
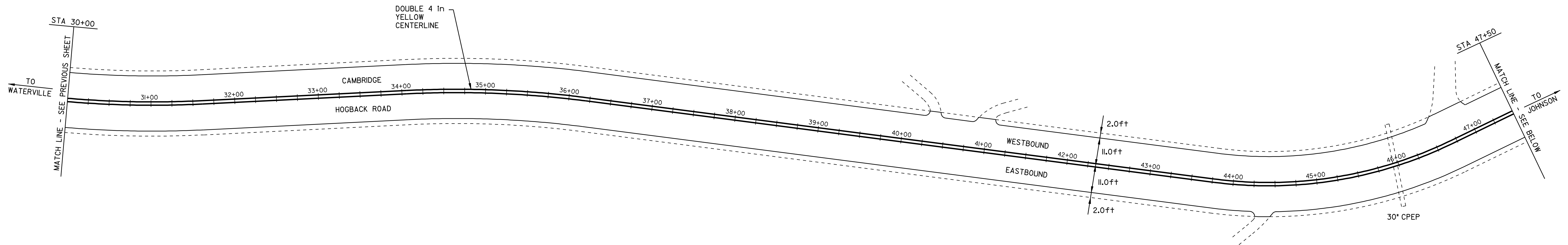

- LEGEND**
- N = NEW
 - R = REMOVE
 - R&S = REMOVE & SALVAGE
 - S = SALVAGE
 - RET = RETAIN
 - B-TO-B = BACK TO BACK
 - ⊕ □ = CATCH BASIN/DI
 - ⊙ □ = EXISTING THROAT DI
 - I = MARKER POST
 - ⌵ = UTILITY POLE
 - ⌵/⌵ = UTIL. POLE W/UNDERGROUND UTIL.
 - ⌵ = DRIVE
 - ⋯ = APPROXIMATE CULVERT LOCATION

PAVING PROJECT LAYOUT SHEET #2

DESIGNED BY BCE/PJM DATE 12-05

DRAWN BY C.E.A., INC. DATE 12-05

DESIGN FILE NO. p05e402.dgn

PRF FILE p05e402i02.i DATE 03-FEB-2009

PROJ. NAME **CAMBRIDGE - JOHNSON**

PROJ. NO. **STP 0274(1) (RE-ADVERTISED)**

SHEET **10** OF **18** SHEETS

4 In YELLOW LINE
 STA 65+00 TO 100+00 SOLID LT&RT
 TO BE DONE BY VAOT TRAFFIC SHOP

ANCHOR FOR STEEL BEAM RAIL
 STA 91+50 RT
 STA 100+00 RT

STEEL BEAM GUARD RAIL (GALVANIZED) (MOD.)
 STA 91+50 TO 92+75 RT

STEEL BEAM GUARD RAIL (GALVANIZED) (MOD. -8 ft POSTS) (MOD.)
 STA 92+75 TO 100+00 RT

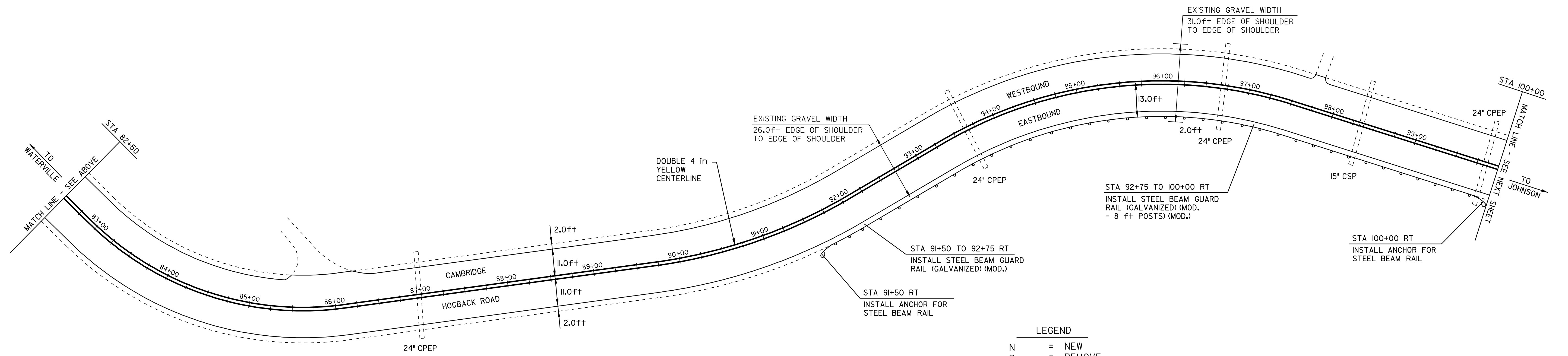
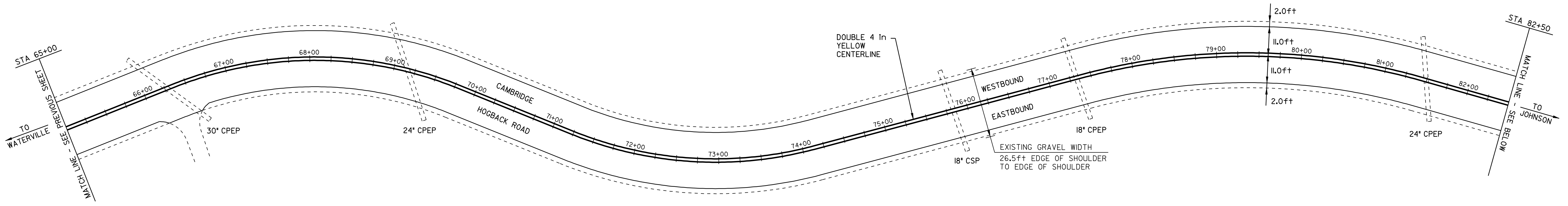

- LEGEND**
- N = NEW
 - R = REMOVE
 - R&S = REMOVE & SALVAGE
 - S = SALVAGE
 - RET = RETAIN
 - B-TO-B = BACK TO BACK
 - ⊕ □ = CATCH BASIN/DI
 - ⊙ □ = EXISTING THROAT DI
 - I = MARKER POST
 - ⋈ = UTILITY POLE
 - ⋈/⋈ = UTIL. POLE W/UNDERGROUND UTIL.
 - ⋈ = DRIVE
 - ⋈ = APPROXIMATE CULVERT LOCATION

PAVING PROJECT LAYOUT SHEET #3

DESIGNED BY	BCE/PJM	DATE	12-05
DRAWN BY	C.E.A., INC.	DATE	12-05
DESIGN FILE NO.	p05e402.dgn		
PRF FILE	p05e402i03.1	DATE PLOTTED	03-FEB-2009 13
PROJ. NAME	CAMBRIDGE - JOHNSON		
PROJ. NO.	STP 0274(1) (RE-ADVERTISED)		
SHEET	11	OF	18 SHEETS

4 in YELLOW LINE

CAMBRIDGE
 STA 100+00 TO 115+10.4 SOLID LT&RT
 JOHNSON
 STA 0+00 TO 15+00 SOLID LT&RT
 TO BE DONE BY VAOT TRAFFIC SHOP

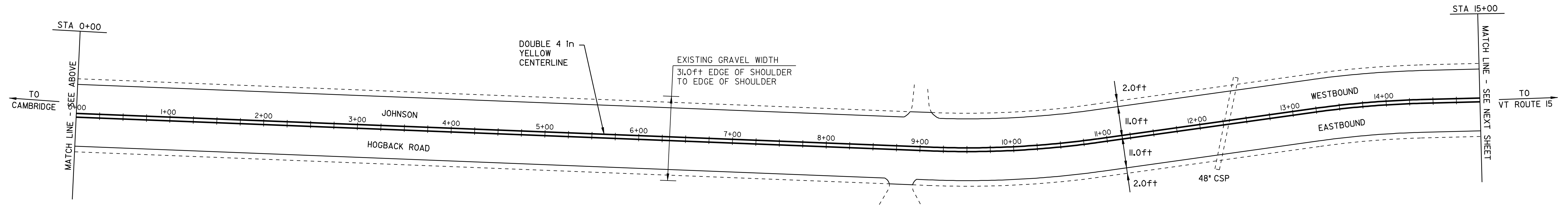
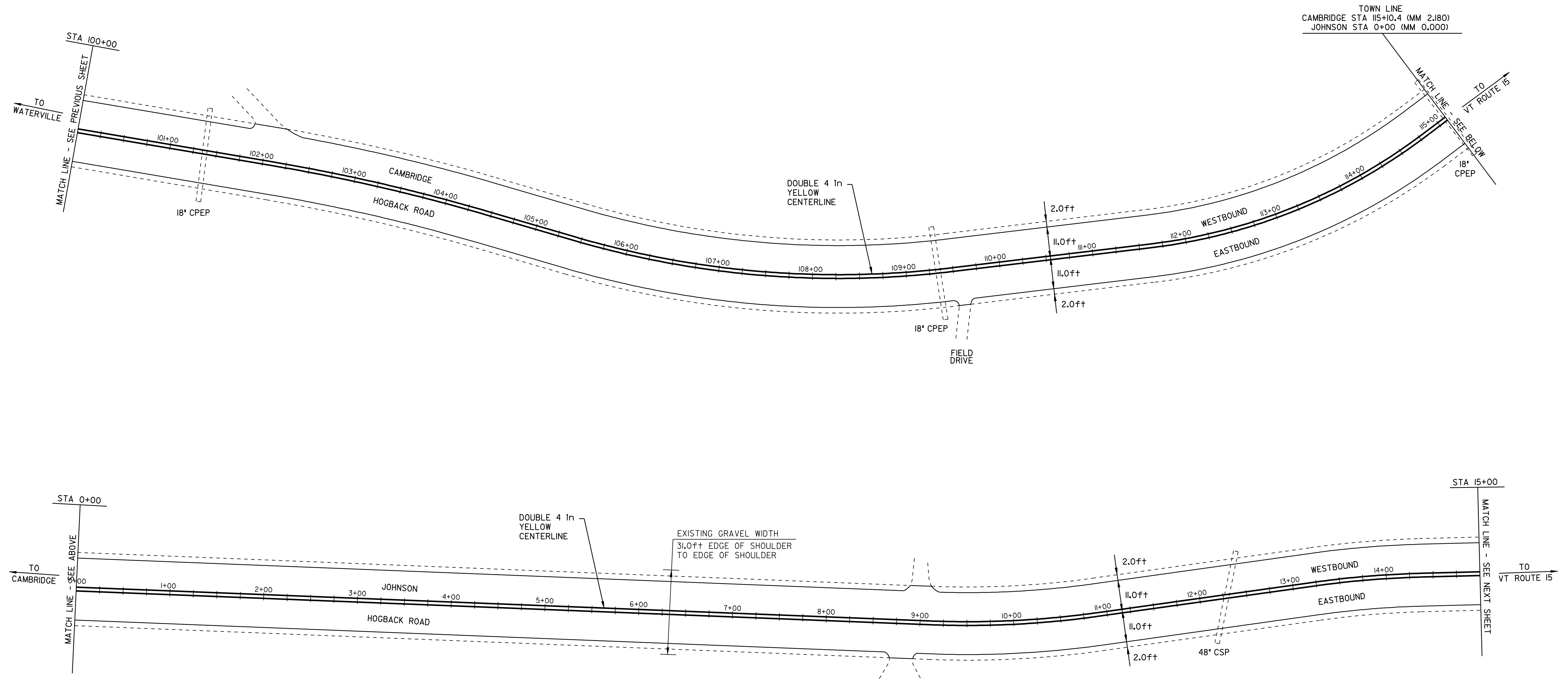

- LEGEND**
- N = NEW
 - R = REMOVE
 - R&S = REMOVE & SALVAGE
 - S = SALVAGE
 - RET = RETAIN
 - B-TO-B = BACK TO BACK
 - ⊕ □ = CATCH BASIN/DI
 - ⊕ □ = EXISTING THROAT DI
 - I = MARKER POST
 - ⊕ = UTILITY POLE
 - ⊕ / ⊕ = UTIL. POLE W/UNDERGROUND UTIL.
 - ⊕ = DRIVE
 - ⊕ = APPROXIMATE CULVERT LOCATION

PAVING PROJECT LAYOUT SHEET #4

DESIGNED BY BCE/PJM DATE 12-05

DRAWN BY C.E.A., INC. DATE 12-05

DESIGN FILE NO. p05e402.dgn

PRF FILE p05e402i04.1 DATE 03-FEB-2009

PROJ. NAME **CAMBRIDGE - JOHNSON**

PROJ. NO. **STP 0274(1) (RE-ADVERTISED)**

SHEET **12** OF **18** SHEETS

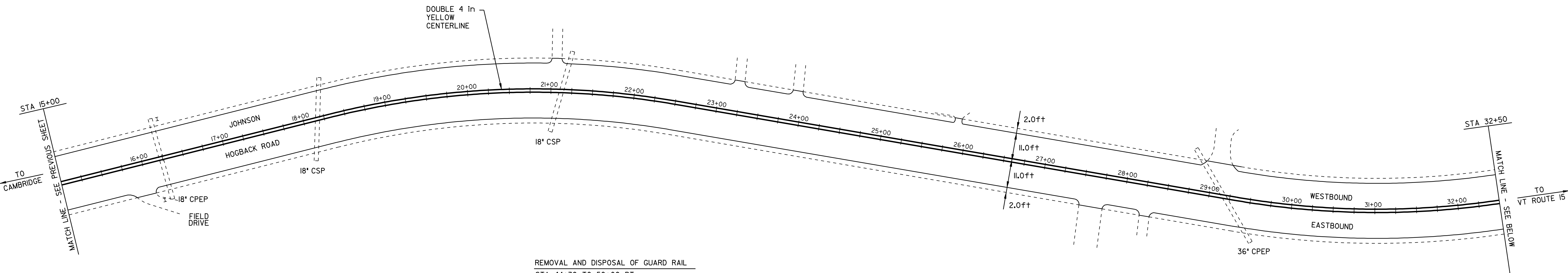

REMOVAL AND DISPOSAL OF GUARD RAIL
 STA 44+30 TO 50+00 RT

ANCHOR FOR STEEL BEAM RAIL
 STA 44+30 RT

STEEL BEAM GUARD RAIL (GALVANIZED) (MOD.)
 STA 44+30 TO 47+30 RT

STEEL BEAM GUARD RAIL (GALVANIZED) (MOD. - 8 ft POSTS) (MOD.)
 STA 47+30 TO 50+00 RT

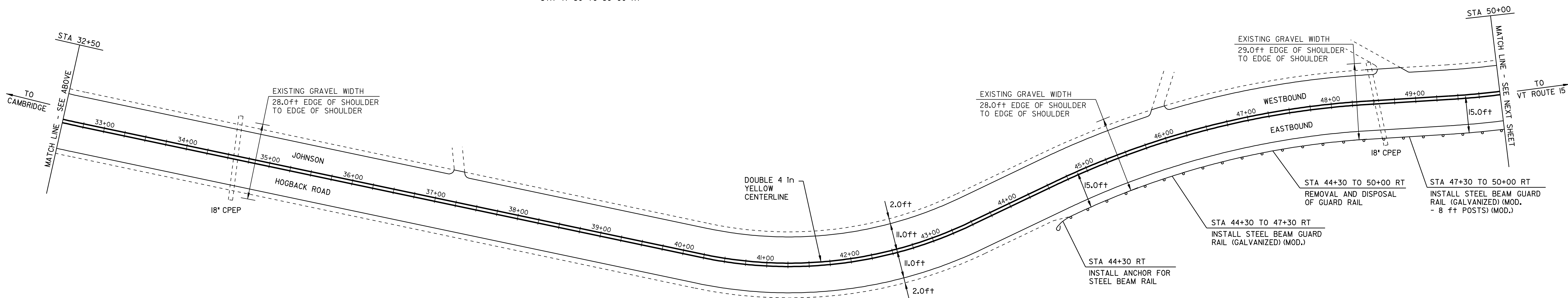

- LEGEND**
- N = NEW
 - R = REMOVE
 - R&S = REMOVE & SALVAGE
 - S = SALVAGE
 - RET = RETAIN
 - B-TO-B = BACK TO BACK
 - ⊕ □ = CATCH BASIN/DI
 - ⊙ □ = EXISTING THROAT DI
 - I = MARKER POST
 - ⌘ = UTILITY POLE
 - ⌘/⌘ = UTIL. POLE W/UNDERGROUND UTIL.
 - ⌘ = DRIVE
 - ⋯ = APPROXIMATE CULVERT LOCATION

PAVING PROJECT LAYOUT SHEET #5

DESIGNED BY	BCE/PJM	DATE	12-05
DRAWN BY	C.E.A., INC.	DATE	12-05
DESIGN FILE NO.	p05e402.dgn		
PRF FILE	p05e402i05.i	DATE PLOTTED	03-FEB-2009 13
PROJ. NAME	CAMBRIDGE - JOHNSON		
PROJ. NO.	STP 0274(1) (RE-ADVERTISED)		
SHEET	13	OF	18 SHEETS

REMOVAL AND DISPOSAL OF GUARD RAIL
 STA 50+00 TO 55+00 RT
 STA 78+35 TO 82+50 RT

STEEL BEAM GUARD RAIL (GALVANIZED) (MOD.)
 44+30 STA 54+00 TO 55+55 RT 89+10 TO 94+10 RT
 STA 58+00 TO 61+88 RT
 STA 78+35 TO 79+35 RT 83+47

ANCHOR FOR STEEL BEAM RAIL
 STA 55+55 RT
 STA 58+00 RT
 STA 61+88 RT
 STA 78+35 RT

STEEL BEAM GUARD RAIL (GALVANIZED) (MOD. - 8 ft POSTS) (MOD.)
 STA 50+00 TO 54+00 RT 58+00 TO 61+88 RT
 STA 79+35 TO 82+50 RT 50+00 TO 52+62.5 RT
 78+39 TO 83+47 RT

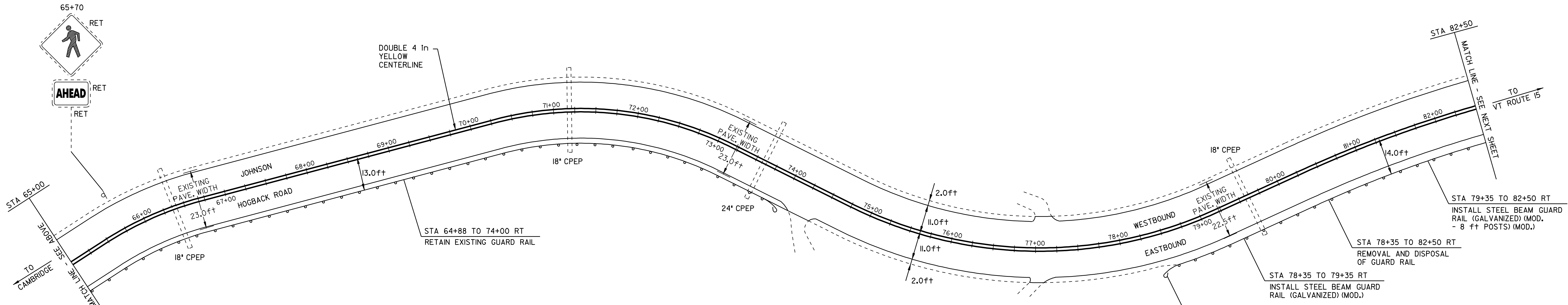
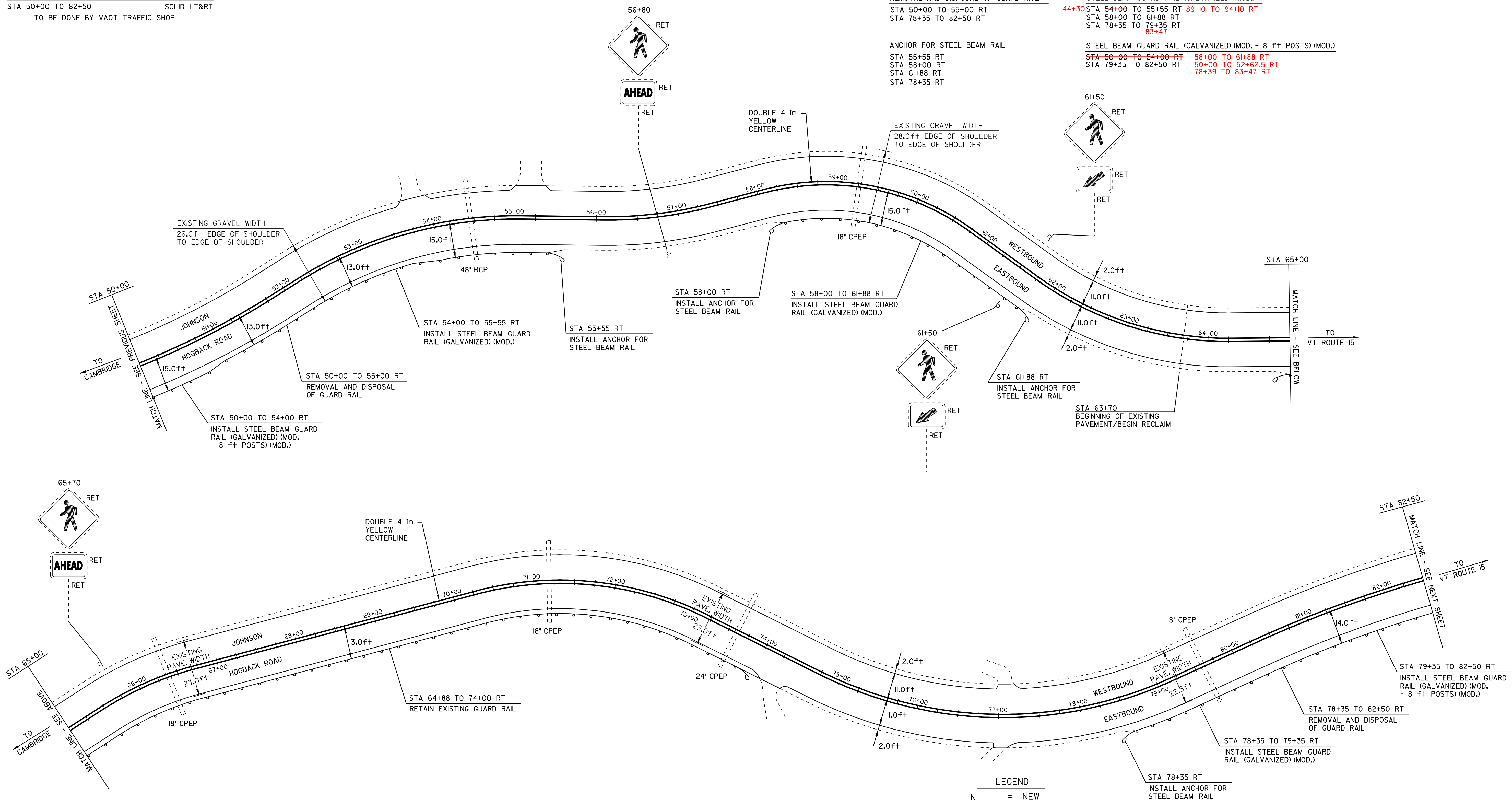

LEGEND

N	=	NEW
R	=	REMOVE
R&S	=	REMOVE & SALVAGE
S	=	SALVAGE
RET	=	RETAIN
B-TO-B	=	BACK TO BACK
⊕	=	CATCH BASIN/DI
⊙	=	EXISTING THROAT DI
I	=	MARKER POST
⋈	=	UTILITY POLE
⋈/⋈	=	UTIL. POLE W/UNDERGROUND UTIL.
---	=	DRIVE
---	=	APPROXIMATE CULVERT LOCATION

PAVING PROJECT LAYOUT SHEET #6

DESIGNED BY	BCE/PJM	DATE	12-05
DRAWN BY	C.E.A., INC.	DATE	12-05
DESIGN FILE NO.	p05e402.dgn		
PRF FILE	p05e402i06.1	DATE PLOTTED	03-FEB-2009 13
PROJ. NAME	CAMBRIDGE - JOHNSON		
PROJ. NO.	STP 0274(1) (RE-ADVERTISED)		
SHEET	14	OF	18 SHEETS

4 in YELLOW LINE
 STA 82+50 TO 117+50
 SOLID LT&RT
 TO BE DONE BY VAOT TRAFFIC SHOP

REMOVAL AND DISPOSAL OF GUARD RAIL
 STA 82+50 TO 83+47 RT

STEEL BEAM GUARD RAIL (GALVANIZED) (MOD.)
 STA 89+10 TO 94+10 RT

~~REMOVAL AND DISPOSAL OF GUIDE POSTS~~
~~STA 89+65 TO 93+92 RT - 49~~

STEEL BEAM GUARD RAIL (GALVANIZED) (MOD. - 8 ft POSTS) (MOD.)
 STA 82+50 TO 83+47 RT

ANCHOR FOR STEEL BEAM RAIL
 STA 83+47 RT
 STA 89+10 RT
 STA 94+10 RT

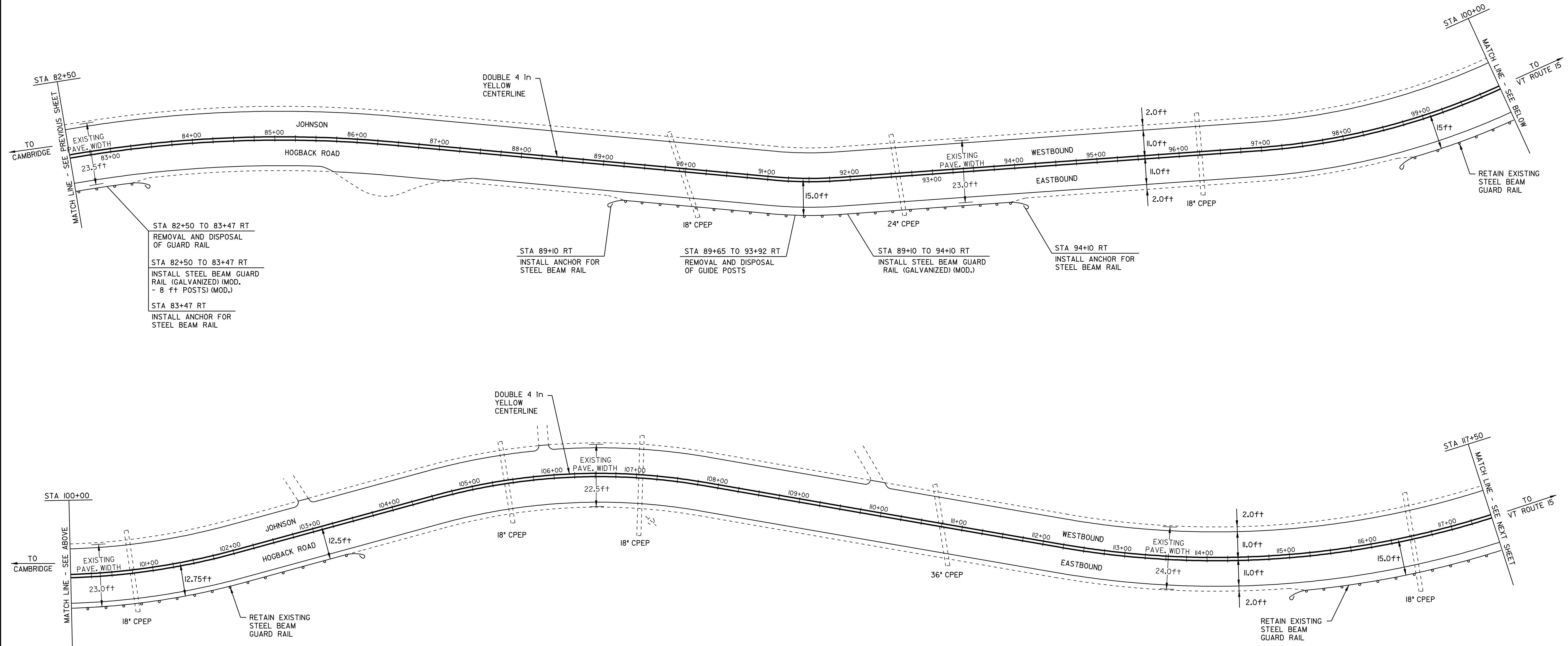

STA 82+50 TO 83+47 RT
 REMOVAL AND DISPOSAL
 OF GUARD RAIL
 STA 82+50 TO 83+47 RT
 INSTALL STEEL BEAM GUARD
 RAIL (GALVANIZED) (MOD.
 - 8 ft POSTS) (MOD.)
 STA 83+47 RT
 INSTALL ANCHOR FOR
 STEEL BEAM RAIL

STA 89+10 RT
 INSTALL ANCHOR FOR
 STEEL BEAM RAIL

STA 89+65 TO 93+92 RT
 REMOVAL AND DISPOSAL
 OF GUIDE POSTS

STA 89+10 TO 94+10 RT
 INSTALL STEEL BEAM GUARD
 RAIL (GALVANIZED) (MOD.)

STA 94+10 RT
 INSTALL ANCHOR FOR
 STEEL BEAM RAIL

LEGEND

N	=	NEW
R	=	REMOVE
R&S	=	REMOVE & SALVAGE
S	=	SALVAGE
RET	=	RETAIN
B-TO-B	=	BACK TO BACK
⊕	⊞	CATCH BASIN/DI
⊙	⊞	EXISTING THROAT DI
I		MARKER POST
⋈		UTILITY POLE
⋈	⋈	UTIL. POLE W/UNDERGROUND UTIL.
---		DRIVE
---		APPROXIMATE CULVERT LOCATION

PAVING PROJECT LAYOUT SHEET #7

DESIGNED BY	BCE/PJM	DATE	12-05
DRAWN BY	C.E.A., INC.	DATE	12-05
DESIGN FILE NO.	p05e402.dgn		
PRF FILE	p05e402107.1	DATE PLOTTED	03-FEB-2009 13
PROJ. NAME	CAMBRIDGE - JOHNSON		
PROJ. NO.	STP 0274(1) (RE-ADVERTISED)		
SHEET	15	OF	18 SHEETS

4 in YELLOW LINE
 STA 117+50 TO 123+00 SOLID LT&RT
 TO BE DONE BY VAOT TRAFFIC SHOP

LETTER OR SYMBOL
 STA 119+75 RT *STOP AHEAD*

REMOVING SIGNS
 4

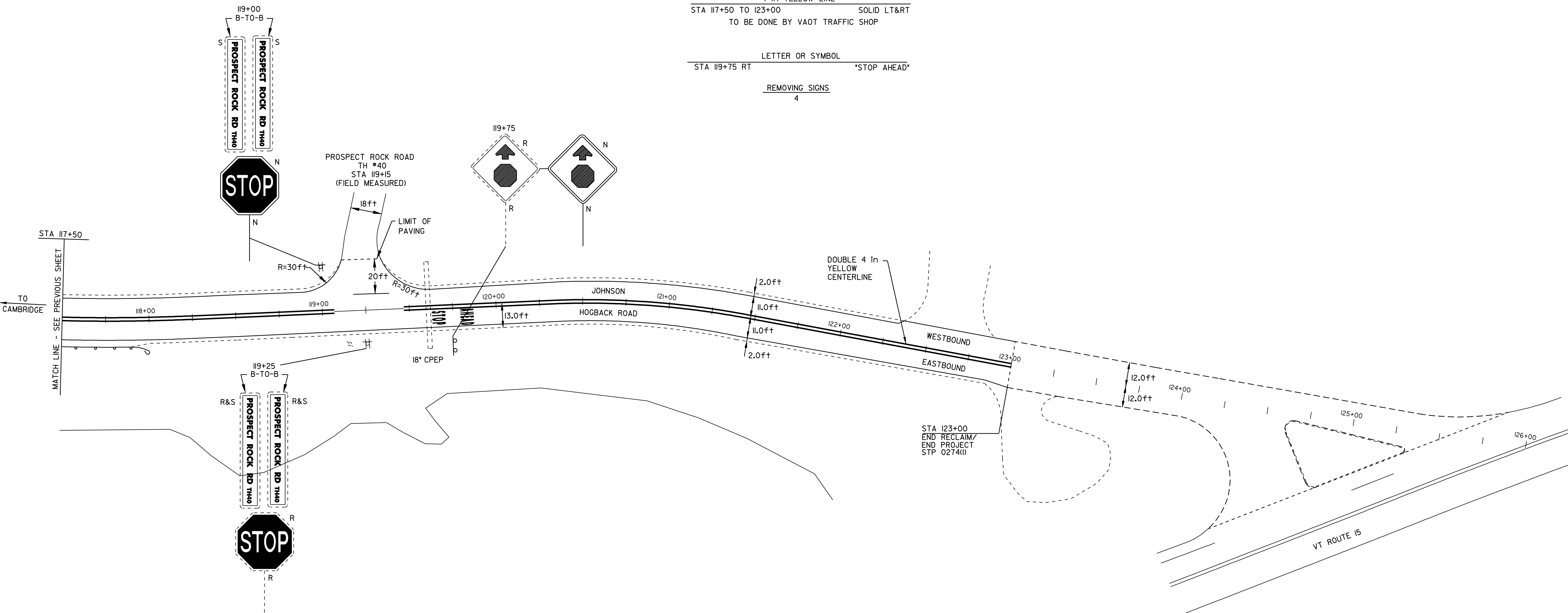

LEGEND

N	=	NEW
R	=	REMOVE
R&S	=	REMOVE & SALVAGE
S	=	SALVAGE
RET	=	RETAIN
B-TO-B	=	BACK TO BACK
⊕	=	CATCH BASIN/DI
⊙	=	EXISTING THROAT DI
I	=	MARKER POST
⊥	=	UTILITY POLE
⊥/⊥	=	UTIL. POLE W/UNDERGROUND UTIL.
---	=	DRIVE
-----	=	APPROXIMATE CULVERT LOCATION

PAVING PROJECT LAYOUT SHEET #8

DESIGNED BY	BCE/PJM	DATE	12-05
DRAWN BY	C.E.A., INC.	DATE	12-05
DESIGN FILE NO.	p05e402.dgn		
PRF FILE	p05e402108.1	DATE PLOTTED	03-FEB-2009 13
PROJ. NAME	CAMBRIDGE - JOHNSON		
PROJ. NO.	STP 0274(1) (RE-ADVERTISED)		
SHEET	16	OF	18 SHEETS

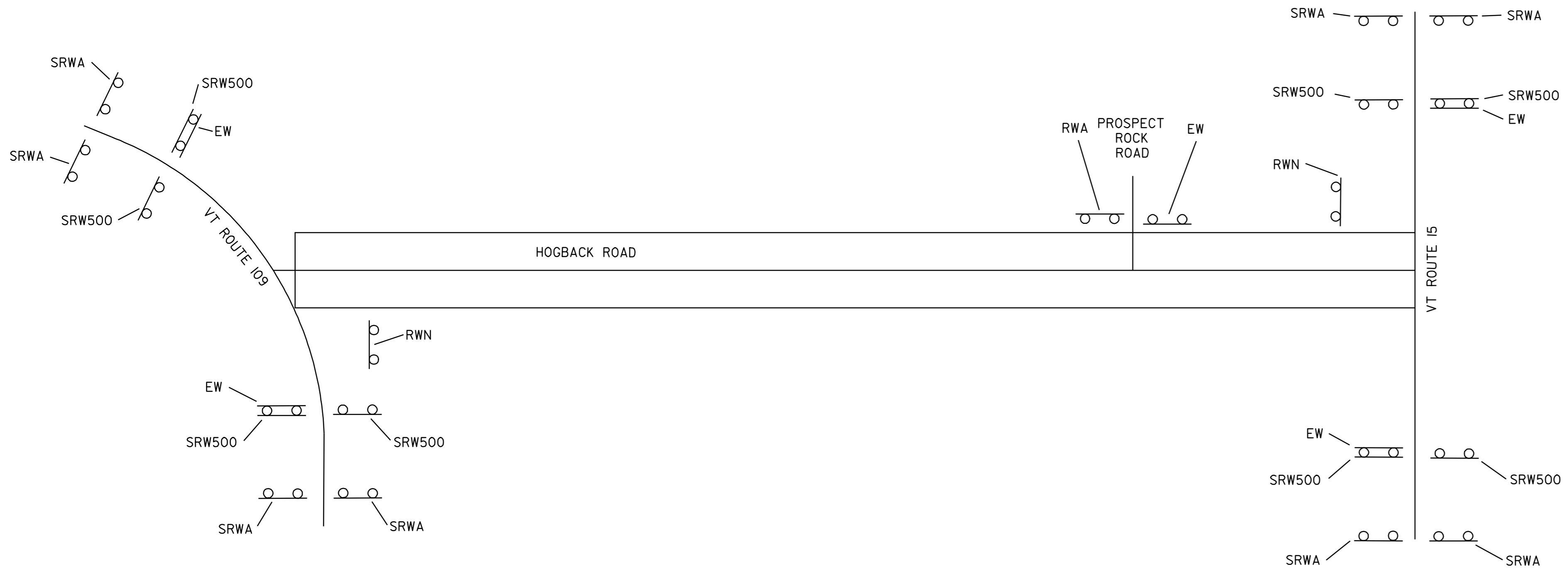

LIST OF CONSTRUCTION SIGNS

TOWN HIGHWAY	RWA	RW500	EW	RWN	SRWA	SRW500
BEGIN PROJECT (WATERVILLE)			2	1	4	4
PROSPECT ROCK ROAD	1		1			
END PROJECT (JOHNSON)			2	1	4	4
TOTALS	1	--	5	2	8	8

- LEGEND**
- RWA = ROAD WORK AHEAD
 - RW500 = ROAD WORK 500 FEET
 - EW = END WORK
 - RWN = ROAD WORK NEXT 5 MILES
 - SRWA = SIDE ROAD WORK AHEAD
 - SRW500 = SIDE ROAD WORK 500 FEET

CONSTRUCTION APPROACH SIGNING

SEE STANDARD E-100 AND E-103 FOR SIGN PLACEMENT
 RESIDENT ENGINEER, AT HIS OR HER DISCRETION, SHALL ELIMINATE CONSTRUCTION APPROACH SIGNING AT DEAD END LOCATIONS.

NOTE:
 THE CONTRACTOR SHALL INCLUDE A CONSTRUCTION SIGN PACKAGE FOR EXPECTED LANE CLOSURES AND WORK ZONE SPEED REDUCTIONS IN COMPLIANCE WITH STANDARD E-103. PAYMENT FOR PROVIDING THIS PACKAGE SHALL BE INCIDENTAL TO ITEM 641.10, TRAFFIC CONTROL.

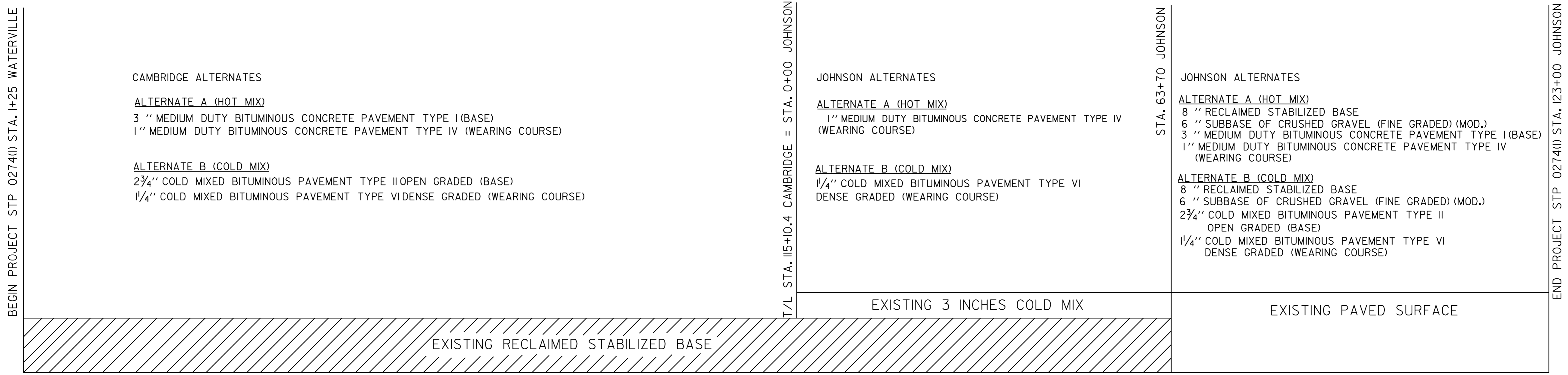

PAVEMENT TYPICAL ALTERNATES

**CONSTRUCTION APPROACH
SIGNING & OTHER
MISCELLANEOUS DETAILS**

DATUM

VERTICAL	N/A
HORIZONTAL	N/A

NOT TO SCALE

DESIGNED BY	BCE/PJM	DATE	12-05
DRAWN BY	C.E.A., INC.	DATE	12-05
DESIGN FILE NO.	p05e402.dgn		
PRF FILE	p05e402cas.1	DATE PLOTTED	03-FEB-2009 15
PROJ. NAME	CAMBRIDGE - JOHNSON		
PROJ. NO.	STP 0274(1) (RE-ADVERTISED)		
SHEET	18	OF	18 SHEETS