

4 in YELLOW LINE

CAMBRIDGE
 STA 100+00 TO 115+10.4 SOLID LT&RT
 JOHNSON
 STA 0+00 TO 15+00 SOLID LT&RT
 TO BE DONE BY VAOT TRAFFIC SHOP

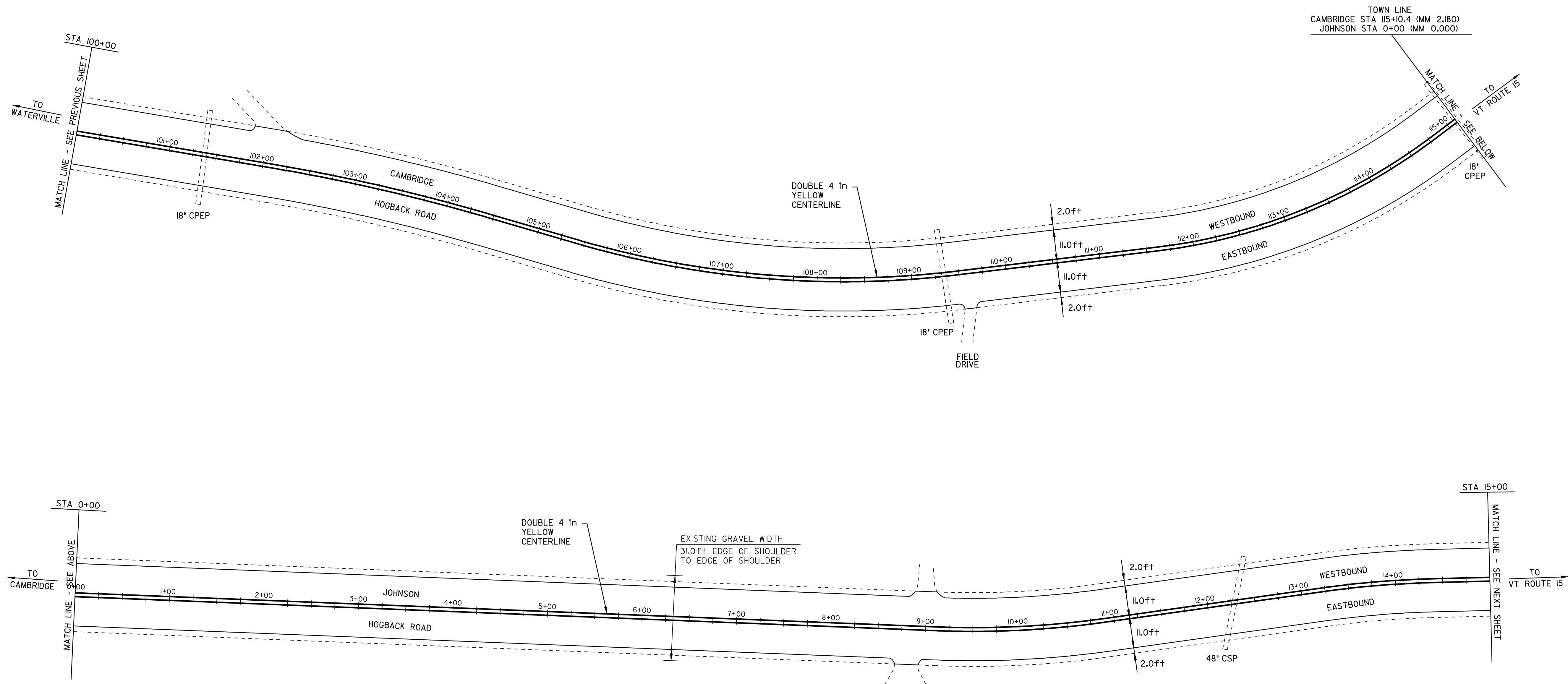

- LEGEND**
- N = NEW
 - R = REMOVE
 - R&S = REMOVE & SALVAGE
 - S = SALVAGE
 - RET = RETAIN
 - B-TO-B = BACK TO BACK
 - ⊕ □ = CATCH BASIN/DI
 - ⊙ □ = EXISTING THROAT DI
 - I = MARKER POST
 - ⋈ = UTILITY POLE
 - ⋈/⋈ = UTIL. POLE W/UNDERGROUND UTIL.
 - ⋈ = DRIVE
 - ⋈⋈⋈ = APPROXIMATE CULVERT LOCATION

<h1>PAVING PROJECT LAYOUT SHEET #4</h1>	DESIGNED BY	BCE/PJM	DATE	12-05
	DRAWN BY	C.E.A., INC.	DATE	12-05
	DESIGN FILE NO.	p05e402.dgn		
	PRF FILE	p05e402i04.1	DATE PLOTTED	03-FEB-2009 13
	PROJ. NAME	CAMBRIDGE - JOHNSON		
PROJ. NO.	STP 0274(1) (RE-ADVERTISED)			
SHEET	12	OF	18	SHEETS