

STEEL BEAM GUARDRAIL, GALVANIZED W/8 FEET POSTS
 STA. 15+58.3 - STA. 16+68.0, LT.
 STA. 15+50.0 - STA. 18+87.4, RT.

ANCHOR FOR STEEL BEAM GUARDRAIL
 AS SHOWN - 3

CLEANING CULVERT PIPE, IN-PLACE (0'-24" INCL.)
 STA. 18+12.0 (35')

REMOVAL AND DISPOSAL OF GUARDRAIL
 STA. 15+68.4 - STA. 16+69.0, LT.
 STA. 16+38.1 - STA. 18+54.5, RT.

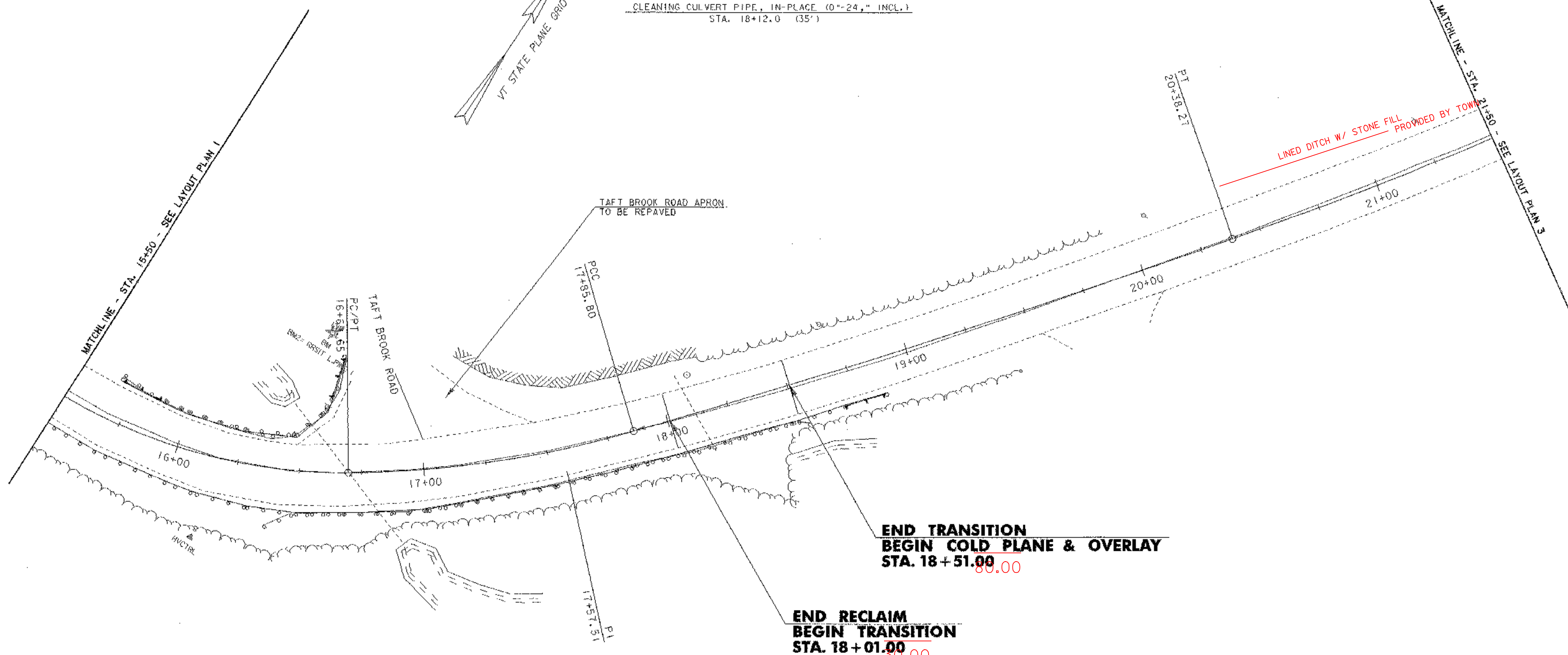

**END TRANSITION
 BEGIN COLD PLANE & OVERLAY
 STA. 18+51.00**

**END RECLAIM
 BEGIN TRANSITION
 STA. 18+01.00**

NOTES:

- PAVING LIMIT ON ALL DRIVES SHALL BE MEASURED 4 FEET BACK FROM T.H. #1 EDGE OF SHOULDER OR AS DIRECTED BY THE RESIDENT ENGINEER.
- PAVING LIMIT ON ALL SIDE ROADS SHALL BE MEASURED 25 FEET BACK FROM T.H. #1 EDGE OF SHOULDER OR AS DIRECTED BY THE RESIDENT ENGINEER.

PROJECT NAME: DOVER
 PROJECT NUMBER: HES 0106(5)

FILE NAME: d05c320bdr.dgn
 PROJECT LEADER: SDM
 DESIGNED BY: MBL
 LAYOUT PLAN 2

PLOT DATE: 04/11/07
 DRAWN BY: MBL
 CHECKED BY: JLS
 SHEET 6 OF 18

