

**INDEX OF SHEETS**

- 1 TITLE SEET
- 2 TYPICAL SECTIONS
- 3-4 QUANTITY SHEETS
- 5-8 LAYOUT PLANS
- 9-10 BANKING DIAGRAMS
- 11-14 SIGNING & STRIPING PLANS
- 15-16 TRAFFIC SIGN SUMMARY SHEETS
- 17 SIGN DETAILS
- 18 CONSTRUCTION APPROACH SIGNING

**STANDARDS**

E-100	CONSTRUCTION APPROACH SIGNS	01/02/04
E-100A	SIDE ROAD CONSTRUCTION APPROACH SIGNS	01/02/04
E-101	CONSTRUCTION SIGN DETAILS	05/30/03
E-102	CONSTRUCTION SIGN DETAILS	06/30/03
E-102A	CONSTRUCTION SIGN DETAILS	05/01/04
E-121	STANDARD SIGN PLACEMENT - CONVENTIONAL ROAD	08/08/95
E-123	GUIDE SIGN PLACEMENT - MISCELLANEOUS DETAILS	03/16/04
E-141	REGULATORY SIGN DETAILS	09/20/95
E-142	REGULATORY SIGN DETAILS	09/20/95
E-143	REGULATORY SIGN DETAILS	06/15/04
E-150	WARNING SIGN DETAILS	05/01/04
E-155	WARNING SIGN DETAILS	05/01/04
E-160	FLANGED CHANNEL STEEL SIGN POST	05/20/99
E-164	SQUARE STEEL SIGN POST	05/20/99
E-193	PAVEMENT MARKING DETAILS	08/18/95
G-1	STEEL BEAM GUARDRAIL WITH STEEL POSTS	01/03/00
G-1d	STEEL BEAM GUARDRAIL WITH APPROACH END TERMINAL	01/03/00

**TRAFFIC DATA**

AADT		ADTT		DHV		%T		%D	
2007	2027	2027	2027	2027	2027	2007	2027	2007	2027
1000	1300	160	150	7.6	12.4	56	56		

ESALs (2007-2027) = 287,000  
 ESALs (2027-2047) = 745,000  
 DESIGN SPEED = 35 M.P.H.  
 POSTED SPEED = 35 M.P.H.

# STATE OF VERMONT AGENCY OF TRANSPORTATION

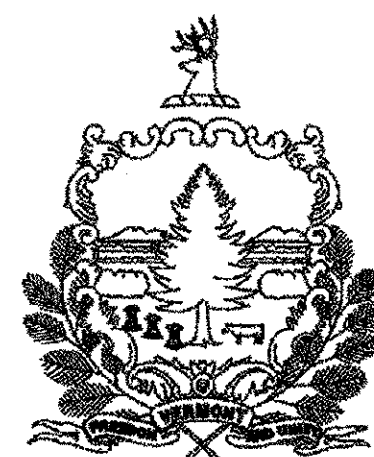

## PROPOSED SAFETY IMPROVEMENT TOWN OF DOVER COUNTY OF WINDHAM TH#1 - DOVER HILL ROAD (MAJOR COLLECTOR)

BEGINNING AT A POINT ON DOVER HILL ROAD AT THE INTERSECTION WITH YEAW ROAD (T.H. #28) AND EXTENDING NORTHEASTERLY 0.455 MILES.

LENGTH OF PROJECT = 2,401 FEET = 0.455 MILES

WORK TO BE PERFORMED UNDER THIS CONTRACT INCLUDES RECLAIMING A SEGMENT OF THE EXISTING HIGHWAY AND COLD PLANING AND RESURFACING OF THE EXISTING HIGHWAY WITH A WEARING COURSE, SUPERELEVATION IMPROVEMENT IN A SEGMENT OF THE EXISTING HIGHWAY, PAVEMENT MARKINGS, GUARDRAIL IMPROVEMENTS, SIGN IMPROVEMENTS, AND INCIDENTAL ITEMS.

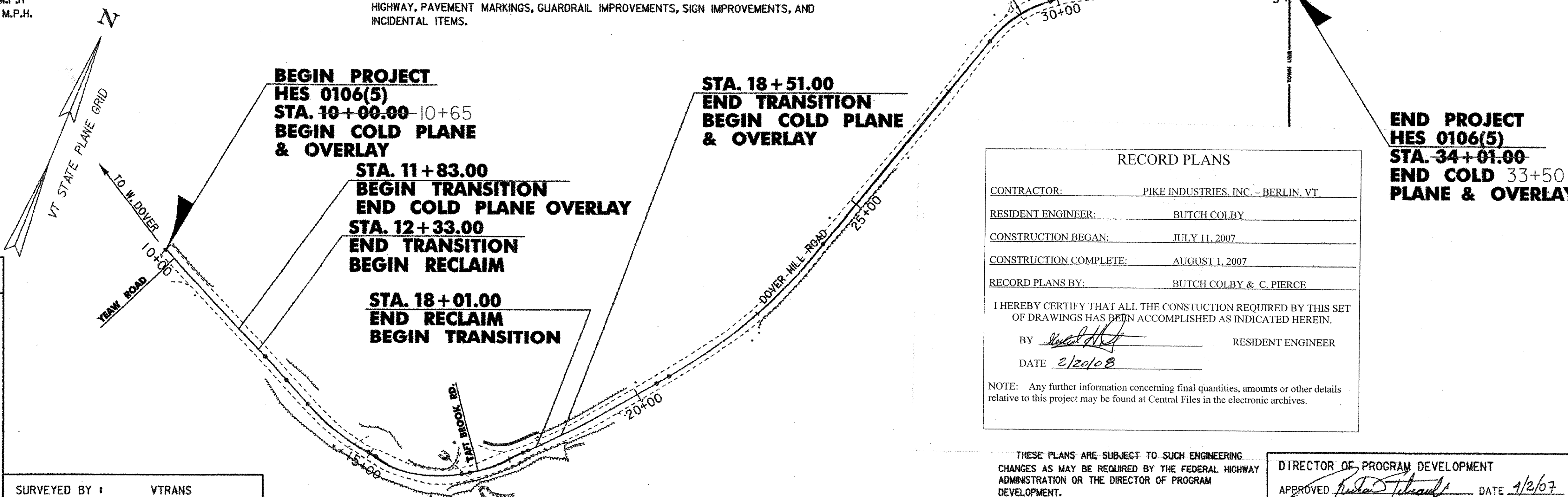
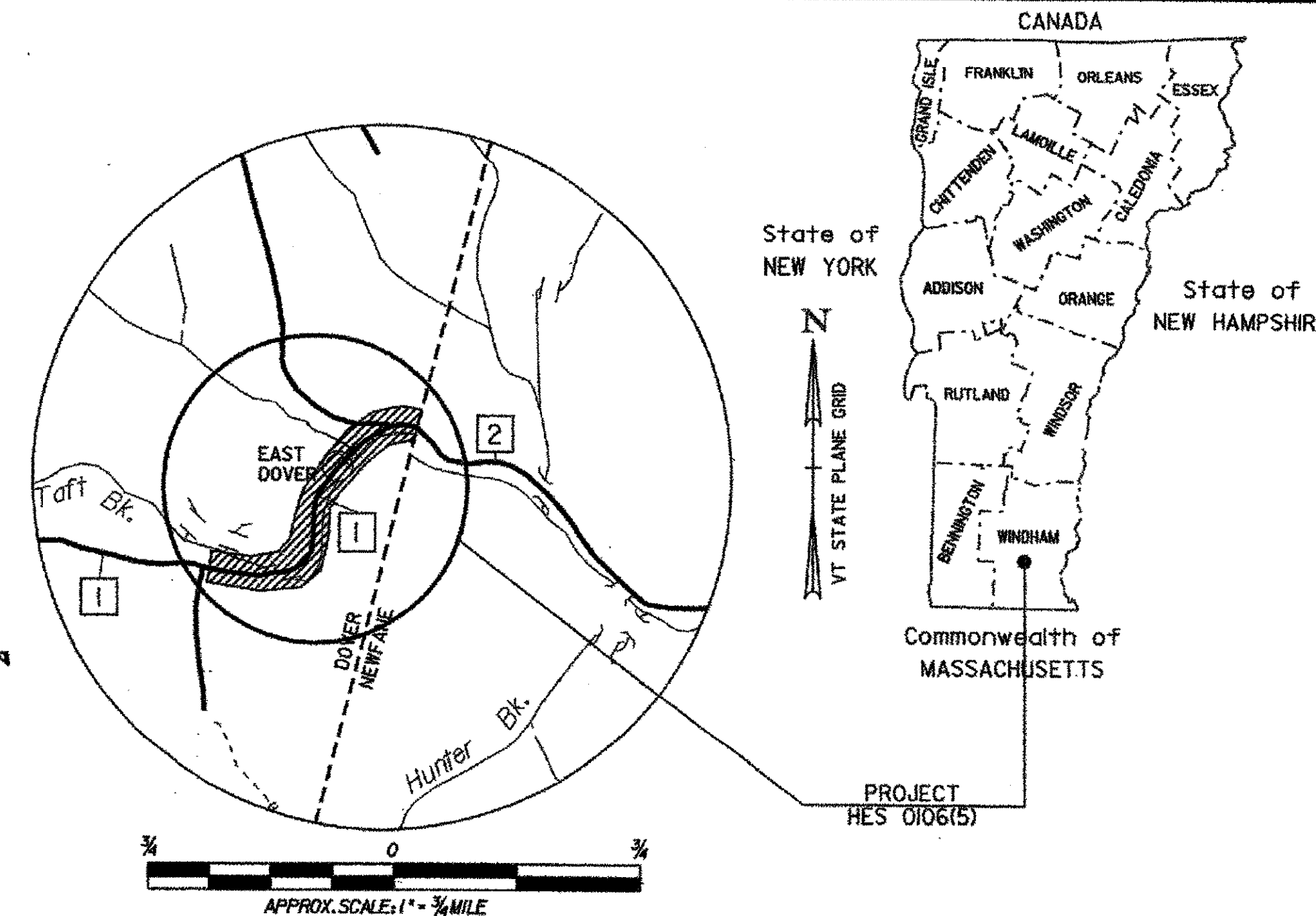

**CONVENTIONAL SYMBOLS**

COUNTY LINE	
TOWN LINE	
LIMITS OF ACCESS	
POINT OF ACCESS	
FENCE LINE	
STONE WALL	
TRAVELED WAY	
GUARD RAIL	
RAILROAD	
SURVEY LINE	
CULVERT	
POWER POLE	
TELEPHONE POLE	
TREES	
CONTROL OF ACCESS	
PROPERTY LINE	
R.O.W. TAKING LINE	
SLOPE RIGHTS	
TOP OF CUT	
TOE OF SLOPE	

SURVEYED BY :	VTRANS
SURVEYED DATE :	12/06
DATUM	
VERTICAL	NAVD 88
HORIZONTAL	NAD 83 (92)

**RECORD PLANS**

CONTRACTOR: PIKE INDUSTRIES, INC. - BERLIN, VT

RESIDENT ENGINEER: BUTCH COLBY

CONSTRUCTION BEGAN: JULY 11, 2007

CONSTRUCTION COMPLETE: AUGUST 1, 2007

RECORD PLANS BY: BUTCH COLBY & C. PIERCE

I HEREBY CERTIFY THAT ALL THE CONSTRUCTION REQUIRED BY THIS SET OF DRAWINGS HAS BEEN ACCOMPLISHED AS INDICATED HEREIN.

BY RESIDENT ENGINEER

DATE 2/20/08

NOTE: Any further information concerning final quantities, amounts or other details relative to this project may be found at Central Files in the electronic archives.

THESE PLANS ARE SUBJECT TO SUCH ENGINEERING CHANGES AS MAY BE REQUIRED BY THE FEDERAL HIGHWAY ADMINISTRATION OR THE DIRECTOR OF PROGRAM DEVELOPMENT.

CONSTRUCTION IS TO BE CARRIED ON IN ACCORDANCE WITH THESE PLANS AND THE STANDARD SPECIFICATIONS FOR CONSTRUCTION DATED 2006, AS APPROVED BY THE FEDERAL HIGHWAY ADMINISTRATION ON JUNE 15, 2006 FOR USE ON THIS PROJECT, INCLUDING ALL SUBSEQUENT REVISIONS AND SUCH REVISED SPECIFICATIONS AND SPECIAL PROVISIONS AS ARE INCORPORATED IN THESE PLANS.

DIRECTOR OF PROGRAM DEVELOPMENT	APPROVED	DATE 1/2/07
PROJECT MANAGER :	KEN ROBIE	
PROJECT NAME :	DOVER	
PROJECT NUMBER :	HES 0106 (5)	
SHEET 1 OF 18 SHEETS		

