

INDEX OF SHEETS

- 1 TITLE SHEET
- 2 TYPICAL SECTIONS AND PROJECT DATA
- 3 PROJECT NOTES
- 3A-3B QUANTITIES
- 4 TIE SHEET
- 5 LAYOUT SHEET
- 6 PROFILE AND ELEVATIONS SHEET
- 7 RESOURCE SHEET
- 8-11 EROSION CONTROL SHEETS
- 12-13 BLANK
- 14-15 PLAN SHEETS 1 & 2
- 16-22 CONSTRUCTION DETAIL SHEETS
- 23-24 GUARDRAIL DETAIL SHEETS
- 25 BLANK
- 26 REINFORCING STEEL SCHEDULE
- 27 BORING LAYOUT SHEET
- 28-30 BORINGS
- 31 TRAFFIC SIGN SUMMARY SHEET
- 32-33 ROADWAY CROSS-SECTIONS

VAOT STANDARD SHEETS

E - 100A	SIDE ROAD CONSTRUCTION APPROACH SIGNS	- 1/02/04
E - 102	CONSTRUCTION SIGN DETAILS	- 6/30/03
E - 102A	CONSTRUCTION SIGN DETAILS	- 5/01/04
E - 107	DELINEATION, BARRICADES AND DETOURS	- 6/30/03
E - 107A	BREAKAWAY BARRICADE DETAILS	- 8/08/95
E - 121	STANDARD SIGN PLACEMENT-CONVENTIONAL ROAD	- 8/08/95
E - 141	REGULATORY SIGN DETAILS	- 9/20/95
E - 146	REGULATORY SIGN DETAILS	- 9/20/95
E - 155	WARNING SIGN DETAILS	- 5/01/04
E - 160	FLANGED CHANNEL STEEL SIGN POST	- 5/20/99
G - 1	STEEL BEAM GUARDRAIL WITH WOOD POSTS	- 1/03/00
G - 1d	STEEL BEAM GUARDRAIL APPROACH END TERMINAL	- 1/03/00

STATE OF VERMONT AGENCY OF TRANSPORTATION



PROPOSED IMPROVEMENT BRIDGE PROJECT

TOWN OF: MONTGOMERY
COUNTY OF: FRANKLIN

ROUTE NO: TH 25, CL 4 BRIDGE NO: 32

PROJECT LOCATION: ON TH 25 BEGINNING APPROXIMATELY 0.22 MILES WEST FROM ITS INTERSECTION WITH TH 12 AND EXTENDING NORTHERLY APPROXIMATELY 0.030 MILES.

PROJECT DESCRIPTION: REHABILITATION OF THE CREAMERY WEST HILL COVERED BRIDGE, INCLUDING TIMBER SUPERSTRUCTURE, SUBSTRUCTURE, DRY MASONRY AND ROADWAY APPROACH WORK.

LENGTH OF STRUCTURE: 58.8± FEET
LENGTH OF PROJECT: 156.0 FEET

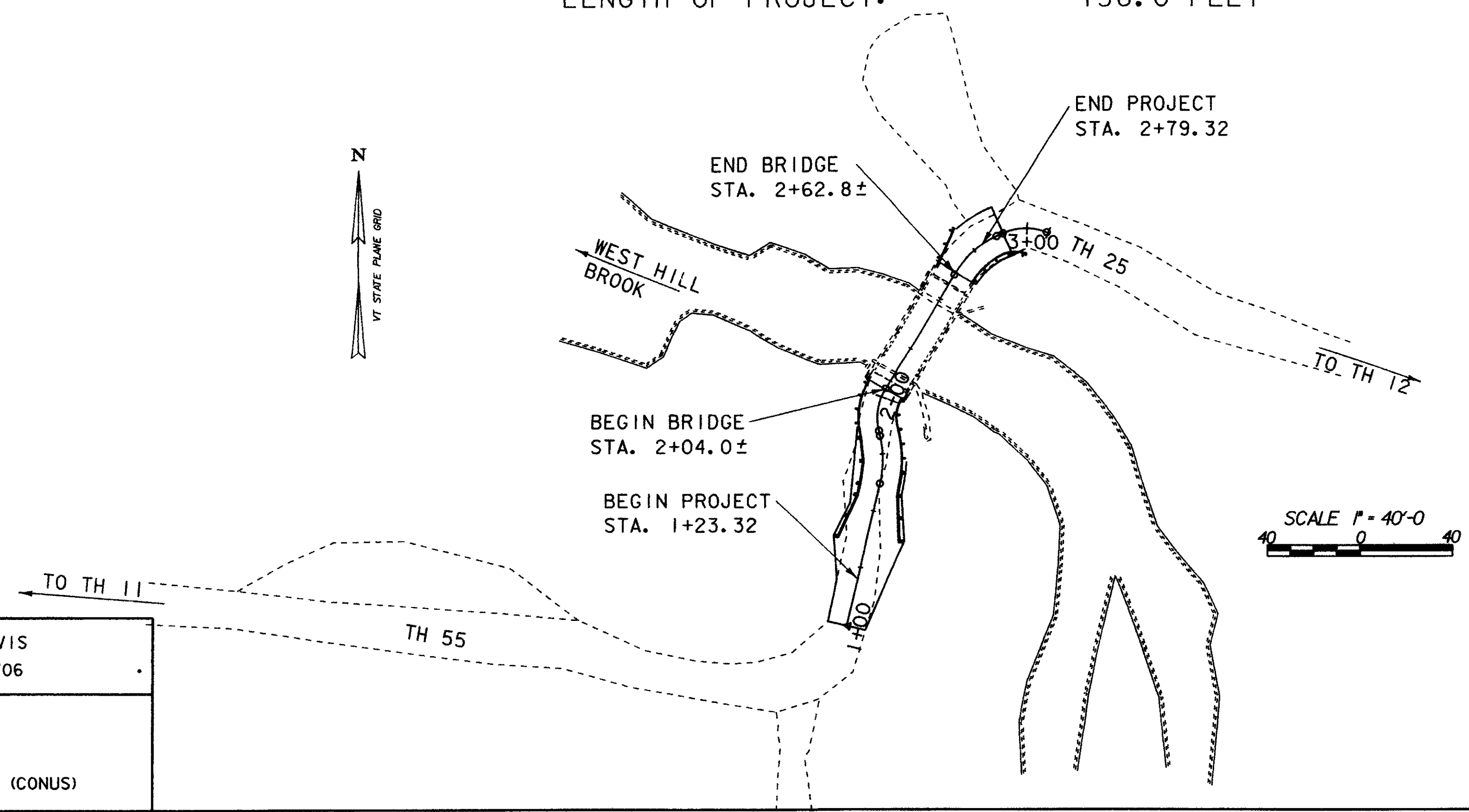
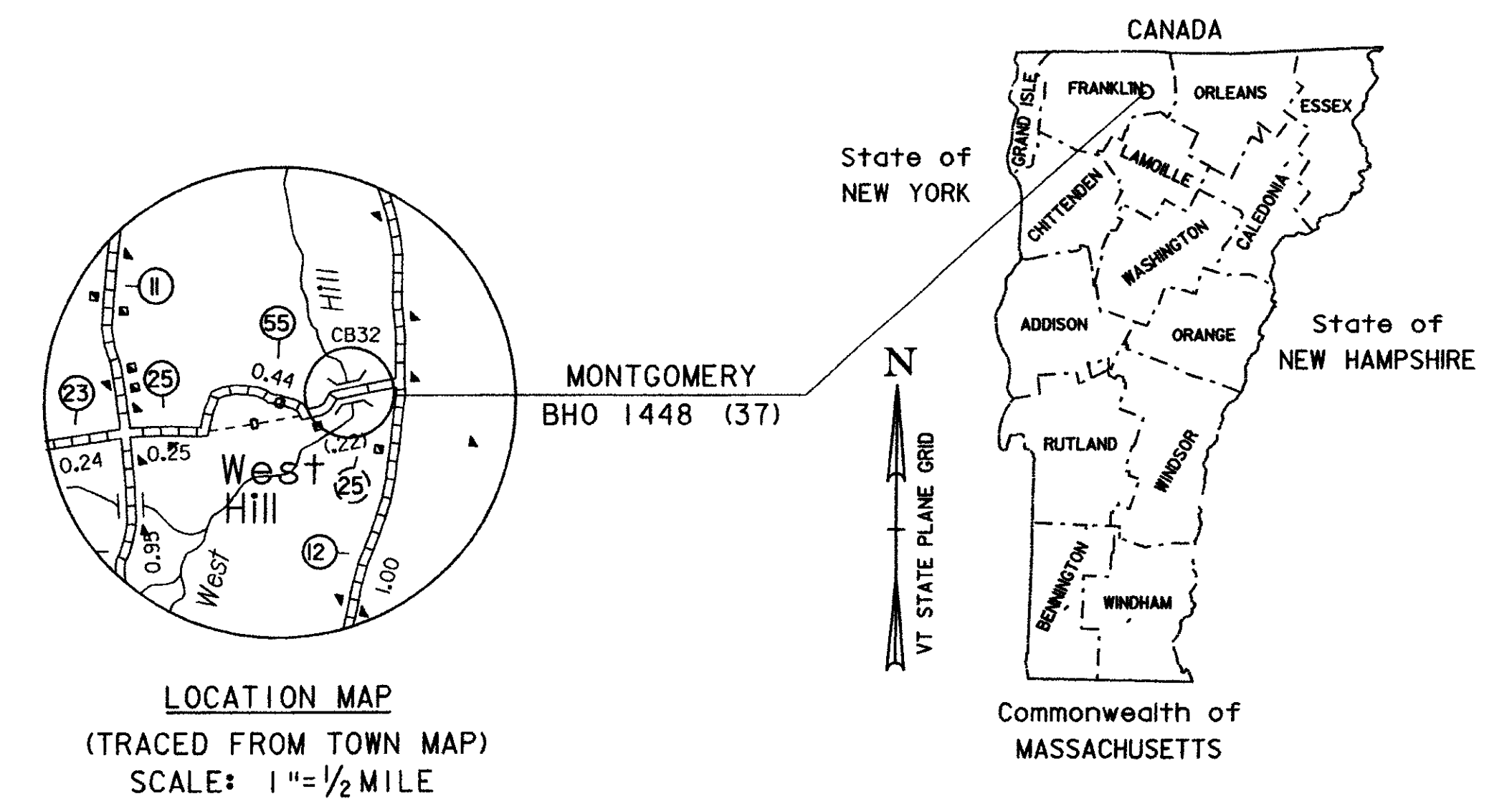

CONVENTIONAL SYMBOLS

COUNTY LINE	
TOWN LINE	
LIMITS OF ACCESS	
POINT OF ACCESS	
FENCE LINE	
STONE WALL	
TRAVELED WAY	
GUARD RAIL	
RAILROAD	
SURVEY LINE	
CULVERT	
POWER POLE	
TELEPHONE POLE	
TREES	
CONTROL OF ACCESS	
PROPERTY LINE	
R.O.W. TAKING LINE	
SLOPE RIGHTS	
TOP OF CUT	
TOE OF SLOPE	

SURVEYED BY : L. G. ORVIS
SURVEYED DATE : 01/24/06

DATUM
VERTICAL: NAVD 88
HORIZONTAL: NAD 83 (CONUS)

RECORD PLANS

CONTRACTOR ALPINE CONSTRUCTION, LLC - SCHUYLerville, NY

RESIDENT ENGINEER DELVIN WARNER

CONSTRUCTION BEGAN SEPTEMBER 15, 2008

CONSTRUCTION COMPLETE OCTOBER 7, 2009

RECORD PLANS BY DELVIN WARNER & NICK GARBACIK

I HEREBY CERTIFY THAT ALL THE CONSTRUCTION REQUIRED BY THIS SET OF DRAWINGS HAS BEEN ACCOMPLISHED AS INDICATED HEREIN

BY *Delvin Warner* RESIDENT ENGINEER
DATE 07/08/10

NOTE Any further information concerning final quantities, amounts or other details relative to this project may be found at Central Files in the electronic archives

THESE PLANS ARE SUBJECT TO SUCH ENGINEERING CHANGES AS MAY BE REQUIRED BY THE FEDERAL HIGHWAY ADMINISTRATION OR THE DIRECTOR OF PROGRAM DEVELOPMENT.

CONSTRUCTION IS TO BE CARRIED ON IN ACCORDANCE WITH THESE PLANS AND THE STANDARD SPECIFICATIONS FOR CONSTRUCTION DATED 2006, AS APPROVED BY THE FEDERAL HIGHWAY ADMINISTRATION ON JUNE 15, 2006 FOR USE ON THIS PROJECT, INCLUDING ALL SUBSEQUENT REVISIONS AND SUCH REVISED SPECIFICATIONS AND SPECIAL PROVISIONS AS ARE INCORPORATED IN THESE PLANS.

DIRECTOR OF PROGRAM DEVELOPMENT
APPROVED *Richard Stearns* DATE 5/22/08

PROJECT MANAGER : J. WEAVER

PROJECT NAME : MONTGOMERY BHO 1448 (37)

SHEET 1 OF 33 SHEETS