

NOTE: ROOF BOARDS AND UPPER LATERAL BRACING NOT SHOWN FOR CLARITY.

ROOF FRAMING PLAN

SCALE: 3/8" = 1'-0"
 1 0 1 2 3 4

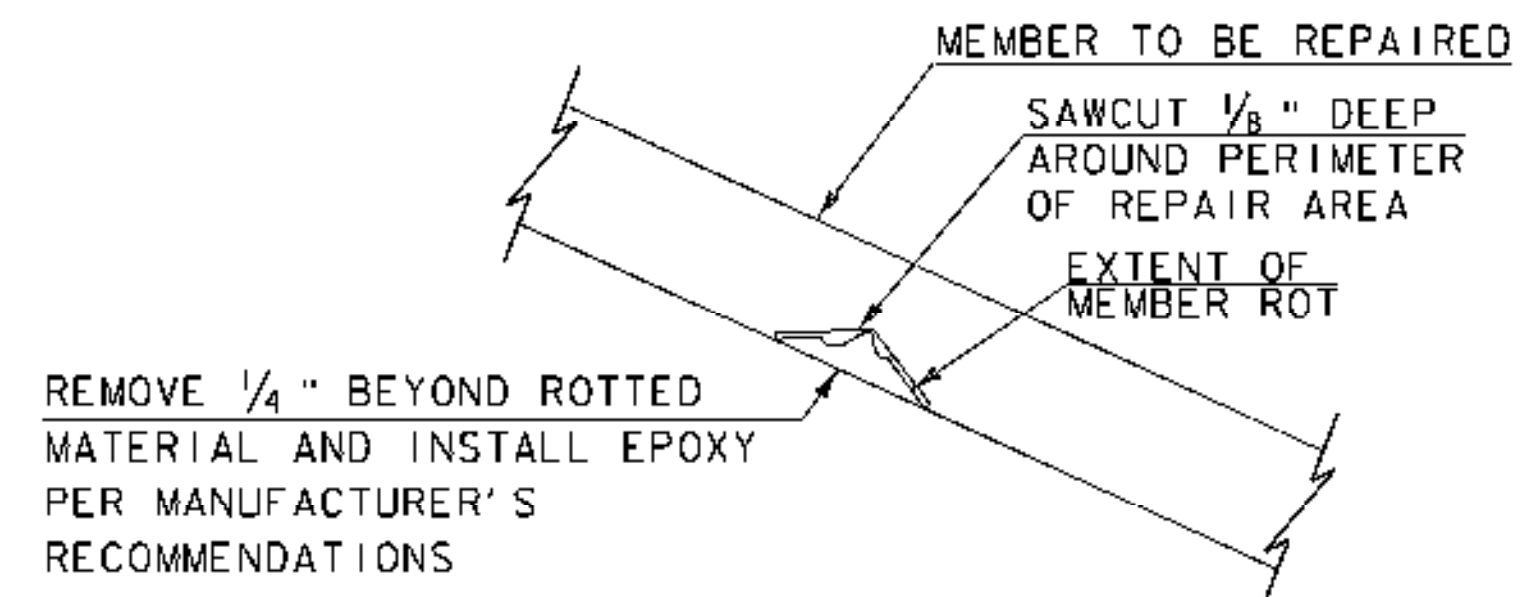

EPOXY REPAIR DETAIL

NOT TO SCALE

RECOMMENDED REPAIR SEQUENCE:

- R-1. IDENTIFIED ROTTED MATERIAL IN LUMBER AND TIMBER MEMBERS, IF LESS THAN 1 INCH IN DEPTH, SHALL BE REPAIRED AS SHOWN ABOVE IN THE "EPOXY REPAIR DETAIL". IF ROT IS GREATER THAN 1 INCH IN DEPTH, THE ENTIRE MEMBER SHALL BE REPLACED AS ORDERED BY THE RESIDENT ENGINEER.
- R-2. REMOVE ALL ROTTED MATERIAL TO A MINIMUM OF 1/4" BEYOND EXTENT OF ROT. SAWCUT 1/8" DEEP AROUND PERIMETER OF REPAIR AREA.
- R-3. CLEAN EXISTING MEMBER OF ALL DIRT, SAWDUST, ETC. AND PREPARE SURFACE PER MANUFACTURER'S RECOMMENDATIONS.
- R-4. INSTALL/INJECT APPROVED EPOXY REPAIR MATERIAL PER MANUFACTURER'S RECOMMENDATIONS, (PAID UNDER ITEM 900.620, SPECIAL PROVISION (WOOD EPOXY REPAIRS)). COLOR OF REPAIR MATERIAL TO MATCH EXISTING WOOD. A COMPLETED TEST SECTION SHALL BE MADE FOR APPROVAL BY THE RESIDENT ENGINEER.
- R-5. INSTALL TWO GALVANIZED LAG SCREWS INTO EXISTING SPLIT THROUGH REPAIR MATERIAL (IF REQUIRED). SIZE OF LAG SCREWS TO BE DETERMINED BY THE RESIDENT ENGINEER.
- R-6. SEE NOTE W-3 ON SHEET 21, NOTE 6 ON SHEET 26 AND NOTE 1 ON SHEET 27 FOR ALL WORK TO BE PAID FOR UNDER ITEM 900.620, SPECIAL PROVISION (WOOD EPOXY REPAIRS).

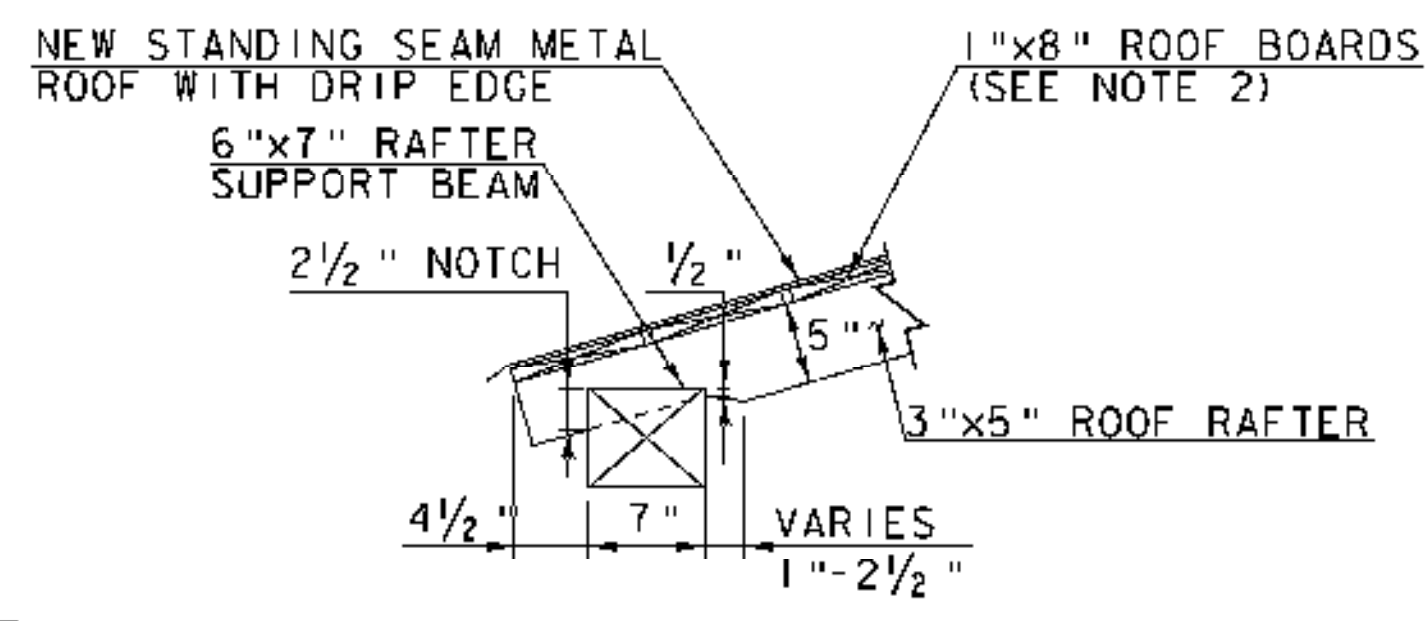

ROOF RAFTER BEARING DETAIL

NOT TO SCALE

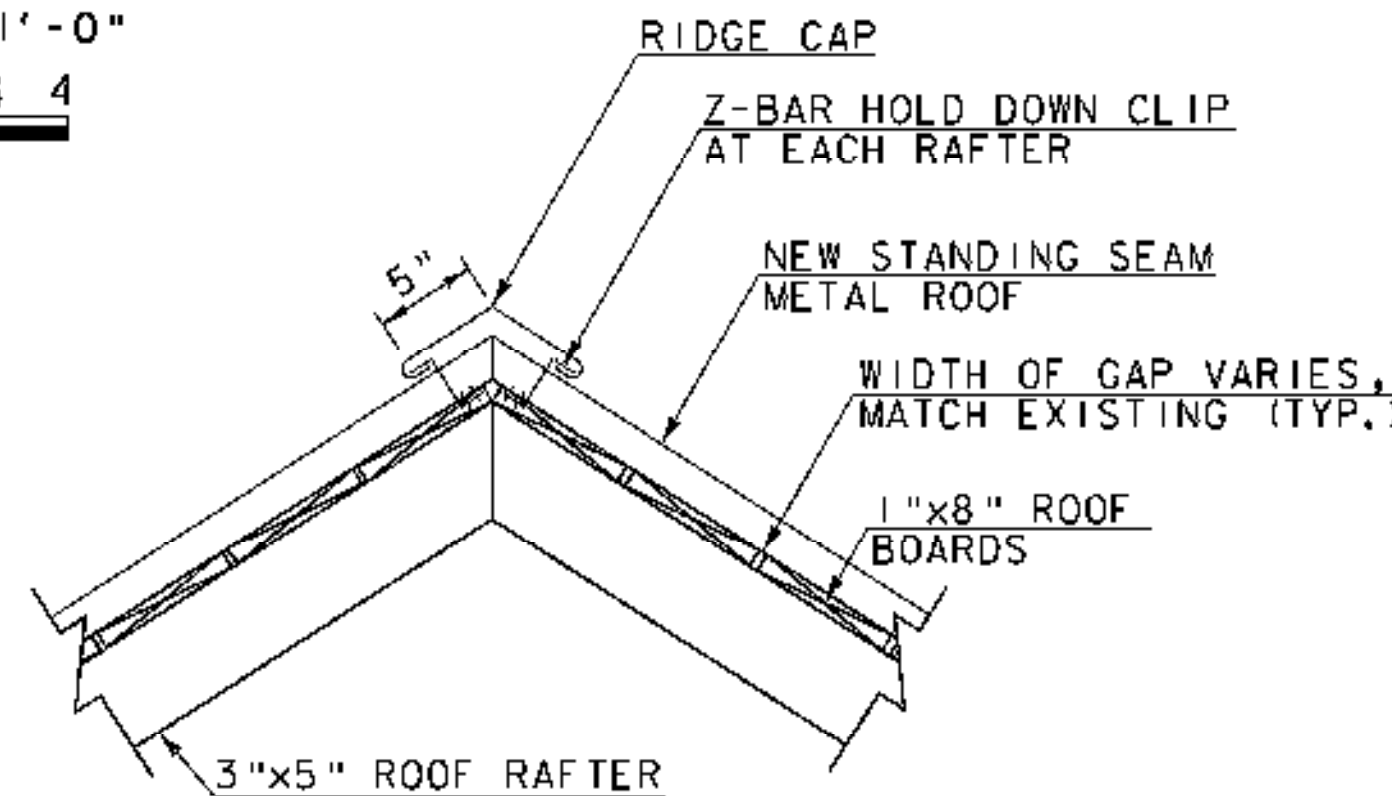

ROOF RIDGE CAP DETAIL

NOT TO SCALE

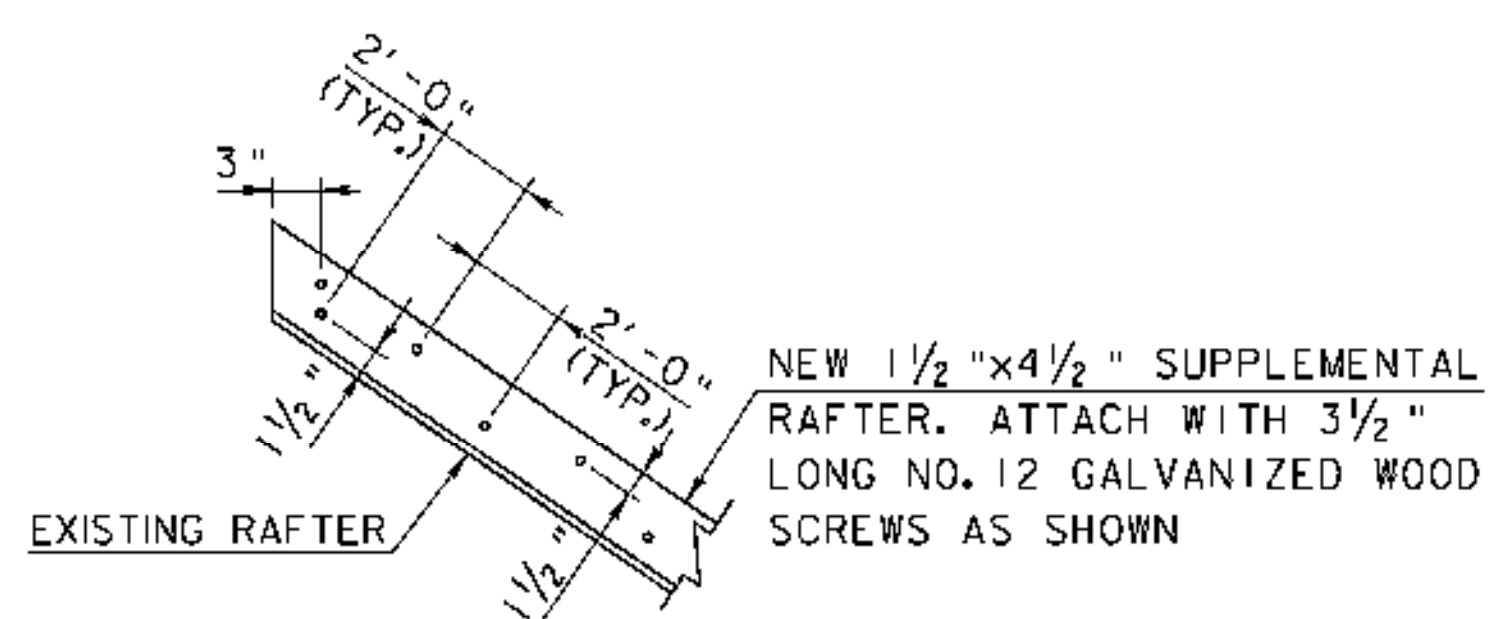

SUPPLEMENTAL RAFTER DETAIL

NOT TO SCALE

PLAN NOTES:

1. ITEM 522.20 STRUCTURAL LUMBER AND TIMBER, UNTREATED - ASSUMES REPLACEMENT OF 3 ADDITIONAL RAFTERS FOR BIDDING PURPOSES THAT HAVE NOT BEEN IDENTIFIED IN THE PLANS. THE CONTRACTOR AND RESIDENT ENGINEER SHALL JOINTLY INSPECT ALL ROOF RAFTERS AFTER REMOVAL OF THE EXISTING METAL ROOF TO IDENTIFY ADDITIONAL RAFTERS AND RAFTER SUPPORT BEAMS TO BE REPLACED.
2. ITEM 522.30 NONSTRUCTURAL LUMBER AND TIMBER, UNTREATED - INCLUDES INSTALLATION OF NEW SIDING AND REPLACEMENT OF 30 PERCENT OF THE EXISTING ROOF BOARDS. FOR BIDDING PURPOSES REPLACEMENT OF 30 PERCENT OF EXISTING ROOF BOARDS INCLUDES REPLACEMENT OF DETERIORATED ROOF BOARDS AND INSTALLATION OF NEW ROOF BOARDS WHERE MISSING. SPECIFIC ROOF BOARDS HAVE NOT BEEN IDENTIFIED IN THE ROOF RAFTER PLAN. THE CONTRACTOR AND RESIDENT ENGINEER SHALL JOINTLY INSPECT ALL ROOF BOARDS AFTER REMOVAL OF THE EXISTING METAL ROOF. ATTACH ROOF BOARDS TO EACH RAFTER WITH 2-3" LONG NO. 14 GALVANIZED WOOD SCREWS.
3. THE CONTRACTOR SHALL REALIGN ALL RAFTERS TO BE PERPENDICULAR TO THE RAFTER SUPPORT BEAM. ALL COST OF SUCH WORK IS PAID UNDER ITEM 900.645, SPECIAL PROVISION (REHABILITATING COVERED BRIDGE SUPERSTRUCTURE).

LEGEND:

- (7N) TRUSS NODE
- MEMBER TO BE REPLACED
- ▨ NEW SUPPLEMENTAL MEMBER

MODEL
Default
HTA PROJECT NO.
904213

PROJECT NAME:	FAIRFIELD	PLOT DATE:	4/25/2008
PROJECT NUMBER:	BHO 1448(32)	DRAWN BY:	J.B.McQUAID
FILE NAME:	Z04J144sup2.dgn	DESIGNED BY:	S.T.JAMES
PROJECT LEADER:	J.H.WEAVER	CHECKED BY:	S.T.JAMES
DESIGNED BY:	J.BICJA	ROOF FRAMING PLAN	SHEET 30 OF 36

Hoyle, Tanner & Associates, Inc.