

LEGEND

AgA	EXISTING SOIL TYPE BOUNDARY (APPROX.)
Qd	EXISTING UNDERGROUND TELEPHONE LINE
UT	EXISTING UNDERGROUND WATER LINE
W	EXISTING UNDERGROUND GAS LINE
G	EXISTING UNDERGROUND SEWER LINE
S	EXISTING OVERHEAD ELECTRIC & TELEPHONE LINE
AERIAL E&T	EXISTING FORCED MAIN SEWER LINE
FM	EXISTING STORM DRAIN
SD	LEDGE
HYD	HYDRANT
⊙	MANHOLE
⊙	MAILBOX
⊙	SIGNS
↑	UTILITY POLE GUY WIRE
⊙	GAS SHUTOFF
⊙	LIGHT POLE

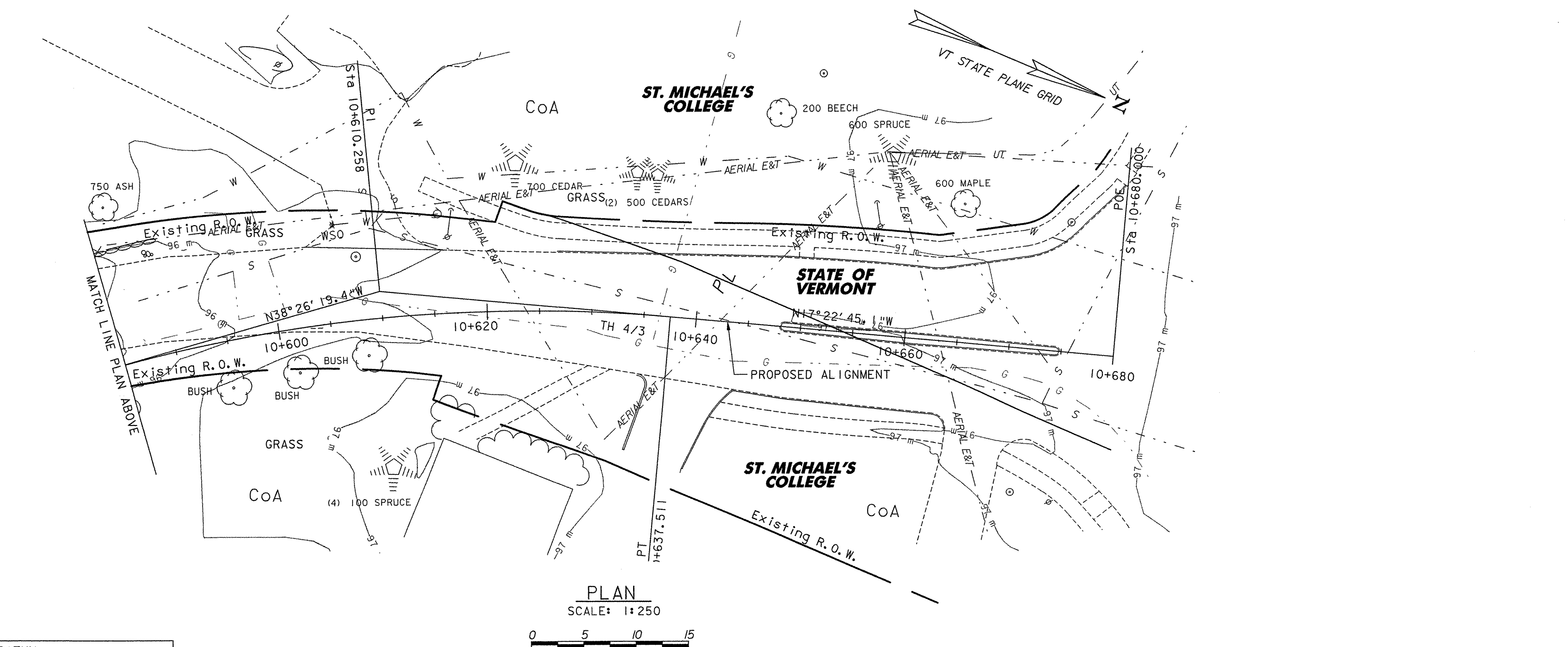

- NOTES:**
- NO SENSITIVE RESOURCES EXIST.
 - SOIL BOUNDARIES ARE APPROXIMATE AND ARE TAKEN FROM CHITTENDEN COUNTY, VT. SOIL SURVEY BOOK DATED JAN. 1974. SEE SHEET 47 FOR SOIL DESCRIPTIONS.
 - EXISTING CONTOURS MAY VARY DUE TO PLACEMENT OF FILL BY OTHERS ALREADY IN PLACE FROM STA 10+480 TO STA 10+550 RT.

STATE OF VERMONT AGENCY OF TRANSPORTATION	
Town Of COLCHESTER-SOUTH BURLINGTON	Bridge No. 6
Highway No. TH 4/3	Log Sta. Surv. Sta.
TH 4/3 OVER WINOOSKI RIVER & N.E.C.R.	
EXISTING CONDITIONS PLAN (3 OF 3)	
Designed By S. M. GUNN	Drawn By B. J. MASSE
Checked By S. M. GUNN	Date 4/05
S. M. GUNN Date 4/05	
PROJECT COLCHESTER-SOUTH BURLINGTON	PROJECT NO. BRM 5600 (6) S C/2
I.G.C. Info.	
Bridge Sheet No. ZD139ER3A	Sheet 47C of 124

DATUM
VERTICAL NAVD 88
HORIZONTAL NAD 83 (92)

VHB Vanasse Hangen Brustlin, Inc.