

FED ROAD RLG. NO.	STATE	CONTRACT NO.	SHEET NO.	TOTAL SHEETS
1	N.Y.		17	43

COUNTY ROAD 18 OVER POULTNEY RIVER
WASHINGTON COUNTY, NY / RUTLAND COUNTY, VT
TOWN OF HAMPTON, NY / POULTNEY, VT
CAPITAL PROJECT IDENTIFICATION NO. 1753.76

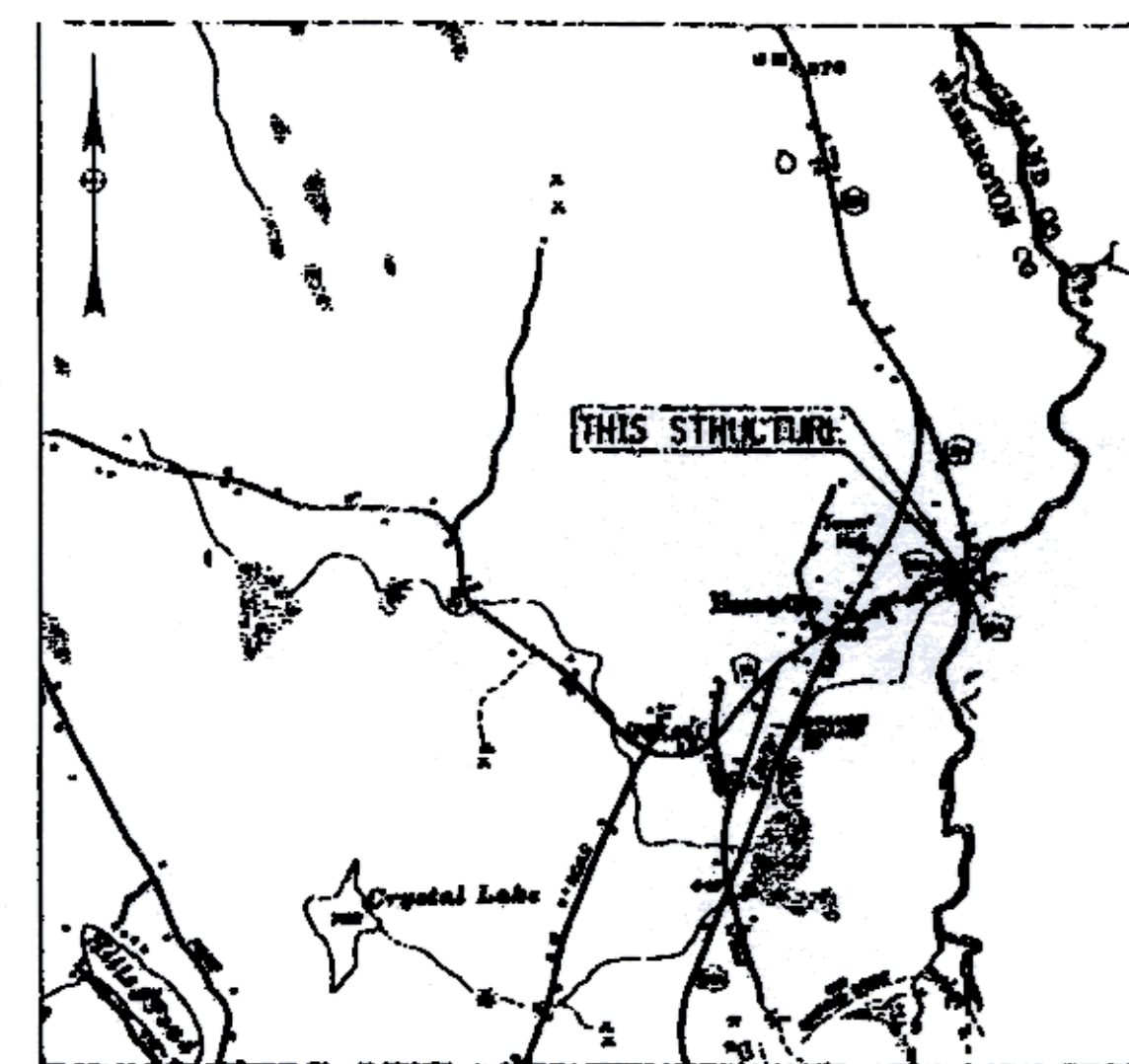

LOCATION MAP
THORN HILL QUADRANGLE
SCALE: 1:24000

ELECTRICAL SAFETY NOTE:
HIGH VOLTAGE ELECTRICAL LINES ARE IN PROXIMITY TO THIS BRIDGE. REFER TO ELECTRICAL SAFETY NOTE CONTAINED IN THE CONTRACT PROPOSAL FOR SPECIAL CONTRACTOR SAFETY REQUIREMENTS. SEE DRAWING NO. GP-1 FOR LOCATIONS.

HORIZONTAL CURVE DATA		
	CURVE 1	CURVE 2
PC STATION	0+223.489	0+304.147
RADIUS	75,000 m	500,000 m
LENGTH OF CURVE	20.416 m	12.248 m

HYDRAULIC DATA			
		BASIC FLOOD	DESIGN FLOOD
DRAINAGE AREA	124.96 km ²	100	50
RECURRENCE INTERVAL (YEARS)		107.6	87.8
PEAK DISCHARGE (m ³ /S)		116.12	115.89
HIGH WATER ELEVATION AT	EXISTING	116.12	115.89
POINT OF MAX. BACKWATER	PROPOSED	116.12	115.89
AVG. VELOCITY THRU STRUCTURE @ DESIGN FLOOD = 3.95 m/S			

BIN 3-30639-0
ALL DIMENSIONS ARE IN mm UNLESS OTHERWISE NOTED
AS BUILT REVISIONS

Lawrence S. Attanasio 9/2003
SIGNATURE DATE

COUNTY ROAD 18 OVER POULTNEY RIVER
PLAN AND ELEVATION

WASHINGTON COUNTY
DEPARTMENT OF PUBLIC WORKS

FILENAME	REGION	DATE	DRAWING NO.
175376AA.G1A	ONE	3/2002	ST-1

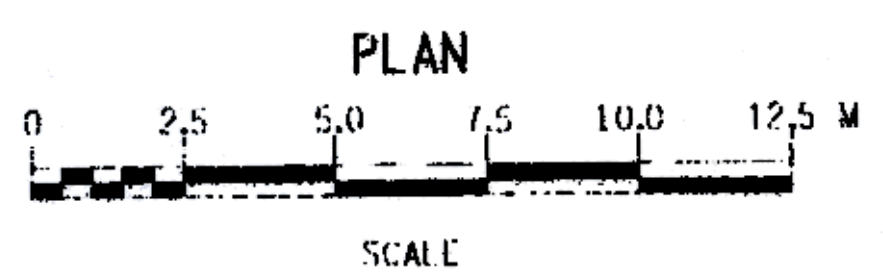
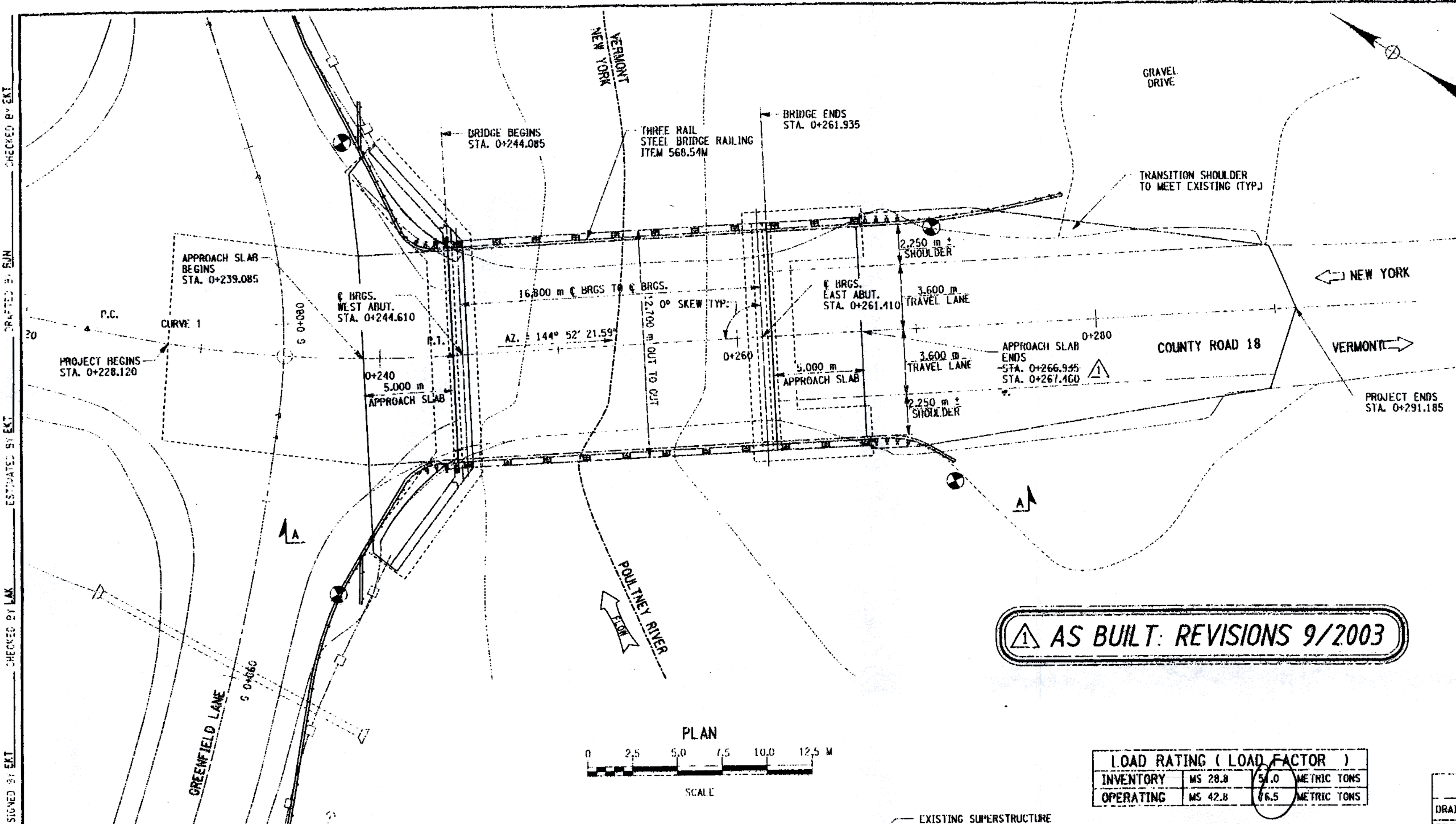

LOAD RATING (LOAD FACTOR)		
INVENTORY	MS 28.8	54.0 METRIC TONS
OPERATING	MS 42.8	86.5 METRIC TONS

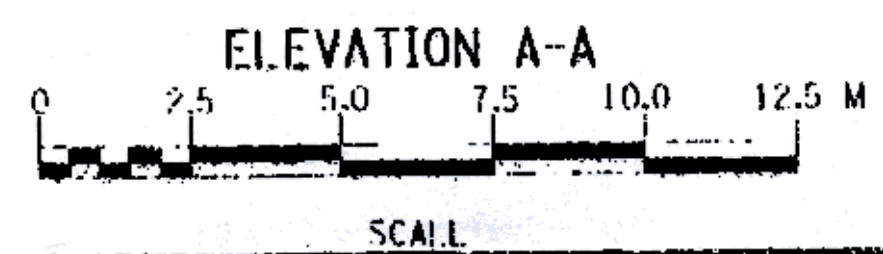
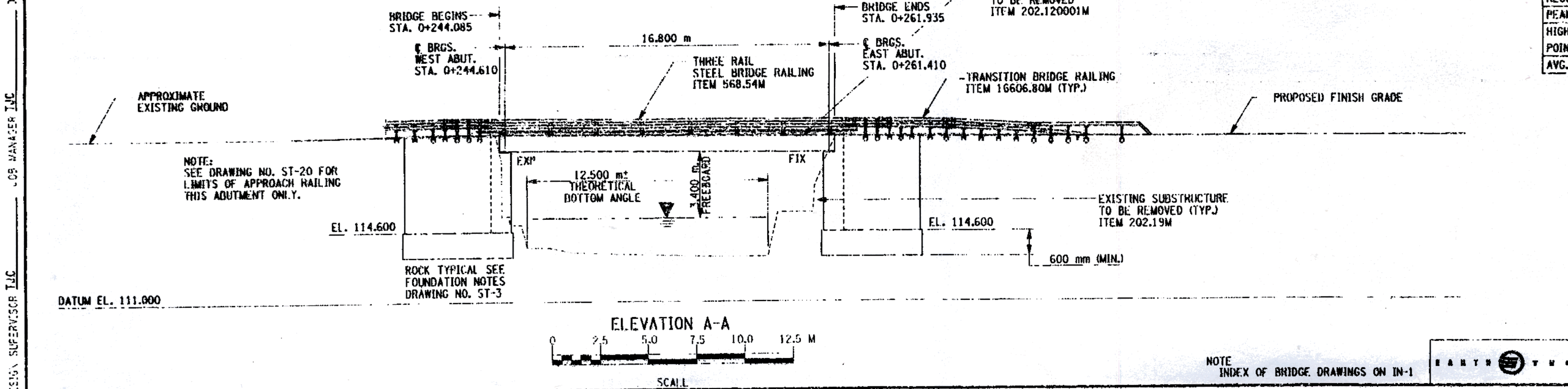

NOTE
INDEX OF BRIDGE DRAWINGS ON IN-1

FILE NAME = I:\proj\142007\CADD\asbuilt\175376aa.g1a
DATE/TIME = 3/04/2003 09:25:06 AM
USER = RJN

DESIGN SUPERVISOR IJC
DESIGNED BY IJC
CHECKED BY LAK
ESTIMATED BY EAT
DRAFTED BY RJN
CHECKED BY EAT