

THETFORD TEMPORARY DETOUR SIGNAGE AND ROUTING

D
INTERSECTION RT. 132 AND TH-3 (ACADEMY RD.)

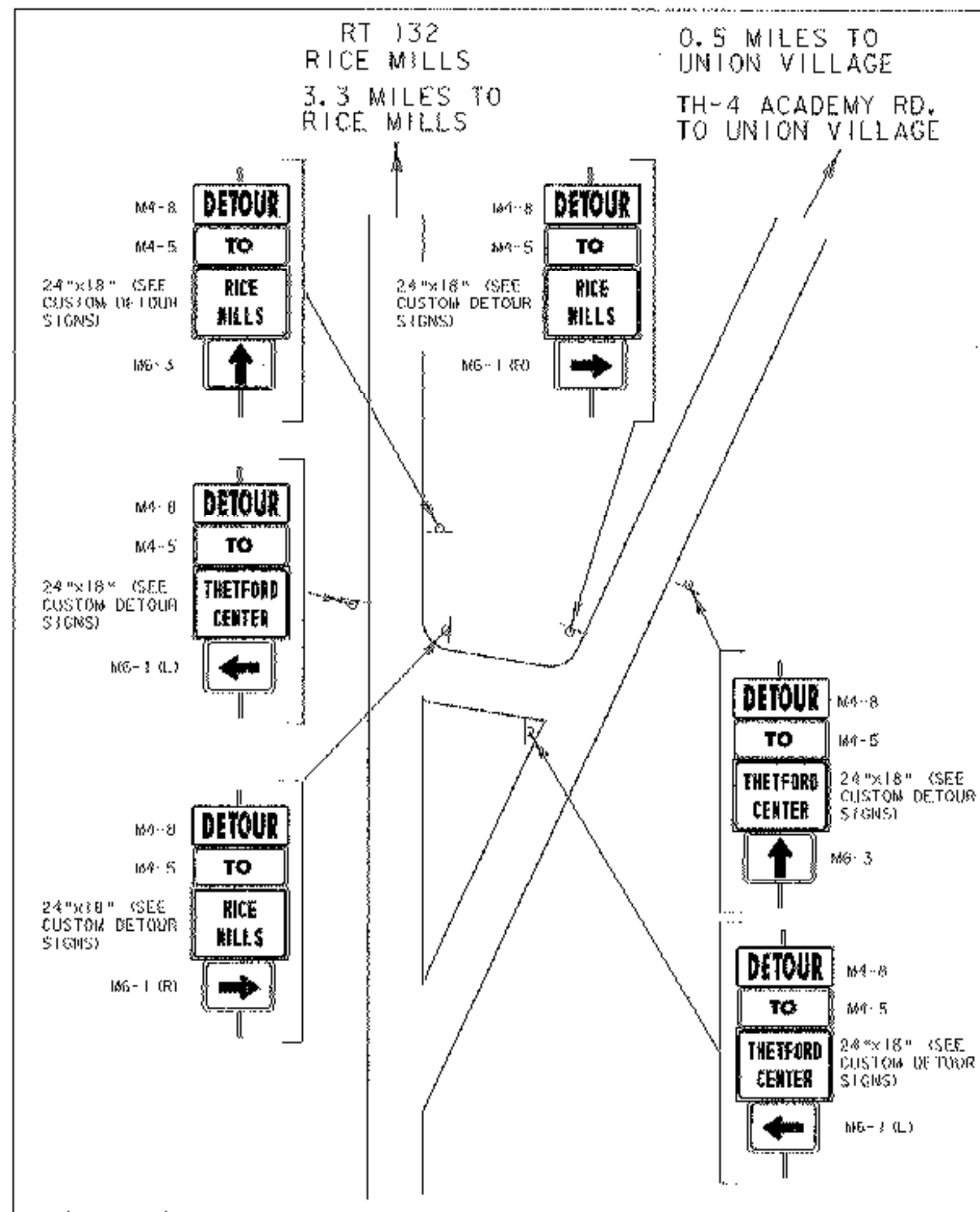

F
TH-3 TO TH-4 (ACADEMY RD.) AND CAMPBELL FLATS RD INTERSECTION AT POST MILLS BRIDGE UNION VILLAGE

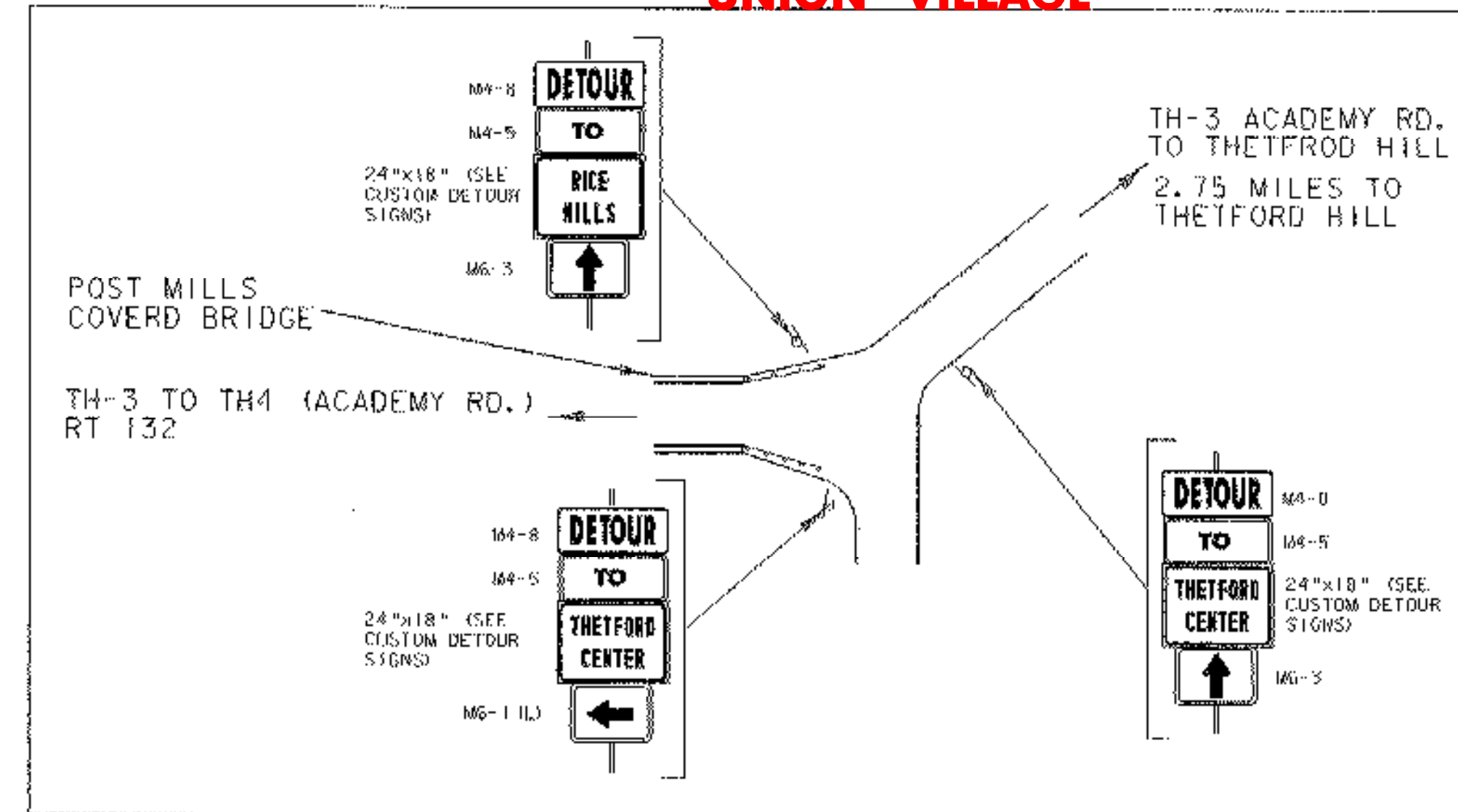

G
INTERSECTION VT. 113 AND TH-3 (ACADEMY RD.) AT THETFORD HILL

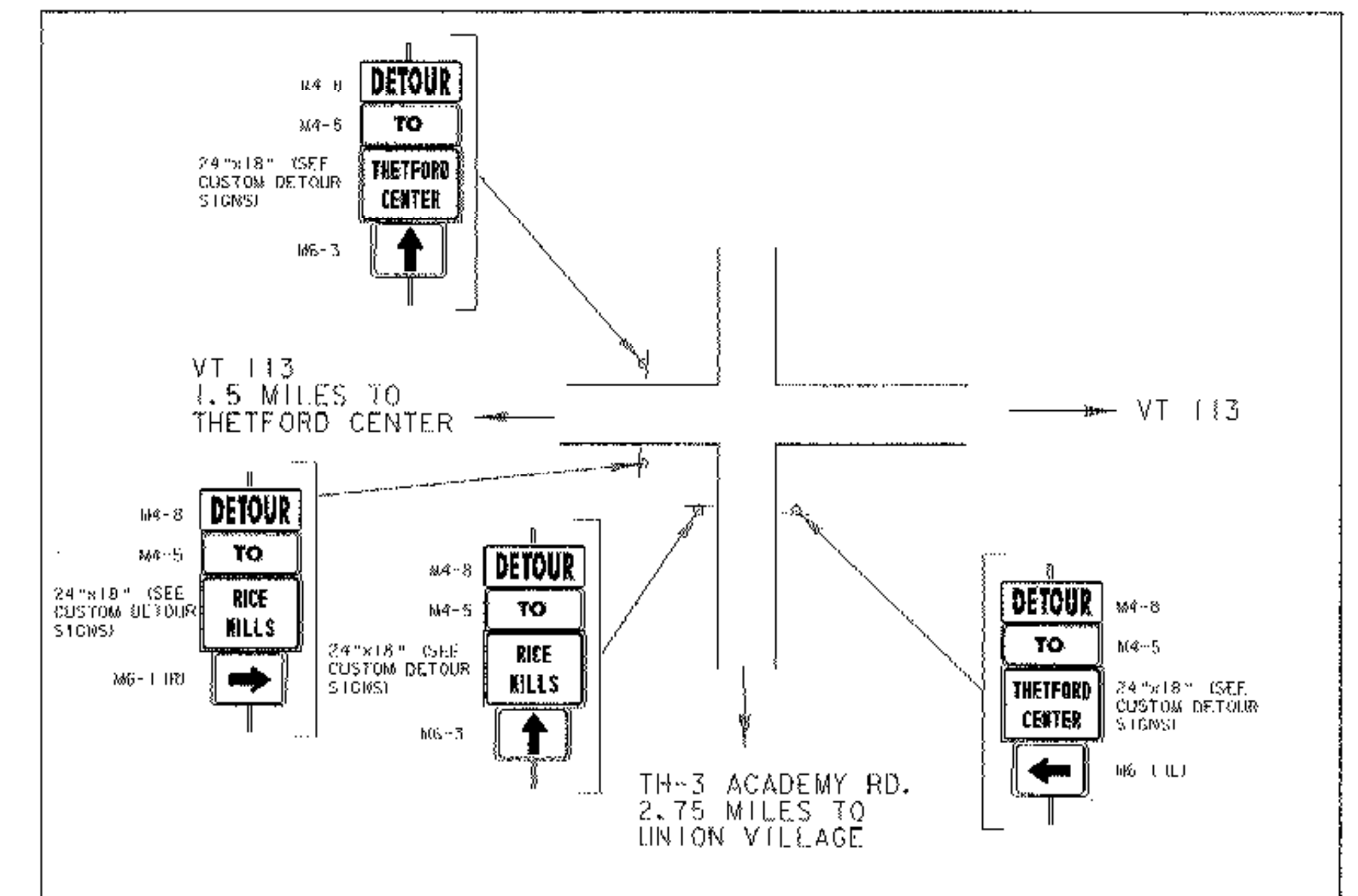

H
INTERSECTION VT. 113 AND TH-6 (TUCKER HILL RD.)

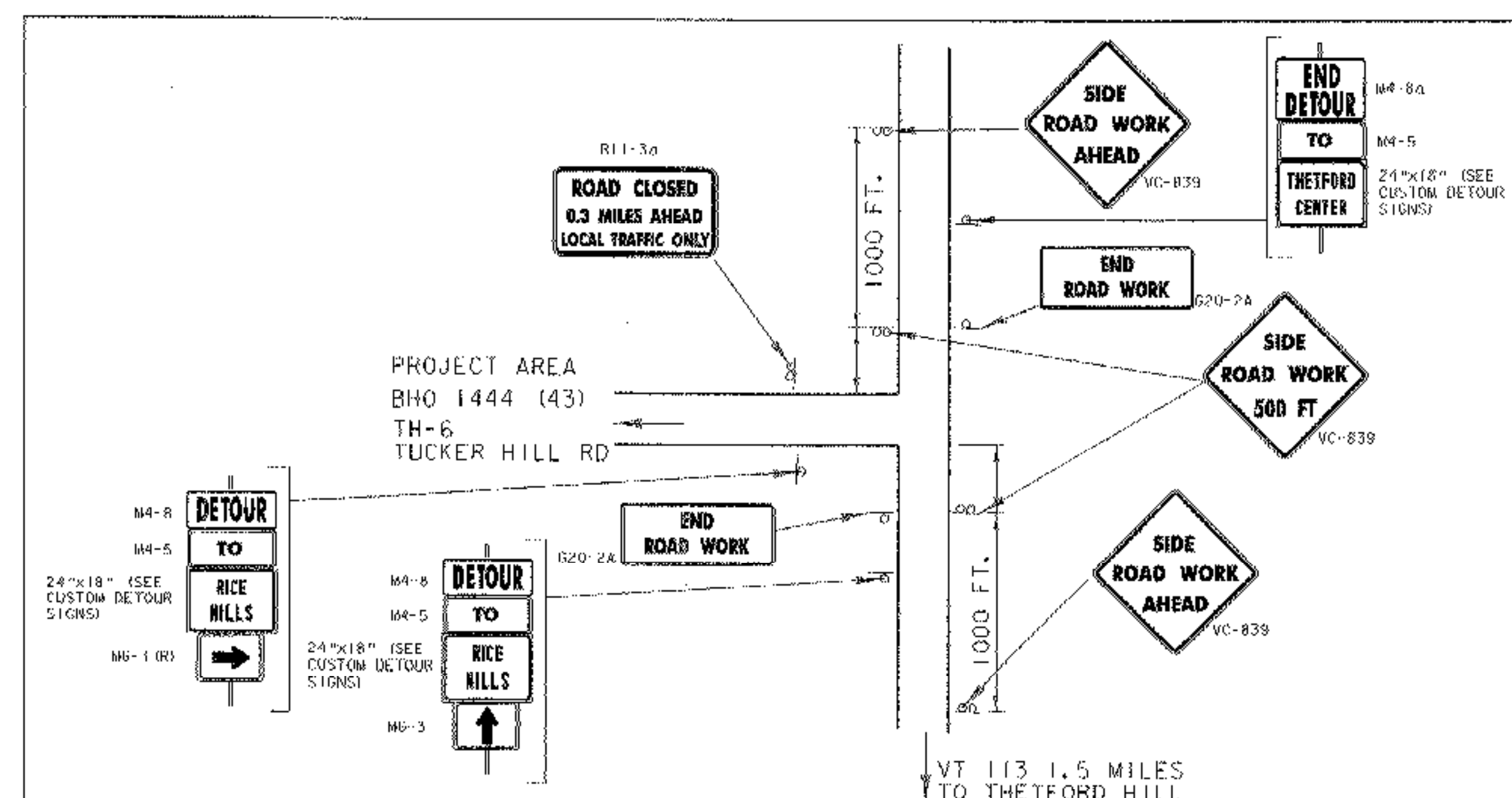

E
INTERSECTION TH-4 (ACADEMY RD.) AND TH-3 AT POST MILLS BRIDGE

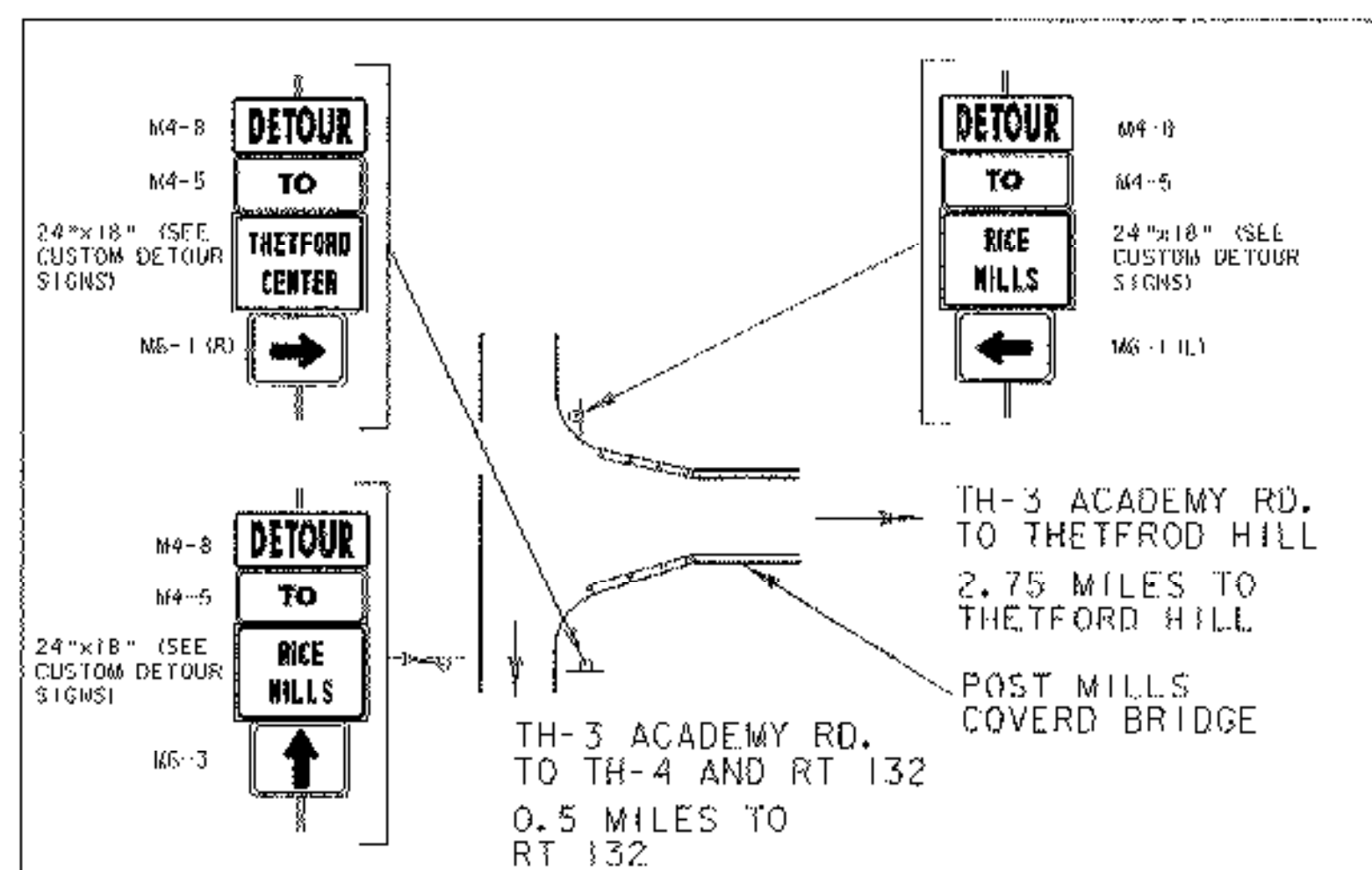

THE "DETOUR" AND "END DETOUR" SIGNS WILL BE BLACK LETTERS ON ORANGE BACK GROUND, ASTM TYPE VIII OR IX RETRO-REFLECTIVE SHEETING.

THE LEAD SIGNS "SIDE ROAD WORK AHEAD, END ROAD WORK, SIDE ROAD WORK 500 FT." AND "BRIDGE CLOSED AHEAD" WILL BE BLACK LETTERS ON ORANGE BACK GROUND, ASTM TYPE VIII OR IX RETRO-REFLECTIVE SHEETING.

THE "TO" AND "ARROWS" SIGNS WILL BE BLACK LETTERS ON WHITE BACK GROUND, ASTM TYPE III SHEETING.

THE "ROAD CLOSED LOCAL TRAFFIC ONLY" AND "BRIDGE CLOSED" SIGNS WILL BE BLACK LETTERS ON WHITE BACK GROUND, ASTM TYPE III SHEETING.

DRAWINGS ON THIS SHEET ARE NOT TO SCALE

TEMPORARY DETOUR SIGNAGE AND ROUTING (2)

PROJECT NAME:	THETFORD	PLOT DATE:	27-SEP-2006
PROJECT NUMBER:	BHO 1444 (43)	DRAWN BY:	G. ROKES
FILE NAME:	Structures\03J036det.dgn	CHECKED BY:	S. SCRIBNER
DESIGNED BY:	G. ROKES	SHEET	13 OF 60
IPARM:	03J036d12.1		