

INDEX OF SHEETS

1. TITLE SHEET
2. PRELIMINARY INFORMATION SHEET
3. QUANTITY SHEET 1
4. QUANTITY SHEET 2
5. TIE SHEET
6. LAYOUT SHEET 1
7. PROFILE SHEET
8. MISC. DETAILS
9. PLAN AND ELEVATION
10. RESOURCE SHEET
11. GENERAL NOTES
12. TYPICAL BRIDGE SECTION
13. FLOOR FRAMING PLAN AND TRUSS ELEVATION
14. TRUSS DETAILS
15. DECK AND CURB SHEET
16. SIDING DETAILS
17. END BRIDGE DETAILS
18. ABUT. 1 DETAILS
19. ABUT. 2 DETAILS
20. WINGWALL DETAILS
21. BRIDGE SEAT AND CORNER DETAILS
22. DOWNSPOUT DETAILS
23. RAILING DETAIL SHEET
24. TRAFFIC SIGN SUMMARY
25. REINFORCING STEEL SCHEDULE
- 26-29. ROADWAY CROSS SECTIONS
- 30-31. CHANNEL CROSS SECTIONS
32. EROSION PREVENTION AND SEDIMENT CONTROL NARRATIVE
33. EXISTING CONDITIONS
34. EROSION PREVENTION AND SEDIMENT CONTROL PLAN
35. FINAL CONDITIONS
36. EROSION PREVENTION AND SEDIMENT CONTROL NOTES
- 37-40. EROSION PREVENTION AND SEDIMENT CONTROL DETAILS

LIST OF STANDARDS

B-5	06-01-1994
E-107	06-30-2003
E-107A	08-08-1995
E-121	08-08-1995
E-141	09-20-1995
E-155	05-01-2004
E-160	05-20-1999
G-1	01-03-2000
G-1d	01-03-2000

STATE OF VERMONT AGENCY OF TRANSPORTATION

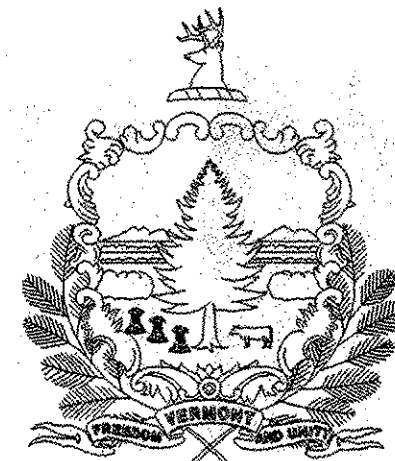

PROPOSED IMPROVEMENT BRIDGE PROJECT TOWN OF TUNBRIDGE COUNTY OF ORANGE

ROUTE NO. : TH 45 BRIDGE NO. : 33 "CILLEY BRIDGE"

PROJECT LOCATION : LOCATED IN THE COUNTY OF ORANGE, TOWN OF TUNBRIDGE, ON TOWN HIGHWAY 45,
BRIDGE 33 AT THE INTERSECTION OF TOWN HIGHWAY 45 AND TOWN HIGHWAY 48.

PROJECT DESCRIPTION : THE PROJECT SHALL CONSIST OF THE REHABILITATION OF THE CILLEY COVERED
BRIDGE AND RELATED APPROACH WORK.

LENGTH OF STRUCTURE : 68.50 FEET
LENGTH OF PARTICIPATION ROADWAY : 81.50 FEET
LENGTH OF PROJECT : 150.00 FEET

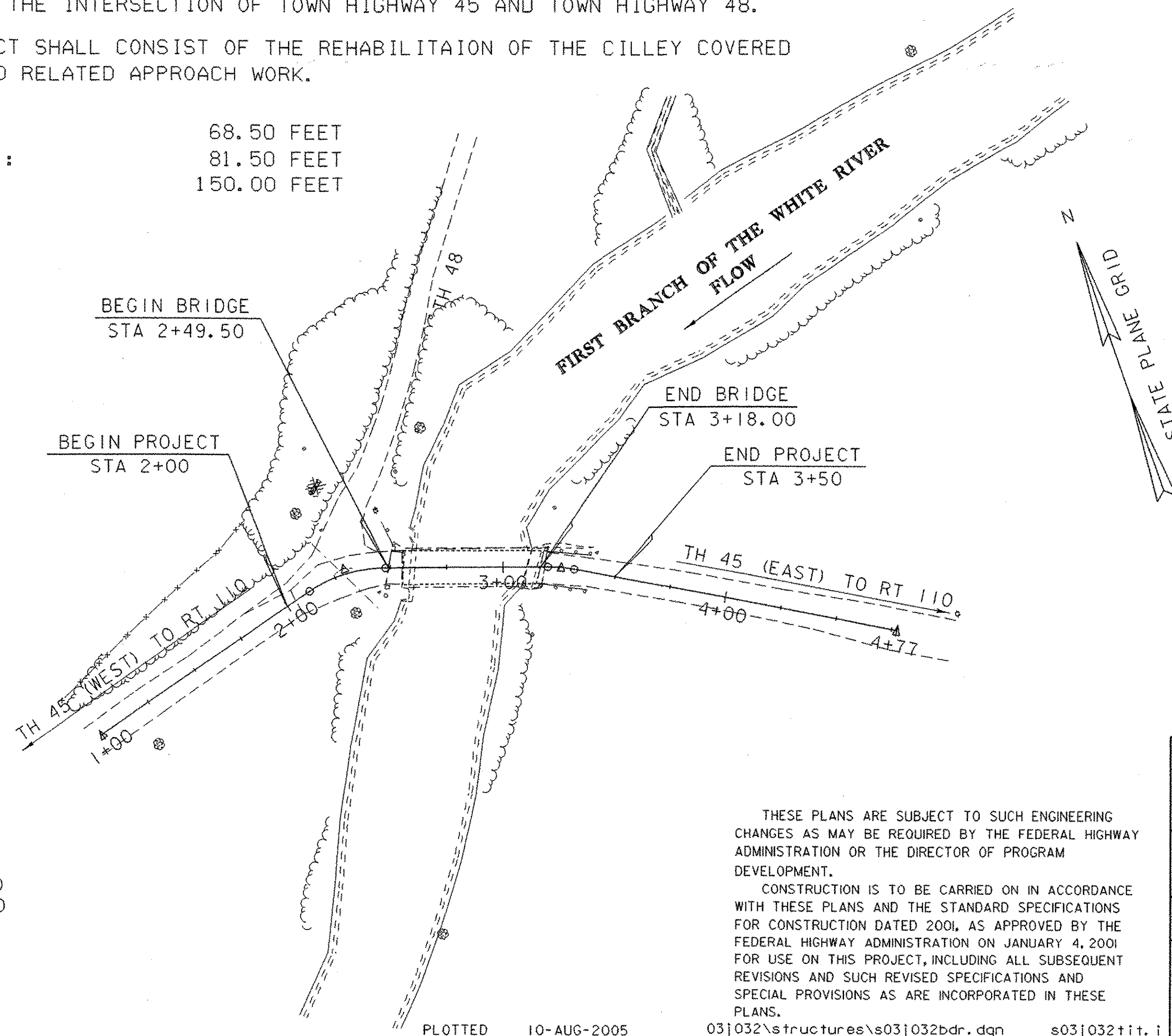
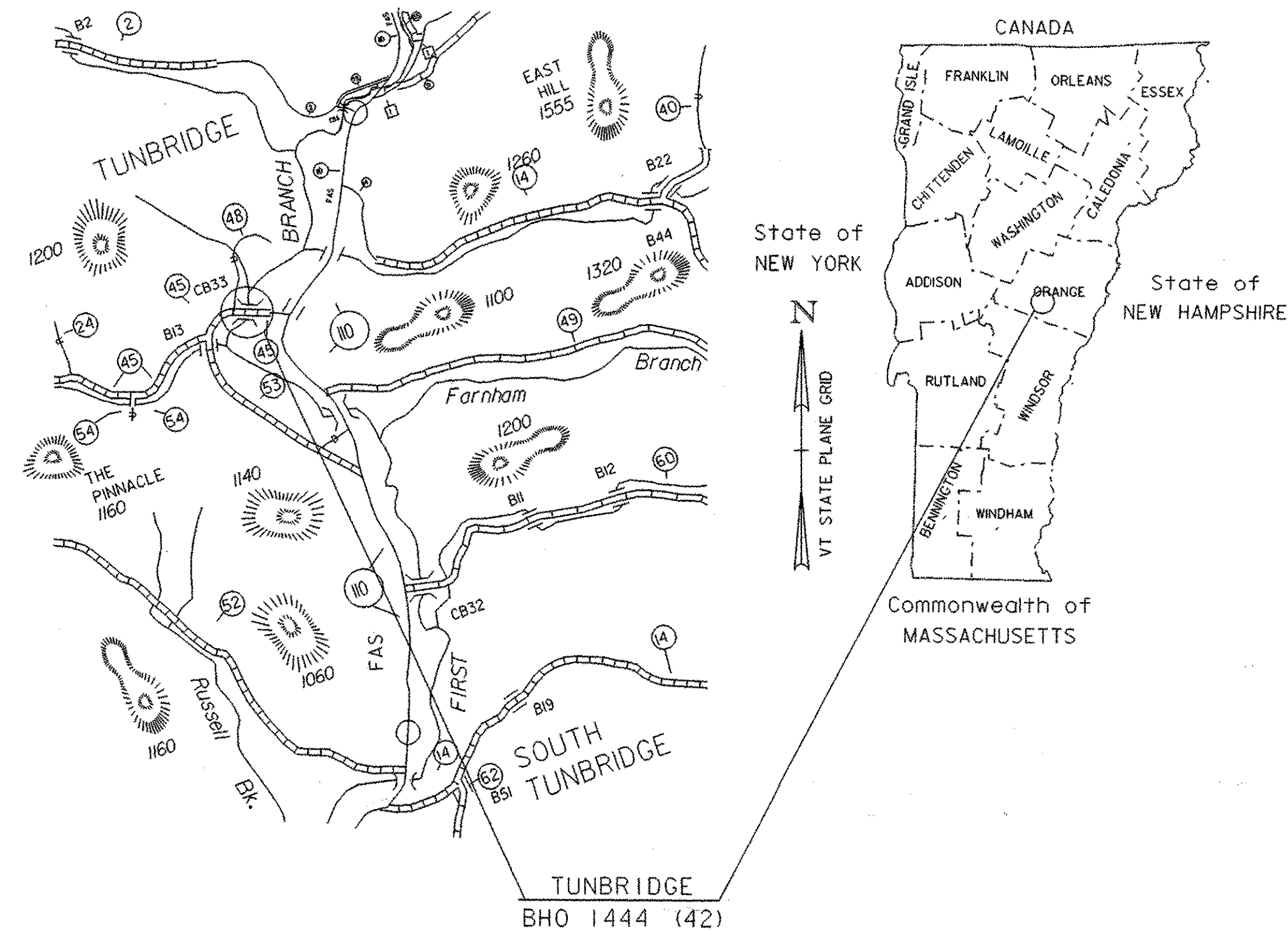

RECORD PLANS	
CONTRACTOR:	WRITE CONSTRUCTION CO., INC. - MT. HOLLY, VT
RESIDENT ENGINEER:	TOM CHASE
CONSTRUCTION BEGAN:	APRIL 17, 2006
CONSTRUCTION COMPLETE:	AUGUST 15, 2006
RECORD PLANS BY:	TOM CHASE & C. PIERCE
I HEREBY CERTIFY THAT ALL THE CONSTRUCTION REQUIRED BY THIS SET OF DRAWINGS HAS BEEN ACCOMPLISHED AS INDICATED HEREIN.	
BY	<u>Thomas A. Chase</u> RESIDENT ENGINEER
DATE	<u>03/12/07</u>
NOTE: Any further information concerning final quantities, amounts or other details relative to this project may be found at Central Files in the electronic archives.	

CONVENTIONAL SYMBOLS	
COUNTY LINE	
TOWN LINE	
LIMITS OF ACCESS	
POINT OF ACCESS	
FENCE LINE	
STONE WALL	
TRAVELED WAY	
GUARD RAIL	
RAILROAD	
SURVEY LINE	
CULVERT	
POWER POLE	
TELEPHONE POLE	
TREES	
CONTROL OF ACCESS	
PROPERTY LINE	
R.O.W. TAKING LINE	
SLOPE RIGHTS	
TOP OF CUT	
TOE OF SLOPE	

SURVEYED BY : R. GILMAN
SURVEYED DATE : JUNE 08 2003

DATUM
VERTICAL NAVD88
HORIZONTAL NAD83 (96)

SCALE 1" = 40'-0"
40 0 40

THESE PLANS ARE SUBJECT TO SUCH ENGINEERING CHANGES AS MAY BE REQUIRED BY THE FEDERAL HIGHWAY ADMINISTRATION OR THE DIRECTOR OF PROGRAM DEVELOPMENT.
CONSTRUCTION IS TO BE CARRIED ON IN ACCORDANCE WITH THESE PLANS AND THE STANDARD SPECIFICATIONS FOR CONSTRUCTION DATED 2001, AS APPROVED BY THE FEDERAL HIGHWAY ADMINISTRATION ON JANUARY 4, 2001 FOR USE ON THIS PROJECT, INCLUDING ALL SUBSEQUENT REVISIONS AND SUCH REVISED SPECIFICATIONS AND SPECIAL PROVISIONS AS ARE INCORPORATED IN THESE PLANS.

DEPARTMENT OF TRANSPORTATION FEDERAL HIGHWAY ADMINISTRATOR	
APPROVED	DATE 9-8-2005
DIRECTOR OF PROGRAM DEVELOPMENT	
APPROVED	DATE 8-10-05
PROJECT MANAGER :	C. P. WILLIAMS
PROJECT NAME :	TUNBRIDGE
PROJECT NUMBER :	BHO 1444 (42)
SHEET 1 OF 40 SHEETS	