

SEE SHEET 2 INDEX OF SHEETS

# STATE OF VERMONT AGENCY OF TRANSPORTATION



## PROPOSED IMPROVEMENT TOWN OF FRANKLIN COUNTY OF FRANKLIN

### TOWN HIGHWAY NO. 3, CLASS 2 (MAJOR COLLECTOR)

**PROJECT LOCATION:**  
BEGINNING ON FRANKLIN TOWN HIGHWAY 3, 0.438KM FROM THE INTERSECTION OF FRANKLIN TOWN HIGHWAY 21 AND 3, AND EXTENDING IN A NORTHEASTERLY DIRECTION TO END AT THE INTERSECTION OF FRANKLIN TOWN HIGHWAY 3 AND VERMONT ROUTE 120

LENGTH OF ROADWAY = 434.139 m = 0.434KM  
LENGTH OF PROJECT = 434.139 m = 0.434KM

**PROJECT DESCRIPTION:**  
RECONSTRUCTION OF TOWN HIGHWAY 3 IN THE VILLAGE OF FRANKLIN, INCLUDING NEW DRAINAGE SYSTEM, SUBBASE, BITUMINOUS CONCRETE PAVEMENT AND CURB

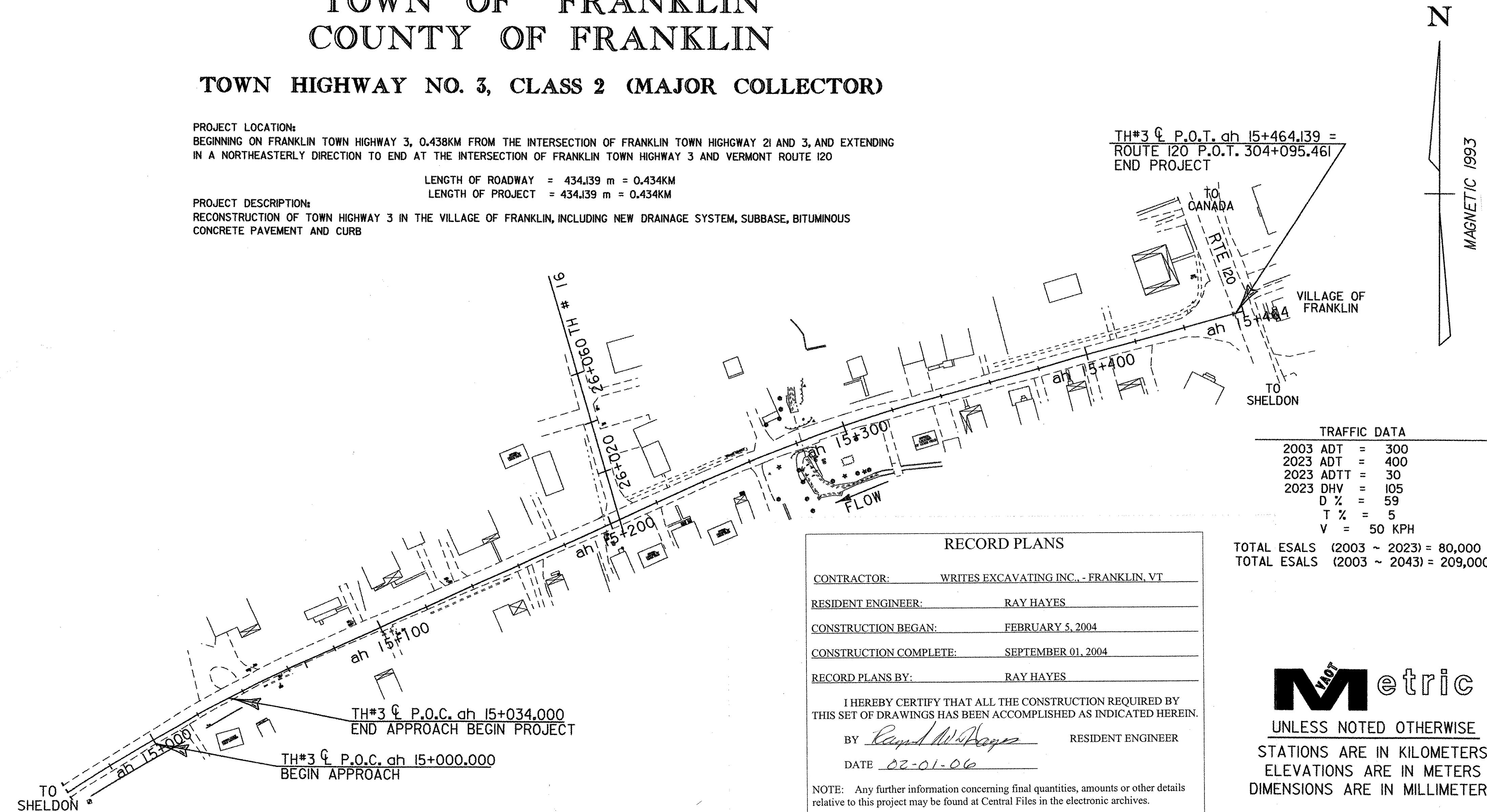
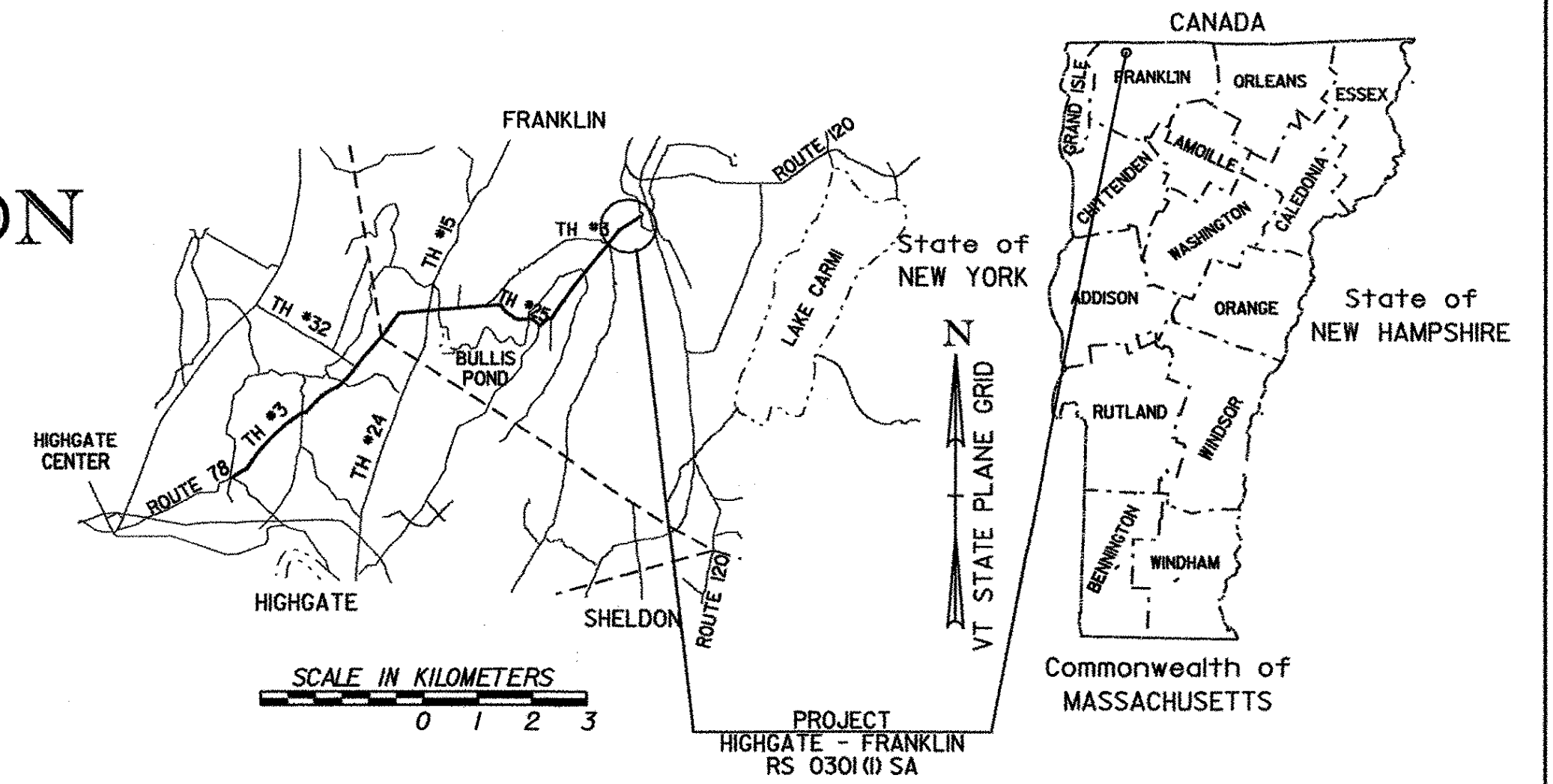

TRAFFIC DATA	
2003 ADT	= 300
2023 ADT	= 400
2023 ADTT	= 30
2023 DHV	= 105
D %	= 59
T %	= 5
V	= 50 KPH
TOTAL ESALS (2003 ~ 2023) = 80,000	
TOTAL ESALS (2003 ~ 2043) = 209,000	

CONVENTIONAL SYMBOLS	
COUNTY LINE	
TOWN LINE	
LIMITS OF ACCESS	
POINT OF ACCESS	
FENCE LINE	
STONE WALL	
TRAVELED WAY	
GUARD RAIL	
RAILROAD	
SURVEY LINE	
CULVERT	
POWER POLE	
TELEPHONE POLE	
TREES	
CONTROL OF ACCESS	
PROPERTY LINE	
R.O.W. TAKING LINE	
SLOPE RIGHTS	
TOP OF CUT	
TOE OF SLOPE	

SURVEYED BY :	
SURVEYED DATE :	
DATUM	NGVD 1929
VERTICAL	N/A
HORIZONTAL	N/A

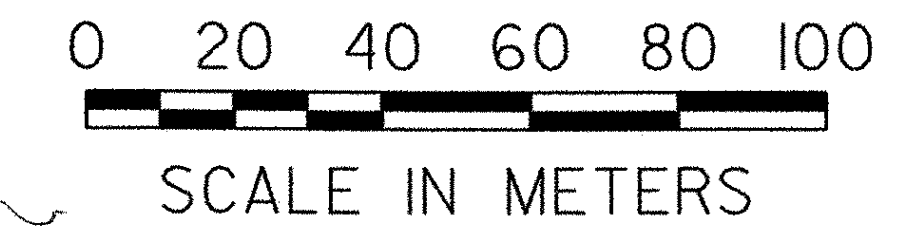

**RECORD PLANS**

CONTRACTOR: WRITES EXCAVATING INC., - FRANKLIN, VT

RESIDENT ENGINEER: RAY HAYES

CONSTRUCTION BEGAN: FEBRUARY 5, 2004

CONSTRUCTION COMPLETE: SEPTEMBER 01, 2004

RECORD PLANS BY: RAY HAYES

I HEREBY CERTIFY THAT ALL THE CONSTRUCTION REQUIRED BY THIS SET OF DRAWINGS HAS BEEN ACCOMPLISHED AS INDICATED HEREIN.

BY *Ray Hayes* RESIDENT ENGINEER  
DATE 02-01-06

NOTE: Any further information concerning final quantities, amounts or other details relative to this project may be found at Central Files in the electronic archives.

THESE PLANS ARE SUBJECT TO SUCH ENGINEERING CHANGES AS MAY BE REQUIRED BY THE FEDERAL HIGHWAY ADMINISTRATION OR THE DIRECTOR OF PROGRAM DEVELOPMENT.

CONSTRUCTION IS TO BE CARRIED ON IN ACCORDANCE WITH THESE PLANS AND THE STANDARD SPECIFICATIONS FOR CONSTRUCTION DATED 2001, AS APPROVED BY THE FEDERAL HIGHWAY ADMINISTRATION ON JANUARY 4, 2001 FOR USE ON THIS PROJECT, INCLUDING ALL SUBSEQUENT REVISIONS AND SUCH REVISED SPECIFICATIONS AND SPECIAL PROVISIONS AS ARE INCORPORATED IN THESE PLANS.

**Metric**

UNLESS NOTED OTHERWISE  
STATIONS ARE IN KILOMETERS  
ELEVATIONS ARE IN METERS  
DIMENSIONS ARE IN MILLIMETERS

DIRECTOR OF PROGRAM DEVELOPMENT	
APPROVED <i>[Signature]</i>	DATE 4/3/03
PROJECT MANAGER : G. DuBrey	
PROJECT NAME :	FRANKLIN
PROJECT NUMBER :	STP 0301 (18)
SHEET 1 OF 60 SHEETS	