

EROSION CONTROL LAYOUT

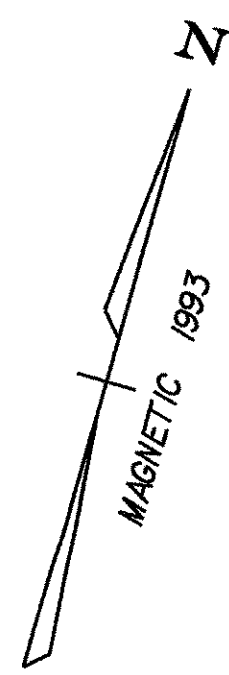

SODDING

ah 15+300 ~ ah 15+313 RT. (13M)
ah 15+320 ~ ah 15+334 RT. (15M)
ah 15+344 ~ ah 15+348 RT. (5M)
ah 15+349 ~ ah 15+371 RT. (26M)
ah 15+425 ~ ah 15+458 RT. (40M)
ah 15+300 ~ ah 15+328 LT. (29M)
ah 15+344 ~ ah 15+348 LT. (4M)
ah 15+349 ~ ah 15+353 LT. (9M)

NOTES

SODDING SHALL BE APPLIED IMMEDIATELY ON ALL LAWNS DISTURBED BEYOND THE WORK AREA DELINEATED ON THESE PLANS. ALL CONSTRUCTION SHALL BE PERFORMED FROM THE ROADWAY OUT.
 OUTSIDE OF THE ROADWAY BOXED EXCAVATION, ALL NEWLY CONSTRUCTED SLOPES (EXCAVATED OR EMBANKMENT) SHALL BE SEALED WITH 5MM THICK TOPSOIL AND MULCHED AT THE END OF EACH WORKDAY IN ACCORDANCE WITH THE SPECIFICATION AND THESE PLANS.

NOTES

EXISTING DRAINAGE SHALL BE UTILIZED AS LONG AS POSSIBLE UNTIL NEW SYSTEM CAN BE PUT INTO SERVICE. NEW CB AND DISTRICTURES SHALL BE COVERED DURING CONSTRUCTION UNTIL TOPS CAN BE SET AND SYSTEM PUT INTO SERVICE

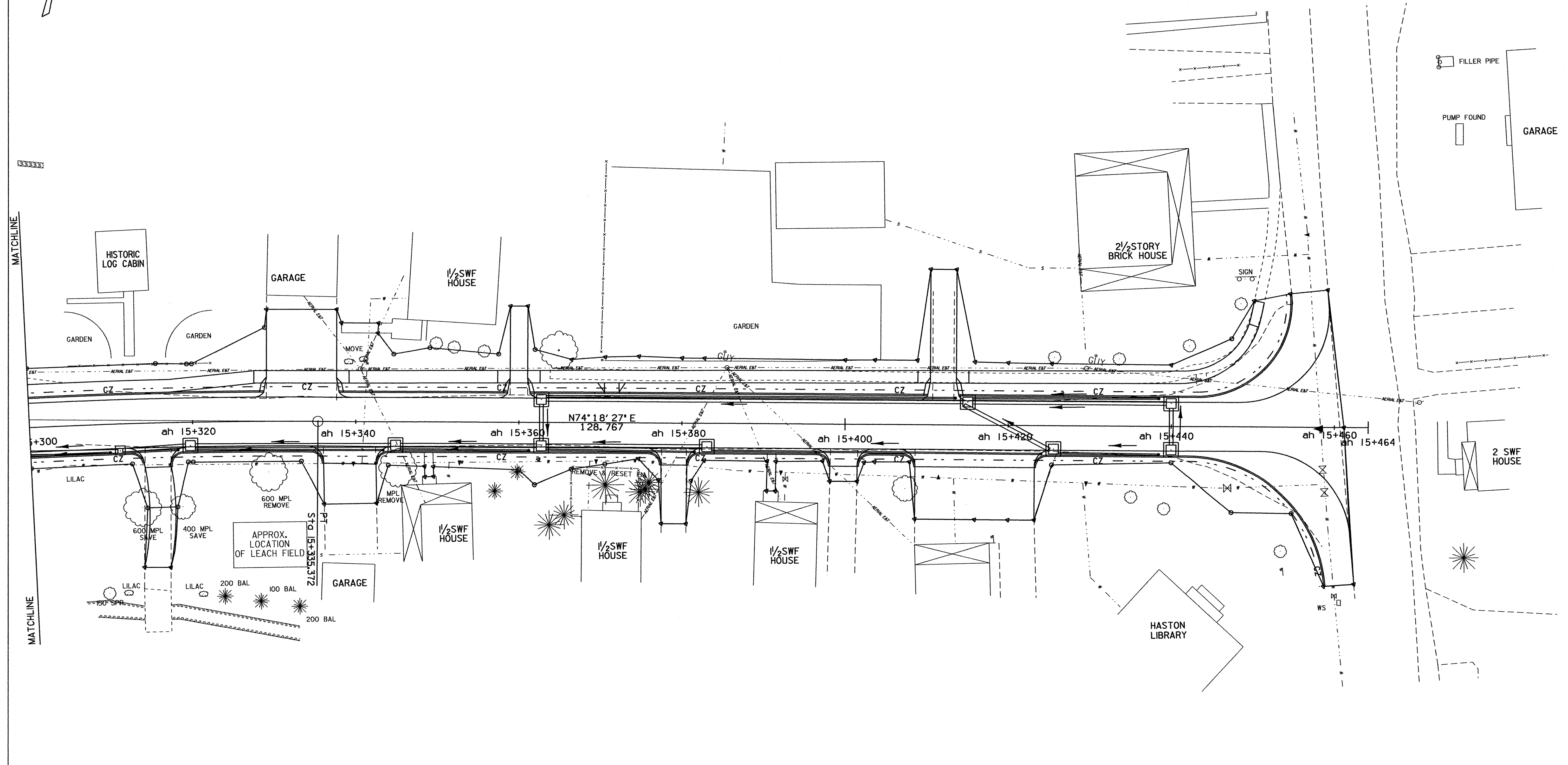

○ DENOTES TREE OR STUMP REMOVAL

ALL DRIVE RADII SHALL BE 6M UNLESS OTHERWISE NOTED PER STD B-71M

EROSION CONTROL LAYOUT

PROJECT NAME:	FRANKLIN	FILE NAME:	...85c060/desigr/dc060bdr.dgn	PLOT DATE:	27-MAR-2003
PROJECT NUMBER:	STP 0301(18)	PROJECT LEADER:	DELLASANTA	DRAWN BY:	SQUAD B
		DESIGNED BY:	SQUAD B	CHECKED BY:	SQUAD B
		IPARM FILE NAME:	(2)dc060ec3.1	SHEET	32 OF 60