

T.H. 16 APPROACH SIGN PACKAGE

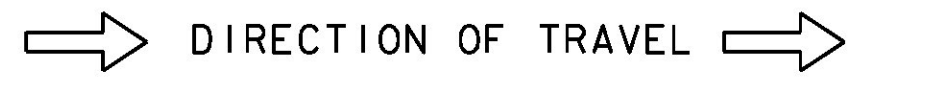

T.H. 1 APPROACH SIGN PACKAGE

APPROACH SIGN NOTES:

1. ALL SIGNS ARE TO BE LOCATED ON THE RIGHT SIDE OF THE ROAD APPROACHING THE CONSTRUCTION AREA UNLESS OTHERWISE NOTED.
2. PORTABLE CHANGEABLE MESSAGE SIGNS TO BE USED AT THE DISCRETION OF THE ENGINEER. IF USED, PCMS WILL BE PAID AS ITEM 641.15 PORTABLE CHANGEABLE MESSAGE SIGN.

CHICKEN FARM ROAD (T.H. 16) DETOUR CURVE DATA

CURVE 1 DELTA = 5°51'12" D = 28°38'52" R = 200.00' T = 10.23' L = 20.43' E = 0.26'	CURVE 3 DELTA = 49°16'35" D = 63°39'43" R = 90.00' T = 41.28' L = 77.40' E = 9.01'
CURVE 2 DELTA = 8°41'55" D = 32°44'26" R = 175.00' T = 13.31' L = 26.57' E = 0.51'	CURVE 4 DELTA = 33°30'13" D = 76°23'40" R = 75.00' T = 22.57' L = 43.86' E = 3.32'
	CURVE 5 DELTA = 20°09'23" D = 76°23'40" R = 75.00' T = 13.33' L = 26.38' E = 1.18'

TRAFFIC CONTROL NOTES:

1. ALL TRAFFIC SIGNS SHALL CONFORM TO THE CURRENT EDITION OF THE MANUAL ON UNIFORM TRAFFIC CONTROL DEVICES (MUTCD).
2. "END ROAD WORK" SIGNS TO BE LOCATED 500' PAST END OF WORK IN THE THREE DIRECTIONS SHOWN ON THIS SHEET.
3. AT THE DISCRETION OF THE ENGINEER, TEMPORARY EDGE LINES MAY BE USED THROUGHOUT THE LENGTH OF THE SINGLE-LANE SECTION OF THE TEMPORARY DETOUR.

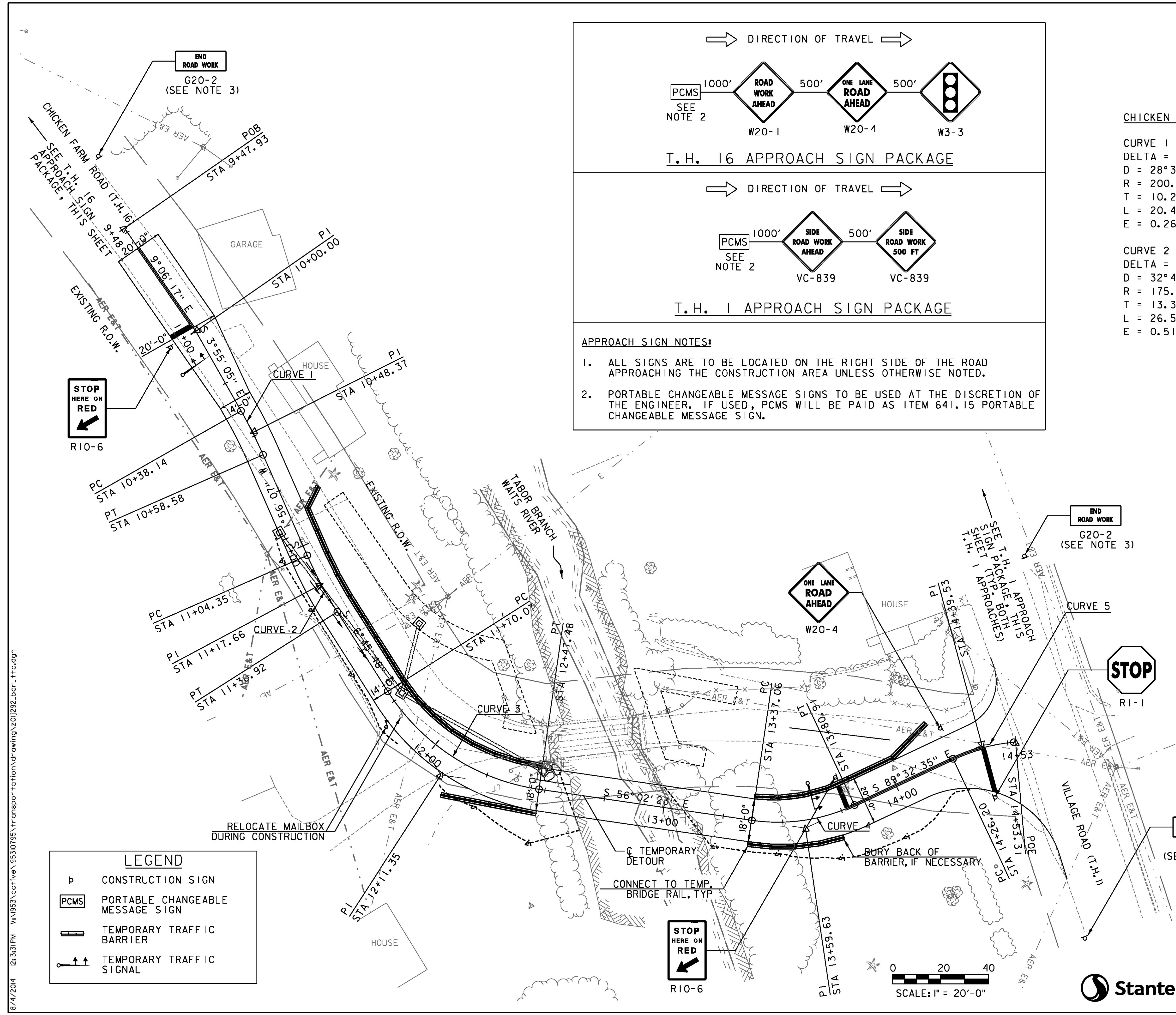

LEGEND

	CONSTRUCTION SIGN
	PORTABLE CHANGEABLE MESSAGE SIGN
	TEMPORARY TRAFFIC BARRIER
	TEMPORARY TRAFFIC SIGNAL

PROJECT NAME: CORINTH	PLOT DATE: 8/4/2014
PROJECT NUMBER: BRO 1447(29)	DRAWN BY: E. ALLING
FILE NAME: ...drawing\z01j292_bdr_+tc.dgn	CHECKED BY: T. LUTHER
DESIGNED BY: E. ALLING	SHEET 14 OF 57
TRAFFIC CONTROL SHEET - TCS 1	



8/4/2014 12:33:31PM V:\9533\active\95330795\transportation\drawing\z01j292_bdr_+tc.dgn