

- (103) STA. 102+79 LT TO STA. 102+91 LT
 - (100) STA. 101+67 RT TO STA. 102+23 RT
NEW 18" X 64", PIPE OPTION 1
WITH DI @ INLET AND ES @ OUTLET
 - (101) STA. 101+56 LT TO STA. 101+67 RT
NEW 18" X 28", PIPE OPTION 1
WITH DI @ INLET AND OUTLET
 - (102) STA. 100+90 RT TO STA. 101+67 RT
NEW 18" X 80", PIPE OPTION 1
WITH DI @ INLET AND OUTLET
- PIPE OPTION 1 = PCCSP, CAAP, RCP OR CPEP (SL)

CHICKEN FARM ROAD (T.H. 16) CURVE DATA

CURVE (1)	CURVE (2)
Δ = 48°45'20"	Δ = 7°11'44"
D = 76°23'40"	D = 7°38'22"
R = 75.00'	R = 750.00'
T = 33.99'	T = 47.16'
L = 63.82'	L = 94.19'
E = 7.34'	E = 1.48'

**ITEM 621.72 - GUARDRAIL APPROACH SECTION,
GALVANIZED 2 RAIL BOX BEAM (COATED BLACK)**

- STA. 101+63.5 - 101+97.5, LT.
- STA. 101+88.4 - 102+11.3, RT.
- STA. 102+62.7 - 102+96.7, LT.
- STA. 102+76.5 - 103+10.5, RT.

**ITEM 621.30 - BOX BEAM GUARDRAIL
(COATED BLACK)**

- STA. 100+87.9 - 101+63.5, LT.
- STA. 101+87.3 - 101+88.4, RT.
- STA. 102+96.7 - 103+54.3, LT.
- STA. 103+10.5 - 103+14.1, RT.

ITEM 616.21 - VERTICAL GRANITE CURB

- STA. 100+90.0 - 101+97.5, LT.
- STA. 102+69.5 - 102+98.8, LT.

DRIVES

- STA. 101+87.6, RT. (GRAVEL)

ITEM 201.15 - REMOVING MEDIUM TREES

- STA. 101+41.6, LT.

ITEM 620.55 - REMOVAL OF EXISTING FENCE

- STA. 102+88.5 - 103+28.8, LT.

**ITEM 621.80 - REMOVAL AND
DISPOSAL OF GUARDRAIL**

- STA. 101+99.6 - 102+21.4, LT.
- STA. 102+11.3 - 102+25.6, RT.
- STA. 102+62.1 - 102+81.0, LT.
- STA. 102+66.1 - 102+93.8, RT.

ITEM 613.12 - STONE FILL, TYPE III

- STA. 102+23 - 102+38, RT.
- STA. 102+79 - 102+69, LT

**ITEM 617.10 - RELOCATE MAILBOX,
SINGLE SUPPORT**

- STA. 101+69.8, RT.

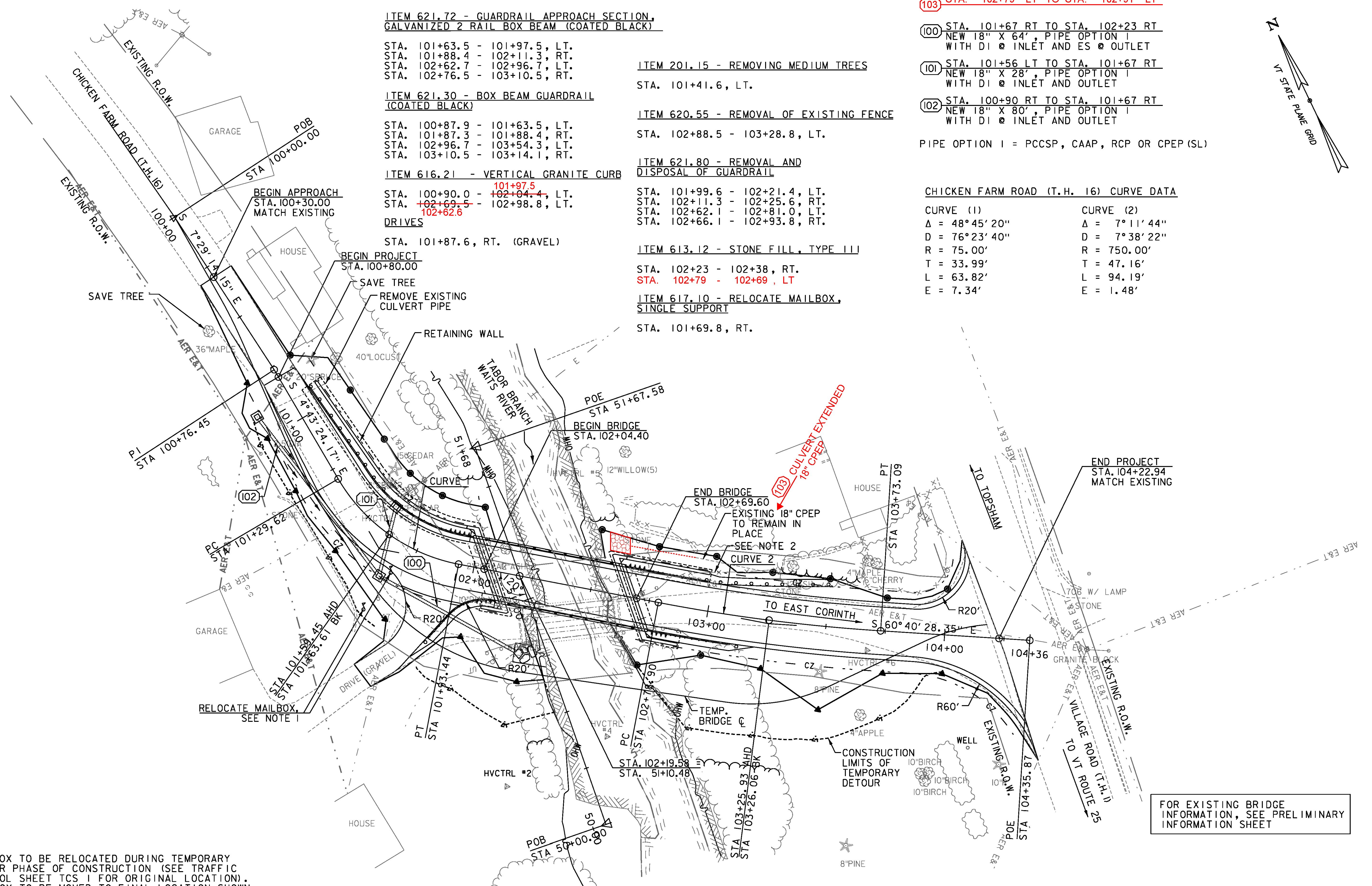

NOTES:

1. MAILBOX TO BE RELOCATED DURING TEMPORARY DETOUR PHASE OF CONSTRUCTION (SEE TRAFFIC CONTROL SHEET TCS 1 FOR ORIGINAL LOCATION). MAILBOX TO BE MOVED TO FINAL LOCATION SHOWN ON THIS SHEET IMMEDIATELY AFTER THE TEMPORARY DETOUR IS CLOSED AND T.H. 16 IS REOPENED TO TRAFFIC.
2. EXISTING WOODEN FENCES SHALL BE REMOVED AND RETURNED TO LAND OWNERS AS DIRECTED BY THE ENGINEER.

FOR EXISTING BRIDGE INFORMATION, SEE PRELIMINARY INFORMATION SHEET

PROJECT NAME: CORINTH	PLOT DATE: 8/4/2014
PROJECT NUMBER: BRO 1447(29)	DRAWN BY: E. ALLING
FILE NAME: ...drawing\z01j292_bdr.dgn	CHECKED BY: G. BOGUE
DESIGNED BY: M. CHENETTE	SHEET II OF 57
PLAN LAYOUT SHEET - PL 1	



8/4/2014 12:13:07 PM V:\9533\active\953310795\transportation\drawing\z01j292_bdr.dgn