

STRUCTURAL STEEL 78

FIELD BOLT SUMMARY				NOTE: 4% ADDITIONAL BOLTS ADDED + 3 FOR TESTING		
LINE	No. OF BOLT BOLTS	DIAM	TYPE	BOLT LENGTH	ACTUAL COUNT	REMARKS
1	128	22	ASTM - A325 MC	57	120	w / 1 FLAT WASHER
2	-	-	-	-	-	-
3	-	-	-	-	-	-
4	-	-	-	-	-	-

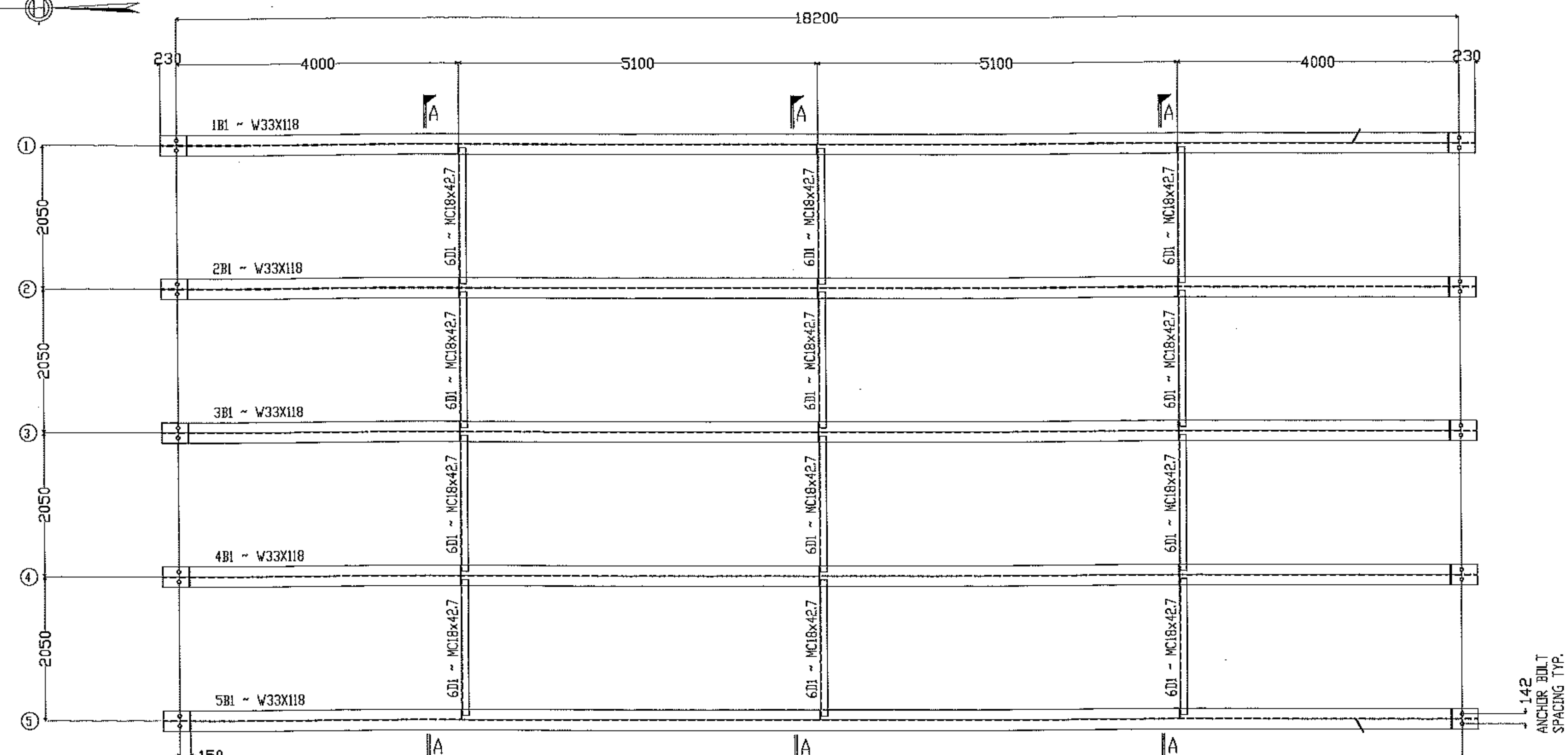

FRAMING PLAN

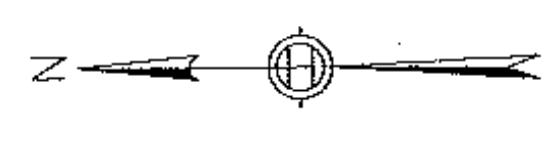
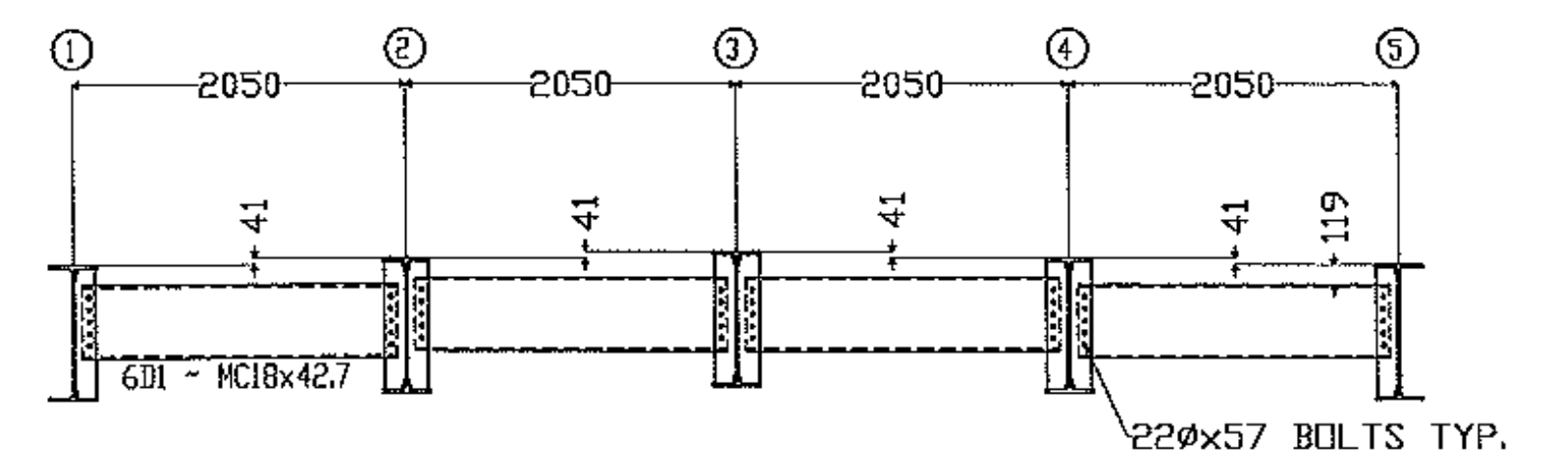

SECTION A-A

BTM OF BEAM ELEVATION

102.730m @ BEAM 1
102.771m @ BEAM 2
102.812m @ BEAM 3
102.771m @ BEAM 4
102.730m @ BEAM 5

BTM OF BEAM ELEVATION

102.639m @ BEAM 1
102.680m @ BEAM 2
102.721m @ BEAM 3
102.680m @ BEAM 4
102.639m @ BEAM 5

EMBEDMENT 450
 ABUTMENT # 1 - C.L. BEARING 150
 (2) 6M1-50φ SWEDGED ANCHOR BOLT
 (1) 6P1-LEVELING PLATE

91mm DROP FROM ABOUT 1 TO 2
 △
 GIRDER ELEVATION

Vermont Agency of Transportation
RECEIVED
 CK'D BY WDL OK'D BY GS
 8:02 am, Jul 25, 2011
 RESUBMIT APPROVED X
 BY CWC DATE 07/25/11

3		
2		
1	7.21.11	APPROVER COMMENTS
REV. NO.	DATE	REVISION
ERECTION DRAWING		
SILVER ST. BRDG - HINESBURG STATE OF VERMONT PROJECT No. STP 0199(2)		
PRECISE STRUCTURAL PRODUCTS 3 FARM LANE GEORGETOWN, MA 01833 978-352-2591		
OWNER: VT AGENCY OF TRANSPORTATION CONTRACTOR: A.L. ST.ONGE CONTRACTORS, INC		
DRAWN BY	CHECKED BY	APP. SHOP DIST. CONTRACT NO. SHEET NO.
KC	WL	
06/24/11	06/28/11	3578 E1