

LEGEND
WETLANDS

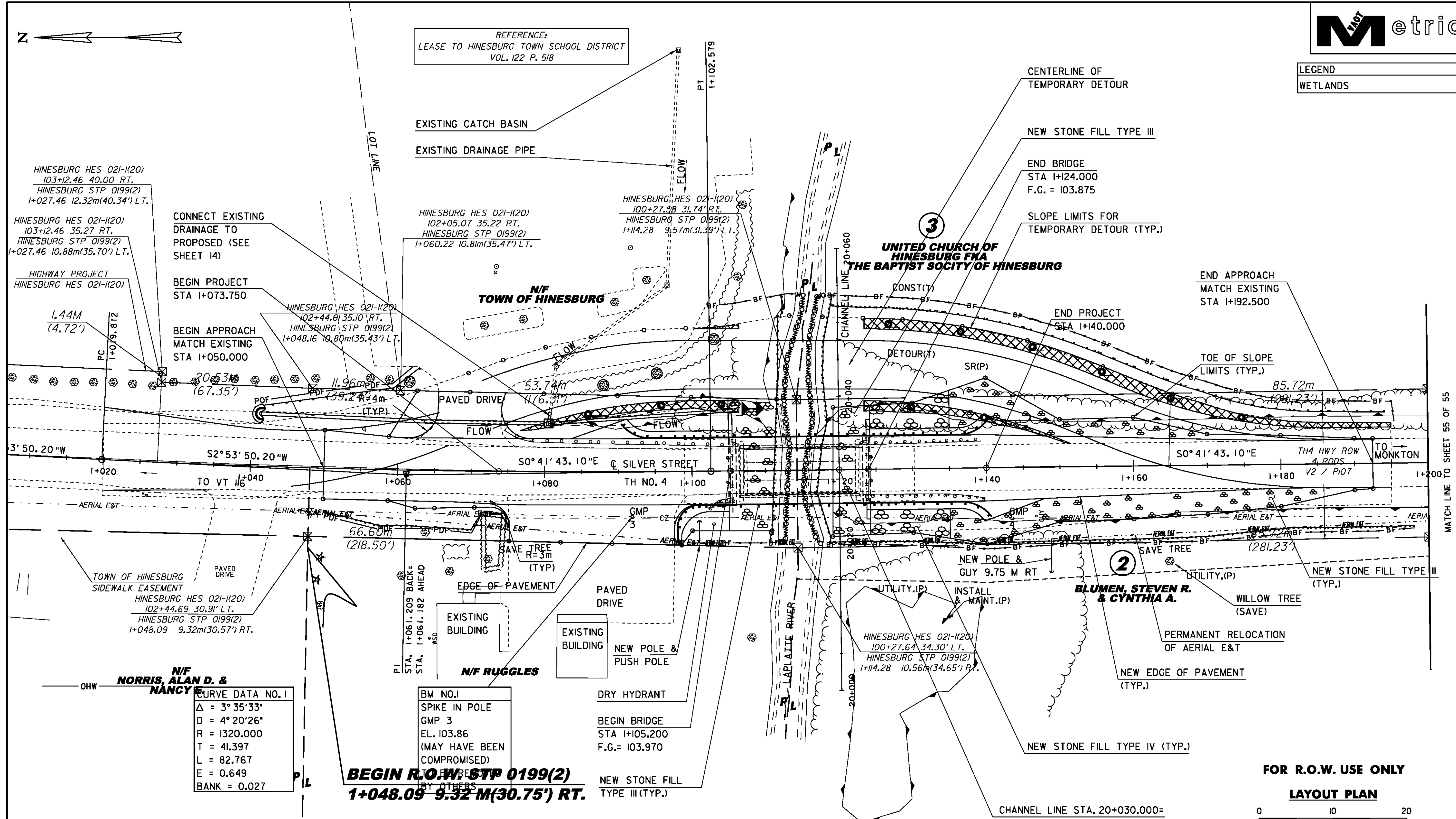

HINESBURG HES 021-K20
103+12.46 40.00 RT.
HINESBURG STP 0199(2)
1+027.46 12.32m(40.34') LT.

HINESBURG HES 021-K20
103+12.46 35.27 RT.
HINESBURG STP 0199(2)
1+027.46 10.88m(35.70') LT.

HIGHWAY PROJECT
HINESBURG HES 021-K20

1.44M
(4.72')

3' 50.20"W
S2° 53' 50.20"W

AERIAL E&T

TOWN OF HINESBURG
SIDEWALK EASEMENT
HINESBURG HES 021-K20
102+44.69 30.91' LT.
HINESBURG STP 0199(2)
1+048.09 9.32m(30.57') RT.

N/F
NORRIS, ALAN D. &
NANCY

CURVE DATA NO. 1
Δ = 3° 35' 33"
D = 4° 20' 26"
R = 1320.000
T = 41.397
L = 82.767
E = 0.649
BANK = 0.027

450 mm OPTION PIPE
STA. 1+063.50 LT - STA. 1+079.90 LT
STA. 1+081.00 LT - STA. 1+108.07 LT

PRECAST REINFORCED CONCRETE
PIPE DI W/ CAST IRON GRATE
STA. 1+080.50 LT

BRIDGE RAILING, ANODIZED 3 RAIL ALUMINUM
STA. 1+103.475 RT - STA. 1+124.125 RT
STA. 1+105.075 LT - STA. 1+124.125 LT

RELOCATE MAILBOX, SINGLE SUPPORT
STA. 1+073 RT

ALUMINUM APPROACH RAILING, ANODIZED
STA. 1+090.400 LT - STA. 1+105.075 LT
STA. 1+098.020 RT - STA. 1+103.475 RT
STA. 1+124.125 RT - STA. 1+140.625 RT
STA. 1+124.125 LT - STA. 1+140.470 LT

100mm WHITE LINE
STA. 1+020.0 LT - STA. 1+195.0 LT
STA. 1+020.0 RT - STA. 1+195.0 RT

100mm YELLOW LINE (DOUBLE CENTERLINE)
STA. 1+020.0 - STA. 1+195.0

REMOVAL AND DISPOSAL OF GUARDRAIL
STA. 1+074.47 LT - STA. 1+106.27 LT
STA. 1+102.17 RT - STA. 1+105.60 RT
STA. 1+122.87 LT - STA. 1+139.29 LT
STA. 1+123.12 RT - STA. 1+139.80 RT

CONSTRUCT DRIVE
STA. 1+061.50 LT - STA. 1+078.30 LT
STA. 1+072.25 RT - STA. 1+100.60 RT

STONE FILL, TYPE II
STA. 1+135.0 RT - STA. 1+190.0 RT
STA. 1+135.0 LT - STA. 1+170.0 LT

STONE FILL, TYPE IV
STA. 1+124.2 RT - STA. 1+135.0 RT
STA. 1+124.2 LT - STA. 1+135.0 LT

DECIDUOUS TREES
(ACER SACCHARUM)
(B&BX100mm CAL)
STA. 1+062 LT
STA. 1+089 LT
STA. 1+096 LT
STA. 1+103 LT

REMOVE TREES
(PAID UNDER ITEM 201.0)
STA. 1+062 LT
STA. 1+089 LT
STA. 1+096 LT
STA. 1+103 LT

YIELDING MARKER POSTS
STA. 1+063.525 LT
STA. 1+106.790 LT

REFERENCE:
LEASE TO HINESBURG TOWN SCHOOL DISTRICT
VOL. 122 P. 518

EXISTING CATCH BASIN
EXISTING DRAINAGE PIPE

HINESBURG HES 021-K20
102+05.07 35.22 RT.
HINESBURG STP 0199(2)
1+060.22 10.81m(35.47') LT.

N/F
TOWN OF HINESBURG

HINESBURG HES 021-K20
102+44.61 35.10 RT.
HINESBURG STP 0199(2)
1+048.16 10.80m(35.43') LT.

PAVED DRIVE
53.74m
(176.31')

SILVER STREET
TH. NO. 4

AERIAL E&T

SAVE TREE
R=3m
(TYP)

N/F RUGGLES
EXISTING BUILDING
NEW POLE & PUSH POLE
DRY HYDRANT

BM NO. 1
SPIKE IN POLE
GMP 3
EL. 103.86
(MAY HAVE BEEN COMPROMISED)

BEGIN R.O.W. STP 0199(2)
1+048.09 9.32 M(30.75') RT.

BEGIN BRIDGE
STA 1+105.200
F.G.= 103.970

NEW STONE FILL
TYPE III(TYP.)

3
UNITED CHURCH OF
HINESBURG FKA
THE BAPTIST SOCIETY OF HINESBURG

CONST(T)
BF

DETOUR(T)
SR(P)

NEW POLE & GUY 9.75 M RT
INSTALL & MAINT.(P)

UTILITY.(P)

HINESBURG HES 021-K20
100+27.64 34.30' LT.
HINESBURG STP 0199(2)
1+114.28 10.56m(34.65') RT.

UTILITY.(P)

NEW STONE FILL TYPE II
(TYP.)

WILLOW TREE (SAVE)

PERMANENT RELOCATION
OF AERIAL E&T

NEW EDGE OF PAVEMENT
(TYP.)

NEW STONE FILL TYPE IV (TYP.)

CHANNEL LINE STA. 20+030.000=
BASELINE STA. 1+120.000
Δ = 90° 00'00" LT

CENTERLINE OF
TEMPORARY DETOUR

NEW STONE FILL TYPE III

END BRIDGE
STA 1+124.000
F.G. = 103.875

SLOPE LIMITS FOR
TEMPORARY DETOUR (TYP.)

END APPROACH
MATCH EXISTING
STA 1+192.500

TOE OF SLOPE
LIMITS (TYP.)
85.72m
(281.23')

TH4 HWY ROW
4.000
V2 / P107

TO MONKTON

AERIAL E&T

SAVE TREE
(281.23')

UTILITY.(P)

BLUMEN, STEVEN R.
& CYNTHIA A.

NEW STONE FILL TYPE II
(TYP.)

UTILITY.(P)

NEW STONE FILL TYPE IV (TYP.)

CHANNEL LINE STA. 20+030.000=
BASELINE STA. 1+120.000
Δ = 90° 00'00" LT

FOR R.O.W. USE ONLY
LAYOUT PLAN

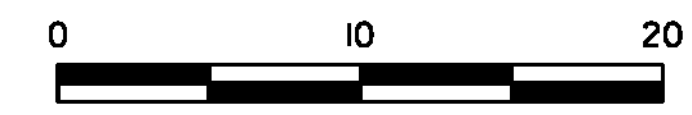

LINE SHOWN ON THIS PLAN AS EXISTING
PROPERTY LINES P/L ARE BELIEVED TO
BE ACCURATE BUT SHOULD NOT BE RELIED
UPON FOR PURPOSES UNRELATED TO THE
TOWN OF HINESBURG'S ACQUISITION OF LAND
AND RIGHTS FOR THIS PROJECT.

PROJECT NAME: HINESBURG
PROJECT NUMBER: STP 0199(2)
FILE NAME: 01J282/str/s01J282row.dgn
PROJECT LEADER: C. CARLSON
DESIGNED BY: W. LAMMER
ROW LAYOUT SHEET 1
PLOT DATE: 02-MAR-2011
DRAWN BY: C. MOONEY
CHECKED BY: C. CARLSON
SHEET 55 OF 56

MATCH LINE TO SHEET 55 OF 55