

SEE SHEET 2 FOR  
INDEX OF SHEETS  
AND LIST OF  
STANDARDS

# STATE OF VERMONT AGENCY OF TRANSPORTATION

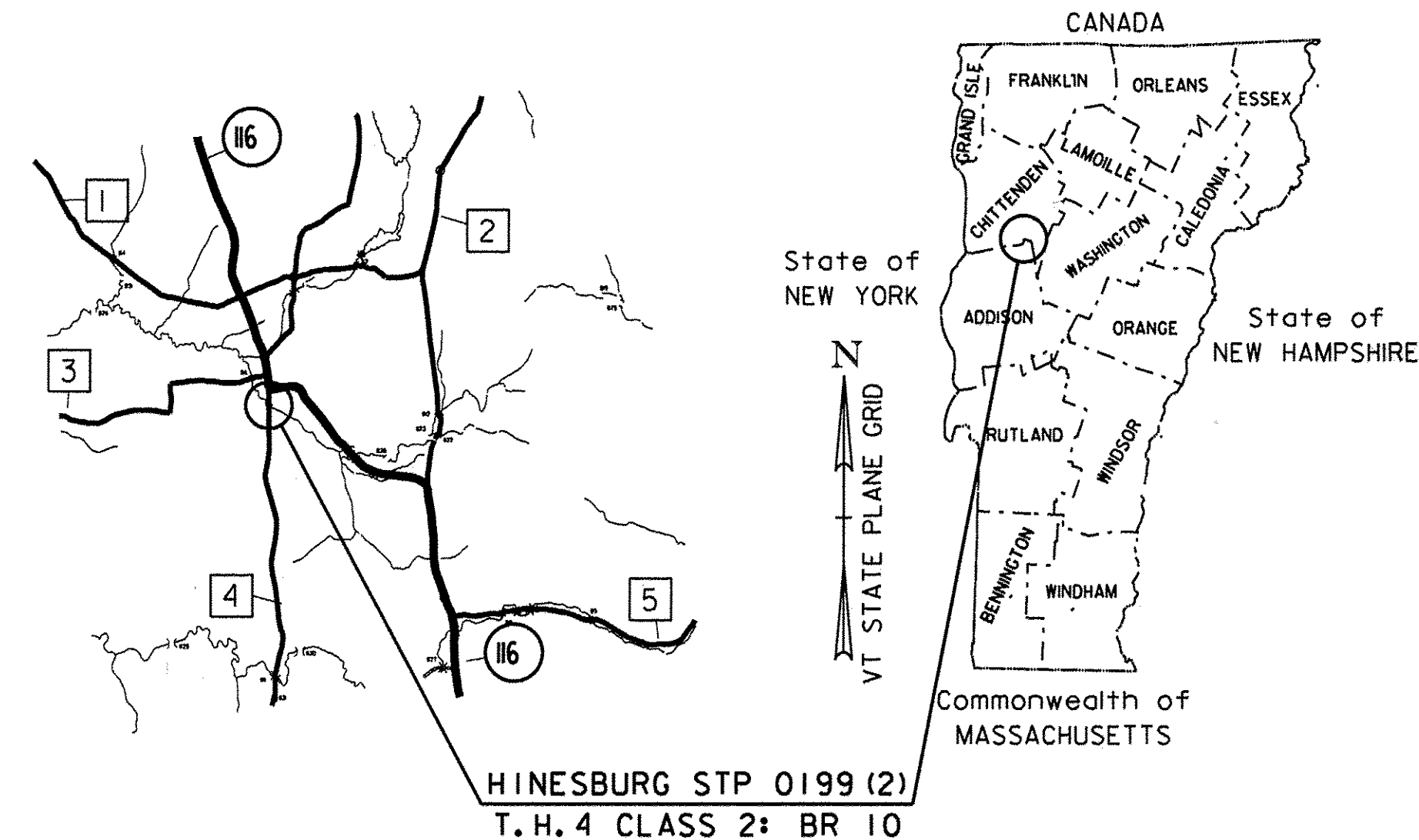

## PROPOSED IMPROVEMENT BRIDGE PROJECT TOWN OF HINESBURG COUNTY OF CHITTENDEN



RECORD PLANS	
CONTRACTOR:	A.L. ST. ONGE CONTRACTOR INC. - MONTGOMERY, VT
RESIDENT ENGINEER:	VICK DWIRE
CONSTRUCTION BEGAN:	MAY 26, 2011
CONSTRUCTION COMPLETE:	SEPTEMBER 19, 2012
RECORD PLANS BY:	VICK DWIRE & STEPHEN KENT
I HEREBY CERTIFY THAT ALL THE CONSTRUCTION REQUIRED BY THIS SET OF DRAWINGS HAS BEEN ACCOMPLISHED AS INDICATED HEREIN.	
BY <i>Vick Dwire</i>	RESIDENT ENGINEER
DATE <u>1-9-2014</u>	
NOTE: Any further information concerning final quantities, amounts or other details relative to this project may be found at Central Files in the electronic archives.	

ROUTE NO: TOWN HIGHWAY 4 (MAJOR COLLECTOR), CLASS 2      BRIDGE NO: 10

**PROJECT LOCATION:** BEGINNING AT A POINT ON TH #4 (SILVER STREET) APPROXIMATELY 120 METERS SOUTHERLY OF THE INTERSECTION OF TH #4 AND VT 116 AND PROCEEDING APPROXIMATELY 70 METERS ALONG TH #4.

**PROJECT DESCRIPTION:** REPLACEMENT OF THE EXISTING BRIDGE WITH A NEW BRIDGE ON THE EXISTING ALIGNMENT WITH NECESSARY ROADWAY AND CHANNEL WORK.

LENGTH OF NEW STRUCTURE: 18.800 METERS  
LENGTH OF ROADWAY: 47.450 METERS  
LENGTH OF PROJECT: 66.250 METERS

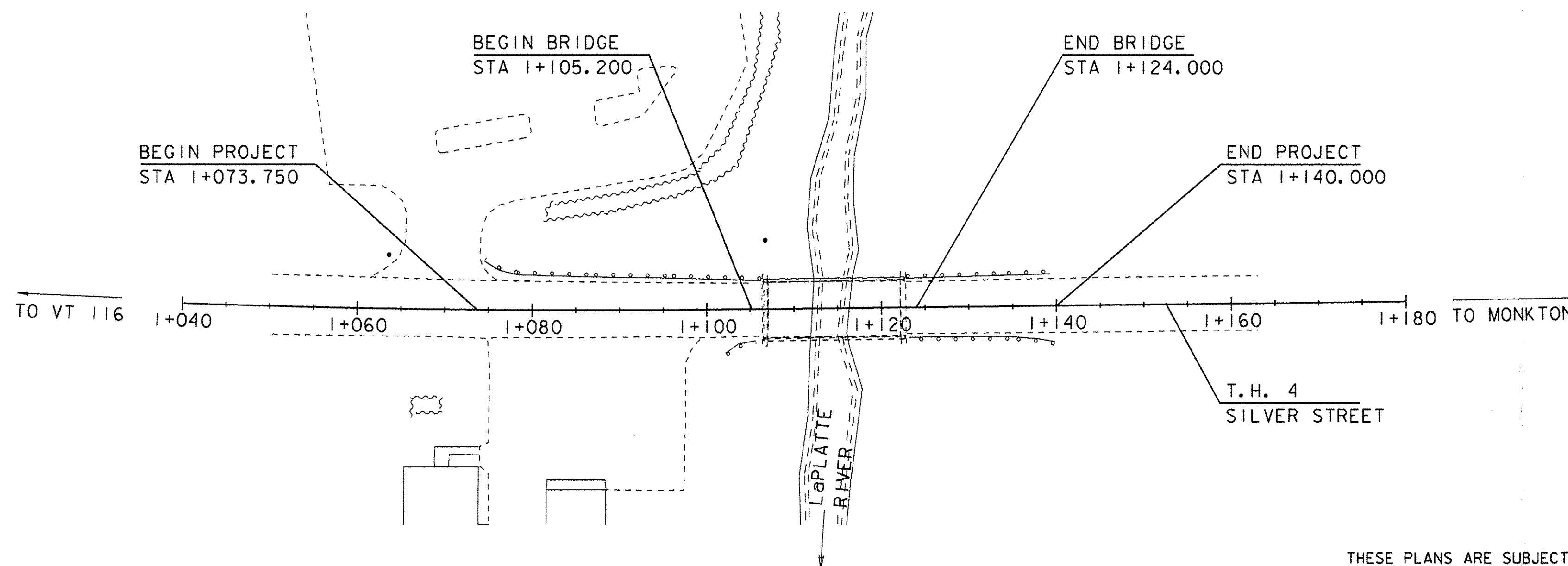
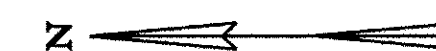

QUALITY ASSURANCE PROGRAM: LEVEL 2

### CONVENTIONAL SYMBOLS

COUNTY LINE	
TOWN LINE	
LIMITS OF ACCESS	
POINT OF ACCESS	
FENCE LINE	
STONE WALL	
TRAVELED WAY	
GUARD RAIL	
RAILROAD	
SURVEY LINE	
CULVERT	
POWER POLE	
TELEPHONE POLE	
TREES	
CONTROL OF ACCESS	
PROPERTY LINE	
R.O.W. TAKING LINE	
SLOPE RIGHTS	
TOP OF CUT	
TOE OF SLOPE	

SURVEYED BY : R.D. GILMAN  
SURVEYED DATE : 9-17-97

DATUM  
VERTICAL ASSUMED  
HORIZONTAL NAD-83

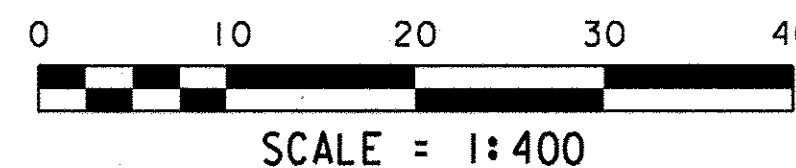

THESE PLANS ARE SUBJECT TO SUCH ENGINEERING CHANGES AS MAY BE REQUIRED BY THE FEDERAL HIGHWAY ADMINISTRATION OR THE DIRECTOR OF PROGRAM DEVELOPMENT.

CONSTRUCTION IS TO BE CARRIED ON IN ACCORDANCE WITH THESE PLANS AND THE STANDARD SPECIFICATIONS FOR CONSTRUCTION DATED 2006, AS APPROVED BY THE FEDERAL HIGHWAY ADMINISTRATION ON JUNE 15, 2006 FOR USE ON THIS PROJECT, INCLUDING ALL SUBSEQUENT REVISIONS AND SUCH REVISED SPECIFICATIONS AND SPECIAL PROVISIONS AS ARE INCORPORATED IN THESE PLANS.

## Metric

UNLESS NOTED OTHERWISE  
STATIONS ARE IN KILOMETERS  
ELEVATIONS ARE IN METERS  
DIMENSIONS ARE IN MILLIMETERS

DIRECTOR OF PROGRAM DEVELOPMENT

APPROVED *[Signature]* DATE 3/6/11

PROJECT MANAGER : C. CARLSON

PROJECT NAME : HINESBURG

PROJECT NUMBER : STP 0199 (2)

SHEET 1 OF 56 SHEETS