

DRAINAGE KEY

①	5+00 - 5+66 LT NEW 6" X 62' UNDERDRAIN W/ F.B. @ INLET	⑤	7+05 - 8+02 RT REMOVE EXISTING 18" CGMP REMOVE DROP INLET AT 8+02 RT
②	4+75 LT - 5+74 LT NEW PAVED GUTTER	⑥	8+04-8+60 RT EXISTING 15" CGMP - DO NOT DISTURB
③	7+34 - 8+02 RT NEW 18" X 68' OPTION PIPE NEW 4' X 4' PRECAST DI W/ TYPE "D" GRATE @ INLET	⑦	7+12 - 7+34 RT NEW 18" X 20' OPTION PIPE NEW 4' X 4' PRECAST DI W/TYPE "D" GRATE @ INLET
④	5+66 - 6+04 LT NEW 18" X 40' OPTION PIPE NEW 4' X 4' PRECAST DI W/ TYPE "D" GRATE @ INLET		
④ NOTE-OUTLET END CAST THRU WING WALL *I			

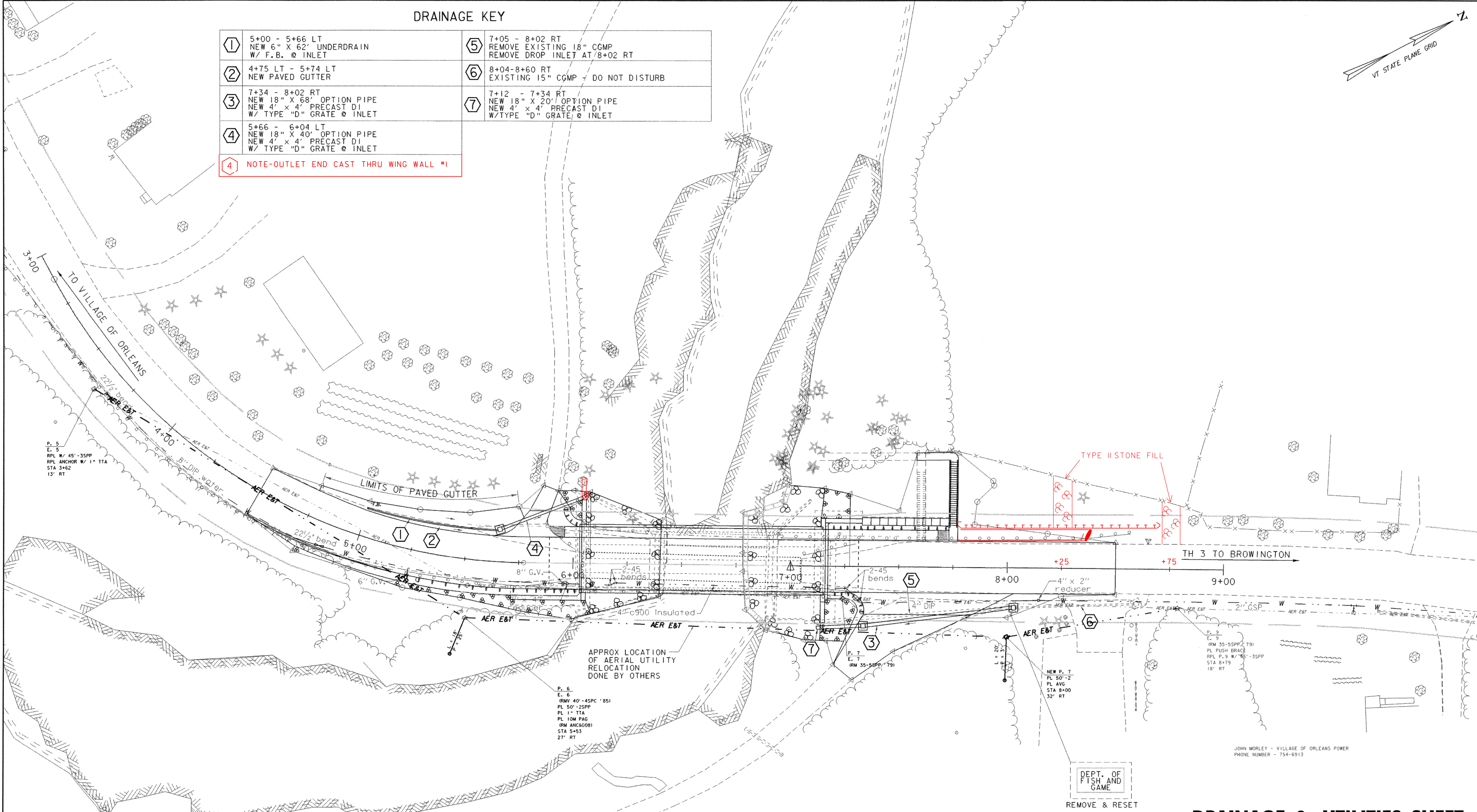
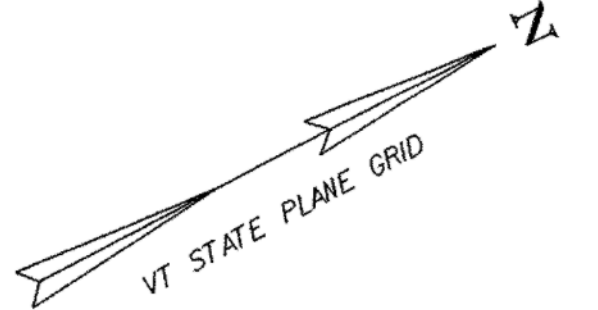

APPROX LOCATION  
OF AERIAL UTILITY  
RELOCATION  
DONE BY OTHERS

DEPT. OF  
FISH AND  
GAME  
REMOVE & RESET

JOHN MORLEY - VILLAGE OF ORLEANS POWER  
PHONE NUMBER - 754-5513

**DRAINAGE & UTILITIES SHEET**

PROJECT NAME:	BARTON	PLOT DATE:	02-APR-2007
PROJECT NUMBER:	BRO 1449(29)	DRAWN BY:	W. SYMONDS
FILE NAME:	/str5/01j168/sj168bdr.dgn	CHECKED BY:	T. SUMNER
PROJECT LEADER:	W. SYMONDS	SHEET	17 OF 84
DESIGNED BY:	W. SYMONDS		

