

DRAINAGE KEY

① 5+00 - 5+66 LT NEW 6" X 62' UNDERDRAIN W/ F.B. @ INLET	⑤ 7+05 - 8+02 RT REMOVE EXISTING 18" CGMP REMOVE DROP INLET AT 8+02 RT
② 4+75 LT - 5+74 LT NEW PAVED GUTTER	⑥ 8+04-8+60 RT EXISTING 15" CGMP - DO NOT DISTURB
③ 7+34 - 8+02 RT NEW 18" X 68' OPTION PIPE NEW 4' X 4' PRECAST DI W/ TYPE "D" GRATE @ INLET	⑦ 7+12 - 7+34 RT NEW 18" X 20' OPTION PIPE NEW 4' X 4' PRECAST DI W/ TYPE "D" GRATE @ INLET
④ 5+66 - 6+04 LT NEW 18" X 40' OPTION PIPE NEW 4' X 4' PRECAST DI W/ TYPE "D" GRATE @ INLET	

CURVE #1 DATA
R = 249.10'
T = 146.63'
L = 265.05'
E = 39.95'
BANK = .060 MAX

SMITH, DAVID V.
& DEBORAH J.

BENCHMARK
RR SPIKE IN LEDGE
ELEV. 747.550

VILLAGE OF ORLEANS INC.

STATE OF VERMONT
FISH & WILDLIFE
DISPUTED PARCEL
STATE OF VERMONT
FISH & WILDLIFE
DISPUTED PARCEL
BLODGETT, DAVID
& NAULT, MILDRED

CONSTRUCT CAST IN-PLACE STAIRS
(CONCRETE) HIGH PERFORMANCE CLASS B
STA. 7+75 LT

METAL HAND RAILING
STA. 7+73.5 (18.4 LT. TO 49.4 LT.)
STA. 7+76.5 (18.4 LT. TO 49.4 LT.)

BRIDGE RAILING, TEXAS
STA. 6+03.0 - 7+14.58 LT.
STA. 6+03.0 - 7+15.33 RT.

HD STEEL BEAM GUARDRAIL, GALVANIZED
STA. 5+31 - 6+04 RT.
STA. 5+97 - 6+04 LT
STA. 7+13.6 - 7+72 LT.
STA. 7+14.3 - 7+34.0 RT.

REMOVAL AND DISPOSAL OF GUARDRAIL
STA. 5+24 - 5+97 RT.
STA. 5+78 - 6+35 RT.
STA. 5+94 - 6+01 LT.
STA. 6+01 - 6+35 LT.
STA. 6+95 - 7+31 RT.
STA. 7+06 - 7+31 RT.
STA. 7+06 - 7+30 LT.
STA. 6+97 - 8+57 LT.

ANCHOR FOR STEEL BEAM RAIL
PARCEL #1 & #2 ARE DISPUTED PARCELS
STATE OF VERMONT FISH & WILDLIFE
BLODGETT, DAVID & NAULT, MILDRED
VILLAGE OF ORLEANS INC.
REMOVAL OF MEDIUM TREES

(INCIDENTAL TO CLEARING AND GRUBBING)
STA. 5+83 LT.
REMOVING SIGNS
STA. 8+02 RT.
ERECTING SALVAGED SIGNS
STA. 8+02 RT.
CONSTRUCT DRIVE
STA. 5+82 LT. 8.5' GRAVEL
STA. 7+60 RT. 11' GRAVEL

SUBBASE FOR DRIVES SHALL BE ITEM 301.26
SUBBASE OF CRUSHED GRAVEL, FINE GRADED

REMOVE AND RESET GUARDRAIL
STA. 4+50 - 5+19 RT.

COLD PLANING
BITUMINOUS PAVEMENT
STA. 4+50 - 5+00
STA. 8+00 - 8+50

PRECAST CONCRETE GRAVITY RETAINING WALL
STA. 7+25 - 7+73 LT.

STONE FILL TYPE II
STA. 4+75 - 6+08.5 RT.
STA. 5+29.9 - 6+08.5 LT.
STA. 7+14 - 7+27.2 RT.
STA. 7+14 - 7+31 LT.

REMOVAL OF EXISTING WOODEN STAIRS
STA. 7+60 LT.

4 INCH YELLOW LINE
STA. 4+50 - 8+50 LT.
STA. 4+50 - 8+50 RT.

4 INCH WHITE LINE
STA. 4+50 - 8+50 LT.
STA. 4+50 - 8+50 RT.

BLODGETT, DAVID & NAULT, MILDRED
PORTLAND CEMENT CONCRETE SIDEWALK, 5 INCH

END R.O.W. PROJECT
BRO 1449(29)
STA. 8+82.47
32.12' RT

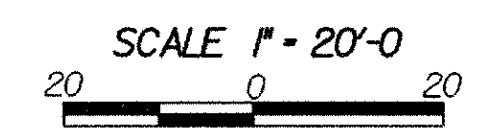
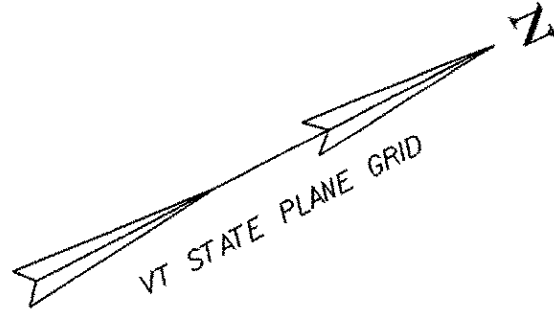
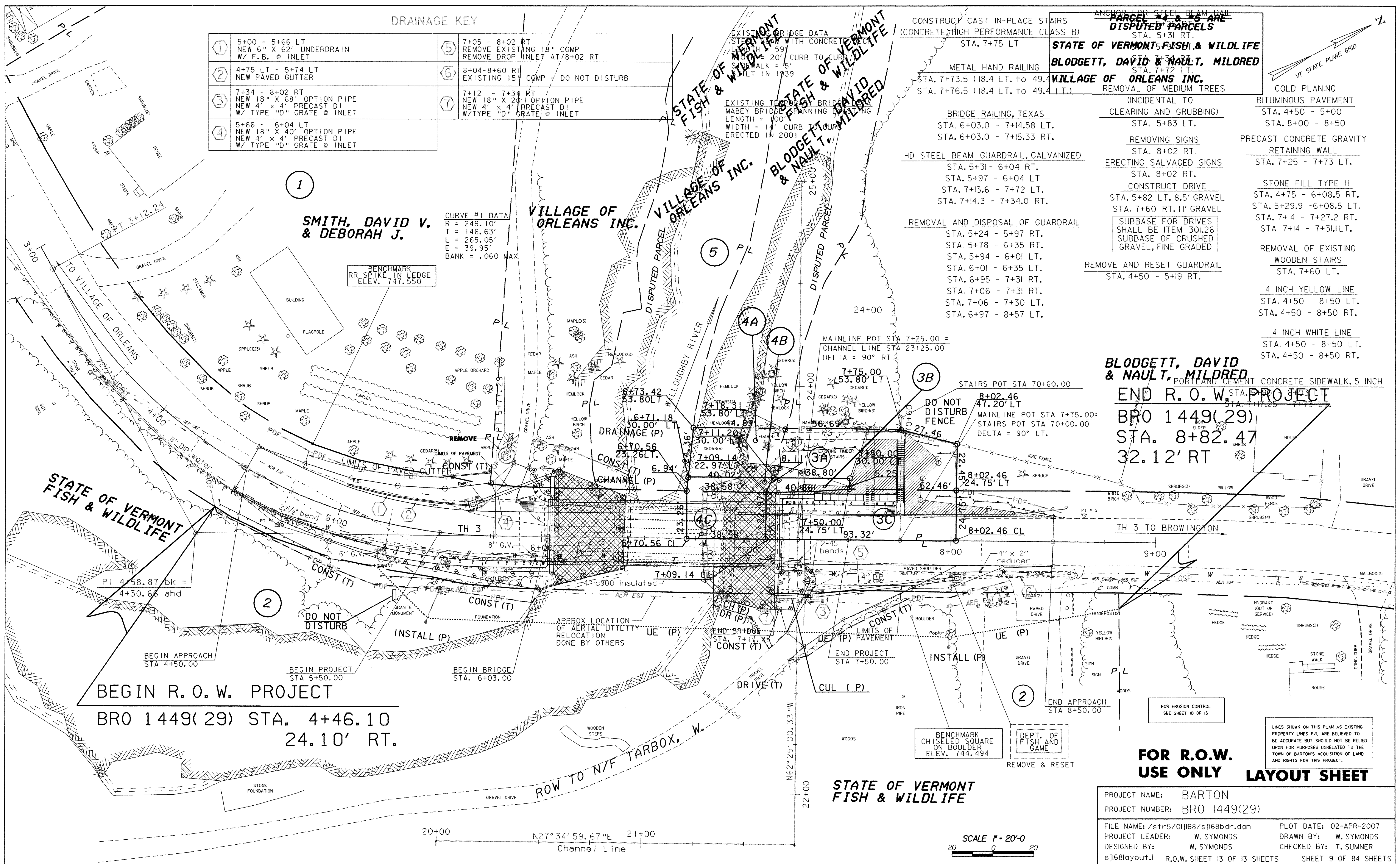

FOR R.O.W. USE ONLY LAYOUT SHEET

PROJECT NAME: BARTON	PROJECT NUMBER: BRO 1449(29)
FILE NAME: /str5/01j168/sj168bdr.dgn	PLOT DATE: 02-APR-2007
PROJECT LEADER: W. SYMONDS	DRAWN BY: W. SYMONDS
DESIGNED BY: W. SYMONDS	CHECKED BY: T. SUMNER
sj168layout.l R.O.W. SHEET 13 OF 13 SHEETS SHEET 9 OF 84 SHEETS	

LINES SHOWN ON THIS PLAN AS EXISTING PROPERTY LINES P/L ARE BELIEVED TO BE ACCURATE BUT SHOULD NOT BE RELIED UPON FOR PURPOSES UNRELATED TO THE TOWN OF BARTON'S ACQUISITION OF LAND AND RIGHTS FOR THIS PROJECT.

FOR EROSION CONTROL SEE SHEET 10 OF 13

BENCHMARK CHISELED SQUARE ON BOULDER ELEV. 744.494

DEPT. OF FISH AND GAME REMOVE & RESET

STATE OF VERMONT FISH & WILDLIFE

BEGIN R.O.W. PROJECT
BRO 1449(29) STA. 4+46.10
24.10' RT.

Channel Line
N27°34'59.67"E 21+00