

INDEX OF SHEETS

- 15 TITLE SHEET
- 16 STP 2031 (11) - PLAN - AIRPORT ROAD
- 17 STP 2031 (11) - TRAFFIC SIGN SUMMARY SHEET

STANDARDS

STANDARDS	DATE
E-100 CONSTRUCTION APPROACH SIGNS	JAN. 02, 2004
E-101 CONSTRUCTION SIGN DETAILS	MAY 30, 2003
E-102 CONSTRUCTION SIGN DETAILS	JUN. 30, 2003
E-102A CONSTRUCTION SIGN DETAILS	MAY 01, 2004
E-106 TRAFFIC CONTROL - MISCELLANEOUS DETAILS	MAR. 01, 2004
E-107 DELINEATION, BARRICADES AND DETOURS FOR U-TURNS ON HIGHWAY	JUN. 30, 2003
E-107A BREAKAWAY BARRICADE DETAILS	AUG. 08, 1995
E-110 MAJOR MAINTENANCE OPERATION LANE CLOSURE	AUG. 08, 1995
E-111 MINOR MAINTENANCE OPERATION	MAR. 11, 1997
E-121 STANDARD SIGN PLACEMENT - CONVENTIONAL ROAD	AUG. 08, 1995
E-132 GENERAL MOTORIST SERVICE SIGN DETAILS	AUG. 18, 1995
E-152 WARNING SIGNS DETAILS	MAY 01, 2004
E-160 FLANGED CHANNEL STEEL SIGN POST	MAY 20, 1999
E-175 POWER DROP STANCHIONS	NOV. 17, 1993
E-190 RAILROAD CROSSING SIGNS AND PAVEMENT MARKINGS	JUN. 30, 2003

STATE OF VERMONT AGENCY OF TRANSPORTATION



PROPOSED IMPROVEMENT COUNTY OF BENNINGTON TOWN OF SHAFTSBURY TH 7, CL. 2 (9-LOCAL ROAD)

SHAFTSBURY; STP 2031 (11); PPMS 01G162
VERMONT RAILWAY CROSSING 851-173N - AIRPORT ROAD
WORK TO BE PERFORMED UNDER THIS PROJECT WILL INCLUDE THE
CONSTRUCTION OF A NEW RR CROSSING SIGNAL SYSTEM INCLUDING NEW
ELECTRICAL SERVICE, SIGNALS, PAVEMENT MARKINGS, AND SIGNAGE.

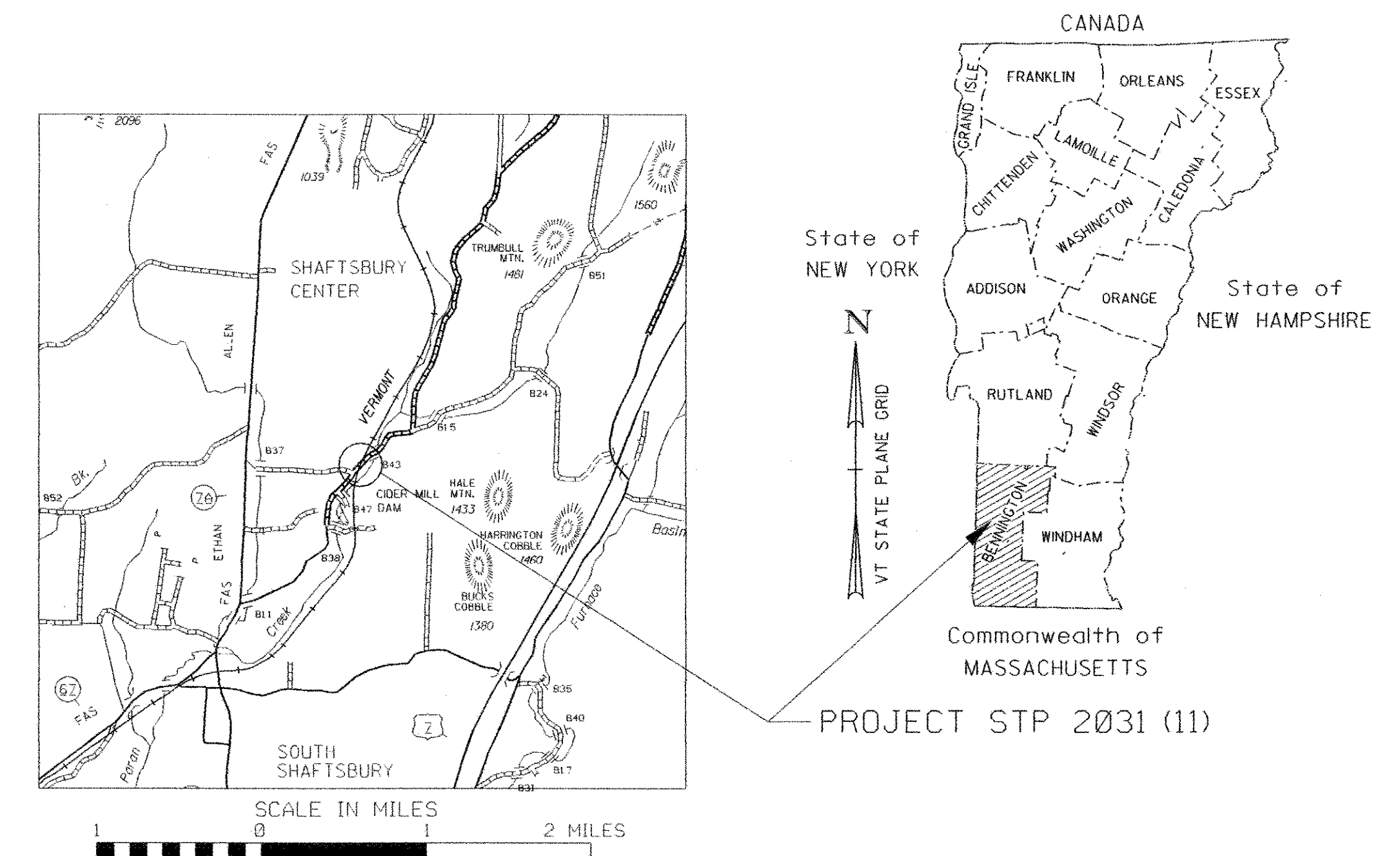

TRAFFIC DATA

- RAILROAD: V=25MPH (PASSENGER OPERATING SPEED)
- V=30MPH (FREIGHT OPERATING SPEED)
- V=59MPH (PASSENGER DESIGN SPEED)
- V=40MPH (FREIGHT DESIGN SPEED)
- APRIL 2006
- HIGHWAY: V=35MPH
- ADT=350 (1999 ESTIMATED)

GENERAL NOTES

- ALL WORK IS TO BE PERFORMED WITHIN THE RAILROAD AND HIGHWAY RIGHT-OF-WAY

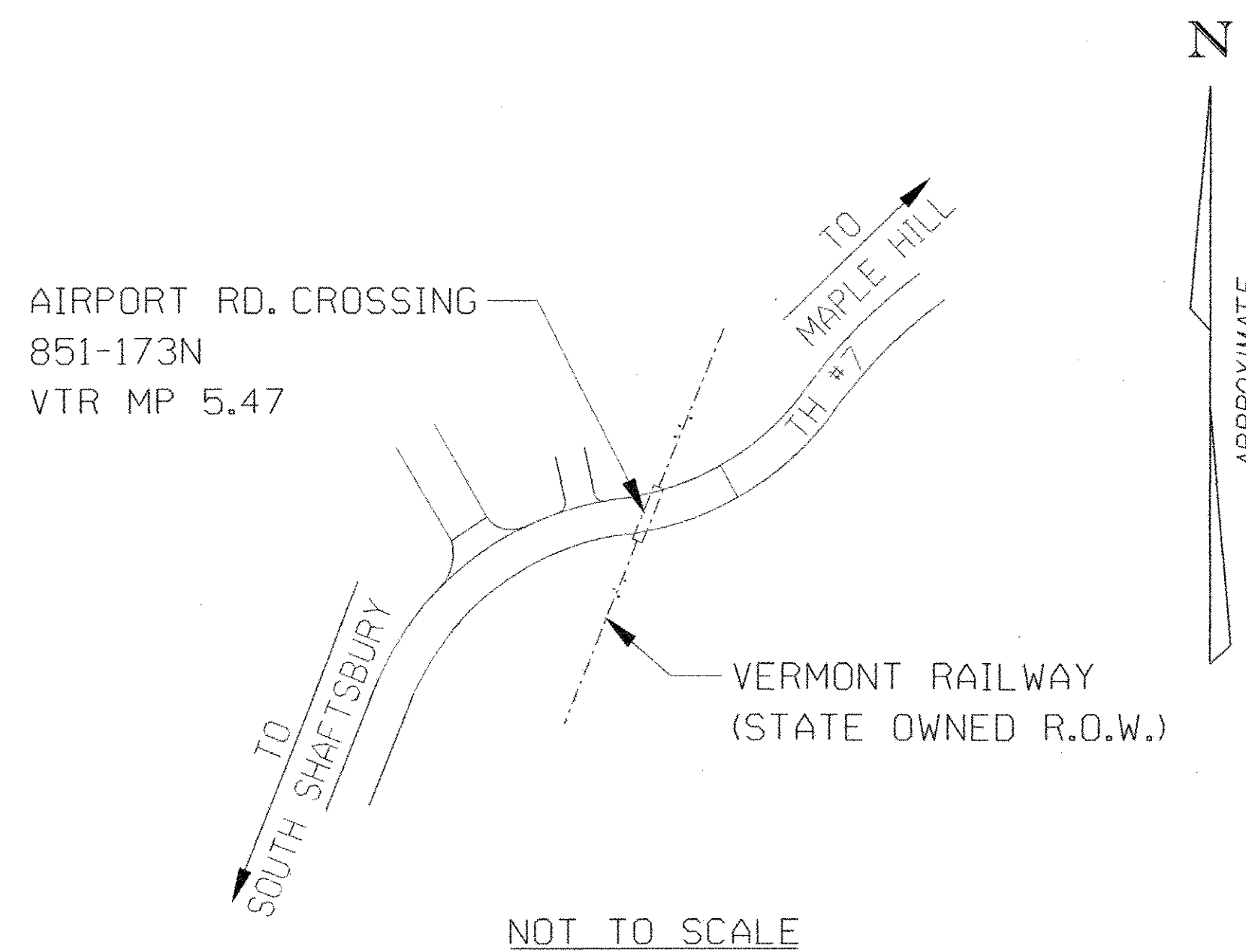

CONVENTIONAL SYMBOLS

COUNTY LINE	
TOWN LINE	
LIMITS OF ACCESS	
POINT OF ACCESS	
FENCE LINE	
STONE WALL	
TRAVELED WAY	
GUARD RAIL	
RAILROAD	
SURVEY LINE	
CULVERT	
POWER POLE	
TELEPHONE POLE	
TREES	
CONTROL OF ACCESS	
PROPERTY LINE	
R.O.W. TAKING LINE	
SLOPE RIGHTS	
TOP OF CUT	
TOE OF SLOPE	

SURVEYED BY : N/A
SURVEYED DATE : N/A

DATUM
VERTICAL N/A
HORIZONTAL N/A

TransSystems Corporation
ONE CABOT ROAD, MEDFORD MA 02155 (781) 396-7775

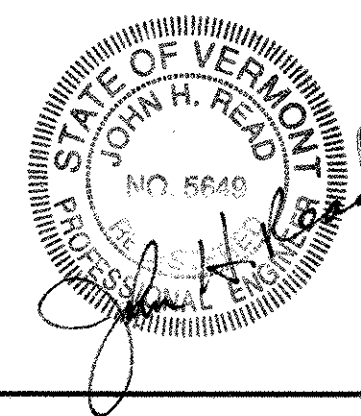

THESE PLANS ARE SUBJECT TO SUCH ENGINEERING CHANGES AS MAY BE REQUIRED BY THE FEDERAL HIGHWAY ADMINISTRATION OR THE DIRECTOR OF PROGRAM DEVELOPMENT.

CONSTRUCTION IS TO BE CARRIED ON IN ACCORDANCE WITH THESE PLANS AND THE STANDARD SPECIFICATIONS FOR CONSTRUCTION DATED 2001, AS APPROVED BY THE FEDERAL HIGHWAY ADMINISTRATION ON JANUARY 4, 2001 FOR USE ON THIS PROJECT, INCLUDING ALL SUBSEQUENT REVISIONS AND SUCH REVISED SPECIFICATIONS AND SPECIAL PROVISIONS AS ARE INCORPORATED IN THESE PLANS.

PROJECT MANAGER : JENNIFER ROYER

PROJECT NAME : SHAFTSBURY
PROJECT NUMBER : STP 2031 (11) TH #7

SHEET 15 OF 21 SHEETS