

DURABLE 24 INCH STOP BAR
 STA. 1+20.41 LT
DURABLE LETTER OR SYMBOL
 STA. 2+05.27, 48.59 LT (HANDICAP)
 STA. 2+23.27, 48.58 LT (HANDICAP)
 STA. 2+36.27, 48.57 LT (HANDICAP)
 STA. 1+26.41, LT (STOP)

DURABLE 4 INCH YELLOW LINE (DOUBLE CENTERLINE)
 STA. 1+20.41 TO STA. 1+68.26

DURABLE 4 INCH WHITE LINE
 PARKING SPOT LINES
 HANDICAP HATCHING
 END PARK AND RIDE LOT HATCHING
 THESE END LINES WERE NOT INSTALLED THE HATCHING WAS INSTALLED

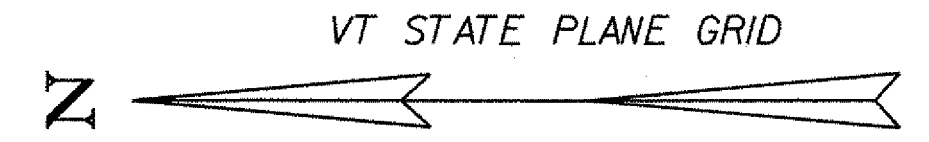
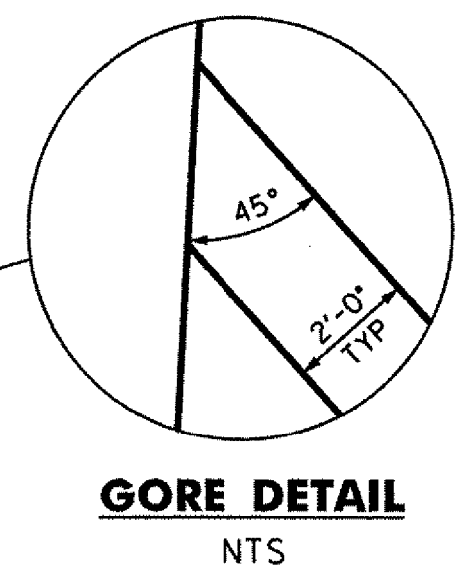
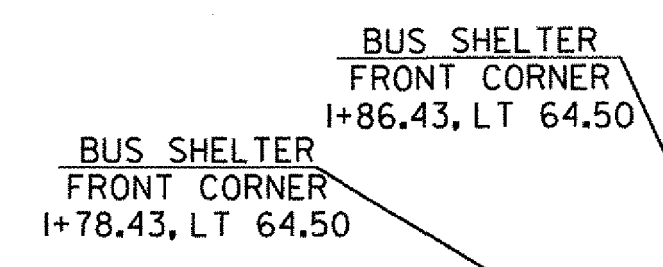
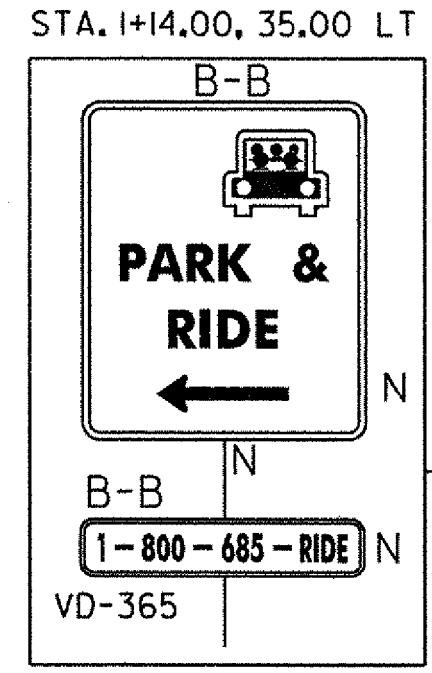

EXISTING *TENNEY FARM* 36" MAPLE TREE TO REMAIN UNDISTURBED
 NO EXCAVATION THAT WILL DAMAGE TREE ROOT SYSTEM

EXISTING TREES TO REMAIN UNDISTURBED
 NO EXCAVATION THAT WILL DAMAGE TREE ROOT SYSTEM

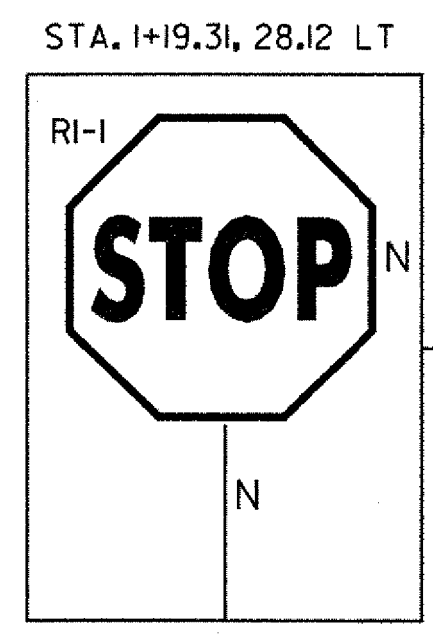

DURABLE 24 INCH STOP BAR

DURABLE LETTER (STOP)

STA. 4+99.50 END PROJECT WEATHERSFIELD CMG PARK 17(S)

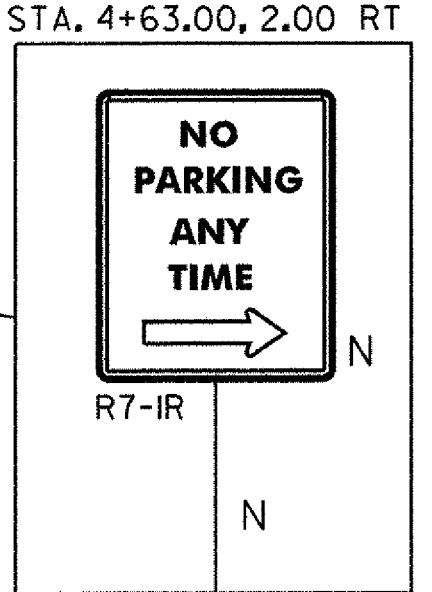

STA. 1+14.12 BEGIN PROJECT WEATHERSFIELD CMG PARK 17(S)

DURABLE 4 INCH YELLOW LINE (DOUBLE CENTERLINE)

EXISTING GATE
 EXISTING GRAVEL DRIVE

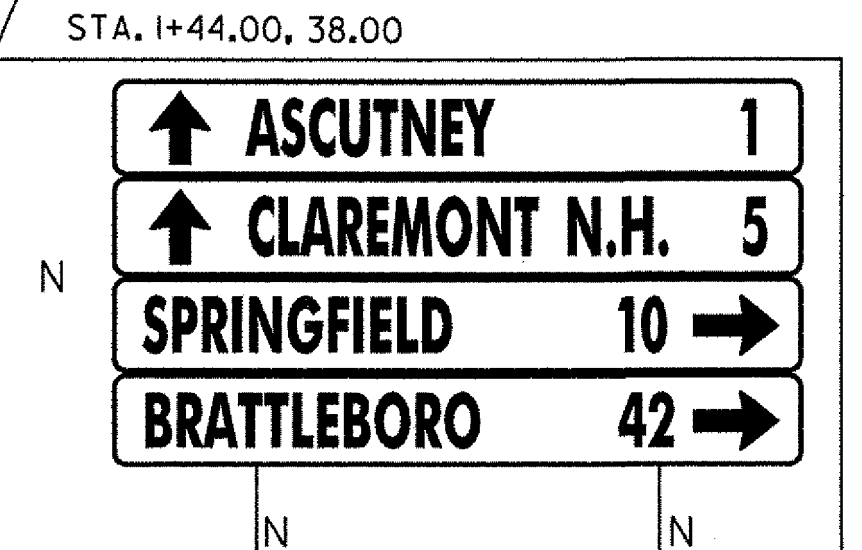
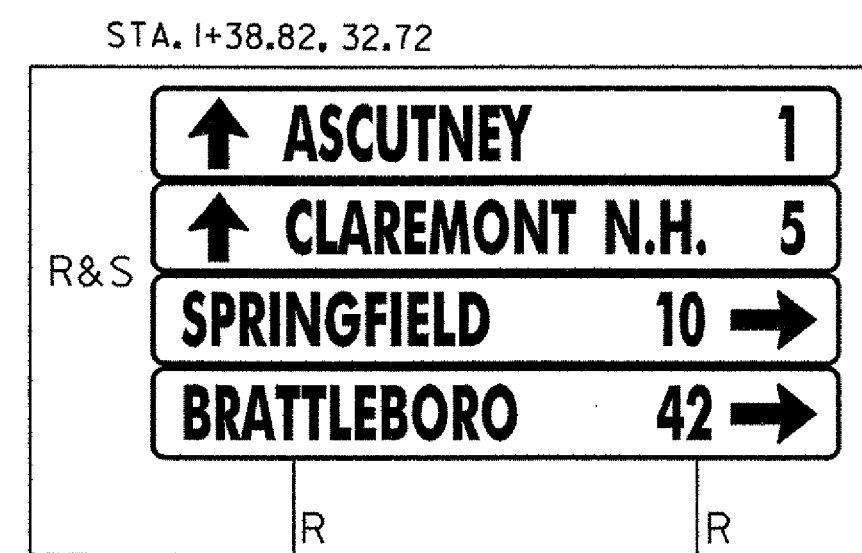
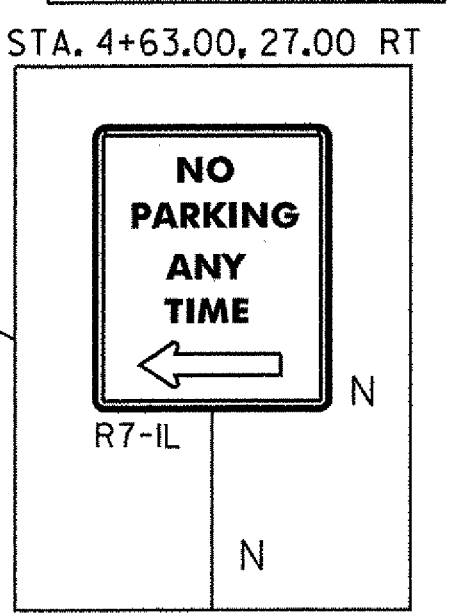

LEGEND

EDGE OF TRAVEL WAY	---
TREE LINE	~ ~ ~
LEDGE LINE	///
FENCE LINE	x-x-x
ROW LINE	- - -
STONE WALL	o-o-o-o
OVERHEAD POWER LINE	AER E&T
TREES	⊗
POWER POLE	⊙
GUY WIRE	○
CONTROL POINTS	△
TIES	•
SIGN POSTS	⊕

EXISTING TREE TO REMAIN UNDISTURBED
 NO EXCAVATION THAT WILL DAMAGE TREE ROOT SYSTEM

NOTE:
 1. ALL SIGNS AND POSTS WILL BE NEW UNLESS OTHERWISE NOTED.
 2. REMOVE AND SALVAGE PARK AND RIDE SIGNS AT STA. 1+20.36, 35.39 LT PRIOR TO START OF CONSTRUCTION.

SIGN LEGEND

N	= INSTALL NEW
R	= REMOVE EXISTING
R&S	= REMOVE & SALVAGE
S	= USE SALVAGED
RET	= RETAIN EXISTING
B-B	= BACK TO BACK

PAVEMENT MARKING AND SIGNS SHEET

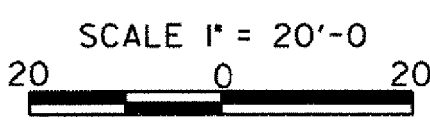

Hoyle, Tanner & Associates, Inc.

PROJECT NAME: WEATHERSFIELD
 PROJECT NUMBER: CMG PARK(17)S

FILE NAME: z99k014sht_lay.dgn
 PROJECT LEADER: Wayne L. Davis
 DESIGNED BY: AGB
 PAVEMENT MARKING & SIGNS SHEET

PLOT DATE: 8/20/2008
 DRAWN BY: AGB
 CHECKED BY: SJG
 SHEET 14 OF 36