

- LEGEND**
- ERW = END ROAD WORK
  - RW500 = ROAD WORK 500 FT
  - RWA = ROAD WORK AHEAD
  - RWN = ROAD WORK NEXT XX MILES
  - SRW500 = SIDE ROAD WORK 500 FT
  - SRWA = SIDE ROAD WORK AHEAD
  - CLOSED = PARK & RIDE CLOSED

LOCATION	ERW	RW500	RWA	RWN	SRW500	SRWA	CLOSED
<b>VT ROUTE 131</b>							
EAST OF SITE	1				2	2	
WEST OF SITE	1				2	2	
<b>I-91 SB OFF RAMP</b>							
							2
<b>PARK AND RIDE</b>							
							1
TOTALS	2				4	6	1

I-91 SB ON RAMP      1  
 TOTAL                      3

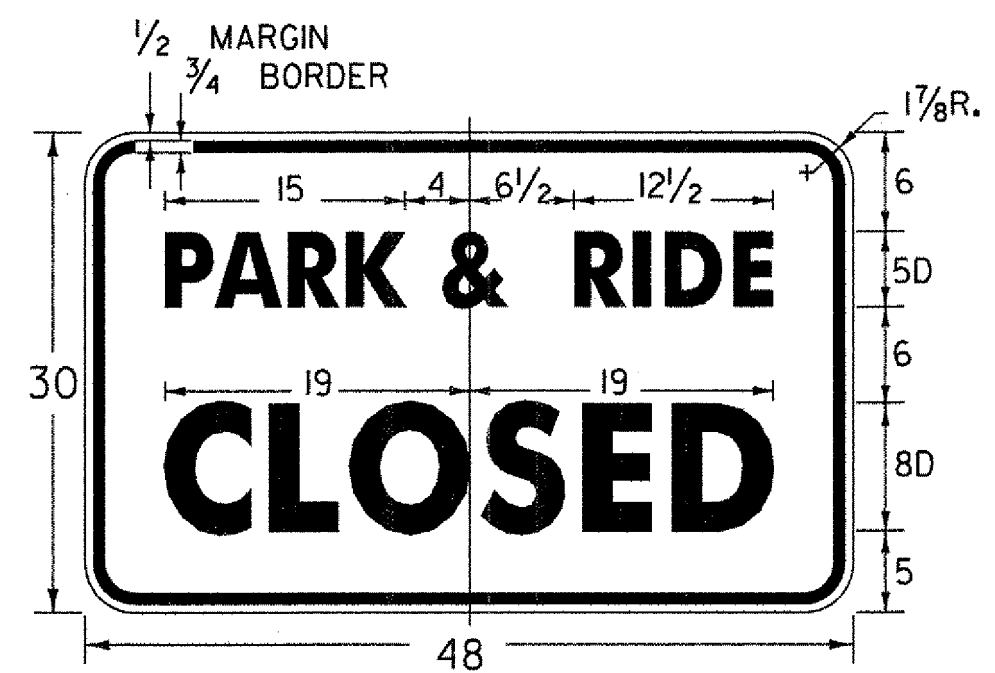
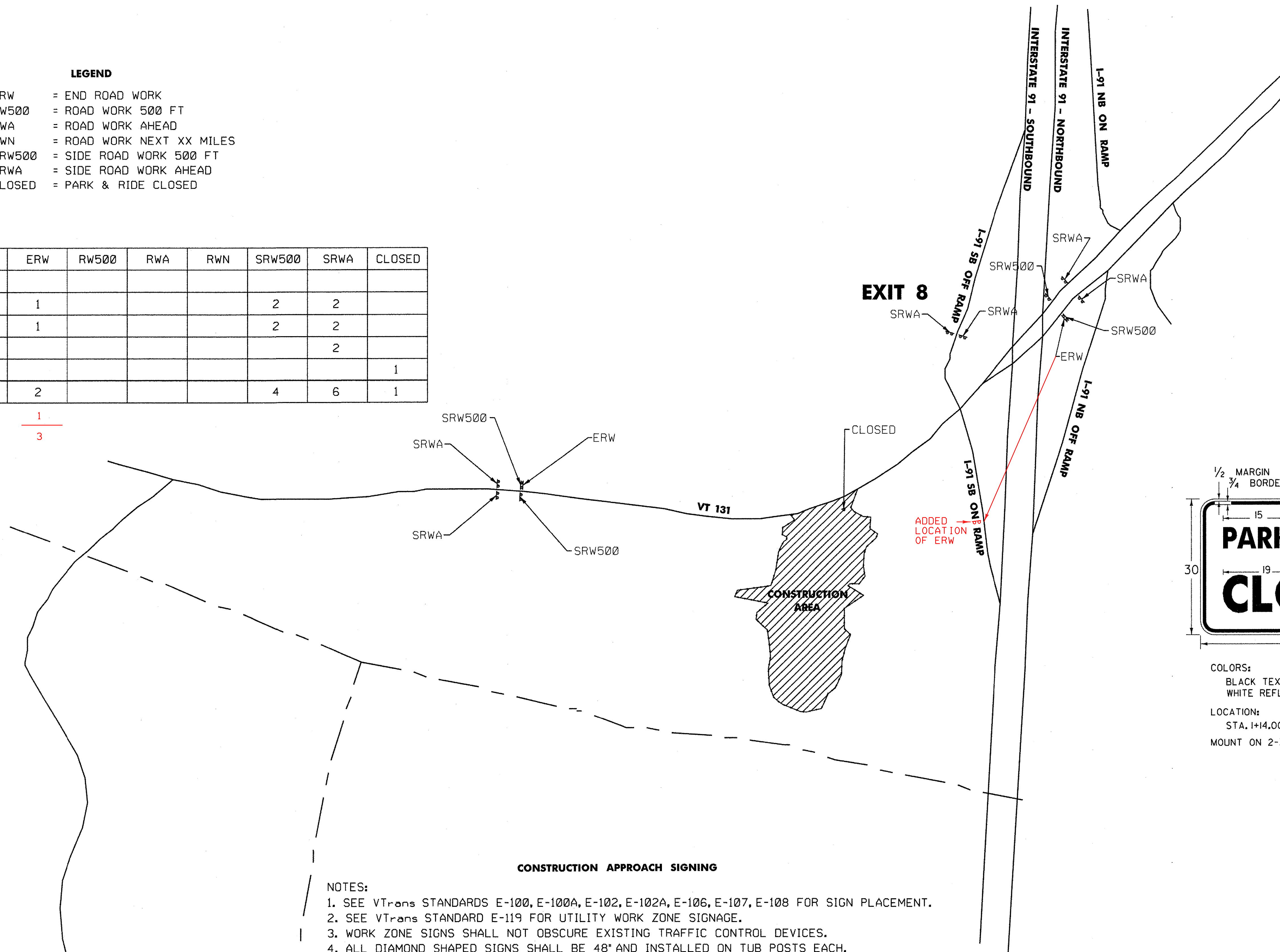

**COLORS:**  
 BLACK TEXT AND BORDER  
 WHITE REFLECTORIZED BACKGROUND

**LOCATION:**  
 STA. 1+14.00, 35.00 LT  
 MOUNT ON 2-3LB/FT FLANGED CHANNEL POSTS

**CONSTRUCTION APPROACH SIGNING**

- NOTES:**
1. SEE VTrans STANDARDS E-100, E-100A, E-102, E-102A, E-106, E-107, E-108 FOR SIGN PLACEMENT.
  2. SEE VTrans STANDARD E-119 FOR UTILITY WORK ZONE SIGNAGE.
  3. WORK ZONE SIGNS SHALL NOT OBSCURE EXISTING TRAFFIC CONTROL DEVICES.
  4. ALL DIAMOND SHAPED SIGNS SHALL BE 48" AND INSTALLED ON TUB POSTS EACH.
  5. ALL CONSTRUCTION SIGNS SHALL BE NEW OR IN LIKE-NEW CONDITON.
  6. SEE VTrans STANDARDS FOR SIGN SHEETING REQUIREMENTS.
  7. NO CONSTRUCTION SIGNS SHALL BE INSTALLED IN SUCH A WAY AS TO INTERFERE OR OBSTRUCT THE VIEW OF EXISTING TRAFFIC CONTROL DEVICES, STOPPING SIGHT DISTANCE AND CORNER SIGHT DISTANCE FROM EXISTING DRIVES AND HIGHWAYS.
  8. PAYMENT FOR TEMPORARY CONSTRUCTION SIGNING WILL BE INCLUDED IN THE UNIT PRICE BID FOR CONTRACT ITEM 641.10.
  9. PARK AND RIDE WILL BE CLOSED DURING CONSTRUCTION. SEE DETAIL THIS SHEET FOR APPROPRIATE SIGNAGE.
  10. ACCESS TO THE TENNEY EASEMENT MUST BE MAINTAINED DURING CONSTRUCTION.

**Hoyle, Tanner & Associates, Inc.**

HTA PROJECT	MODEL
904219	Construction Signs

PROJECT NAME: WEATHERSFIELD	PLOT DATE: 8/20/2008
PROJECT NUMBER: CMG PARK(17)S	DRAWN BY: AGB
FILE NAME: z99k014sht_lay.dgn	CHECKED BY: SJG
PROJECT LEADER: Wayne L. Davis	SHEET 13 OF 36
DESIGNED BY: AGB	

**CONSTRUCTION APPROACH SIGNING**