

REMOVING SIGNS AS SHOWN - 9
ERECTING SALVAGED SIGNS AS SHOWN - 7

SEE SIGN & PAVEMENT MARKING PLAN #2 FOR SIGNS AND MARKINGS IN PARK-AND-RIDE AREA

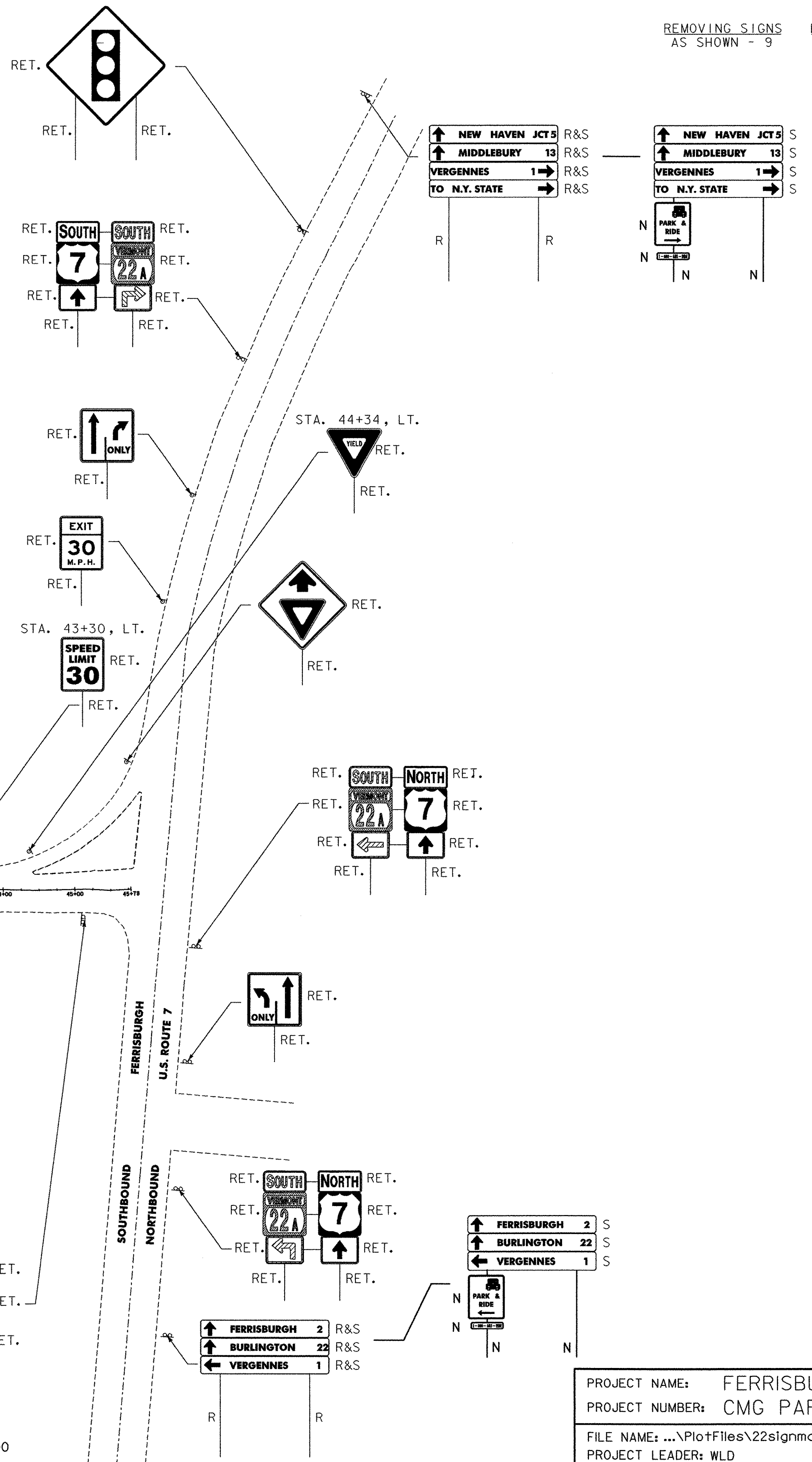
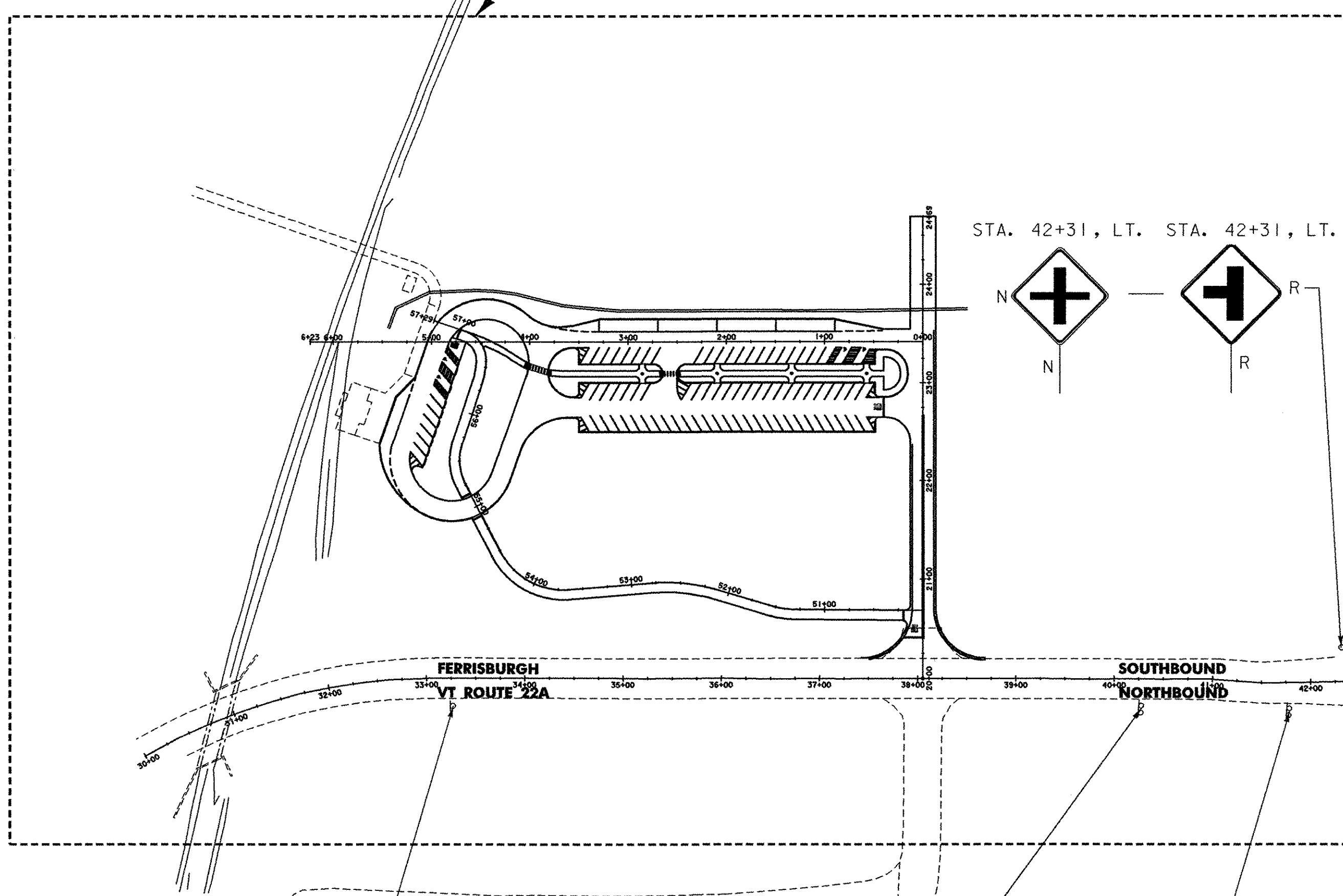

SIGN LEGEND
 N = NEW
 R = REMOVE
 R&S = REMOVE & SALVAGE
 S = SALVAGE SIGN
 RET = RETAIN
 B-B = BACK TO BACK

STA. 40+28, RT.
 RET. ← FERRISBURGH 2
 RET. ← BURLINGTON 22
 RET. ← NEW HAVEN JCT 5
 RET. ← MIDDLEBURY 13 →

STA. 41+78, RT.
 RET. [Traffic Light Sign]
 STA. 43+28, RT.
 RET. [Yield Sign]

STA. 45+13, RT.
 RET. NORTH SOUTH
 RET. [Route 7 Signs]

↑ FERRISBURGH 2 S
 ↑ BURLINGTON 22 S
 ← VERGENNES 1 S
 [Park & Ride Sign]

NOTES:
 1) SURVEY FOR U.S. ROUTE 7 NOT EXACT
 2) APPROXIMATE ALIGNMENT ADDED FOR VT ROUTE 22A
 3) ALL EXISTING SIGNS NOT SHOWN SHALL BE RETAINED AS DIRECTED BY THE RESIDENT ENGINEER
 4) FOR SIGNING AND PAVEMENT MARKING DETAILS, SEE DETAIL SHEET AND VTrans STANDARDS E-191, E-192, E-193, E-194.

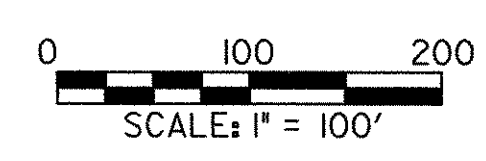

PROJECT NAME: FERRISBURGH/VERGS-FERRISBURGH
 PROJECT NUMBER: CMG PARK (15)S/STP EH01(21)
 FILE NAME: ...PlotFiles\22signmarkingl.prf PLOT DATE: 4/19/2006
 PROJECT LEADER: WLD DRAWN BY: MBL/SRZ
 DESIGNED BY: CSP/GGG CHECKED BY: GAS
SIGNS & PAVEMENT MARKINGS 1 SHEET 22 OF 65