

0+40.00 NORTH

ABUTMENT 1
CHANNEL STA 0+23 N
BEGIN STONE FILL TYPE IV
BEGIN UNCLASSIFIED CHANNEL EXCAVATION
BEGIN GRUBBING MATERIAL
BEGIN GEOTEXTILE UNDER STONE FILL

PIER
CHANNEL STA 0+20 N
BEGIN STONE FILL TYPE IV
BEGIN UNCLASSIFIED CHANNEL EXCAVATION
BEGIN GRUBBING MATERIAL
BEGIN GEOTEXTILE UNDER STONE FILL

ABUTMENT 2
CHANNEL STA 0+34 N
BEGIN STONE FILL TYPE IV
BEGIN UNCLASSIFIED CHANNEL EXCAVATION
BEGIN GRUBBING MATERIAL
BEGIN GEOTEXTILE UNDER STONE FILL

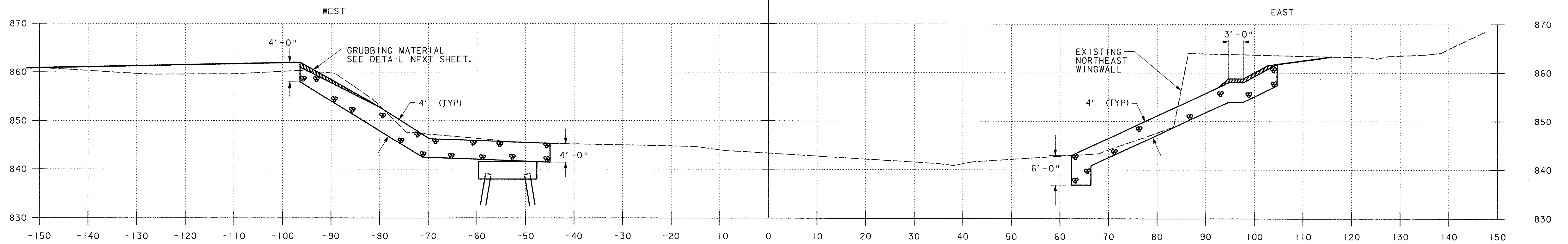

0+20.00 NORTH

REMOVAL OF STONE WINGWALLS PAID UNDER ITEM 203.15 "COMMON EXCAVATION" SEE SHEET 27.

REMOVE STONES AND GRANULAR MATERIAL FOR EXISTING ABUTMENT AND WINGWALLS AS NECESSARY TO THE BOTTOM OF STONE FILL. TO BE PAID AS ITEM 529.20 "PARTIAL REMOVAL OF STRUCTURE (MODIFIED, EXISTING ABUTMENTS)" SEE SHEET 27.

REMOVE STONES AND GRANULAR MATERIAL FOR EXISTING ABUTMENT AND WINGWALLS AS NECESSARY TO THE BOTTOM OF STONE FILL. TO BE PAID AS ITEM 529.20 "PARTIAL REMOVAL OF STRUCTURE (MODIFIED, EXISTING ABUTMENTS)" SEE SHEET 27.

"CRITTER CROSSING" (TYP) PREPARE A LEVEL AREA AND PLACE GRUBBING MATERIAL AT APPROXIMATE ELEVATION 858' FOR THE FULL LENGTH OF THE STONE FILL. THIS WORK SHALL BE CONSIDERED SUBSIDIARY TO ITEM 613.13 STONE FILL, TYPE IV.

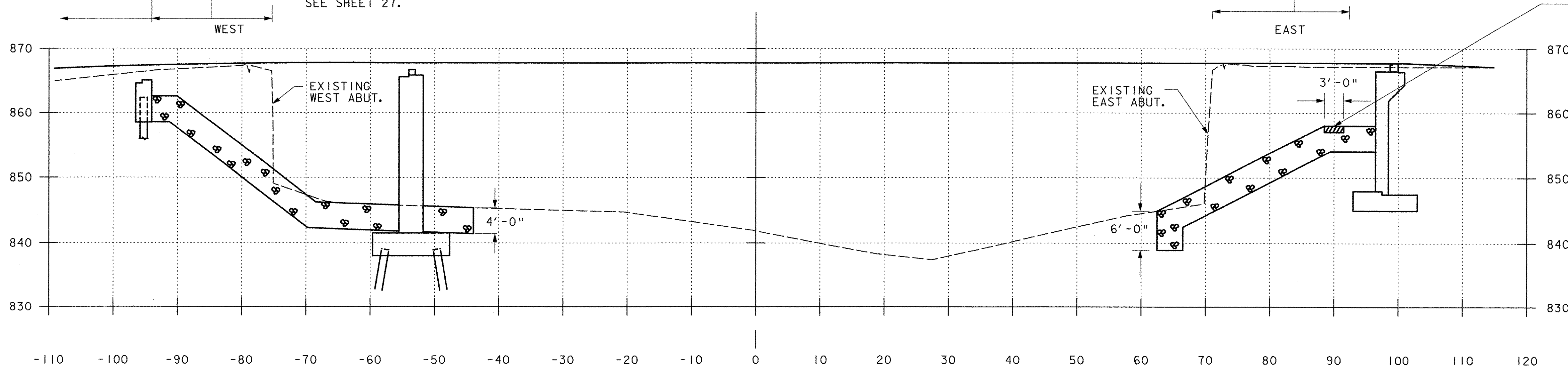

STATION 102+00
ALONG BASELINE



CHANNEL CROSS SECTIONS I

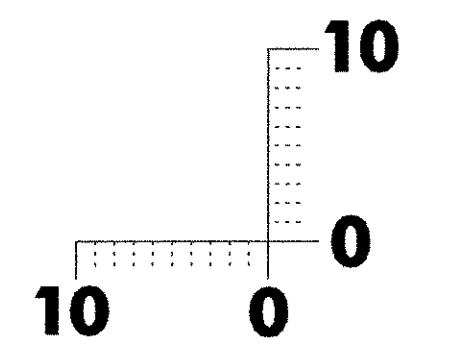

SCALE 1" = 10'

X-Section Sheet

CHANNEL CROSS SECTION I

PREPARED BY J. MESSIER DATE 8/03
CHECKED BY D.B. SULLIVAN DATE 8/03
DESIGN SUPERVISOR DATE
PROJ. MAIDSTONE-STRATFORD
TRAFFIC SHEET NO. OF
SHEET 62 OF 65 SHEETS

12 AUG 2003 P:\2071\cadd\gdn\ze064xcl.dgn