

646.40 DURABLE 100 mm WHITE LINE
(ALL LINES WILL INCLUDE EDGE LINE BREAKS AND RADIUS FOR TOWN HIGHWAYS)
U.S. ROUTE 7:
STA. 5+120.0 - STA. 5+360.0 LT & RT

646.60 TEMPORARY 100 mm WHITE LINE
(ALL LINES WILL INCLUDE EDGE LINE BREAKS AND RADIUS FOR TOWN HIGHWAYS)
U.S. ROUTE 7:
STA. 5+120.0 - STA. 5+360.0 LT & RT

646.41 DURABLE 100 mm YELLOW LINE
(ALL LINES WILL INCLUDE C/L BREAKS FOR TOWN HIGHWAYS) S=SOLID, D=DASHED
U.S. ROUTE 7:
STA. 5+120.0 - STA. 5+360.0 LT S C RT
STA. 5+183.697 DOUBLE SOLID LT, T-332 S
STA. 5+289.914 DOUBLE SOLID RT, T-336 S

646.61 TEMPORARY 100 mm YELLOW LINE
(ALL LINES WILL INCLUDE C/L BREAKS FOR TOWN HIGHWAYS) S=SOLID, D=DASHED
U.S. ROUTE 7:
STA. 5+120.0 - STA. 5+360.0 LT S C RT
STA. 5+183.697 DOUBLE SOLID LT, T-332 S
STA. 5+289.914 DOUBLE SOLID RT, T-336 S

646.46 DURABLE 600 mm STOP BAR (TYPE I TAPE)
U.S. ROUTE 7:
STA. 5+183.697 LT, T-332
STA. 5+289.914 RT, T-336

646.66 TEMPORARY 600 mm STOP BAR
U.S. ROUTE 7:
STA. 5+183.697 LT, T-332
STA. 5+289.914 RT, T-336

646.50 DURABLE LETTER OR SYMBOL (TYPE I TAPE)
U.S. ROUTE 7:
STA. 5+183.697 LT, T-332, "S,T,O,P" (4 EA)
STA. 5+289.914 RT, T-336, "S,T,O,P" (4 EA)

646.51 DURABLE CROSSWALK MARKING WITH DIAGONAL LINES (MOD. 2)
U.S. ROUTE 7:
STA. 5+141.5
STA. 5+146.682 RT, T-338
STA. 5+183.697 LT, T-332
STA. 5+289.914 RT, T-336

646.71 TEMPORARY CROSSWALK MARKING WITH DIAGONAL LINES
U.S. ROUTE 7:
STA. 5+141.5
STA. 5+146.682 RT, T-338
STA. 5+183.697 LT, T-332
STA. 5+289.914 RT, T-336

675.50 REMOVING SIGNS
AS SHOWN - 12

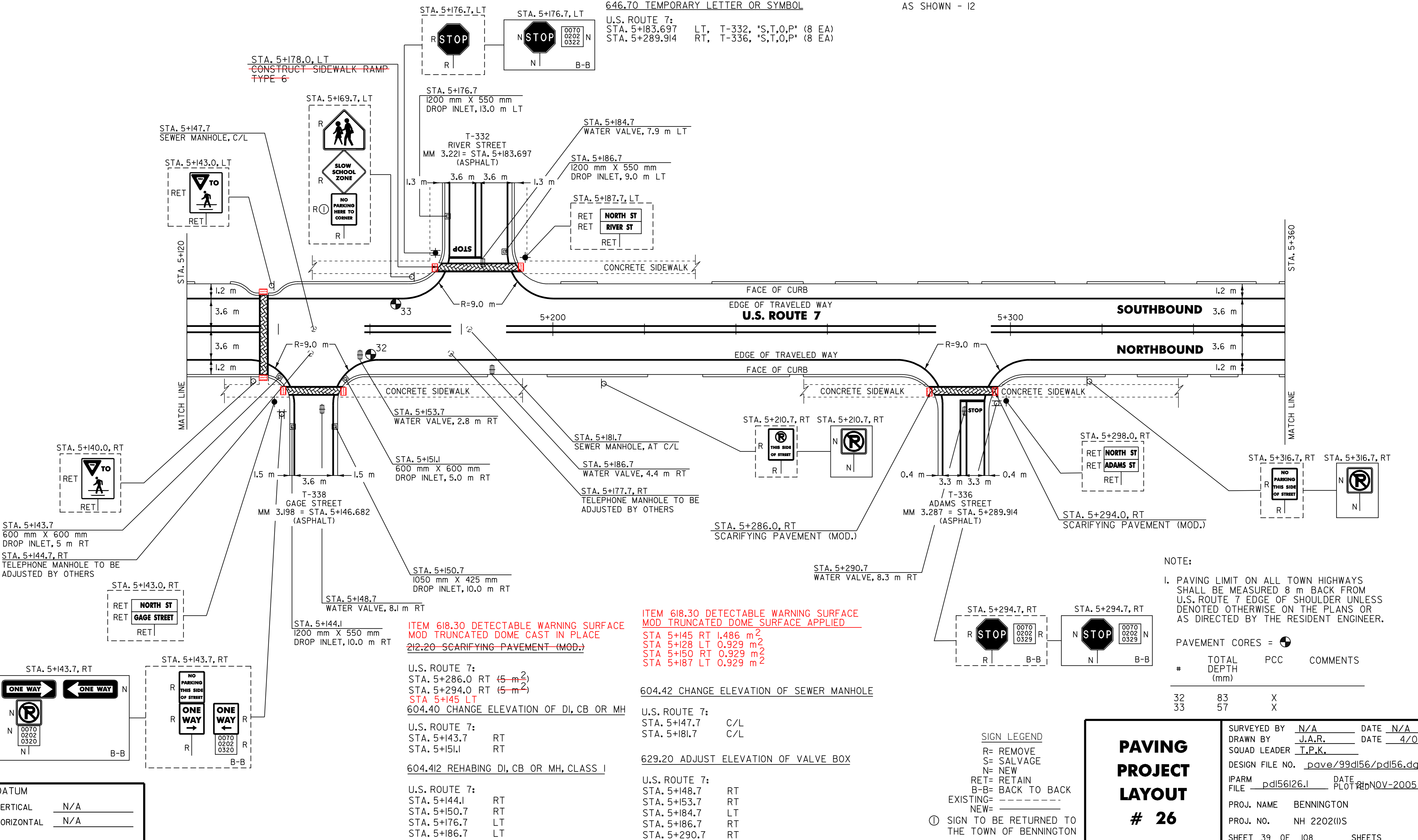

STA. 5+178.0, LT
CONSTRUCT SIDEWALK RAMP
TYPE 6

STA. 5+176.7, LT
R STOP

STA. 5+176.7, LT
N STOP

STA. 5+176.7
1200 mm X 550 mm
DROP INLET, 13.0 m LT

STA. 5+184.7
WATER VALVE, 7.9 m LT

STA. 5+186.7
1200 mm X 550 mm
DROP INLET, 9.0 m LT

STA. 5+187.7, LT
RET NORTH ST
RET RIVER ST
RET

STA. 5+147.7
SEWER MANHOLE, C/L

STA. 5+143.0, LT
RET TO

STA. 5+140.0, RT
RET TO

STA. 5+143.7
600 mm X 600 mm
DROP INLET, 5 m RT

STA. 5+144.7, RT
TELEPHONE MANHOLE TO BE
ADJUSTED BY OTHERS

STA. 5+143.0, RT
RET NORTH ST
RET GAGE STREET
RET

STA. 5+143.7, RT
RET ONE WAY

STA. 5+143.7, RT
RET NO PARKING THIS SIDE OF STREET

STA. 5+143.7, RT
RET ONE WAY

STA. 5+143.7, RT
RET ONE WAY

DATUM
VERTICAL N/A
HORIZONTAL N/A

STA. 5+176.7, LT
R STOP

STA. 5+176.7, LT
N STOP

STA. 5+176.7
1200 mm X 550 mm
DROP INLET, 13.0 m LT

STA. 5+184.7
WATER VALVE, 7.9 m LT

STA. 5+186.7
1200 mm X 550 mm
DROP INLET, 9.0 m LT

STA. 5+187.7, LT
RET NORTH ST
RET RIVER ST
RET

STA. 5+147.7
SEWER MANHOLE, C/L

STA. 5+143.0, LT
RET TO

STA. 5+140.0, RT
RET TO

STA. 5+143.7
600 mm X 600 mm
DROP INLET, 5 m RT

STA. 5+144.7, RT
TELEPHONE MANHOLE TO BE
ADJUSTED BY OTHERS

STA. 5+143.0, RT
RET NORTH ST
RET GAGE STREET
RET

STA. 5+143.7, RT
RET ONE WAY

STA. 5+143.7, RT
RET NO PARKING THIS SIDE OF STREET

STA. 5+143.7, RT
RET ONE WAY

STA. 5+143.7, RT
RET ONE WAY

DATUM
VERTICAL N/A
HORIZONTAL N/A

646.70 TEMPORARY LETTER OR SYMBOL
U.S. ROUTE 7:
STA. 5+183.697 LT, T-332, "S,T,O,P" (8 EA)
STA. 5+289.914 RT, T-336, "S,T,O,P" (8 EA)

STA. 5+176.7, LT
R STOP

STA. 5+176.7, LT
N STOP

STA. 5+176.7
1200 mm X 550 mm
DROP INLET, 13.0 m LT

STA. 5+184.7
WATER VALVE, 7.9 m LT

STA. 5+186.7
1200 mm X 550 mm
DROP INLET, 9.0 m LT

STA. 5+187.7, LT
RET NORTH ST
RET RIVER ST
RET

STA. 5+147.7
SEWER MANHOLE, C/L

STA. 5+143.0, LT
RET TO

STA. 5+140.0, RT
RET TO

STA. 5+143.7
600 mm X 600 mm
DROP INLET, 5 m RT

STA. 5+144.7, RT
TELEPHONE MANHOLE TO BE
ADJUSTED BY OTHERS

STA. 5+143.0, RT
RET NORTH ST
RET GAGE STREET
RET

STA. 5+143.7, RT
RET ONE WAY

STA. 5+143.7, RT
RET NO PARKING THIS SIDE OF STREET

STA. 5+143.7, RT
RET ONE WAY

STA. 5+143.7, RT
RET ONE WAY

DATUM
VERTICAL N/A
HORIZONTAL N/A

646.51 DURABLE CROSSWALK MARKING WITH DIAGONAL LINES (MOD. 2)
U.S. ROUTE 7:
STA. 5+141.5
STA. 5+146.682 RT, T-338
STA. 5+183.697 LT, T-332
STA. 5+289.914 RT, T-336

646.71 TEMPORARY CROSSWALK MARKING WITH DIAGONAL LINES
U.S. ROUTE 7:
STA. 5+141.5
STA. 5+146.682 RT, T-338
STA. 5+183.697 LT, T-332
STA. 5+289.914 RT, T-336

675.50 REMOVING SIGNS
AS SHOWN - 12

STA. 5+176.7, LT
R STOP

STA. 5+176.7, LT
N STOP

STA. 5+176.7
1200 mm X 550 mm
DROP INLET, 13.0 m LT

STA. 5+184.7
WATER VALVE, 7.9 m LT

STA. 5+186.7
1200 mm X 550 mm
DROP INLET, 9.0 m LT

STA. 5+187.7, LT
RET NORTH ST
RET RIVER ST
RET

STA. 5+147.7
SEWER MANHOLE, C/L

STA. 5+143.0, LT
RET TO

STA. 5+140.0, RT
RET TO

STA. 5+143.7
600 mm X 600 mm
DROP INLET, 5 m RT

STA. 5+144.7, RT
TELEPHONE MANHOLE TO BE
ADJUSTED BY OTHERS

STA. 5+143.0, RT
RET NORTH ST
RET GAGE STREET
RET

STA. 5+143.7, RT
RET ONE WAY

STA. 5+143.7, RT
RET NO PARKING THIS SIDE OF STREET

STA. 5+143.7, RT
RET ONE WAY

STA. 5+143.7, RT
RET ONE WAY

DATUM
VERTICAL N/A
HORIZONTAL N/A

ITEM 618.30 DETECTABLE WARNING SURFACE
MOD TRUNCATED DOME SURFACE APPLIED
STA 5+145 RT 1.486 m²
STA 5+128 LT 0.929 m²
STA 5+150 RT 0.929 m²
STA 5+187 LT 0.929 m²

604.42 CHANGE ELEVATION OF SEWER MANHOLE
U.S. ROUTE 7:
STA. 5+147.7 C/L
STA. 5+181.7 C/L

629.20 ADJUST ELEVATION OF VALVE BOX
U.S. ROUTE 7:
STA. 5+148.7 RT
STA. 5+153.7 RT
STA. 5+184.7 LT
STA. 5+186.7 RT
STA. 5+290.7 RT

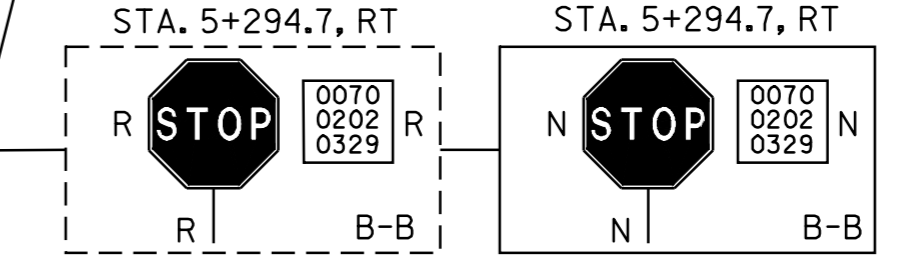

SIGN LEGEND
R= REMOVE
S= SALVAGE
N= NEW
RET= RETAIN
B-B= BACK TO BACK
EXISTING= - - - - -
NEW= _____
⓪ SIGN TO BE RETURNED TO THE TOWN OF BENNINGTON

NOTE:
1. PAVING LIMIT ON ALL TOWN HIGHWAYS SHALL BE MEASURED 8 m BACK FROM U.S. ROUTE 7 EDGE OF SHOULDER UNLESS DENOTED OTHERWISE ON THE PLANS OR AS DIRECTED BY THE RESIDENT ENGINEER.

PAVEMENT CORES =

| # | TOTAL DEPTH (mm) | PCC | COMMENTS |
|----|------------------|-----|----------|
| 32 | 83 | X | |
| 33 | 57 | X | |

PAVING PROJECT LAYOUT # 26

SURVEYED BY N/A DATE N/A
DRAWN BY J.A.R. DATE 4/01
SQUAD LEADER T.P.K.

DESIGN FILE NO. pave/99dl56/pdl56.dgn
IPARM FILE pdl56l26.l DATE PLOT 24 NOV-2005 10

PROJ. NAME BENNINGTON
PROJ. NO. NH 2202(1)S
SHEET 39 OF 108 SHEETS