

646.40 DURABLE 100 mm WHITE LINE
 (ALL LINES WILL INCLUDE EDGE LINE BREAKS AND RADIUS FOR TOWN HIGHWAYS)

VT. ROUTE 9:
 STA. 8+320.0 - STA. 8+580.0 LT & RT

646.60 TEMPORARY 100 mm WHITE LINE
 (ALL LINES WILL INCLUDE EDGE LINE BREAKS AND RADIUS FOR TOWN HIGHWAYS)

VT. ROUTE 9:
 STA. 8+320.0 - STA. 8+580.0 LT & RT

646.41 DURABLE 100 mm YELLOW LINE
 (ALL LINES WILL INCLUDE C/L BREAKS FOR TOWN HIGHWAYS) S=SOLID, D=DASHED

VT. ROUTE 9:
 STA. 8+320.0 - STA. 8+458.7 S
 STA. 8+484.3 - STA. 8+580.0 S
 STA. 8+468.368 DOUBLE SOLID RT, T-486
 STA. 8+468.368 DOUBLE SOLID LT, T-384

646.61 TEMPORARY 100 mm YELLOW LINE
 (ALL LINES WILL INCLUDE C/L BREAKS FOR TOWN HIGHWAYS) S=SOLID, D=DASHED

VT. ROUTE 9:
 STA. 8+320.0 - STA. 8+458.7 S
 STA. 8+484.3 - STA. 8+580.0 S
 STA. 8+468.368 DOUBLE SOLID RT, T-486
 STA. 8+468.368 DOUBLE SOLID LT, T-384

646.42 DURABLE 200 mm WHITE LINE

VT. ROUTE 9:
 STA. 8+340.2 - STA. 8+343.8 RT, SHOULDER HATCHING (12.9 m)
 STA. 8+569.2 - STA. 8+572.8 RT, SHOULDER HATCHING (12.9 m)

646.46 DURABLE 600 mm STOP BAR (TYPE ITAPE)

VT. ROUTE 9:
 STA. 8+459.0 RT
 STA. 8+468.368 RT, T-486
 STA. 8+468.368 LT, T-384
 STA. 8+484.0 LT

646.66 TEMPORARY 600 mm STOP BAR

VT. ROUTE 9:
 STA. 8+459.0 RT
 STA. 8+468.368 RT, T-486
 STA. 8+468.368 LT, T-384
 STA. 8+484.0 LT

646.51 DURABLE CROSSWALK MARKINGS WITH DIAGONAL LINES (MOD.2)

VT. ROUTE 9:
 STA. 8+461.0
 STA. 8+468.368 LT, T-384

646.71 TEMPORARY CROSSWALK MARKINGS WITH DIAGONAL LINES

VT. ROUTE 9:
 STA. 8+461.0
 STA. 8+468.368 LT, T-384

675.50 REMOVING SIGNS
 AS SHOWN - 9

675.60 ERECTING SALVAGED SIGNS
 AS SHOWN - 2

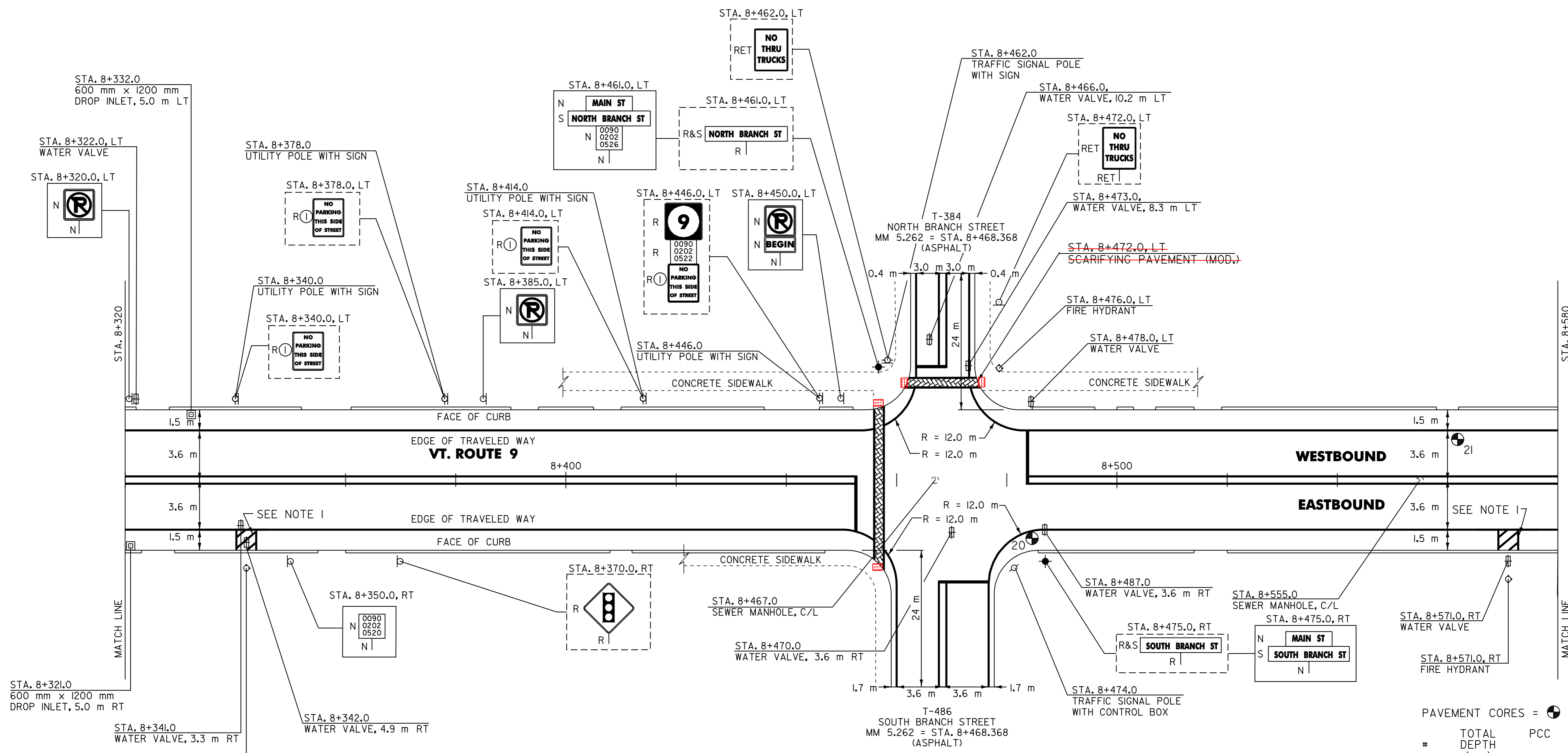

ITEM 618.30 DETECTABLE WARNING SURFACE
 MOD TRUNCATED DOME CAST IN PLACE

~~212.20 SCARIFYING PAVEMENT (MOD.)~~

VT. ROUTE 9:
 STA. 8+472.0 LT (3-m²) & RT 0.929 m²
 STA 8+461 LT 1.858 m²

604.40 CHANGE ELEVATION OF DI, CB OR MH

VT. ROUTE 9:
 STA. 8+321.0 RT
 STA. 8+332.0 LT

604.42 CHANGE ELEVATION OF SEWER MANHOLE

VT. ROUTE 9:
 STA. 8+467.0 C/L
 STA. 8+555.0 C/L

629.20 ADJUST ELEVATION OF VALVE BOX

VT. ROUTE 9:
 STA. 8+341.0 RT
 STA. 8+342.0 RT
 STA. 8+466.0 LT
 STA. 8+470.0 RT
 STA. 8+473.0 LT
 STA. 8+487.0 RT

ITEM 618.30 DETECTABLE WARNING SURFACE
 MOD TRUNCATED DOME SURFACE APPLIED
 STA 8+461 RT

NOTES:

- SEE SHEET 70 OF 108 FOR FIRE HYDRANT PAVEMENT MARKING DETAIL.
- PAVING LIMIT ON ALL TOWN HIGHWAYS SHALL BE MEASURED 8 m BACK FROM VT. ROUTE 9 EDGE OF SHOULDER UNLESS DENOTED OTHERWISE ON THE PLANS OR AS DIRECTED BY THE RESIDENT ENGINEER.

SIGN LEGEND

- R= REMOVE
- S= SALVAGE
- N= NEW
- RET= RETAIN
- B-B= BACK TO BACK
- EXISTING=
- NEW=

① SIGN TO BE RETURNED TO THE TOWN OF BENNINGTON

#	TOTAL DEPTH (mm)	PCC	COMMENTS
20	127	Y	
21	140	Y	

PAVING PROJECT LAYOUT # 19

SURVEYED BY	N/A	DATE	N/A
DRAWN BY	J.A.R.	DATE	4/01
SQUAD LEADER	T.P.K.		
DESIGN FILE NO.	pave/99dl56/pdl56.dgn		
IPARM FILE	pdl56119.i	DATE PLOTTED	27 NOV-2005 10
PROJ. NAME	BENNINGTON		
PROJ. NO.	NH 2202(1)S		
SHEET 32 OF 108	SHEETS		

DATUM	
VERTICAL	N/A
HORIZONTAL	N/A