

646.40 DURABLE 100 mm WHITE LINE  
(ALL LINES WILL INCLUDE EDGE LINE BREAKS AND RADIUS FOR TOWN HIGHWAYS)

VT. ROUTE 9:  
STA. 7+960.0 - STA. 8+140.0 LT & RT

646.60 TEMPORARY 100 mm WHITE LINE  
(ALL LINES WILL INCLUDE EDGE LINE BREAKS AND RADIUS FOR TOWN HIGHWAYS)

VT. ROUTE 9:  
STA. 7+960.0 - STA. 8+140.0 LT & RT

646.41 DURABLE 100 mm YELLOW LINE  
(ALL LINES WILL INCLUDE C/L BREAKS FOR TOWN HIGHWAYS) S=SOLID, D=DASHED

VT. ROUTE 9:  
STA. 7+960.0 - STA. 7+977.7 S  
STA. 8+005.0 - STA. 8+019.7 S  
STA. 8+056.3 - STA. 8+140.0 S  
STA. 7+998.440 DOUBLE SOLID RT, T-476  
STA. 8+032.236 DOUBLE SOLID RT, T-3

646.61 TEMPORARY 100 mm YELLOW LINE  
(ALL LINES WILL INCLUDE C/L BREAKS FOR TOWN HIGHWAYS) S=SOLID, D=DASHED

VT. ROUTE 9:  
STA. 7+960.0 - STA. 7+977.7 S  
STA. 8+005.0 - STA. 8+019.7 S  
STA. 8+056.3 - STA. 8+140.0 S  
STA. 7+998.440 DOUBLE SOLID RT, T-476  
STA. 8+032.236 DOUBLE SOLID RT, T-3

646.42 DURABLE 200 mm WHITE LINE

VT. ROUTE 9:  
STA. 8+058.2 - STA. 8+061.8 RT, SHOULDER HATCHING (16.3 m)

646.46 DURABLE 600 mm STOP BAR (TYPE ITAPE)

VT. ROUTE 9:  
STA. 7+978.0 RT 7+988  
STA. 7+998.440 RT, T-476  
STA. 8+020.0 RT  
STA. 8+032.236 RT, T-3  
STA. 8+056.0 LT

646.46 DURABLE 600 mm STOP BAR (TYPE ITAPE)

VT. ROUTE 9:  
STA. 7+978.0 RT  
STA. 7+998.440 RT, T-476  
STA. 8+020.0 RT  
STA. 8+032.236 RT, T-3  
STA. 8+056.0 LT

646.50 DURABLE LETTER OR SYMBOL (TYPE ITAPE)

VT. ROUTE 9:  
STA. 7+998.440 RT, T-476, "S,T,O,P" (4 EA)

646.70 TEMPORARY LETTER OR SYMBOL

VT. ROUTE 9:  
STA. 7+998.440 RT, T-476, "S,T,O,P" (8 EA)

646.51 DURABLE CROSSWALK MARKINGS WITH DIAGONAL LINES (MOD 2)

VT. ROUTE 9:  
STA. 7+998.440 RT, T-476  
STA. 8+027.0  
STA. 8+032.236 RT, T-3

646.71 TEMPORARY CROSSWALK MARKINGS WITH DIAGONAL LINES

VT. ROUTE 9:  
STA. 7+998.440 RT, T-476  
STA. 8+027.0  
STA. 8+032.236 RT, T-3

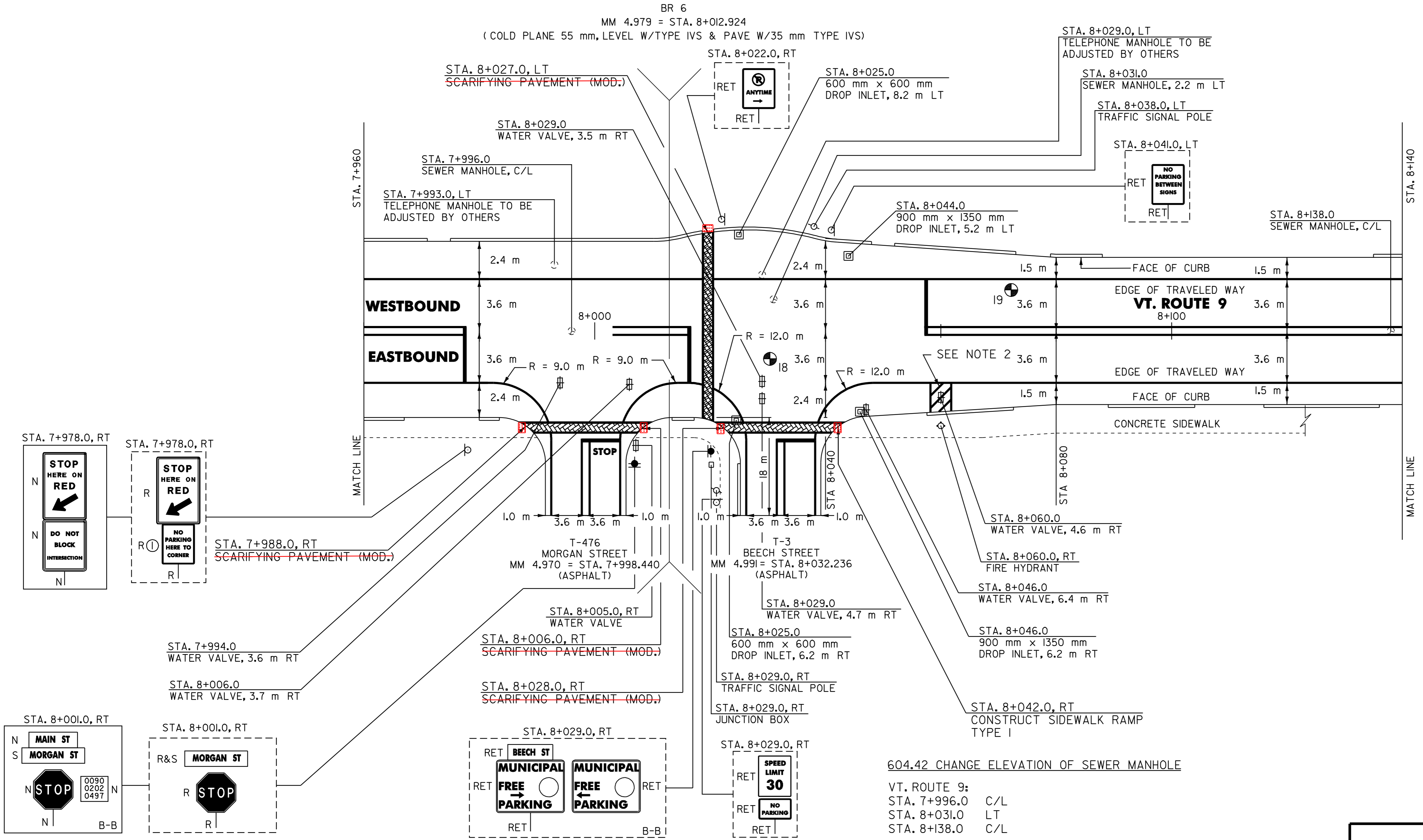

- NOTES:
- PAVING LIMIT ON ALL TOWN HIGHWAYS SHALL BE MEASURED 8 m BACK FROM VT. ROUTE 9 EDGE OF SHOULDER UNLESS DENOTED OTHERWISE ON THE PLANS OR AS DIRECTED BY THE RESIDENT ENGINEER.
  - SEE SHEET 70 OF 108 FOR FIRE HYDRANT PAVEMENT MARKING DETAIL.

PAVEMENT CORES =

#	TOTAL DEPTH (mm)	PCC	COMMENTS
18	114	Y	
19	127	Y	

604.42 CHANGE ELEVATION OF SEWER MANHOLE  
VT. ROUTE 9:  
STA. 7+996.0 C/L  
STA. 8+031.0 LT  
STA. 8+138.0 C/L

629.20 ADJUST ELEVATION OF VALVE BOX  
VT. ROUTE 9:  
STA. 7+994.0 RT  
STA. 8+006.0 RT  
STA. 8+029.0 RT  
STA. 8+029.0 RT  
STA. 8+046.0 RT  
STA. 8+060.0 RT

SIGN LEGEND  
R= REMOVE  
S= SALVAGE  
N= NEW  
RET= RETAIN  
B-B= BACK TO BACK  
EXISTING= -----  
NEW= \_\_\_\_\_  
① SIGN TO BE RETURNED TO THE TOWN OF BENNINGTON

## PAVING PROJECT LAYOUT # 17

SURVEYED BY	N/A	DATE	N/A
DRAWN BY	J.A.R.	DATE	4/01
SQUAD LEADER	T.P.K.		
DESIGN FILE NO.	pave/99d156/pd156.dgn		
IPARM FILE	pd156i17.i	DATE PLOTTED	NOV-2005 10
PROJ. NAME	BENNINGTON		
PROJ. NO.	NH 2202(1)S		
SHEET 30 OF 108		SHEETS	

DATUM

VERTICAL	N/A
HORIZONTAL	N/A

ITEM 618.30 DETECTABLE WARNING SURFACE MOD TRUNCATED DOME CAST IN PLACE  
~~212.20 SCARIFYING PAVEMENT (MOD.)~~  
VT. ROUTE 9: STA 8+042 RT 0.929 m<sup>2</sup>  
STA. 7+988.0 RT (5-m<sup>2</sup>) 0.929 m<sup>2</sup>  
STA. 8+006.0 RT (5-m<sup>2</sup>) 0.929 m<sup>2</sup>  
STA. 8+027.0 LT (3-m<sup>2</sup>) 0.929 m<sup>2</sup>  
STA. 8+028.0 RT (3-m<sup>2</sup>) 1.858 m<sup>2</sup>

604.40 CHANGE ELEVATION OF DI, CB OR MH  
VT. ROUTE 9:  
STA. 8+025.0 RT  
STA. 8+025.0 LT  
STA. 8+044.0 LT  
STA. 8+046.0 RT