

646.40 DURABLE 100 mm WHITE LINE
 (ALL LINES WILL INCLUDE EDGE LINE BREAKS AND RADIUS FOR TOWN HIGHWAYS)
 VT. ROUTE 9:
 STA. 6+580.0 - STA. 6+760.0 LT & RT
 STA. 6+595.092 LT, T-7
 STA. 6+630.497 LT, T-7

646.60 TEMPORARY 100 mm WHITE LINE
 (ALL LINES WILL INCLUDE EDGE LINE BREAKS AND RADIUS FOR TOWN HIGHWAYS)
 VT. ROUTE 9:
 STA. 6+580.0 - STA. 6+760.0 LT & RT
 STA. 6+595.092 LT, T-7
 STA. 6+630.497 LT, T-7

646.41 DURABLE 100 mm YELLOW LINE
 (ALL LINES WILL INCLUDE C/L BREAKS FOR TOWN HIGHWAYS) S=SOLID, D=DASHED
 VT. ROUTE 9:
 STA. 6+680.0 - STA. 6+760.0 S
 STA. 6+580.0 - STA. 6+611.5 S
 STA. 6+652.8 - STA. 6+680.0 S
 STA. 6+630.497 DOUBLE SOLID LT, T-7 (MEDIAN TAPER)
 STA. 6+633.716 DOUBLE SOLID RT, T-404
 STA. 6+622.0, LT

646.61 TEMPORARY 100 mm YELLOW LINE
 (ALL LINES WILL INCLUDE C/L BREAKS FOR TOWN HIGHWAYS) S=SOLID, D=DASHED
 VT. ROUTE 9:
 STA. 6+680.0 - STA. 6+760.0 S
 STA. 6+580.0 - STA. 6+611.5 S
 STA. 6+652.8 - STA. 6+680.0 S
 STA. 6+630.497 DOUBLE SOLID LT, T-7 (MEDIAN TAPER)
 STA. 6+633.716 DOUBLE SOLID RT, T-404
 STA. 6+622.0, LT

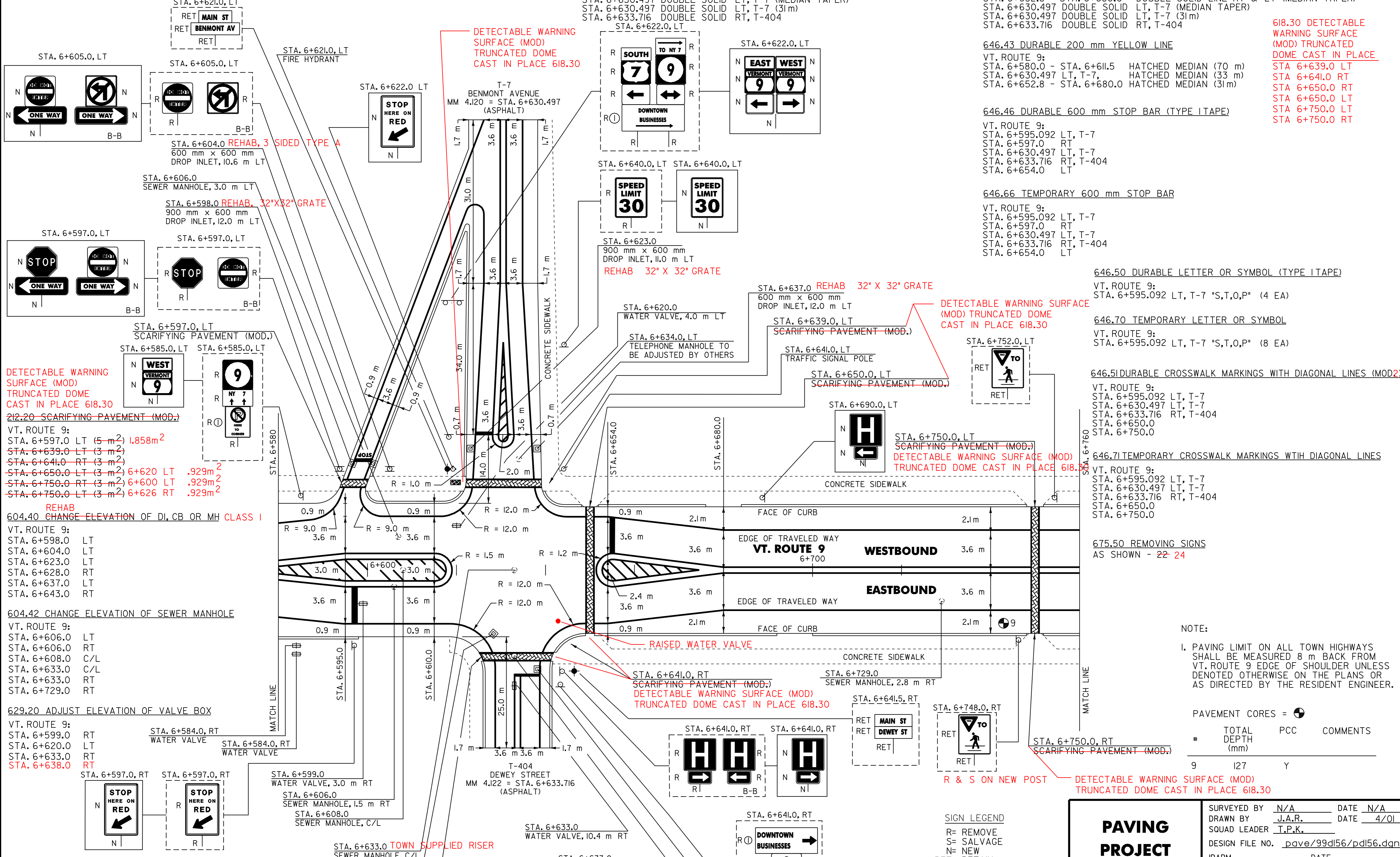

618.30 DETECTABLE WARNING SURFACE (MOD) TRUNCATED DOME CAST IN PLACE
 STA 6+639.0 LT
 STA 6+641.0 RT
 STA 6+650.0 RT
 STA 6+650.0 LT
 STA 6+750.0 LT
 STA 6+750.0 RT

DETECTABLE WARNING SURFACE (MOD) TRUNCATED DOME CAST IN PLACE 618.30
~~212.20 SCARIFYING PAVEMENT (MOD.)~~
 VT. ROUTE 9:
 STA. 6+597.0 LT (5 m²) 1.858m²
 STA. 6+639.0 LT (3 m²)
 STA. 6+641.0 RT (3 m²)
 STA. 6+650.0 LT (3 m²) 6+620 LT .929m²
 STA. 6+750.0 RT (3 m²) 6+600 LT .929m²
 STA. 6+750.0 LT (3 m²) 6+626 RT .929m²

604.40 REHAB CHANGE ELEVATION OF DI, CB OR MH CLASS I
 VT. ROUTE 9:
 STA. 6+598.0 LT
 STA. 6+604.0 LT
 STA. 6+623.0 LT
 STA. 6+628.0 RT
 STA. 6+637.0 LT
 STA. 6+643.0 RT

604.42 REHAB CHANGE ELEVATION OF SEWER MANHOLE
 VT. ROUTE 9:
 STA. 6+606.0 LT
 STA. 6+606.0 RT
 STA. 6+608.0 C/L
 STA. 6+633.0 C/L
 STA. 6+633.0 RT
 STA. 6+729.0 RT

629.20 REHAB ADJUST ELEVATION OF VALVE BOX
 VT. ROUTE 9:
 STA. 6+599.0 RT
 STA. 6+620.0 LT
 STA. 6+633.0 RT
 STA. 6+638.0 RT

DATUM

VERTICAL	N/A
HORIZONTAL	N/A

DETECTABLE WARNING SURFACE (MOD) TRUNCATED DOME CAST IN PLACE 618.30

646.63 TOWN SUPPLIED RISER
 STA. 6+633.0 SEWER MANHOLE, C/L
 STA. 6+628.0 REHAB TYPE A 600 mm x 600 mm DROP INLET, 6.0 m RT
 STA. 6+626.0 RT CONSTRUCT SIDEWALK RAMP TYPE 6
 STA. 6+643.0 600 mm x 600 mm DROP INLET, 9.0 m RT REHAB, 3 SIDED, TYPE A

SIGN LEGEND
 R= REMOVE
 S= SALVAGE
 N= NEW
 RET= RETAIN
 B-B= BACK TO BACK
 EXISTING= - - - - -
 NEW= _____
 (1) SIGN TO BE RETURNED TO THE TOWN OF BENNINGTON

PAVING PROJECT LAYOUT # 9

SURVEYED BY	N/A	DATE	N/A
DRAWN BY	J.A.R.	DATE	4/01
SQUAD LEADER	T.P.K.		
DESIGN FILE NO.	pave/99dl56/pdl56.dgn		
IPARM FILE	pdl56109.i	DATE	21 NOV-2005 10:
PROJ. NAME	BENNINGTON		
PROJ. NO.	NH 2202(1)S		
SHEET	22 OF 108	SHEETS	

NOTE:
 1. PAVING LIMIT ON ALL TOWN HIGHWAYS SHALL BE MEASURED 8 m BACK FROM VT. ROUTE 9 EDGE OF SHOULDER UNLESS DENOTED OTHERWISE ON THE PLANS OR AS DIRECTED BY THE RESIDENT ENGINEER.

PAVEMENT CORES =

#	TOTAL DEPTH (mm)	PCC	COMMENTS
9	127	Y	