

646.40 DURABLE 100 mm WHITE LINE
 (ALL LINES WILL INCLUDE EDGE LINE BREAKS AND RADIUS FOR TOWN HIGHWAYS)
 VT. ROUTE 9:
 STA. 5+320.0 - STA. 5+520.0 LT & RT
 STA. 5+420.0 - STA. 5+460.0 RT, DOTTED LINE (EDGE LINE)

646.41 DURABLE 100 mm YELLOW LINE
 (ALL LINES WILL INCLUDE C/L BREAKS FOR TOWN HIGHWAYS) S=SOLID, D=DASHED
 VT. ROUTE 9:
 STA. 5+320.0 - STA. 5+520.0

646.46 DURABLE 600 mm STOP BAR (TYPE I TAPE)
 VT. ROUTE 9:
 STA. 5+452.457 RT, T-2
 STA 5+455 RT, T-2
 646.66 TEMPORARY 600 mm STOP BAR
 VT. ROUTE 9:
 STA. 5+452.457 RT, T-2

675.50 REMOVING SIGNS
 AS SHOWN - 24

ADJUST HEIGHT OF WATER VALVE
 STA 05+448 RT

646.60 TEMPORARY 100 mm WHITE LINE
 (ALL LINES WILL INCLUDE EDGE LINE BREAKS AND RADIUS FOR TOWN HIGHWAYS)
 VT. ROUTE 9:
 STA. 5+320.0 - STA. 5+520.0 LT & RT
 STA. 5+420.0 - STA. 5+460.0 RT, DOTTED LINE (EDGE LINE)

646.61 TEMPORARY 100 mm YELLOW LINE
 (ALL LINES WILL INCLUDE C/L BREAKS FOR TOWN HIGHWAYS) S=SOLID, D=DASHED
 VT. ROUTE 9:
 STA. 5+320.0 - STA. 5+520.0

646.50 DURABLE LETTER OR SYMBOL (TYPE I TAPE)
 VT. ROUTE 9:
 STA. 5+452.457 RT, T-2, "S,T,O,P" (4 EA)
 STA 5+455 RT, T-2 "STOP" (4 EA)
 646.70 TEMPORARY LETTER OR SYMBOL
 VT. ROUTE 9:
 STA. 5+452.457 RT, T-2, "S,T,O,P" (8 EA)

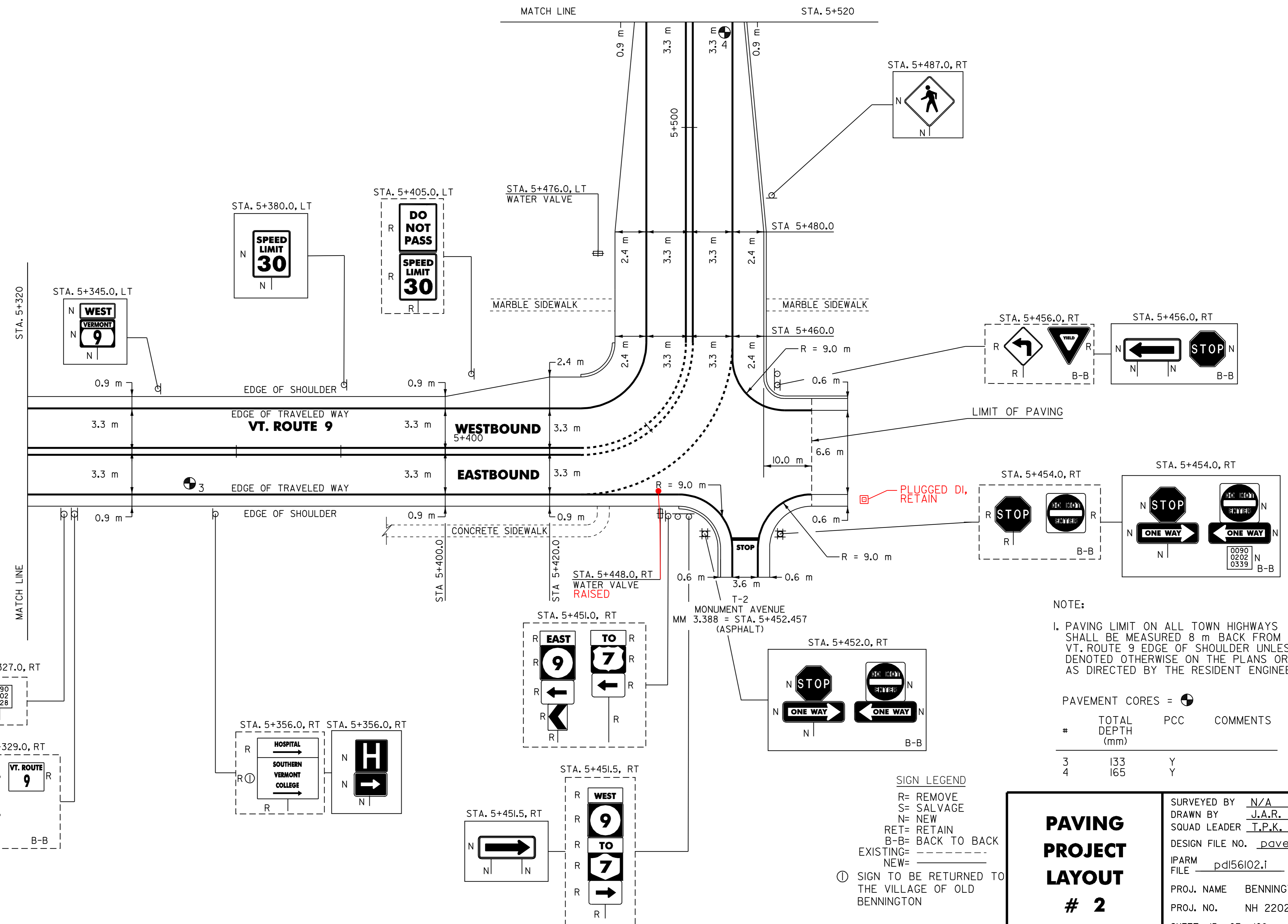

NOTE:
 1. PAVING LIMIT ON ALL TOWN HIGHWAYS SHALL BE MEASURED 8 m BACK FROM VT. ROUTE 9 EDGE OF SHOULDER UNLESS DENOTED OTHERWISE ON THE PLANS OR AS DIRECTED BY THE RESIDENT ENGINEER.

PAVEMENT CORES =

#	TOTAL DEPTH (mm)	PCC	COMMENTS
3	133	Y	
4	165	Y	

SIGN LEGEND
 R= REMOVE
 S= SALVAGE
 N= NEW
 RET= RETAIN
 B-B= BACK TO BACK
 EXISTING=
 NEW=
 ① SIGN TO BE RETURNED TO THE VILLAGE OF OLD BENNINGTON

PAVING PROJECT LAYOUT # 2

SURVEYED BY N/A DATE N/A
 DRAWN BY J.A.R. DATE 4/01
 SQUAD LEADER T.P.K.
 DESIGN FILE NO. pave/99d156/pd156.dgn
 IPARM FILE pd156102.i DATE NOV-2005 10
 PROJ. NAME BENNINGTON
 PROJ. NO. NH 2202(1)S
 SHEET 15 OF 108 SHEETS

DATUM

VERTICAL	N/A
HORIZONTAL	N/A