

STEEL BEAM GUARD RAIL
 STA. 9+392.02 RT. - STA. 9+516.32 RT.
 STA. 9+564.10 RT. - STA. 9+632.71 RT.
 STA. 9+659.38 RT. - STA. 9+701.55 RT.

ANCHOR FOR STEEL BEAM GUARD RAIL
 STA. 9+392.02 RT. (2)
 STA. 9+392.02 RT. (1)

T-50
 BURNOR ROAD
 MM 5.986 = STA. 9+633.270
 (PAVED)

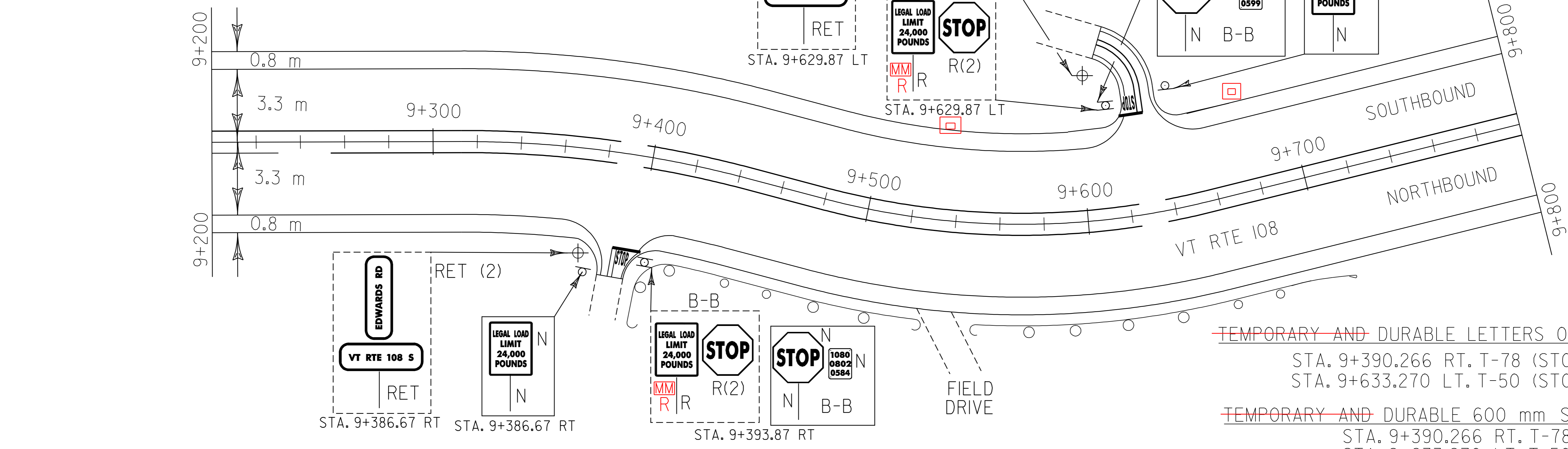

~~TEMPORARY AND DURABLE LETTERS OR SYMBOLS~~
 STA. 9+390.266 RT. T-78 (STOP)
 STA. 9+633.270 LT. T-50 (STOP)
~~TEMPORARY AND DURABLE 600 mm STOP BAR~~
 STA. 9+390.266 RT. T-78
 STA. 9+633.270 LT. T-50

T-78
 EDWARDS ROAD
 MM 5.835 = STA. 9+390.266
 (PAVED)

STEEL BEAM GUARD RAIL W/2.4 M POSTS
 STA. 9+632.71 RT. - STA. 9+659.38 RT.
 STA. 9+957.38 RT. - STA. 10+313.41 RT.

REMOVING SIGNS
 6 EA

REHABILITATION OF DI, CB, OR MH CLASS I
 STA. 9+531.00 LT
 STA. 9+670.00 LT

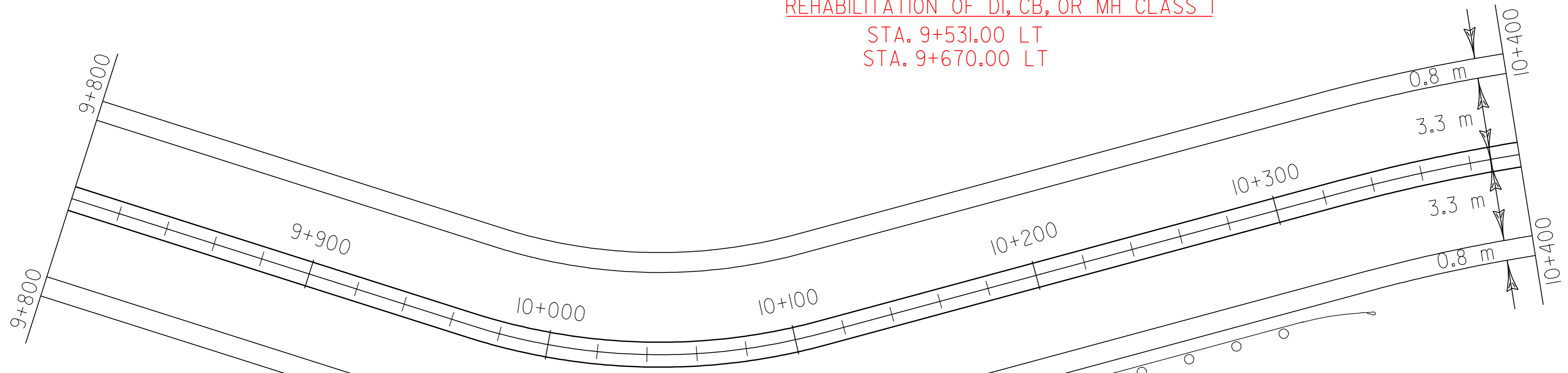

REMOVAL AND DISPOSAL OF GUARD RAIL
 STA. 9+392.02 RT. - STA. 9+527.72 RT.
 STA. 9+552.70 RT. - STA. 9+712.95 RT.
 STA. 9+945.98 RT. - STA. 10+324.81 RT.

MANUFACTURED TERMINAL SECTION (FLARED)
 USED G-ID ~~STA. 9+527.72 RT.~~ STA. 9+552.70 RT.
 STA. 9+712.95 RT. STA. 9+945.98 RT.
 STA. 10+324.81 RT.

TEMPORARY AND DURABLE 100 mm YELLOW LINE W/CL BREAKS FOR TH'S
 STA. 9+200.00 RT. - STA. 9+253.73 RT. (DASHED)
 STA. 9+200.00 LT. - STA. 9+253.73 LT. (SOLID)
 STA. 9+253.73 - STA. 10+400.00 LT. & RT. (SOLID)
 STA. 9+390.27 RT. T-78 (SOLID)
 STA. 9+633.27 LT. T-50 (SOLID)

TEMPORARY AND DURABLE 100 mm WHITE LINE
 STA. 9+200.00 - STA. 10+400.00 RT. & LT.
~~TREATED TIMBER CURB~~
~~STA. 9+945.98 RT. STA. 9+994.28 RT.~~

PAVING PROJECT LAYOUT #6	PROJECT NAME: CAMBRIDGE	FILE NAME: Z:\pave\299ci88\299ci88.dgn	PLOT DATE: 14-FEB-2006 16:4
	PROJECT NUMBER: SIP_2218(1)S	PROJECT LEADER: WOQLAYER	DRAWN BY: KML
	DESIGNED BY: KML	RECORDED BY: LOCKE	CHECKED BY: PAVI.MGMT.
			SHEET 13 OF 28