

**REMOVAL AND DISPOSAL OF GUARD RAIL**

STA. 4+692.22 LT. - STA. 4+845.63 LT.  
 STA. 4+740.57 RT. - STA. 4+788.72 RT.  
 STA. 5+014.18 LT. - STA. 5+093.66 LT.

**STEEL BEAM GUARD RAIL**

STA. 4+703.65 LT. - STA. 4+834.20 LT.  
 STA. 4+751.99 RT. - STA. 4+777.29 RT.  
 STA. 5+025.61 LT. - STA. 5+082.23 LT.

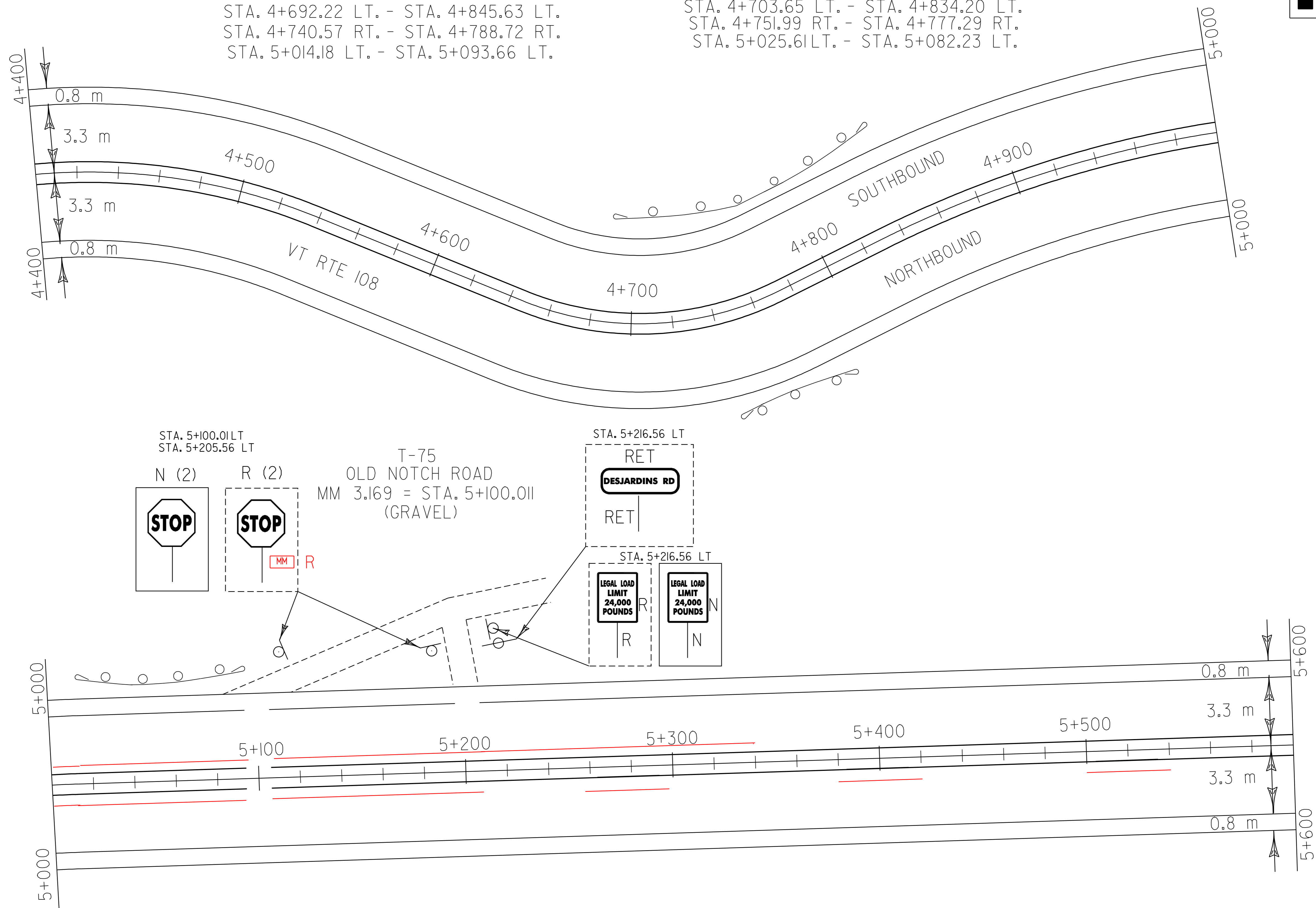

STA. 5+100.01 LT  
 STA. 5+205.56 LT

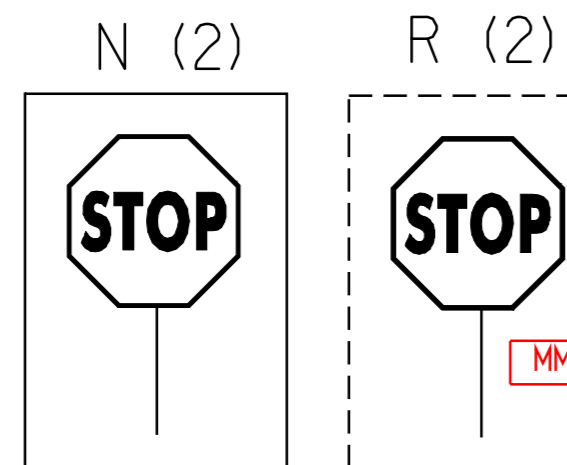

T-75  
 OLD NOTCH ROAD  
 MM 3.169 = STA. 5+100.01  
 (GRAVEL)

STA. 5+216.56 LT

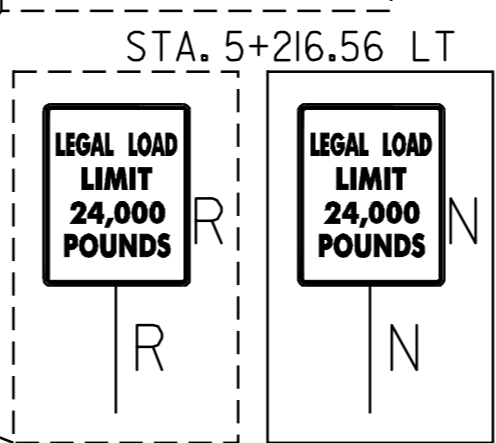
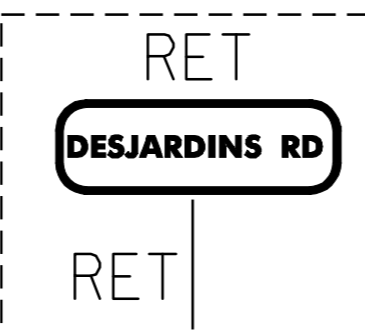

**MANUFACTURED TERMINAL SECTION (FLARED)**

STA. 4+692.22 LT.  
 STA. 4+740.57 RT.  
 STA. 4+788.72 RT.  
 STA. 4+845.63 LT.  
 STA. 5+014.18 LT.  
 STA. 5+093.66 LT.

**REMOVING SIGNS**  
 4 - 3 EA

**TEMPORARY AND DURABLE 100 mm WHITE LINE W/ EL BREAKS FOR TH'S**  
 STA. 4+400.00 - STA. 5+600.00 LT. & RT.

**TEMPORARY AND DURABLE 100 mm YELLOW LINE W/ CL BREAKS FOR TH'S**

~~STA. 4+400.00 - STA. 5+600.00 LT. & RT. (SOLID)~~  
 STA. 4+400.00 - STA. 5+222.32 LT & RT (SOLID)  
 STA. 5+222.32 - STA. 5+343.02 LT (SOLID)  
 STA. 5+222.32 - STA. 5+600.00 RT (DASHED)

**PAVING PROJECT LAYOUT #2**

PROJECT NAME: CAMBRIDGE	FILE NAME: Z:\pave\299cl88\299cl88.dgn	PLOT DATE: 14-FEB-2006 16:4
PROJECT NUMBER: SIP_2218(I)S	PROJECT LEADER: WQQLAYER	DRAWN BY: KML
DESIGNED BY: KML	RECORDED BY: LOCKE	CHECKED BY: PAVI_MGMT
		SHEET 9 OF 28